

m12 Receptacle

M12 (Plastic) Receptacle, Male, A-Coding

Description

Receptacle, Front Fastened,
Screw Type, Solder, Plastic



Drawing

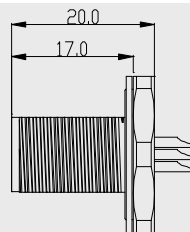

Coding

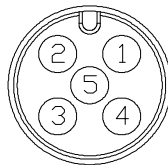

Part NO.

A-Coding

Contacts	Part -Number	Contacts	Part -Number
3	56035105-01	4	56045105-01
5	56055105-01		

Specifications

	3	4	5	8	
Number of Contacts	3	4	5	8	
Voltage Rating	250V	250V	60V	30V	
Rated Current(40°C)	4A	4A	4A	2A	
Environmental Protection	IP67				
Mechanical Life	100 mating cycles (min)				
Operating Temperature	-40°C - 105°C				

Conductor Type

Wire Gauge	0.34mm ² (22AWG)	0.34mm ² (22AWG)	0.34mm ² (22AWG)	0.25mm ² (24AWG)	

About CHOGORI

Industrial Automation

To Order

M8 Series

M12 Series

USB Series

RJ45 Series

D-SUB Series