

m12 Receptacle

M12 (Metal Die-Casting) Receptacle, Female, A, B & D-Coding

Description Receptacle, Rear Fastened, Screw Type, Solder

Figure



Drawing

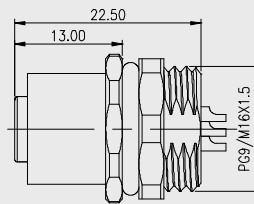

Coding

A-Coding (X=1)

B-Coding (X=2)

D-Coding (X=4)

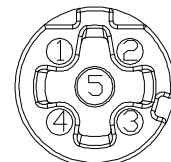
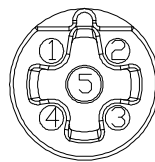
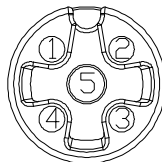

Part No.	Contacts		Part Number		Contacts		Part Number	
	A, B, D-Coding	3	M16X1.5	54036X05-09	4	M16X1.5	54046X05-09	PG9
PG9			54036X05-19	PG9		54046X05-19		
5		M16X1.5	54056X05-09	12	M16X1.5	54126105-09	PG9	54126105-19
		PG9	54056X05-19		PG9	54126105-19		
A-Coding	8	M16X1.5	54086105-09	12	M16X1.5	54126105-09	PG9	54126105-19
		PG9	54086105-19		PG9	54126105-19		

Specifications					
Number of Contacts	3	4	5	8	12
Voltage Rating	250V	250V	60V	30V	30V
Rated Current (40°C)	4A	4A	4A	2A	1.5A
Max Panel Thickness	3.0mm (max)				
Environmental Protection	IP68				
Mechanical Life	100 mating cycles (min)				
Operating Temperature	-40°C - 85°C				
Conductor Type					
Wire Gauge	0.34mm ² (22AWG)	0.34mm ² (22AWG)	0.34mm ² (22AWG)	0.25mm ² (24AWG)	0.14mm ² (26AWG)

About CHOGORI
Industrial Automation
To Order
M8 Series
M12 Series
USB Series
RJ45 Series
D-SUB Series