

Part Number	Wire Size	Current/Volt	Screw	Dimension (mm)					
				A	B	C	D (Pitch)	E	F
SM C09 710010 XX AK	2.5mm ²	24A/450V	M3.0*6	116.5	20.6	16.2	10.0	3.5	N/A
SM C09 710010 XX BK	2.5mm ²	24A/450V	M3.0*6	116.5	20.6	16.2	10.0	3.5	N/A
SM C09 710010 XX CK	2.5mm ²	24A/450V	M3.0*6	116.5	20.6	19.2	10.0	3.5	N/A
SM C09 710010 XX DK	2.5mm ²	24A/450V	M3.0*6	116.5	20.6	19.2	10.0	3.5	N/A

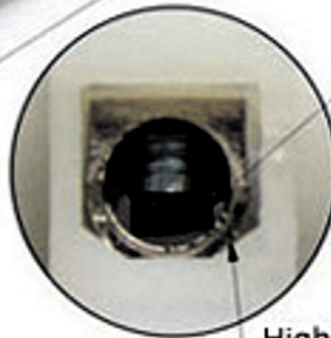

Wire Protector

High Grade Copper Alloy (B Class)
Pure Copper Materials (A Class)

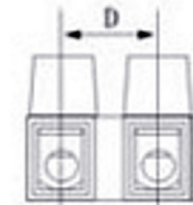
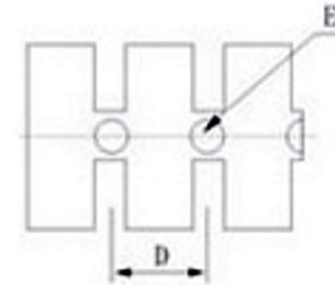
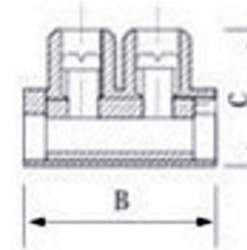

B = with wire protector
C = with Higher Base
D = Higher base and wire protector

RoHS Compliant		SCHMID-M	
APPD.	SCALE	TOLERANCE 0 ± .00 ± ANG. ±	PART NAME Fuse Terminal Block
DWG. BRAUN	UNIT M M	SIZE. A 4	PART NO. SM C09 710010 XX XK
DATE 2013/05/14	PAGE 1 OF 1	REV. A	