

Components for the most demanding applications

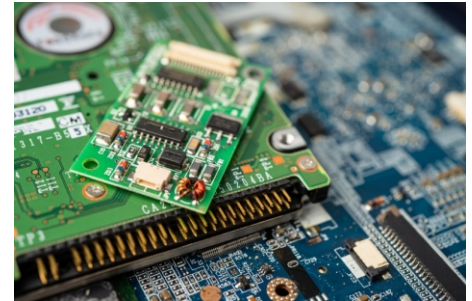

Zahl	Ziel	Über	Ziel	Intervall	Geht
1320	Köln	Frankfurt	Frankfurt	10	10
1321	Köln	Frankfurt	Frankfurt	10	10
1326	Köln	Frankfurt	Frankfurt	10	10
1328	Köln	Frankfurt	Frankfurt	10	10
1345	Köln	Frankfurt	Frankfurt	10	10
1346	Köln	Frankfurt	Frankfurt	10	10
1349	Köln	Frankfurt	Frankfurt	10	10
1350	Köln	Frankfurt	Frankfurt	10	10
1352	Köln	Frankfurt	Frankfurt	10	10
1353	Köln	Frankfurt	Frankfurt	10	10
1357	Köln	Frankfurt	Frankfurt	10	10
1400	Köln	Frankfurt	Frankfurt	10	10
1402	Köln	Frankfurt	Frankfurt	10	10



TABLE OF CONTENT

Introduction.....	3
Pin Headers Customer & Standard.....	4
Pin Header & Female Header.....	5
Box Header, Micro-Match, RJ & USB connectors.....	6
Circular connectors M12, M8, Waterproof, Audio.....	7
D-Sub Connectors, D-Sub Hoods.....	8
Push-Pull Connectors.....	9
EPT connectors ...Colibri & One27.....	10
EPT connectors ..Zero8 & EC.8.....	11
EPT connectors ..DIN 41612/IEC 60603-2.....	12
EPT connectors ..Press-fit technology, HM2.0.....	13
RF connectors, Cables, Antennas.....	14
Terminal Block - Pluggable, PCB, Transformer.....	15
PCB Elements, Spacer, Crimp Contacts.....	16
Fuses & Cables.....	17
Plastic boxes & Piezo Components.....	18
Switches.....	19
LED & Display.....	20
Memories.....	21
Inductors.....	22
TDK-EPCOS Capacitors, Ferrites, Arresters, Chokes.....	23
aird - Thermal Interface material - Cutting plotter.....	24
Laird Thermoelectric Modules - Cooling Systems.....	25
Laird EMI Gasket - Elastomers, FOF, Fingerstock.....	26
Laird EMI Gasket - Board Level Shield, Absorbers.....	27
Patron - Converters - SMD, SIL-DIL, DIN Rail.....	28
Myrra Transformers, Power Chokes.....	29
Schmid-M Converters.....	30
Schmid-M - Battery & EMI filters.....	31
ELMA - Rotary Switch, Encoders, Knobs.....	32
ELMA - Multi Rotary Switch, LED, Enclosures.....	33
Capacitors.....	34
AB Chimie - Conformal Coatings.....	35
AB Chimie - Resins and Glues.....	36
Customized Components.....	37
Customized Components.....	38
Ferrites, Bobbins and Clamps.....	39
Catalogs.....	40

You can find many of our products on our e-shop: www.atd-shop.com

**atd-shop is linked to company system
and shows the actual stock status.**

Vážení zákazníci / partneři,
s radostí ale i s pokorou bych se rád pochlubil, že jsme letos oslavili 30 let od založení naší firmy.

Výročí firmy je pěkná věc, ale je potřeba se dívat stále vpřed a být připraven na přicházející výzvy. Prožili jsme covidové období plné zákazů a omezení, období nedostatku elektronických součástek a nyní se nám za humny spláčil krvelačný ruský medvěd.

Toto turbulentní období jsme zvládli díky individuálnímu přístupu ke každému Vašemu požadavku a také díky novému skladu. Velmi se osvědčili rámcové objednávky a postupné dodávky zboží dle požadavků. Také se nám pomalu vrací vynaložená práce na atd-shopu. Stále k nám přicházejí noví zákazníci z celého světa.

Díky odborným znalostem Vám můžeme nabídnout technickou podporu, navrhnout ekvivalenty a řešení. Sortiment také přizpůsobujeme požadavkům Vašich aplikací. Proto velkou část našich produktů tvoří zákaznické typy a produkty. Rozšiřujeme nabídku absorberů, tepelně vodivých materiálů, SMD DC/DC měničů, UV laků, pojistek, LED displejů, integrovaných obvodů, pamětí, výkonových tlumivek, pig-tailů ...

Mnoho novinek představujeme na našich internetových stránkách, při osobních návštěvách a také je postupně nabízíme na e-shopu.

Jsmo poměrně malá firma, přesto se nebojíme nových výzev a těšíme se na Vaše současné i budoucí požadavky.

Doufám, že budete s našimi službami i nadále spokojeni.

Za tým ATD,

Ing. Petr Jankovec - generální ředitel

Dear customers / partners,
I would like to proudly but humbly boast that this year we have celebrated 30 years since the foundation of company.

A company's anniversary is a nice thing, but we need to keep looking forward and be ready for the challenges ahead. We have lived through a covid period full of bans and restrictions, a period of shortages of electronic components and now a bloodthirsty Russian bear stomps behind us.

We managed this turbulent period thanks to an individual approach to each of your requests and also thanks to the new warehouse. Framework orders and gradual deliveries of goods according to requirements have proven very effective. Also, the work spent on atd-shop is slowly coming back to us. New customers from all over the world come to us regularly.

Thanks to our expertise, we can offer you technical support, propose equivalents and solutions. We also adapt product range to the requirements of your applications. Therefore, a large part of our products are customized types and products. We are expanding the offer of absorbers, thermally conductive materials, SMD DC/DC converters, UV varnishes, fuses, LED displays, integrated circuits, memories, power chokes, pig-tails...

We present the news on website, during customer visits and gradually offer them via the e-shop as well. Being relatively small company we are not afraid of new challenges and are willing to respond to your current as well as future demands.

I hope you continue to be satisfied with our services.

On behalf of ATD team,

Ing. Petr Jankovec - general manager



We produce according to **customer's requirement**.
Send us your drawing or dimensions and we will produce the desired header.



The "COSMIC" connectors used are based on standard series:
SM C02 1271 XX BD and SM C02 4835 XX BD

Schmid-M connectors point higher

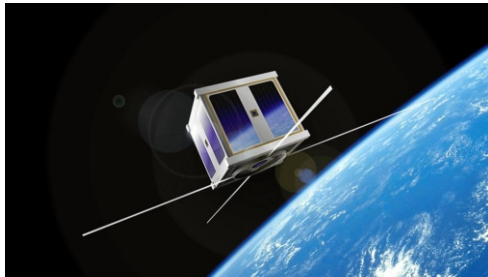

**SM C02 1271 08 BD; E=9,0;
without 2nd.pins; With Cap REEL**

SMD rail, pitch RM1,27, pin length E=9,0mm
unset second row. Connectors are supplied
on a reel with mounting cap.

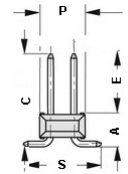

**Give us type of header, number of pins
and dimensions you need
and we will prepare a quotation for you.**

Header Single Row, Single Insulator, Straight

SM C02 1170 XX AS - 1,27mm

SM C02 6100 XX AS - 2,00mm

SM C02 2100 XX AS - 2,54mm

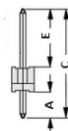

Header Single Row, Dual Insulators, Straight

SM C02 1170 XX ES - 1,27mm

SM C02 6100 XX ES - 2,00mm

SM C02 2100 XX ES - 2,54mm

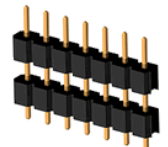
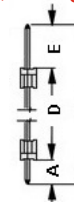

Header Dual Rows, Single Insulator, Straight

SM C02 1801 XX BS - 1,00mm

SM C02 1271 XX BS - 1,27mm

SM C02 6100 XX BS - 2,00mm

SM C02 2100 XX BS - 2,54mm

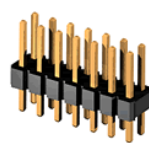
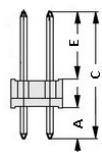

Header Dual Rows, Dual Insulators, Straight

SM C02 1804 XX FS - 1,00mm

SM C02 1274 XX FS - 1,27mm

SM C02 6200 XX FS - 2,00mm

SM C02 2200 XX FS - 2,54mm

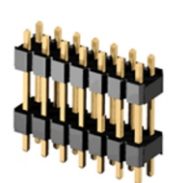
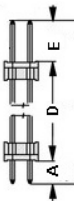

Header Single Row, Single Insulator Right Angle

SM C02 1170 XX AR - 1,27mm

SM C02 6100 XX AR - 2,00mm

SM C02 2100 XX AR - 2,54mm

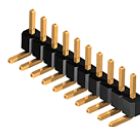
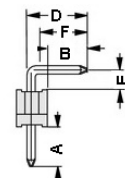

Header Dual Rows, Single Insulator Right Angle

SM C02 1174 XX BR - 1,27mm

SM C02 6200 XX BR - 2,00mm

SM C02 2200 XX BR - 2,54mm

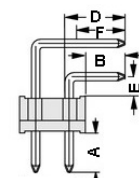

Header Triple Rows, Single Insulator, Straight

SM C02 6230 XX CS - 2,00mm

SM C02 1896 XX CS - 2,54mm

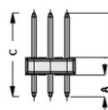

Header Triple Rows, Single Insulator, Right Angle

SM C02 6230 XX CR - 2,00mm

SM C02 1896 XX CR - 2,54mm

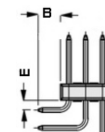

Header Dual Rows, Dual Insulators Right Angle

SM C02 1280 XX FR - 1,27mm

SM C02 6200 XX FR - 2,00mm

SM C02 2200 XX FR - 2,54mm

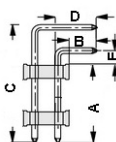

Header Single Row and Insulators SMT

SM C02 1170 XX AZ - 1,27mm

SM C02 6100 XX AZ - 2,00mm

SM C02 2100 XX AZ - 2,54mm

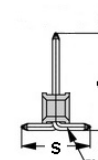

PIN Header



www.atd-shop.com

Header Single Row; Dual Insulators SMT

- SM C02 1170 XX EZ - 1,27mm
- SM C02 6100 XX EZ - 2,00mm
- SM C02 2100 XX EZ - 2,54mm

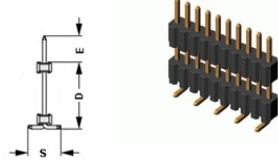

Header Dual Rows; Single Insulator SMT

- SM C02 1801 XX BD - 1,00mm
- SM C02 1271 XX BD - 1,27mm
- SM C02 6200 XX BD - 2,00mm
- SM C02 2200 XX BD - 2,54mm

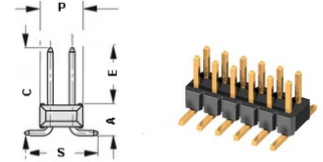

Header Dual Rows and Insulator SMT

- SM C02 1804 XX FD - 1,00mm
- SM C02 1274 XX FD - 1,27mm
- SM C02 6200 XX FD - 2,00mm
- SM C02 2200 XX FD - 2,54mm

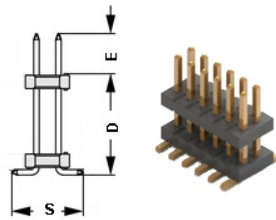

Female Header Single Row; Straight

- SM C02 4832 XX S - 1,27mm
- SM C02 6801 XX S - 2,00mm
- SM C02 2826 XX S - 2,54mm

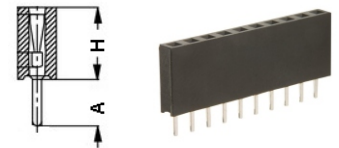

Female Header Single Row; Right Angle

- SM C02 4832 XX R - 1,27mm
- SM C02 6801 XX R - 2,00mm
- SM C02 2826 XX R - 2,54mm

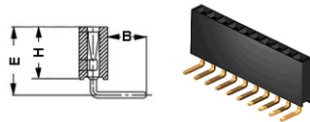

Female Header Dual Rows; Straight

- SM C02 4828 XX BS - 1,27mm
- SM C02 6801 XX BS - 2,00mm
- SM C02 2826 XX BS - 2,54mm

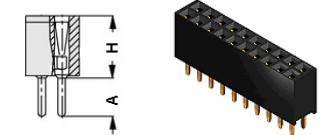

Female Header Dual Rows; Right Angle

- SM C02 4828 XX BR - 1,27mm
- SM C02 6801 XX BR - 2,00mm
- SM C02 2826 XX BR - 2,54mm

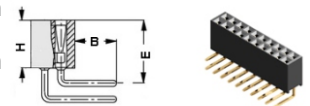

Female Header 2 Rows SMT

- SM C02 5910 XX BD - 0,8x1,2mm
- SM C02 5983 XX BD - 0,8x1,5mm
- SM C02 5812 XX BD - 1,0mm
- SM C02 4828 XX BD H - 1,27mm
- SM C02 4830 XX BD - 1,27x2,54mm
- SM C02 6804 XX BD - 2,00mm
- SM C02 6802 XX BD H - 2,00mm

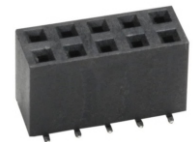

Female Header Single Row SMT

- SM C02 4832 XX A SMT - 1,27mm
- SM C02 6801 XX A Z SMT - 2,00mm
- SM C02 2823 XX A SMT - 2,54mm
standard: H=5,0mm
- SM C02 2826 XX A SMT - 2,54mm
standard: H=8,4mm

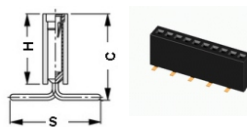

- SM C02 2818 XX BD H - 2,54mm
H=7,10mm other H=3,56; 5,0mm; 6,4mm; 8,4mm; 9,4mm

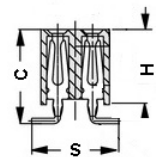

Female Header Side Entry Dual Rows

- SM C02 8178 XX B Z - 2,00mm
- SM C02 2813 XX B Z - 2,54mm



Header Dual Rows; Single Insulator SMT Dual Rows

- SM C02 2127 XX BH - 1,27mm
- SM C02 2154 XX BH - 2,00mm
- SM C02 2105 XX BH - 2,54mm

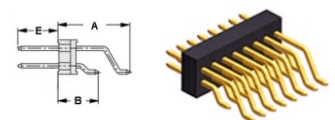

Socket Machined Pin

SM C07 0109 XX Black
Standard height insulator H=7

SM C07 0109 XX H=Y
Customer height insulator Y:3 - 9

SM C07 0109 XX D
Standard height insulator H:7

SM C07 0109 XX D H=Y
Customer height insulator Y:3-9

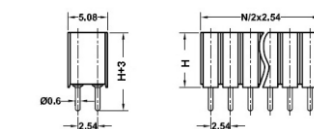
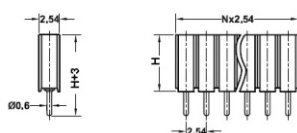
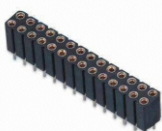

SM C07 0109 XX SMT D
Standard height insulator H:7

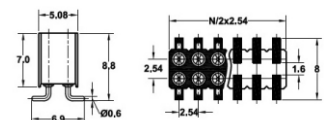
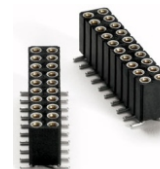

Box Header



Box Header Straight

- SM C02 3506 XX S**
(Pitch: 1,27x1,27mm)
- SM C02 3503 XX S**
(Pitch: 1,27x2,54mm)
- SM C02 9510 XX S**
(Pitch: 2,00mm)
- SM C02 3510 XX S**
(Pitch: 2,54mm)



Box Header Right Angle

- SM C02 3506 XX R**
(Pitch: 1,27x1,27mm)
- SM C02 3503 XX R**
(Pitch: 1,27x2,54mm)
- SM C02 9510 XX R**
(Pitch: 2,00mm)
- SM C02 3510 XX R**
(Pitch: 2,54mm)



Box Header SMT

- SM C02 3506 XX D**
(Pitch: 1,27x1,27mm)
- SM C02 3503 XX D**
(Pitch: 1,27x2,54mm)
- SM C02 9510 XX D**
(Pitch: 2,00mm)
- SM C02 3510 XX D**
(Pitch: 2,54mm)



Female Straight with Bump

- SM C02 6806 XX**
(Pitch: 2,00mm)
H=4,0mm
- SM C02 6807 XX S**
(Pitch: 2,00mm)
- SM C02 2811 XX**
(Pitch: 2,54mm)
- SM C02 2817 XX S**
(Pitch: 2,54mm)

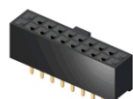

DIP Plug IDC

- SM C02 3006 XX**
(Pitch: 1,27x1,27mm)
- SM C02 3100 XX A**
(Pitch: 2,54mm)
- SM C02 3100 XX B**
(Pitch: 2,54mm)



IDC Socket with Strain Relief

- SM C02 3007 XX C**
(Pitch: 1,27x1,27mm)
- SM C02 3009 XX C**
(Pitch: 1,27x2,54mm)
- SM C02 9200 XX C**
(Pitch: 2,00mm)
- SM C02 3001 XX C**
(Pitch: 2,54mm)



Micro-Match board-cable connectors

www.atd-shop.com/qx22P-en/micro-match-connectors

- SM C02 3128 XX YF SM C02 3129 XX YF SM C02 3130 XX Y SM C02 3135 XX Y SM C02 3131 XX YF SM C02 3133 XX SM C02 3132 XX Y



RJ Connectors

We offer RJ45 connectors from the following manufacturers: Schmid-M, Molex, TE Connectivity, WE, Pulse...
Tell us which connectors you are buying and we will be happy to prepare an offer.

- SM C04 0060 XX 0060 SM C04 0060 88 DA SM C04 0060 88 HA SM C04 0060 88 AA SM C04 0060 88 HN SM C04 5A15AEG2 SM C04 2A17JHG2
The most popular types with transformer



USB Connectors

- SM C04 8446 04 A SM C04 8317 04 SM C04 8335 04 A SM C04 8323 04 AFV SM C04 8367 05 B SM C04 8362 05 BF SM C04 1024 03 FAR
USB A, SMT Angle USB A, THT USB A, SMD, black USB A, vertical Micro USB B, SMT Micro USB B, vertical USB-C 3.1, SMT

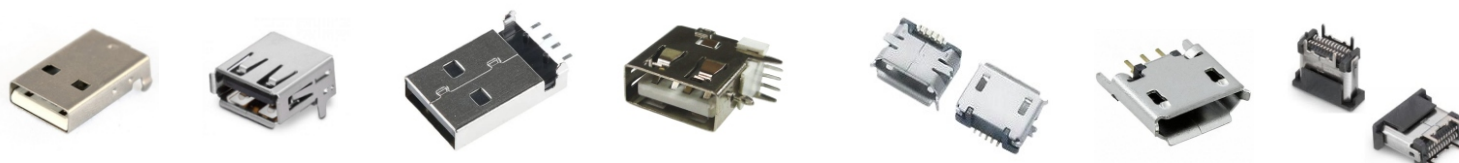

www.atd-shop.com/qx24-en/connectors-for-data-transmission

Circular Connectors



www.atd-shop.com

M8 & M12

Female Straight
(Cable length 2m or 5m, PVC or PUR)

Female Angled

Male Straight

Male Angled



SM C10 BF12-S44N0-02
SM C10 BF12-S55N0-02
SM C10 BF12-S88N0-02
SM C10 BF12-S12N0-02

SM C10 BF12-R44N0-02
SM C10 BF12-R55N0-02
SM C10 BF12-R88N0-02
SM C10 BF12-R12N0-02

SM C10 BM12-S44N0-02
SM C10 BM12-S55N0-02
SM C10 BM12-S12N0-02

SM C10 BM12-R44N0-02
SM C10 BM12-R55N0-02

SM C10 NM12-S4IP0-BLK

Part Numbering System

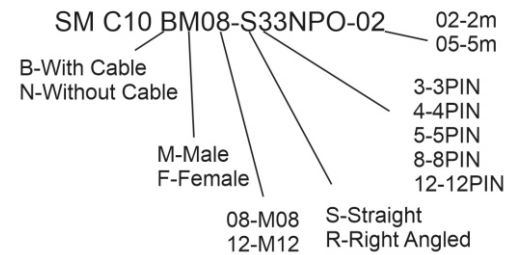

99-3732-201-04 99-3731-202-04 99-3442-458-05 99-0413-10-05



CHOGORI®

Circular connectors

CHO 22 002 1 1 1 - 01 - 001

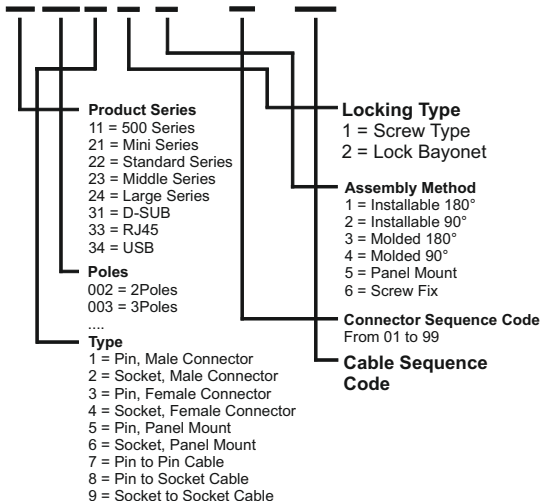

CHO21005221-01 Mini female 5pin CHO21005525-03 Mini male 5pin CHO24309535-01 Large 3+9 CHO 24309231-02 Large 3+9



CHO22004635-03 Standard female 4pin CHO2204131-01 Standard male 4pin CHO33000000-04 RJ45 IP68 bayonet CHO33000000-10 RJ45 IP68 screw



CHO 34000000-03 USB CHO 33000000-04 CHO33000000-03 CHO 34000000-01



AUDIO Connectors

SM C08 GCD002
d-6,3mm
L1-31mm; L-95mm

SM C08 GCD046
d-6,3mm
L1-31mm; L-83mm

SM C08 GCD202
M8; h-34,5mm

SM C08 GCE103-4P

SM C08 GCE018-4P

Lumberg DIN 0123 05
Lumberg DIN 0107 05



www.atd-elektronik.cz/chogori.html



D-Sub Connectors
D-Sub Hoods
I/O Connectors
Bus Connectors

Deltron offers a wide range of different connectors, electronic- and electromechanical components.



D-Sub Connectors

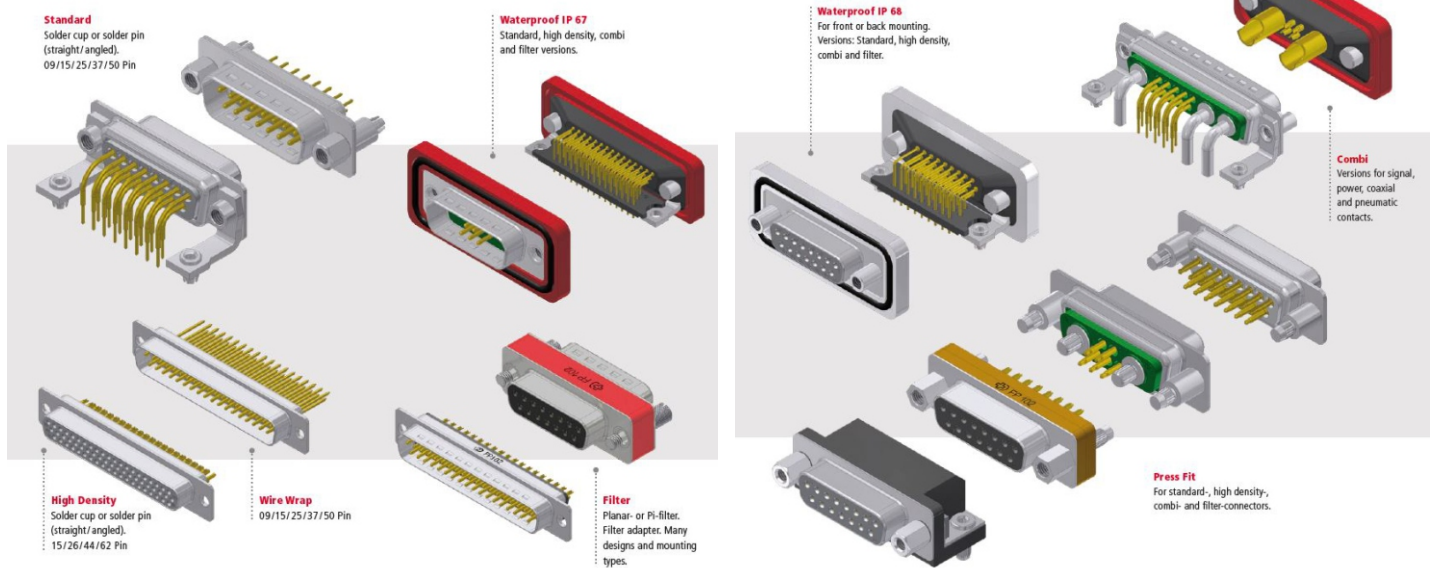

Series DMVZK-SL

Shell Sizes: 9 & 15
Standard material: Zink
Termination: Shield clamp



Series DSZK-SL

Shell Sizes: 9 & 15
Standard material: Zink
Termination: Shield clamp

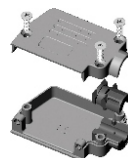

Series DSK-SL

Shell Sizes: 9, 15, 25 & 37
Standard material: Polycarbonate
Termination: Shield crimp



Series DTK/DSK-SL

Shell Sizes: 9, 15, 25 & 37
Standard material: Polycarbonate



Series DTPMK

Shell Sizes: 9, 15, 25 & 37
Metallized ABS-plastic
Termination: Shield clamp



Series DVPMK

Shell Sizes: 9, 15, 25 & 37
Metallized ABS-plastic
Termination: Shield clamp



Series DTZK

Shell Sizes: 9, 15, 25 & 37
Standard material: Zink
Termination: Shield clamp



Series DVZK

Shell Sizes: 9, 15, 25, 37 & 50
Standard material: Zink
Termination: Shield clamp



Series DSZK

Shell Sizes: 9 & 15
Standard material: Zink
Termination: Shield clamp



Push-pull Connectors



www.atd-shop.com



Series K - Outdoor



MAIN FEATURES:

1. Security of the push –pull self-latching system
2. Multipole types 2 to 30 contacts
3. Solder or PCB contacts (straight or elbow)
4. High Packing density for space saving
5. Multiple key options to avoid cross mating of similar connectors
6. Keying system (G key standard) for connector alignment
7. 360° screening for full EMC shielding

T1 Plug staight

Series: 00B, 0B, 1B,2B,3B



T2 Plug fixed

00B, 0B, 1B,2B,3B



T3 Plug elbow 90°

00B, 0B, 1B, 2B, 3B



T4 Plug Lanyard

0B, 1B, 2B, 3B



T6 Plug sealed

0B, 1B, 2B, 3B



T9 Plug nut fixing

0B, 1B, 2B



Z1 Socket front panel

Series: 00B, 0B, 1B,2B,3B



Z2 Socket

0B, 1B,2B,3B



Z3 Socket back panel

00B, 0B, 1B, 2B, 3B



Z4 Socket free

00B, 0B, 1B, 2B, 3B



Z6 Socket

0B, 1B, 2B



Z12 Socket

0B, 1B,



Series T MIL -DTL-26482



Series Triaxial



Series B



Series P



M series connectors

are lightweight triple-start ratchet coupling type connectors designed for avionics, aerospace, military, security, motorsport and heavy duty applications.



- Various sizes & configurations providing maximum rated current ranging from 140A to 430A
- 360° screening for full EMC shielding
- Wide temperature range -55°C to 200°C
- High shock and vibration resistance
- Sealed to IP68 mated; IP68 unmated as options
- Tested to MIL Standards (MIL-STD-810F)

- Broad range of lightweight aluminium shell models
- Oil and fuel resistant
- Scoop proof & IP2X finger protection
- Threaded option for MIL-DTL-38999M backshell

Colibri®

High Speed up to 25+ Gbps



Colibri® is a shielded, two-row SMT connector system with a pitch of 0.5 mm, which is especially suitable for applications with high data transmission rates. The product is available in different speeds, starting at 10 Gbps through 16 Gbps and up to 25 Gbps in the highest configuration. In addition to the available pin counts of 40, 80, 120 and 160, the versions with 220 and 440 contacts are primarily used for the now widespread COM Express® applications.

Part Number Key

Type 401 Plug 402 Receptacle	b-t-b distance 51 Plug 5 mm 51 Receptacle 55 Plug 8 mm	Pick & place cap 0 without pick & place cap 5 with pick & place cap (Plug only)	Optional tray packaging 220p and 440p only
---	--	--	--

Coating
51 Standard version
52 Heavy Au

Standard version
1 220p
3 160p
4 120p
5 440p
6 80p
7 40p

Variant
1 Standard version
3 16+ plug only
4 25+ plug only

VP1

		Plug		Receptacle	
Pins	Data transfer rate		Part number		Part number
40	10+		401-51701-51		402-51701-51
	16+		401-51703-51		
80	10+		401-51601-51		402-51701-51
	16+		401-51603-51		
120	10+		401-51401-51		402-51701-51
	16+		401-51403-51		
160	10+		401-51301-51		402-51701-51
	16+		401-51303-51		
220	10+		401-51101-51		402-51101-51
	16+		401-51103-51		
	25+		401-51104-51		

One27

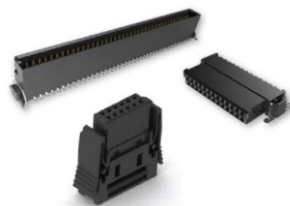

The One27® range offers a high level of flexibility and at the same time reliable connectors for a number of board-to-board applications. The product family is based on a pitch of 1.27 mm, offers both straight and angled types as well as connections with ribbon cable, and is available in pin counts from 12 to 80 pins. Number of pins: 12, 16, 20, 26, 32, 40, 50, 68 and 80.

	Female		Male	
Pairing	low	Part number	low	Part number
A	low	414-520NN-51	low	413-520NN-51
B	low	414-520NN-51	mid	413-530NN-51
C	low	414-520NN-51	high	403-540NN-51
D	mid	414-530NN-51	low	413-520NN-51
E	mid	414-530NN-51	mid	413-530NN-51
F	mid	414-530NN-51	high	403-540NN-51
G	high	404-540NN-51	low	413-520NN-51
H	high	404-540NN-51	mid	413-530NN-51
I	high	404-540NN-51	high	403-540NN-51

	Female		Male	
Pairing 90°	low	Part number	90°	Part number
A	low	414-520NN-51	90°	403-510NN-51
B	90°	404-510NN-51	low	413-520NN-51
C	mid	414-530NN-51	90°	403-510NN-51
D	90°	404-510NN-51	mid	413-530NN-51
E	90°	404-510NN-51	high	403-540NN-51
F	high	404-540NN-51	90°	403-510NN-51

Pairing horizontal	Part number	Part number
Horizontal 15.65 - 17.15 mm	90° 404-510NN-51	90° 403-510NN-51

One27 IDC Pre-Assembled with Cable

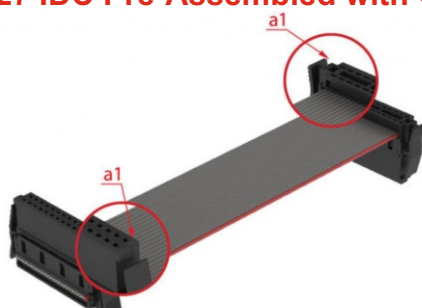

Part Number Key for Cable Assembly

Cable type 61 PVC 62 High temperature 66 Halogen-free	Cable length in mm from 30 to 999 mm i.e. 080 = 80 mm 660 = 660 mm
---	--

4 0 4 - **XX** **NN** - **LLL** - **CCC** - 1

12, 16, 20, 26, 32, 40, 50, 68, 80
Pins

See next page

Zero8 and EC.8

Zero8

- up to 16 Gbps
- 12, 20, 32, 52 and 80 contacts
- 1.7 A current carrying capacity
- 500 mating cycles
- Maximized contact reliability
- Optimized mating protection
- Packaged in tape & reel
- Board-to-Board from 6 to 21 mm
- Parallel and right-angled connections
- Shielded and unshielded versions

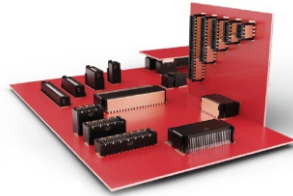

Part Number Key

Type	Profile	Shielding
405 Plug	51 Angled	0 unshielded for A01
406 Socket	52 Low	1 shielded
	53 Mid	2 unshielded
	54 High	
	55 X-High Plug only	

XXX - XX X NN - 5 1

12, 20, 32, 52, 80 Pins

Pairing	Plug straight			Socket straight		
	Profile	Part number	Part number	Profile	Part number	Part number
A	Low	405-52XNN-51	406-52XNN-51	Low	406-52XNN-51	406-52XNN-51
B	Mid	405-53XNN-51	406-52XNN-51	Low	406-52XNN-51	406-52XNN-51
C	Low	405-52XNN-51	406-53XNN-51	Mid	406-53XNN-51	406-53XNN-51
D	Mid	405-53XNN-51	406-53XNN-51	Mid	406-53XNN-51	406-53XNN-51
E	High	405-54XNN-51	406-52XNN-51	Low	406-52XNN-51	406-52XNN-51
E	Low	405-52XNN-51	406-54XNN-51	High	406-54XNN-51	406-54XNN-51
F	X-High	405-55XNN-51	406-52XNN-51	Low	406-52XNN-51	406-52XNN-51
F	Mid	405-53XNN-51	406-54XNN-51	High	406-54XNN-51	406-54XNN-51
G	High	405-54XNN-51	406-53XNN-51	Mid	406-53XNN-51	406-53XNN-51
H	X-High	405-55XNN-51	406-53XNN-51	Mid	406-53XNN-51	406-53XNN-51
I	High	405-54XNN-51	406-54XNN-51	High	406-54XNN-51	406-54XNN-51
J	X-High	405-55XNN-51	406-54XNN-51	High	406-54XNN-51	406-54XNN-51

Pairing	Unshielded					
	Profile	Part number	Part number	Profile	Part number	Part number
A	Low	405-52XNN-51	406-51XNN-51	90°	406-51XNN-51	406-51XNN-51
C	Mid	405-53XNN-51	406-51XNN-51	90°	406-51XNN-51	406-51XNN-51
E	High	405-54XNN-51	406-51XNN-51	90°	406-51XNN-51	406-51XNN-51
G	X-High	405-55XNN-51	406-51XNN-51	90°	406-51XNN-51	406-51XNN-51
Pairing	Shielded					
	Profile	Part number	Part number	Profile	Part number	Part number
B	Low	405-521NN-51	406-511NN-51	90°	406-511NN-51	406-511NN-51
D	Mid	405-531NN-51	406-511NN-51	90°	406-511NN-51	406-511NN-51
F	High	405-541NN-51	406-511NN-51	90°	406-511NN-51	406-511NN-51
H	X-High	405-551NN-51	406-511NN-51	90°	406-511NN-51	406-511NN-51
Pairing	Plug angled unshielded			Socket angled unshielded		
	Profile	Part number	Part number	Profile	Part number	Part number
I	90°	405-51XNN-51	406-51XNN-51	90°	406-51XNN-51	406-51XNN-51
Pairing	Plug angled shielded			Socket angled shielded		
	Profile	Part number	Part number	Profile	Part number	Part number
J	90°	405-511NN-51	406-511NN-51	90°	406-511NN-51	406-511NN-51

EC.8 - 0.8 mm SMT Edge Card Connector



- edge card connector
- 20 to 200 pins
- 28 Gbps transfer rate
- 3.2 A operational current
- 500 mating cycles
- packed in Tape & Reel, Tray
- 1.60 mm edge card thickness

Edge Card Connector (without key)



Edge Card Connector - Performance Level I

Number of pins	Part number	PU (Tape & Reel)
20	408-52020-000-11	250
40	408-52040-000-11	
60	408-52060-000-11	

Edge Card Connector (with key)



Edge Card Connector - Performance Level I

Number of pins	Part number	PU (Tape & Reel)
60	408-52060-100-11	250
80	408-52080-100-11	
100	408-52100-100-11	
120	408-52120-100-11	
140	408-52140-100-11	

Number of pins	Part number	PU (Tray)
160	408-52160-100-12	90
180	408-52180-100-12	
200	408-52200-100-12	
	408-52200-103-12 (strengthened element along insulator)	

Connectors DIN 41612/IEC 60603-2

With 1000+ employees and a global network of own production facilities EPT as a family owned company offers you highest quality standards and reliability for your BtB project - all from one source.

Signal Connectors up to 1,5 A : Type B, Type C, Type M, Type Q, Type R
 Power Connectors up to 5,6 A : Type D, Type E, Type F, Type G
 Signal Connectors up to 15 A : Type H11, Type H15, Type H7/F24



DIN 41612 THTR

High Temp Connectors allow

One Step Reflow Solder Process

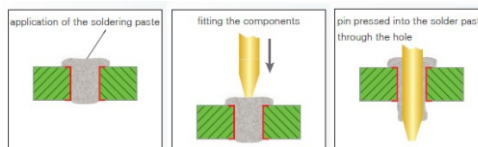

Type	max. no. of contacts	Termination	Type	max. no. of contacts	Termination
B	B, B/2, B/3 Male	64 / 32 / 20	E Male	48	solder
	B, B/2, B/3 Female	64 / 32 / 20	E Female	48	Press-fit, solder
	B IDC	64	F Male	48	solder, THTR
C	C, C/2, C/3 Male	96 / 48 / 30	F, F low profile Female	48	Press-fit, solder
	C, C/2, C/3 Female	96 / 48 / 30	G Male	64	solder
	C IDC	96	G, G low profile Female	64	Press-fit, solder
M	M Male	78	H11 Male	11	solder
	M, M/2, M/3 Female	78 / 30 / 12	H11, H11 low profile Female	11	Faston, solder
Q	Q, Q/2 Male	64 / 32	H15 Male	15	solder
R	R, R/2, R/3 Male	96 / 48 / 30	H15, H15 low profile Female	15	Faston, solder
	R, R/2, R/3 Female	96 / 48 / 30	H7/F24 Male	7+24	solder
D	D Male	32	VMEx Female	160	Press-fit
	D Female	32	Schalter	96	Press-fit

Connectors DIN 41612/IEC 60603-2 and much more on atd-shop

You can find out immediately in our e-shop:

- The real-time available / reserved quantity of the stock.
- Price / quantity breaks
- Technical details / drawing
- Related commodity

www.atd-shop.com/qx221/konektory-deska-deska

DIN connector: 103-80004



EPT: DIN connector: 103-80004 DIN 41612 C/3 Male 90° Solder RM2.54mm: 30pin, Termination length L=3,00mm SPQ :54pcs - ERNI 424189 - Harting 09251306921

Price (net of VAT) / ks		1,2960 EUR
QUANTITY RABATS		54
1 - 99 ks	1,2960 EUR net of VAT/ks	
100 - 499 ks	1,1300 EUR net of VAT/ks	
500 - 999 ks	1,0440 EUR net of VAT/ks	
More than 999 ks	0,9440 EUR net of VAT/ks	

Description Related commodity Appendices

EPT: DIN connector: 103-80004 - ERNI 424189 - Harting 09251306921; DIN 41612 C/3/IEC60603-2; Performance level II (400 mating cycles); Female contacts double sided

Store name	Availability	Of which reserved	Price (net of VAT)	
ATD hlavní sklad	1 956	1 690	1,2960 EUR	54

Connectors DIN 41612/IEC 60603-2 Press-fit Technology with Tcom press®

As „One-Stop-Supplier“ EPT offers you long time experience in pressfit technology of more than 25 years. ept's comprehensive knowledge and experience offer a great foundation for the development of cost-optimized connector products - from development including the building of prototypes, over manufacturing of equipment and tools, up to serial production.



Press-fit Machines and Tools

As a perfect addition ept offers competent support for the processing of press-fit connectors on PCB. In addition to a wide spectrum of press-fit machines and tools we offer the development and execution of customized machines and equipment.



HM 2.0 - IEC 61076-4-101

High Contact Density The hm 2.0 series of hard metric connectors was developed in accordance with the international IEC 61076-4-101 standard. These shielded connectors have a pitch of 2 mm and are suitable for applications that require high contact density and reliability.

typ A

typ B25

typ B22

typ N

typ AB25



RF Connectors, Cables, Antennas



Our company has over 30 years of experience in the sale of high-frequency connectors. If you have problems with the delivery of a specific type, we will be happy to offer you an equivalent type.



All these connectors can be found in our www.atd-shop.cz

SMA-5113 SMA-5102 SMA-5202 SMA-1249 SMA-5201 SMA-5203 SMA-5204 SMA-52058 SMA-5205



SMB-5206 SMB-5102 SMB-5204 SMB75-5201 SMB-5205 MCX-5111 MCX-5203 MCX-5205 MCX-5206



Coaxial Connector: SMA-5202J-TGG
Schmid-M: SMA-5202J; TGG RF Coaxial Connector SMA Female/Jack PCB Mount - Rosenberger 32K201-400L5 - ...



Availability: 5 701 ks
Of which reserved: 200 ks
(Reservation can be cancelled upon agreement)
1,0650 EUR net of VAT / ks

RF connector U.FL: Schmid-M: U.FL-5101_PGB
Schmid-M: RF connector U.FL: Schmid-M: U.FL-5101 PCB Serie U.FL (UMCC) Connector Receptacle, Male Pin ...

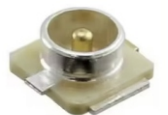

Availability: 25 000 ks
Of which reserved: 25 000 ks
(Reservation can be cancelled upon agreement)
0,2391 EUR net of VAT

Cable Assemblies: Connector UFL + Cable 1.13 mm
Schmid-M: Cable Assemblies: Connector UFL + Cable 1.13 mm - Cable Length 30mm+3mm strip end 1+1.5+22mm



Availability: 18 000 ks
Of which reserved: 18 000 ks
(Reservation can be cancelled upon agreement)
0,6300 EUR net of VAT / ks

We have the best prices for pigtails

Write us what type you need - connector type and cable type and length - and we will prepare a non-binding offer.

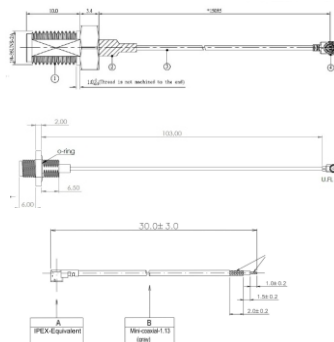

Terminal block



www.atd-shop.com



PCB Terminal Block

Pitch: YY: 25=2,50 mm; 35=3,50 mm; 38=3,81 mm; 39=3,96 mm
50=5,00 mm; 58=5,08 mm; 75=7,50 mm; 76=7,62 mm

SM C09 1507 XX SS4 SM C09 135381 XX SS4-B SM C09 3252 XX SC1Y SM C09 3258 XX SC1 SM C09 35012 XX SC4 SM C09 35014 XX VC1

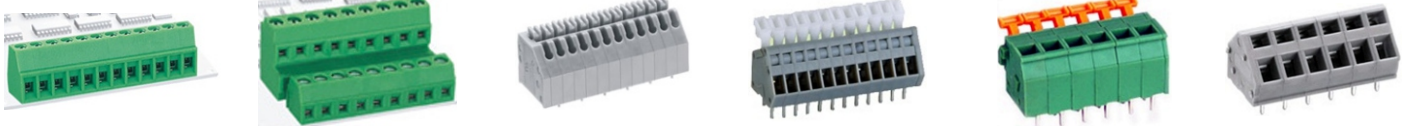

Pluggable Terminal Block

SM C09 0YY3 SOC SM C09 0YY2 ROC SM C09 0YY5 YOC SM C09 0YY8 SSC SM C09 0YY2 RNC SM C09 0YY1 CSC

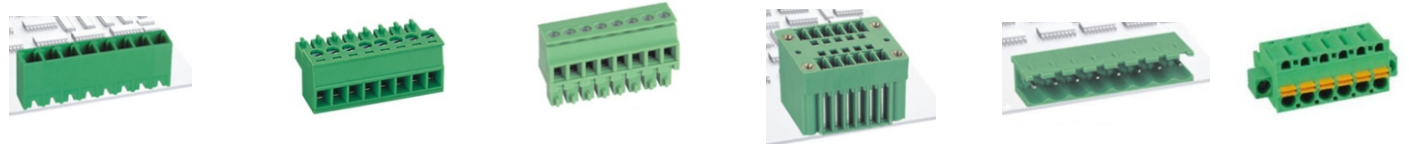

SM C09 0YY1COC SM C09 0YY8 SOC SM C09 0YY9 SSC SM C09 0YY14 YOC SM C09 0YY13 WSC SM C09 0YYP SOC

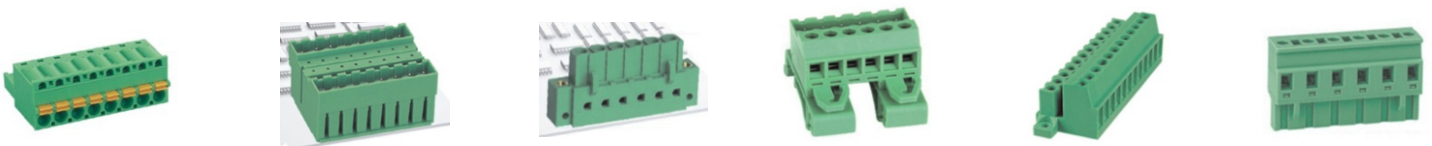

Transformer Terminal Block

SM C09 71918 01 SM C09 71215 01 SM C09 77512 XX SM C09 71917 01 SM C09 77510 XX SM C09 77514 XX
Pitch: 13,00mm Pitch: 12,50mm Pitch: 7,50mm Pitch: 19,00mm Pitch: 7,5mm Pitch: 7,50mm
750V/57A 4,0-10,00mm² 250V/24A 0,50-4,00mm² 250V/24A 0,50-2,50mm² 750V/57A 4,00-10,00mm² 2750V/32A 0,50-4,00mm² 450V/32A 0,50-4,00mm²

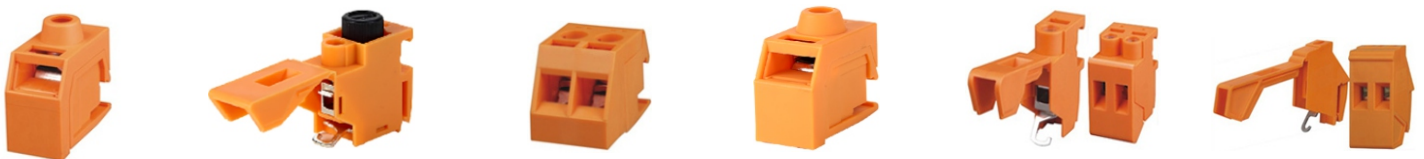

DIN Rail Terminal Block and other

SM C09 WS-DB SM C09 WS SM C09 WS-TW-PE SM C09 WS-SD SM C09 UK-PE SM C09 UK-TW
Wire Size: 4mm² Wire Size: 1.5 / 2.5 / 4 / Wire Size: 1.5 / 2.5 / 4 / Wire Size: 1.5 / 2.5 / 4 / Wire Size: 1.5 / 2.5 / 4 / 6 Wire Size:
800V/6.3A 6 / 10 / 16 mm² 6 / 10 / 16 mm² 6 / 10 / 16 mm² 10 / 16 / 35 / 50 / 95mm² 2.5 / 4 / 6mm²

Single Entry



SM C09 711512 XX Cer SM C09 71020 03 1 SM C09 71023 02 SM C09 710210 XX SM C09 710425 XX
Pitch: 11,50mm Pitch: 10,00mm Pitch: 10,00mm Pitch: 8,00; 10,00; 12,00mm Current: 25A; Wire Size: 2,5mm²
450V/24A 4,00mm² 300V/15A 0,50-4,00mm² 300V/10A-4,00mm² 13,50; 14,50; 16,50mm 3P/4P/5P/6P/8P/10P/12P



Press-Fit Elements

 PRESS-FIT RA-FPU 1. 08. 2018 PCB Connection for fixing cable lugs d-5,2mm-10,2mm	 PRESS-FIT IT-FP 31. 07. 2018 The cable and fuse can be fixed on PCB.
 PRESS-FIT RA-FPB PCB Connection for fixing cable lugs M3-M10, d-3,2mm-10,2mm	 PRESS-FIT IT-C2 31. 07. 2018 The cable and fuse can be fixed on PCB.
 PRESS-FIT RA-TRB 1. 08. 2018 PCB Connection for fixing cable lugs M3-M10, d-3,2mm-10,2mm	 PRESS-FIT IT-C 31. 07. 2018 The cable and fuse can be fixed on PCB.
 PRESS-FIT RA-TRA 1. 08. 2018 PCB Connection for fixing cable lugs M3-M8, d-3,2mm-8,2mm	 PRESS-FIT IT-TRB 31. 07. 2018 The cable and fuse can be fixed on PCB.
 PRESS-FIT ET-FP 31. 07. 2018 The cable and fuse can be fixed on PCB.	 PRESS-FIT IT-TRT 31. 07. 2018 The cable and fuse can be fixed on PCB.

SMD Elements

 Surface-Mount Device SMD-RAP 3. 08. 2018 For soldering in SMT, Blistered for fully automated assembly.	 Surface-Mount Device SMD-FT 3. 08. 2018 For soldering in SMT, Blistered for fully automated assembly.
 Surface-Mount Device SMD-RA 3. 08. 2018 For soldering in SMT, Blistered for fully automated assembly.	 Surface-Mount Device SMD-IBTP 3. 08. 2018 For soldering in SMT, Blistered for fully automated assembly.
 Surface-Mount Device SMD-FTT 3. 08. 2018 For soldering in SMT, Blistered for fully automated assembly.	 Surface-Mount Device SMD-IBT 3. 08. 2018 For soldering in SMT, Blistered for fully automated assembly.
 Surface-Mount Device SMD-ITT 3. 08. 2018 For soldering in SMT, Blistered for fully automated assembly.	 Surface-Mount Device SMD-ETP 3. 08. 2018 For soldering in SMT, Blistered for fully automated assembly.
 Surface-Mount Device SMD-FTP 3. 08. 2018 For soldering in SMT, Blistered for fully automated assembly.	 Surface-Mount Device SMD-ET 3. 08. 2018 For soldering in SMT, Blistered for fully automated assembly.

Two Part Power Elements

 PRESS-FIT TWO PART-TP-SERE Two-Part, Male Thread.	 PRESS-FIT TWO PART-TP-SERI Two-Part, Female Thread.
 PRESS-FIT TWO PART-TP-SESH Two-Part, Female Through-Hole.	 PRESS-FIT TWO PART-TP-GECC Two-Part, Base-Part, Two-Row-Pin population.
 PRESS-FIT TWO PART-TP-SESI Two-Part, Male Thread.	 PRESS-FIT TWO PART-TP-GET Two-Part, Base-Part, Two-Row-Pin population.

THR Elements

 PRESS-FIT TWO PART-TP-SERH Two-Part, Female Thread.	 THROUGH-HOLE REFLOW THR-EH Solderable high current Wire-to-Board connections with a focus on automated assembly.
 PRESS-FIT TWO PART-TP-SESE Two-Part, Female Thread.	 THROUGH-HOLE REFLOW THR-IBT Solderable high current Wire-to-Board connections with a focus on automated assembly.
	 THROUGH-HOLE REFLOW THR-IHT Solderable high current Wire-to-Board connections with a focus on automated assembly.

www.atd-shop.com/qx232-en/fastons-cable-eye-and-power-elements

Spacer

Brass, Stainless Steel, Plastic, SMD

SW4, SW4,7 ,SW5, SW5,5, SW6, SW7, SW8, SW10, SW13 M2, M2,5, M3, M4, M5, M6, M8, UNC4-40



Crimp Contacts



Receptacles 2.8 mm	Receptacles 4.8 mm	Receptacles 6.3 mm	Receptacles 9.5 mm	S-LOCK 6.35	S-CON 5.08

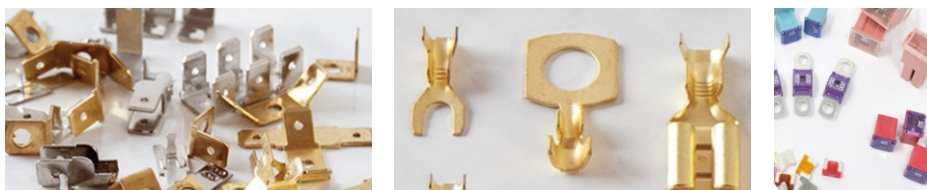

best prices

Fuses

SMD, Photovoltaics, DC voltage.....

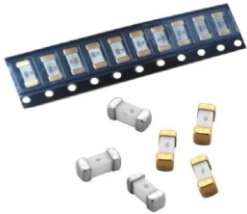

- Wide range of voltage rating (125V /250V /300V)
- Wide range of current rating (50 mA-15A)
- Excellent environmental integrity
- Operating temperature range -55°C to+ 120°C

Littelfuse, ESKA, Schurter, Panasonic, Siba, Schmid-M, Vogt....

Series slow-blow square Surface Mount fuses are ceramic tube/ end cap constructions, RoHS compliant, Halogen Free and lead-free, with U.S. (UL/CSA) safety agency approvals. Provide board level primary and secondary circuit protection in a wide variety of applications, end caps are available in copper or silver plated.

How to order: SM FUSE XXX YYYY
 XXX: SET / SST / STE
 YYYY : Current in mA

Ampere Rating	% of current Rating	Blowing Time
0.05A-15A	100%	>4hours
0.05A-15A	200%	<120sec



Cables

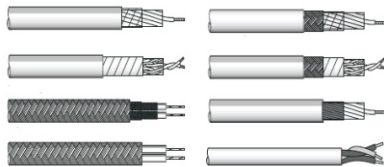

XtraBASIC-Litze UL/CSA/HAR/MTW
 Style 1015-600V/10269-1000V - 105°C AWM TEW



Wall thickness: 0,76 mm
 Temperature range static: -40 to 105 °C
 Temperature range moved: -10 to 105 °C
 static bending radius: 6,0 x outer diameter
 Bending radius dynamic: 10,0 x outer diameter

M-FLEX - OZ	0,50-2,50	2-7	-5°C - +70°C	300/500V
M-FLEX - JZ	0,50-6,00	3-40	-5°C - +70°C	300/500V
M-FLEX - OB/JB	0,50-2,50	2-5	-5°C - +70°C	300/500V
H03VV...-F	0,50-2,50	2-5	-5°C - +70°C	300/500V
H05VV5-F	0,75-2,50	3-18	-5°C - +70°C	300/500V
H05BQ-F	0,75; 1,00	2-5	-35°C - +80°C	300/500-2000V
H07BQ-F	1,50; 2,50	2-5	-35°C - +80°C	450/750-2000V
SIHF	0,50-2,50	2-5	-60°C - +180°C	300/500V
H05RR(N)-F	0,75-1,50	2-5	-30°C - +60°C	300/500-2000V
H07RN-F	1,00-10,00	2-5	-30°C - +60°C	300/500-2000V
Power-PUR	0,10; 0,15	2-12	-40°C - +90°C	max.300V
LIHH	0,14-0,50	2-61	-15°C - +80°C	250V
LIHCH	0,14-0,75	1-50	-15°C - +80°C	250V
1000°C	0,50-4,00	3	do cca 1000°C	300/500V
J/K/L 350°C/450°C	0,22; 0,50	2	-60°C -+350 / 450°C	
J/K/L 1000°C	0,50; 0,80	2	-60 - +1000°C	

XtraHEAT SIF/VE - UL/cUL Style 3672



Wall thickness: 0,60 mm
 Temperature range static: -40 to 180 °C
 Temperature range moved: -40 to 180 °C
 static bending radius: 5,0 x outer diameter

XtraPOWER UL/SJT - HAR/H05V2V2-F



Wall thickness:0,80 mm
 Temperature range static:-20 to 105 °C
 static bending radius: 10,0 x outer diameter

Cable harness protector

KF--GJH-M
 Stainless Steel - Two Male Fitting - 1/2" ~ 2"



MX-FAB

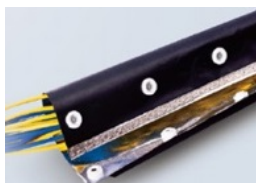

MX-TEB



MX-MP



MX-CBP

Part No.	Width (mm)	Applicable Range (mm)	Packing (M/R)	Picture
MX-CBP-006	6	3-9	500	
MX-CBP-008	8	5-12	300	
MX-CBP-010	10	7-15	300	
MX-CBP-012	12	8-18	300	
MX-CBP-014	14	10-20	300	
MX-CBP-016	16	12-22	300	
MX-CBP-019	19	14-25	300	
MX-CBP-025	25	18-30	200	
MX-CBP-028	28	20-35	200	
MX-CBP-032	32	25-40	200	

Plastic boxes & Piezo components



www.atd-shop.com

Plastic boxes

MODULAR instrument boxes
H=35, 48, 53 and 68mm , 1, 2, 3, 6, 9 unit

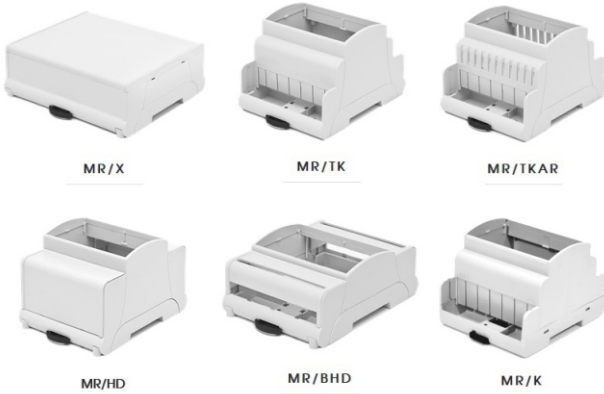

PCB Support
mini 72..68mm, baby 43mm,
Euro 108..100. DLM..DLA 72..68mm

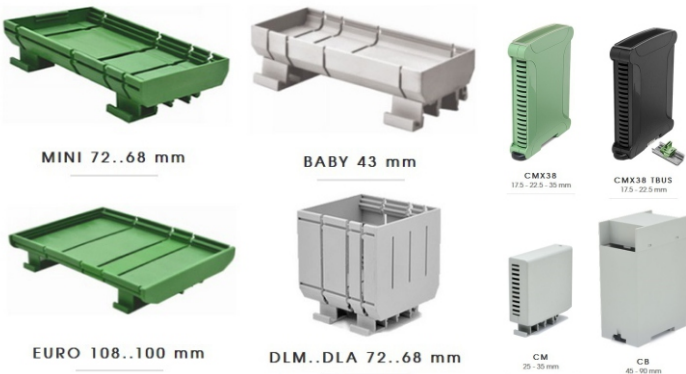

Building Automation - DOMOTICS
H=18, 25, 35, 38,53 and 90mm
Dimension 44x44, 76x76, 112x76, and more



In Stock

STC 130 128x81x16mm STC90 92x81x25mm MR3/CB 52,5x90x55,8mm CM36/30V



Piezo Buzzer

SM 7525 SMT 7,5x7,5x2,5mm,3,6V SM SP KPB 1220 d12h8mm 90dB 1,5V SM SBPT1707 d16,8 80dB 30V SM SBPT4414WE d44mm 82dB 12V SMA-13-P7,5 1,5~24VDC 75dB SMA-24L P15 1,5~15V 92dB SAP-1302-A-W



Piezo Elements

ST-15T-6.5A1 15mm 6,5kHz 30V ST-27T-4.4A1 27mm 4,4kHz 30V



Speaker

Speaker SBF36-5T d36mm 91dB 80hm TE-300_1 91dB, 150W



Microphone

SM M9745 SM M 4013-3P SM M9767P SM M4015WW



Receiver

SM RECEIVER R-02 SM RECEIVER R-14



www.atd-shop.com/qx/1-en/electromechanical-components

DIP Switches

SM DS DP XX APEM NDS-XXV DIP DS1040-XX-B-N SM DS DA5 XXP-HK2-T SM DS PV XX SMD-R

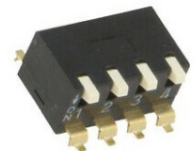
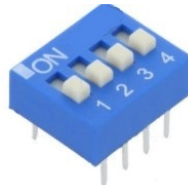
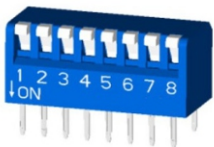

TACT Switches



HOW TO ORDER

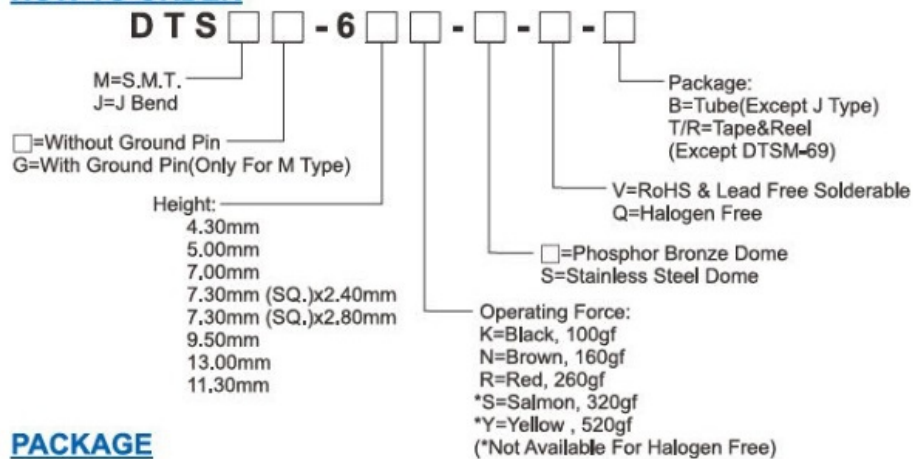

SPECIFICATION

Contact Rating	50mA, 12V DC	
Contact Resistance	100mΩ max.	
Insulation Resistance	100MΩ min, 500V DC	
Dielectric Strength	250V AC/1 minute	
Operating Force	100±50gf, Black(K)	
	160±50gf, Brown(N)	
	260±50gf, Red(R)	
	320±80gf, Salmon(S)	
	520±130gf, Yellow(Y)	
Travel	0,25mm	
Operating Life	Phosphor Bronze Dome 50,000 cycles for 520/320gf 100,000 cycles for 260gf 200,000 cycles for 160/100gf	
	Stainless Steel Dome 300,000 cycles for 520/320gf 500,000 cycles for 260gf 1,000,000 cycles for 160/100gf	
	Operating Temp.	-25°C ~ +70°C
	Storage Temp.	-30°C ~ +80°C

PACKAGE

<Tube>
77 pcs

<Tape & Reel>
DTSM(G)(J)-61 / DTSMG-62:1000 pcs
DTS(M)(J)-62:900 pcs DTSM(G)(T)-63, 64:700 pcs DTSJ-65:400 pcs
DTSM(G)-65:380 pcs DTSM-68:300 pcs DTSM-66:200 pcs

3006.21xx
H=3,95

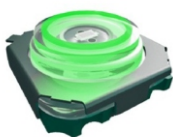

STP-1250SW
H=4,3, 5,0mm



DTSM-6H
H=4,3~11,3mm



SM TS 03 LAB

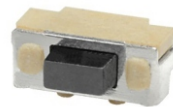

DTS6-H
H=4,3~19mm

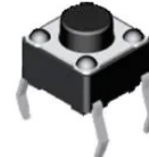

SM KSM632B



Slide Switch

SK-14D02-G2 SBSK-13D07

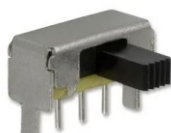

Toggle Switches

APEM 5536A SM-SMTS-202-2C4



Pushbutton switches

SM PB PX16B-3V SM PBPX16 W



7-Segment Display - THT

For example: 1,0" Single Digit THT Display

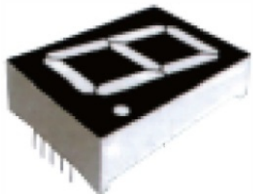

Part Number		Color
Common Anode	Common Cathode	
PA11007-IW	PA11007-LW	White
PA11007-IB	PA11007-LB	Blue
PA11007-IG	PA11007-LG	Pure Green
PA11007-IYG	PA11007-LYG	Yellow Green
PA11007-IY	PA11007-LY	Yellow
PA11007-IO	PA11007-LO	Orange
PA11007-IR	PA11007-LR	Red
PA11007-IRA	PA11007-LRA	Super Bright Red

Through-hole Display Single

Size: 0,28" , 0,30" , 0,36" , 0,39" , 0,60" , 0,80" , 1,0" , 1,2" , 1,5" , 1,8" , 2,3" , 3,0" , 4,0" , 5,0"

Through-hole Display Dual

Size: 0,30" , 0,36" , 0,40" , 0,50" , 0,53" , 0,56" , 0,8"

Through-hole Display Tripple

Size: 0,36" , 0,39" , 0,40" , 0,50" , 0,56" , 0,80"

Through-hole Display Quadruple

Size: 0,28" , 0,33" , 0,36" , 0,39" , 0,40" , 0,56" , 0,80"

Dot Matrix Display

Size: 0,7" 5x7dot, 1,25" 5x7dot, 1,54" 5x7dot, 1,48" 8x8dot, 1,25" 8x8dot, 1,5" 8x8dot, 2,0" 5x7dot, 2,38" 5x8dot, 2,37" 8x8dot, 4,2" 5x7dot

For example: Dot Matrix Size 0,70" 5x7dot

Dot Matrix Size 2,37" 8x8dot



Part Number		Color
Anode Column,Cathode Row	Anode Row,Cathode Column	
PA350701-AW	PA350701-BW	White
PA350701-AB	PA350701-BB	Blue
PA350701-AG	PA350701-BG	Pure Green
PA350701-AYG	PA350701-BYG	Yellow Green
PA350701-AY	PA350701-BY	Yellow
PA350701-AO	PA350701-BO	Orange
PA350701-AR	PA350701-BR	Red
PA350701-ARA	PA350701-BRA	Super Bright Red



Part Number		Color
Anode Column,Cathode Row	Anode Row,Cathode Column	
PA642374-AW	PA642374-BW	White
PA642374-AB	PA642374-BB	Blue
PA642374-AG	PA642374-BG	Pure Green
PA642374-AYG	PA642374-BYG	Yellow Green
PA642374-AY	PA642374-BY	Yellow
PA642374-AO	PA642374-BO	Orange
PA642374-AR	PA642374-BR	Red
PA642374-ARA	PA642374-BRA	Super Bright Red

7-Segment Display - SMD

For example: 0,39" Three Digits SMD Display

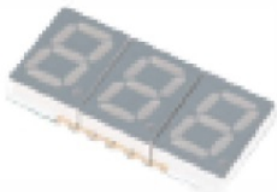

Part Number		Color
Common Anode	Common Cathode	
PA3039A-IW	PA3039A-LW	White
PA3039A-IB	PA3039A-LB	Blue
PA3039A-IG	PA3039A-LG	Pure Green
PA3039A-IYG	PA3039A-LYG	Yellow Green
PA3039A-IY	PA3039A-LY	Yellow
PA3039A-IO	PA3039A-LO	Orange
PA3039A-IR	PA3039A-LR	Red

SMD Display Single

Size: 0,28" , 0,39" , 0,51"

SMD Display Dual

Size: 0,28" , 0,39" , 0,51" , 0,56"

SMD Display Tripple

Size: 0,28" , 0,39" , 0,51" , 0,56"

SMD Display Quadruple

Size: 0,28" , 0,39" , 0,51" , 0,56"

LED



Through-hole LED series



Super Flux LED series



SMD LED series



High Power LED series

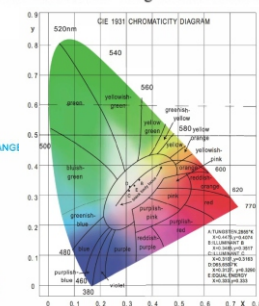
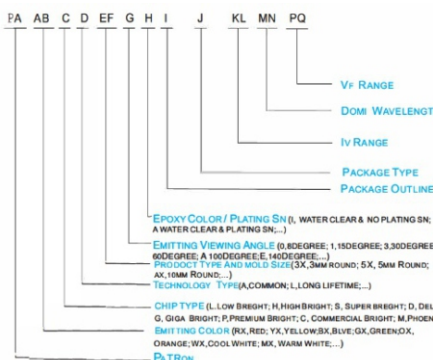

Special LED Series

Current Regulative LED, CRD and Voltage Detector LED, Violet LED, Infrared Emitting Color LED, High CRI LED..

Through-hole LED Series

4.8mm 3-chip Straw Type, Round Type, Rectangular Type..

Oval LED Series

Type 5.0x4.1mm, Type 5.1x4.3mm, 546 Oval Type

Bi-color & Full Color LED Series

Round Bi-color Type, Round Full color Type, Mono-color Flashing Color, Round Intelligent Color RGB LED

Surface Mount LED Series

0402, 0603, 0805, 1206, 0602, 0802, 1204, 3224, 2016, 2835, 3014, 3020, 5630, 7020, 3528 3-chip PLCC4, 3528, 5050..

Super Flux LED Series

chip Super Flux, Flat Super Flux, Concave Super Flux

MEMORIES



www.atd-shop.com

Industrial DRAM Module



DDR DRIM DDR5 SO-DIMM DDR4 DIMM DDR4 VLP DIMM



DDR4 SO-DIMM DDR4 VLP DDR3 DIMM DDR3 VLP DIMM DDR3 SO-DIMM DDR2 DIMM DDRSO-DIMM DDR1 DIMM



Cervoz Industrial DRAM Module product line consists of DIMM, SO-DIMM, VLP-DIMM, and VLP SO-DIMM form factors. The line includes three series: Standard (unbuffered) Series, Wide Temperature Series, and Server.

Industrial SSD

2,5" SATA SSD



U.3 SSD



2,5" SATA SSD

Model No.	Interface Compliance	Density	Sequential Read	Sequential Write
T380 Family	SATA III 6.0Gb/s	64G-2TB	up to 500MB/s	up to 500MB/s
T380 Family (Performance)	SATA III 6.0Gb/s	256G-2TB	up to 500MB/s	up to 500MB/s
T320 Family (Performance)	SATA III 6.0Gb/s	128G-2TB	up to 500MB/s	up to 500MB/s

Titan Series TLC

U.3 SSD

T380 Family Standard Temp. (0°C ~ 70°C) Model No.	T380 Family Wide Temp. (-40°C ~ 85°C) Model No.	Capacity	T443 Family Standard Temp. (0°C ~ 70°C) Model No.	Capacity
CIS-2ST380MLF064GS	CIS-2ST380MLF064GW	64GB	CIS-U3T443ONU1920S	1920GB
CIS-2ST380MMF128GS	CIS-2ST380MMF128GW	128GB	CIS-U3T443ONU3840S	3840GB
CIS-2ST380MMF256GS	CIS-2ST380MMF256GW	256GB	CIS-U3T4430OU7680S	7680GB
CIS-2ST380MOF512GS	CIS-2ST380MOF512GW	512GB		
CIS-2ST380MOF001TS	CIS-2ST380MOF001TW	1TB		
CIS-2ST380MOF002TS	CIS-2ST380MOF002TW	2TB		

Industrial Embedded Module

mSATA Half Size mSATA Half Slim M.2 2230



mSATA Titan Series T380 Family

T380 Family Standard Temp. (0°C ~ 70°C) Model No.	T380 Family Wide Temp. (-40°C ~ 85°C) Model No.	Capacity
CIE-MST380MLF064GS	CIE-MST380MLF064GW	64GB
CIE-MST380MMF128GS	CIE-MST380MMF128GW	128GB
CIE-MST380MMF256GS	CIE-MST380MMF256GW	256GB
CIE-MST380MOF512GS	CIE-MST380MOF512GW	512GB
CIE-MST380MOF001TS	CIE-MST380MOF001TW	1TB
CIE-MST380MOF002TS	CIE-MST380MOF002TW	2TB

M.2 2242 M.2 2280 SATA Disk 7pin SATA Disk Left SATA Disk 7pin PATA Disk 40pin PATA Disk PATA Horizontal



Compact Flash Card

Compact Flash Card - Supreme Series

CFast Card - Momentum Series

Compact Flash Card



CFast Card



S141 Family Standard Temp. (0°C ~ 70°C) Model No.	S141 Family Wide Temp. (-40°C ~ 85°C) Model No.	Capacity
CIM-CFS141TD256MS	CIM-CFS141TD256MW	256MB
CIM-CFS141TD512MS	CIM-CFS141TD512MW	512MB
CIM-CFS141TETS12MS	CIM-CFS141TETS12MW	512MB
CIM-CFS141TFT001GS	CIM-CFS141TFT001GW	1GB
CIM-CFS141TFT002GS	CIM-CFS141TFT002GW	2GB
CIM-CFS141THT004GS	CIM-CFS141THT004GW	4GB
CIM-CFS141THT008GS	CIM-CFS141THT008GW	8GB
CIM-CFS141THT016GS	CIM-CFS141THT016GW	16GB

R350 Family Standard Temp. (0°C ~ 70°C) Model No.	R350 Family Wide Temp. (-40°C ~ 85°C) Model No.	Capacity
CIM-CAR350TKD016GS	CIM-CAR350TKD016GW	16GB
CIM-CAR350TKD032GS	CIM-CAR350TKD032GW	32GB
CIM-CAR350TD064GS	CIM-CAR350TD064GW	64GB

Modular Expansion Card

Wi-Fi Solution Ethernet Solution Serial Solution USB Solution Display Solution SATA Solution CAN Bus Solution



www.atd-elektronik.cz/cervos.html

Let us know what type you are buying and we will be happy to offer you a replacement.



Custom wire wound parts

Please provide us your part number or specification (winding prescription, coil and core shape, etc.). We have experienced technical team, sufficient database of materials and equipment to build winding parts, planar transformers according to your requirements. Our goal is to produce quality components in a reasonable price and within acceptable delivery time. We believe this is very important in electronic rapidly changing industry.

Please feel free to send us your non binding inquiry.

SMD Bead			
Products classification	Photo	P/N	Series
Ni-Zn Ferrite Bead (high current)		SSMB	323023I
			403022I
			403025
			853025
			784730
NEW Metal Alloy Bead (Giga frequency)		SMBP	403025
NEW Mn-Zn Ferrite Bead (high current)		SMBM	403022I
			403025
			853025
			784730
Ni-Zn Ferrite Bead Array		SSMA	455625
			855625
			908545
Multilayer Chip Bead		SCB	1005(0402)
			1608(0603)
			2012(0805)
			3215(1206)
			3225(1210)
SMD Wide Band Choke		SR5H	55
			85

Common mode choke			
Products classification	Photo	P/N	Series
Common mode choke		SPWC	0603
			0805
			1206
			1210
			1812
SMD BALUN X'FMR		SPWB	2012
NEW Common mode choke		SACM	3225
			4532
			9152L
High current CMC for Power Line		SSCM	0706V
			0907V
			1211V

SMD Power Coil			
Products classification	Photo	P/N	Series
Shielded SMD Power Coil		SPRH	0703
			0704
			1205
			1207
			1209
Shielded SMD Power Coil		SSB	0703
			0705
			1207
			1003

Capacitors



Aluminium Electrolyt.

- screw, PCB mounting
- 4 - 500VDC
- axial, radial

Film

- MKP, MKT, MFP
- EMI supp.
- motor run
- power factor corr.
- 63 - 3000 VDC

Power

- for AC / DC applications
- up to 6600VDC
- up to 3400VAC
- AC: 0.1-600 μ F
- DC: 5-30000 μ F

Multilayer

- SMD, PCB mounting
- 16-500VDC
- 0.3pF-1 μ F
- EMI supp. up to the Ghz

Ferrites

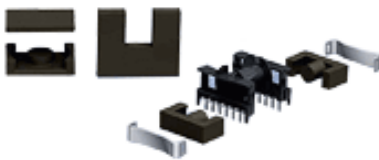

Ferrite materials

- inductors for resonant circuits and filters
- broadband transformers and EMC applications
- power transformers and chokes
- inductive proximity switches
- EMI supp. up to the Ghz

Ferrites&accessories

- SMD, PCB mounting
- E, EELP, EILP, ER planar cores
- EQ/I, ER, PQ, ETD, EFD, EV, U/I cores
- toroids
- double-aperture cores
- EMI supp. up to the Ghz

SMT Inductors & Chokes

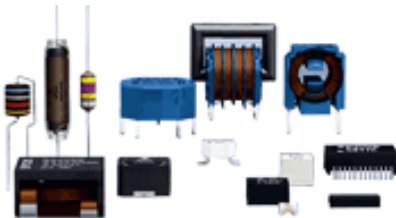

SMT

- SMD mounting
- inductance 0.01-1000 μ H
- EMC shielding
- filtering of supply voltages

SMT Power

- SMD mounting
- low profile
- inductance 0.5-1000 μ H
- EMC shielding
- coupling

Chokes

- SMD, PCB mounting
- low profile
- inductance 0.5-1000 μ H
- EMC shielding
- coupling

EMC filters

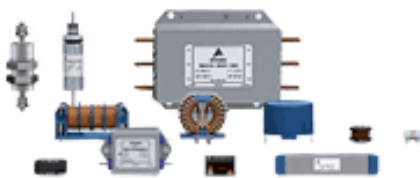

Feedthrough comp.

- 0.00125-4.7 μ F
- broadband interference suppression

Filters

- 2-line, 3-line, 4-line
- output filters
- PCB, screw terminal
- customized
- 63 - 3000 VDC

Shielded rooms

- for power lines
- for communication lines
- customized

Services

- EMC laboratory EPCOS
- for customized design

Arresters

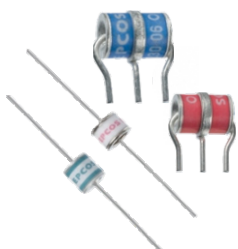

Surge arresters

- 2-electrode, 3-electrode
- AC power line protection
- SMD, PCB mounting
- screw terminal mounting
- protection class to EN 61643-11
- DSL modem, WLAN routers...

Switching spark gaps

- SMD, PCB mounting
- E, EELP, EILP, ER planar cores
- EQ/I, ER, PQ, ETD, EFD, EV, U/I cores
- toroids
- double-aperture cores
- EMI supp. up to the Ghz

Thermal Interface Materials



www.atd-shop.com

ATD offers cutting of materials on own CNC cutting plotter

LCUT 1070



Cutting knife system: one vibrating knife holder
 Cutting area: 1000 mm length x 700 mm width
 Max. 5~10mm, depending on the type of material to be cut
 Cutting speed: 100-1400mm/s
 Setting accuracy/resolution: 0.05mm



Made in the Czech Republic

Ttape 1000A

Thermally Conductive Adhesive Tape



Thermal Conductivity - 0,70W/mK
 Operating Temperature -40 ~ +125°C
 Thickness: 0,05mm
 AC Voltage Breakdown: 2,35 Kvac
 Color: White

CoolZorb - Ultra

Hybrid Thermal/EMI Absorber

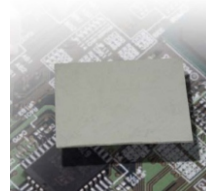

Thermal Conductivity - 11,5W/mK
 Hardness 30 seconds - 31 Shore 00
 Operating Temperature -40 ~ +125°C
 Thickness: 0,5-4 mm
 AC Voltage Breakdown: 1,34 Kvac
 Good EMI particularly over 25GHz
 Color: Dark gray

Tgrease 300X

Thermal Grease



Thermal Conductivity - 3,0W/mK
 Density 2,7g/cc
 Operating Temperature -40 ~ +150°C
 Thermal Resistance
 10 psi & 50°C 0.20°C-cm2/W
 50 psi & 50°C 0.12°C-cm2/W
 Color: Grey

Tflex CR350S

ultra-soft, two-part dispensable gap filler



Thermal Conductivity - 3,6W/mK
 Hardness 50 Shore 00
 Operating Temperature -55 ~ +200°C
 Minimum bondline thickness: 85µm
 Easily reworkable
 Density: 3.16 g/cc

Tgrease 300X

Best-in-class thermal resistance

Low thermal resistance <0.06°C-cm2/W in constant pressure applications

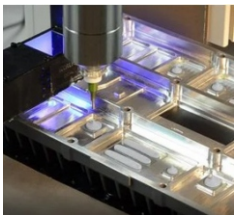

Thermal Conductivity - 6,4W/mK
 Operating Temperature -40 ~ +125°C
 Minimum bondline thickness: 20µm
 Available in cans, pails, cartridges and syringes
 Easily reworkable
 Density: 2,63 g/cc

Tputty 910

A one-part liquid dispensable gap filler with impressive thermal conductivity

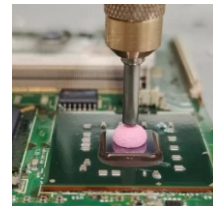

Thermal Conductivity - 9,1W/mK
 Operating Temperature -40 ~ +180°C
 Minimum bondline thickness: 180µm
 Available in syringes, cartridges and 1 gal-pail
 Easily reworkable
 Density: 3.16 g/cc

Tflex UT 20000

Ultra-Thin Thermal Gap filler

Thermal Conductivity - 3,0W/mK
 Thickness: 200 µm - 1000 µm

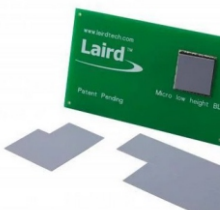

Tgon800

Flexible Graphite

Thermal Conductivity - 5,0W/mK
 Thickness: 0,13 ~ 0,51mm

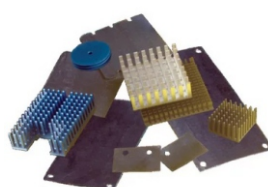

Tflex Hp34

Thermal Gap Filler

Thermal Conductivity - 34,0W/mK
 Thickness: 1 ~ 5mm

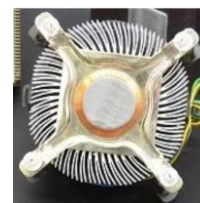

Tpcm 7000

Thermal Phase Change Material

Thermal Conductivity - 7,5W/mK
 Thickness: 0,13 ~ 0,4mm



Thermoelectric Modules



High Performance Cooling Solutions

Thermoelectric Coolers - New „X” generation Series



HiTemp ETX Series
capacity 7-320W
15*18mm - 52-56mm
 $\Delta T = 83,2^{\circ}\text{C}$ max.
higher thermal insulating barrier



Multistage MS Series
capacity 0,3-2W
3,9*3,9mm - 30-30mm
 $\Delta T = 129^{\circ}\text{C}$ max.
ideal to cool CMOS sensors head-up display

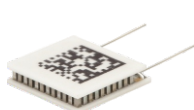

OptoTEC™ OTX/HTX Series
capacity 0,4-9,7W
3,3*4,9mm - 12*13mm
 $\Delta T = 82^{\circ}\text{C}$ max.
LIDAR Sensor Laser/Optic Machine Vision

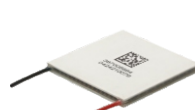

PowerCycling PCX Series
capacity 13-215W
15*15mm - 40*40mm
 $\Delta T = 74^{\circ}\text{C}$ max.
high thermal cycling capability
Precise temperature control



UltraTEC™ UTX Series
capacity 68-298W
24*26mm - 52-56mm
 $\Delta T = 72^{\circ}\text{C}$ max.
Spot colling Laser & Optic
Precise Thermal Management



Annular Series
capacity 3,5-70,3W
14x14 - 40x40mm
 $\Delta T = 70,5^{\circ}\text{C}$ max.
Reagent Storage & Machine Vision

Thermoelectric Cooler Assemblies

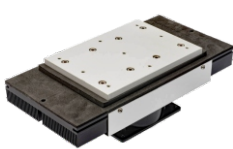

Peltier Plate Assemblies
capacity 11-283W
56*60*44mm ~
135-400*180mm
 $\Delta T = 70^{\circ}\text{C}$ max.
Medical, Analytical Instrumentation
HPLC, Colling of Cetrifuges



Cascade Series
capacity 31-58W
91*160*122mm ~
91*230*122mm
 $\Delta T = 69^{\circ}\text{C}$ max.
CMOS and Imaging Sensors
Heads-Up display



SuperCool Series
capacity 110-407W
156*230*150mm
~ 330*173*197*122mm
 $\Delta T = 40^{\circ}\text{C}$ max.
Air-to-Air, Air-to-liquid,
Cooling Incubator Chamber



Outdoor Cooler Series
capacity 100-480W
180*300*122mm ~
225*330*330mm
 $\Delta T = 45^{\circ}\text{C}$ max.
Cell Phones Base Stanions
and Towers Cooling

Liquid Cooling Systems



Nextreme™ Series
Capacity 0,4-5KW, Flow Rate 1-15L/min.
403*274*400mm-590*630*910mm
100-230VAC,

Thermal Wizard <https://lairdthermal.com/thermal-wizard/qc-cooling-selector-home>

CHOOSE AN EXAMPLE OR COMPLETE THE REQUIREMENTS...

Know your Cooling Requirement (Qc)?
Move a slider to the desired Qc and click SEARCH

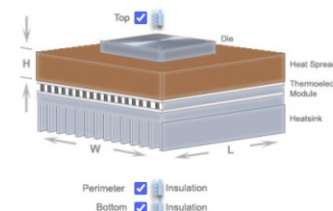
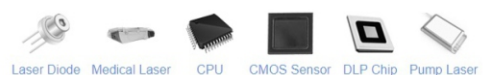
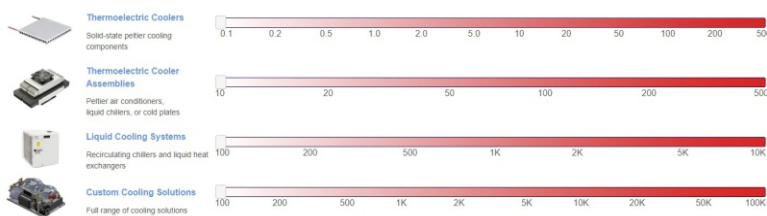

CHOOSE AN EXAMPLE OR COMPLETE THE REQUIREMENTS...

PCR Block
 Thermoelectric Module
 HeatSink

DIMENSIONS

Length mm Width mm Height mm

TEMPERATURES

Ambient Temperature (T_{amb}) °C Elongation Temperature (T_{el}) °C Denaturation Temperature (T_{den}) °C Annealing Temperature (T_{ann}) °C

DIMENSIONS

Length mm Width mm Height mm Insulation Thickness mm

TEMPERATURE

Internal °C Ambient °C

INSULATION TYPE

Foam Insulation Thermal Conductivity: W/m*K

Electrically Conductive Elastomers (ECE) Sub-Groups

Extruded EMI Shielding Gaskets Series

ElectroSeal™ ECE072 - Gray - a Nickel/Graphite filled silicone elastomer
 ElectroSeal™ ECE085 - Tan - a Silver/Glass filled silicone elastomer
 ElectroSeal™ ECE089 - Blue - a Silver/Aluminum filled fluorosilicone elastomer
 ElectroSeal™ ECE093 - Black - a Nickel/Graphite filled silicone elastomer.
 more types of material available



Rectangular Strips

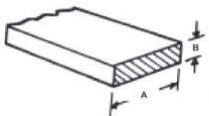

MIL-DTL-85328 PART NUMBER	PART NUMBER	NOMINAL DIMENSIONS	
		A	B
M83528/002X006	8861-0175	0.252 (6,4)	0.031 (0,8)
M83528/009X008	8861-0135	0.500 (12,7)	0.125 (3,2)
M83528/009X011	8861-0192	1.00 (25,4)	0.126 (3,2)

O-Strip Tubing

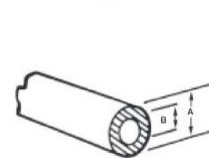

MIL-DTL-85328 PART NUMBER	PART NUMBER	NOMINAL DIMENSIONS	
		A	B
	8864-0060	0.085 (2,2)	0.040 (1,0)
M83528/011X007	8864-0095	0.103 (2,6)	0.040 (1,0)
M83528/011X001	8864-0100	0.125 (3,2)	0.045 (1,1)
M83528/011X002	8864-0105	0.156 (4,0)	0.050 (1,3)
M83528/011X008	8864-0143	0.177 (4,5)	0.079 (2,0)
M83528/011X003	8864-0110	0.250 (6,4)	0.125 (3,2)
M83528/011X004	8864-0120	0.312 (7,9)	0.192 (4,9)
M83528/011X005	8864-0125	0.375 (9,5)	0.250 (6,4)

Hollow D-Strips

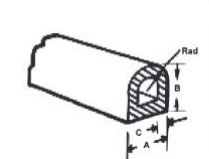

MIL-DTL-85328 PART NUMBER	PART NUMBER	DIMENSIONS		
		A	B	RAD
	8866-0130	0.100 (2,5)	0.094 (2,4)	0.050 (1,3)
M83528/007X001	8866-0100	0.156 (4,0)	0.156 (4,0)	0.078 (2,0)
M83528/007X007	8866-0110	0.250 (6,4)	0.250 (6,4)	0.125 (3,2)
M83528/007X004	8866-0166	0.374 (9,5)	0.252 (6,4)	0.187 (4,8)
	8866-0126	0.480 (12,2)	0.335 (8,5)	0.240 (6,1)
M83528/007X006	8866-0155	0.625 (15,9)	0.400 (10,2)	0.312 (7,9)

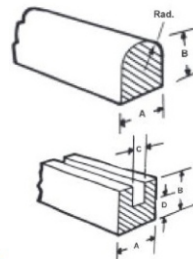

D-Strips

MIL-DTL-85328 PART NUMBER	PART NUMBER	DIMENSIONS		
		A	B	RAD
M83528/003X001	8865-0105	0.062 (1,6)	0.068 (1,7)	0.031 (0,8)
M83528/003X007	8865-0130	0.122 (3,1)	0.135 (3,4)	0.061 (1,5)
M83528/003X012	8865-0145	0.250 (6,4)	0.250 (6,4)	0.125 (3,2)

Channel Strips

MIL-DTL-85328 PART NUMBER	PART NUMBER	DIMENSIONS			
		A	B	C	D
M83528/010X002	8868-0105	0.126 (3,2)	0.110 (2,8)	0.025 (0,6)	0.050 (1,3)
M83528/010X004	8868-0115	0.156 (4,0)	0.156 (4,0)	0.062 (1,6)	0.047 (1,2)
M83528/010X005	8868-0081	0.189 (4,8)	0.189 (4,8)	0.063 (1,6)	0.063 (1,6)
	8868-0085	0.252 (6,4)	0.252 (6,4)	0.126 (3,2)	0.063 (1,6)

O-Strips

MIL-DTL-85328 PART NUMBER	PART NUMBER	RECOMMENDED GROOVE DIMENSIONS (±0.002)		
		A	WIDTH	HEIGHT
	8863-0184	0.032 (0,8)	0.036 (0,9)	0.026 (0,7)
M83528/001X003	8863-0110	0.062 (1,6)	0.066 (1,7)	0.050 (1,3)
M83528/001X009	8863-0145	0.125 (3,2)	0.133 (3,4)	0.100 (2,5)
M83528/001X013	8863-0202	0.374 (9,5)	0.400 (10,2)	0.300 (7,6)

EMI Gasket - Fabric-over-Foam

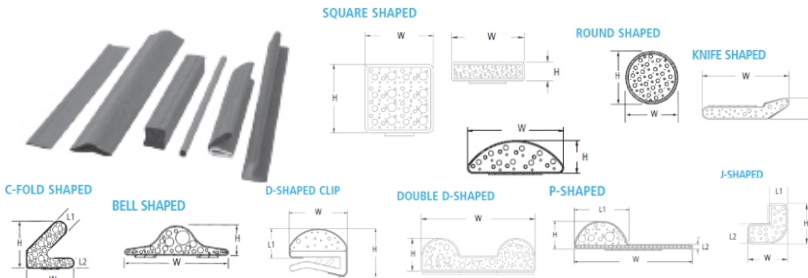

Part Number Example:

Digits: 12 3 4 5 6 7 8 9 10 11 12 13 14

4 6 9 3 - PA - 5 1 H - 0 1 2 0 0

Profile Shape & Size: 4693
 Attachment & Part Specific Details: PA
 Core Materials: 5 = Soft Urethane, R = High Temp, T = Low Compression Set / Force, 0 = No Foam, H = Sculpted Foam / "C" Shapes
 Flame Rating: 1 = UL V0
 Fabric Cover: Y, G = Ni/Cu Knit Mesh, H = Ni/Cu Taffeta, L = Black Ni/Cu Taffeta
 Part Length: 01200

EMI Gasket - EMC FINGERSTOCK

- sticky fingers
- clip-on
- fingerstock slotted
- EMC fingerstock Twist
- EMC spring riveting



EMC TAPE



EMI Taffeta Fabric

Nickel Taffeta Fabric High Resistance
3035-410

Substrate: Polyester Taffeta
 Metal: Nickel
 Thickness: 0,1mm
 Temperature: 155°C



Ripstop Fabric EcoTouch™ Conductive
3050-113

Substrate: Nylon Ripstop
 Metal: Cu
 Thickness: 0,127mm
 Temperature: 200°C



	Thickness (mm) ¹	Color	Peel (N/25mm)
96249	0.053	Black ⁴	>8
96249J	0.10	Black	>8
86748	0.06	Grey	>11
86750	0.075	Grey	>9
86285	0.12	Black	>10
86250	0.08	Black	>12
85785	0.12	Grey	>11
86205	0.13	Black	>11
81720	0.027	Grey	>8
87580	0.13	Grey	>8

Board Level Shields

news
BMI-S-608

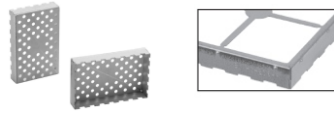

Remove complexity from the thermal transfer chain

STANDARD TWO-PIECE BOARD LEVEL SHIELDS

PART NUMBER	OVERALL LENGTH in (mm)	OVERALL WIDTH in (mm)	OVERALL HEIGHT in (mm)	PARTS PER REEL
BMI-S-201-F	.538 (13,66)	.476 (12,10)	.100 (2,54)	1000
BMI-S-202-F	.650 (16,50)	.650 (16,50)	.142 (3,60)	700
BMI-S-203-F	1.032 (26,21)	1.032 (26,21)	.200 (5,08)	300
BMI-S-204-F	1.260 (32,00)	1.260 (32,00)	.236 (6,00)	225
BMI-S-205-F	1.500 (38,10)	1.000 (25,40)	.236 (6,00)	250
BMI-S-206-F	1.450 (36,83)	1.326 (33,68)	.200 (5,08)	300
BMI-S-207-F	1.747 (44,37)	1.747 (44,37)	.384 (9,75)	120
BMI-S-209-F	1.156 (29,36)	0.728 (18,50)	.275 (7,00)	400
BMI-S-210-F	1.732 (44,02)	1.201 (30,50)	.118 (3,00)	370
BMI-S-230-F	1.500 (38,10)	2.000 (50,80)	.200 (5,08)	250
BMI-S-230-F-R	1.500 (38,10)	2.000 (50,80)	.200 (5,08)	250
BMI-S-305	1.500 (38,10)	1.000 (25,40)	.236 (6,00)	250

STANDARD ONE-PIECE BOARD LEVEL SHIELDS

PART NUMBER	MAXIMUM OVERALL LENGTH in (mm)	MAXIMUM OVERALL WIDTH in (mm)	MAXIMUM OVERALL HEIGHT in (mm)	PARTS PER REEL
BMI-S-101	.538 (13,66)	.476 (12,10)	.100 (2,54)	1000
BMI-S-102	.650 (16,50)	.650 (16,50)	.142 (3,60)	700
BMI-S-103	1.032 (26,21)	1.032 (26,21)	.200 (5,08)	300
BMI-S-104	1.260 (32,00)	1.260 (32,00)	.236 (6,00)	225
BMI-S-105	1.500 (38,10)	1.000 (25,40)	.236 (6,00)	250
BMI-S-106	1.450 (36,83)	1.326 (33,68)	.200 (5,08)	300
BMI-S-107	1.747 (44,37)	1.747 (44,37)	.384 (9,75)	120
BMI-S-111	1.032 (26,21)	1.032 (26,21)	.079 (2,00)	625



Wall mounted defibrillator

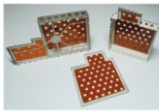

Kapton® and Laird combined design

Microwave Absorbers

news
Robzorb™ GDS
Dispensable Absorber Robzorb™ GDS
- targeting 18 to 35 GHz range
- Operating Temperature -50 ~125°C

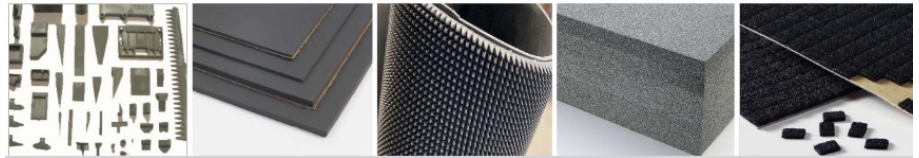

NEAR FIELD NOISE SUPPRESSION	CAVITY RESONANCE					FREE SPACE				TRANSMISSION LOAD/TERMINATION	
						ISOLATION	REFLECTION REDUCTION		>18 GHz		
							NARROW BAND	BROADBAND			
10 MHz-3 GHz	800 MHz-6 GHz	6-18 GHz	18-35 GHz	35-100 GHz	>1 GHz	700 MHz-40 GHz	600 MHz-2 GHz	2-18 GHz	>18 GHz	1-18 GHz	18-35 GHz
NS1000 NS1000 C/F/H NS1000Q NS1000HTRC RF-LB	MCS Softzorb™ MCS RF-LW	BSR LS QR-13AF Thermo-plastic MF	GDS (FR) 5GMeF1 LS QR-13AF Thermo-plastic MF Softzorb™ GDS	MMI JCS-Next 5GHIF1 JCP-PBT 252 JCP-PA JCP-PP	LS QR-13AF JCS-Next JCP-PA JCP-PP JCP-PBT 252	SF	AN	AN FGM HR	HR JCP-PA JCP-PP (Rezorb™ 60-90 GHz) CV	MF500F CR/CRS/ CFS BSR	BSR Thermo-plastic MF

Dielectric silicone Absorber ReZorb S

with no magnetic properties, ReZorb™ S becomes the smart choice in datacom/telecom, industrial, automotive, and military and aerospace applications because of the need to eliminate unwanted reflection and achieve optimum functionality.

- targeting 60 to 90 GHz range
- standard thickness 4,7mm
- Operating Temperature -70 ~177°C
- shock and tear resistant

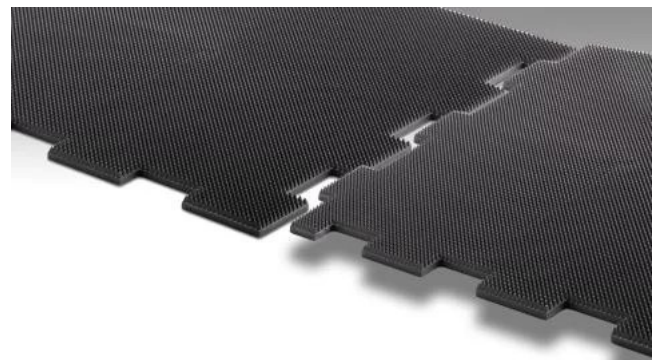

DC/DC Unregulated SMD Package (0,2W~2W)

PN1-XXSXXANT SMD -50°C ~ +115°C



Dimension: 12,7x11x7,13mm
 Input: 3,3V, 5V, 12V, 15V, 24V
 Output: 3,3V, 5V, 9V, 12V, 15V, 24V
 Isolating Voltage 1500V
 High efficiency up to 88%
 Power 1W

PPAT SMD -40°C ~ +105°C



Dimension: 16,24x11,7x7mm
 Input: 3,3V, 5V, 12V, 15V
 Output: ±3.3V, ±5V, ±9V, ±12V, ±15V/
 3.3V, 5V, 9V, 12V, 15V
 Isolating Voltage 3000V
 High efficiency up to 80%
 Power 0,2W, 0,5W, 1W, 2W

Patron

Passive Elektronik

DC/DC Converters Unregulated SIP & DIP Package (0,1W~3W)

PPJ (2W)
 1W, 2W
 SIP 19,5x9,8x12,5mm
 6KVDC

PPH (3W)
 2W, 3W
 SIL 19,5x7,5x10mm
 DIP 19,5x9,8x7,7mm

PPE (1W)
 1W,
 SIL 11,48x6x10mm
 DIP 11,5x9,8x6,8mm

PPG (3W)
 2W, 3W
 SIL 19,5x6x10mm

Non-Isolated (0,5~2,0A)

PP78xx-1 (0,5, 1,5, 2)

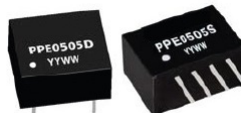

AC/DC On-board regulated (1W~30W)



PP03AL
 3W, SIL, 3KVAC

PP05AL
 5W, SIL, 3KVAC

PP01(02)AZ
 1W, 2W, 27,9x20x15mm

PP03AC
 3W, 37x18,5x16,5mm

PP10AC
 10W, 50,8x25,4x16

PP25AU
 25~30W, 70x48x23,5mm



AC/DC Converters DIN-Rail (15W~360W)

PPR/DG-15-XS
 15W, 103,7x97,5x32mm

PDP 15W
 15W, 17,5mm

PDP 60W
 60W, 32mm

PPR-U120-XS
 120W, 240W

PDP 360
 360W, 60mm

PAN-20-12



AC/DC Converters Metal Enclosure (25W~1200W)

PPC/PD-25XS
 25W, 90,8x51x28,8mm

TPC/LR-50-XS
 50W, 92,5x82x30mm

PPC/PS-60-XS
 60W, 101,6x51x24mm

PPC/LR-150-XS
 150W, 152,5x97x30mm

PPC PDF-1200-XS
 1200w, 226x116,5x41mm

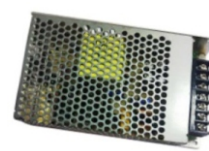
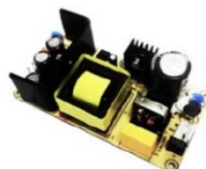
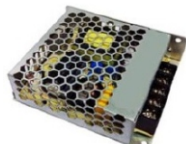
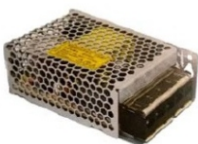

PASSIVE PFC CHOKES



NEW

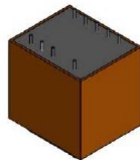

SIZE EI48-20,5
Dimension 48x40x36,7

SIZE EI54-23
54x45x41,3mm

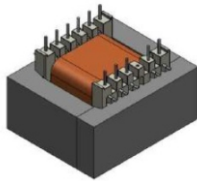
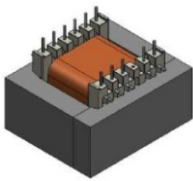

SIZE EI30-23 • POTTED Typical use at ambient 70 °C

Reference	Inductance (mH)	Rated current (A _{RMS})	Sat. current (A _{pk})	Temperature class	Type
43110	1.0	5.2	10.4	T70 / B	2
43111	1.5	4.2	5.9	T70 / B	2
43112	2.0	3.6	5.1	T70 / B	2
43113	2.5	3.5	4.9	T70 / B	1
43114	3.0	3.2	4.5	T70 / B	1
43115	3.5	3.0	4.2	T70 / B	1
43116	4.0	2.9	4.1	T70 / B	1
43117	4.5	2.5	3.9	T70 / B	1
43118	5.0	2.3	3.8	T70 / B	1
43119	10.0	1.9	2.7	T70 / B	2
43120	15.0	1.5	2.2	T70 / B	1
43121	20.0	1.3	2.1	T70 / B	1

Operating temperature - 40 / + 120 °C
Storage temperature - 40 / + 85 °C

SIZE EI30-23 OPEN
Dimension 30x25x32mm

SIZE EI38-13.6
40,6x34,9x28,1mm

SIZE EI38-13.6 OPEN
38,4x32x26,4mm

SIZE EI42-20 POT.
44,3x37,3x38mm

SIZE EI42-20 OPEN
42x35x35,5mm

SIZE EI48-20,5
50,8x42,6x38,4mm

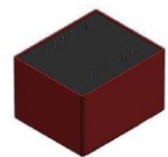
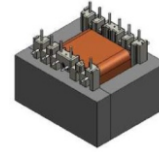
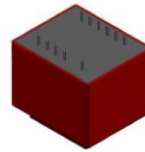
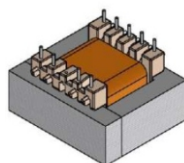
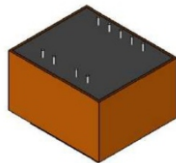
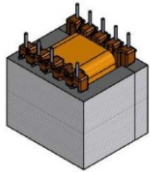

TRANSFORMER FOR TINY SWITCH

SIZE E16 - 5 or 12V, 1,5W, 3,1W, 6W, 9W, 12W

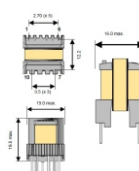

- Primary / Secondary Insulation \geq 4000V
- PD2 - creepage distances \geq 6mm
 - Ambient Temperature $<$ 85°C
 - Construction conforms to the certified MYRRA class B UL Electrical Insulation
 - Construction conforms to IEC60335-1,
 - Exclusively uses UL94-V0 listed materials

SIZE E19 - 5 ~ 30V

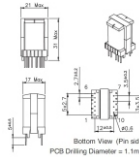

SIZE EF20 & E25

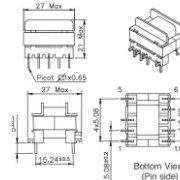

SIZE ETD29

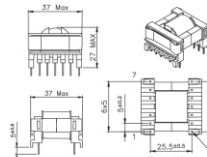

SIZE ERL28

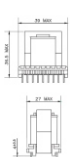

POWER CHOKES - Operating temperature: -40°C / +140°C - Exclusively uses Class H & UL94-V0 listed materials
- Construction conforms to the certified Myrra class H - Electrical Insulation System E113497H1

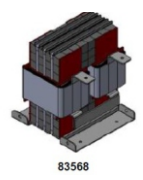
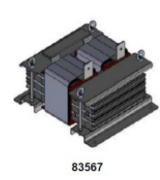
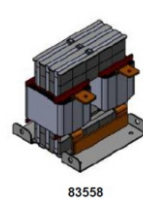
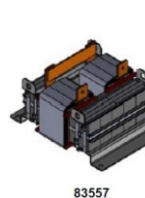
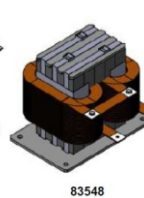
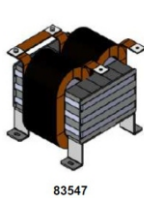
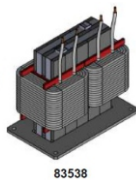
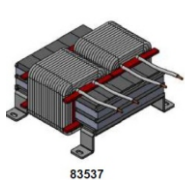

TOROIDAL ACTIVE PFC

insulation 4000V - operating temperature: -40°C / +120°C - Exclusively uses UL94-V0 listed materials

DC CHOKES

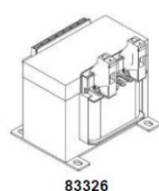
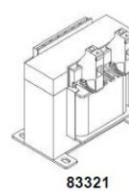
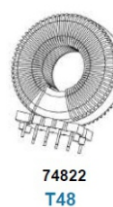
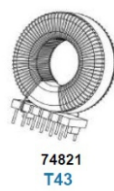
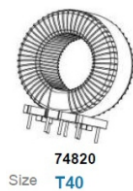
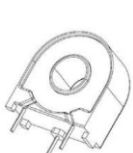

Series S1- 0,5-2W Unregulated SIL/DIL Up to 6000VDC

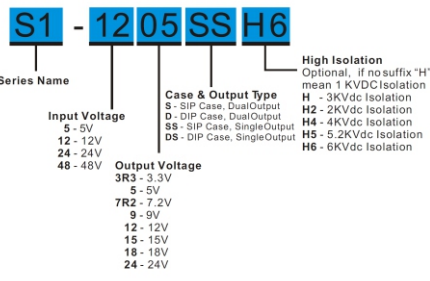

Model Number	Input Vdc	Output Vdc	Output Current (mA)	Efficiency @FL (%)
S1-3R33RSS	3.3	3.3	303	76
S1-3R305SS		5	200	78
S1-3R309SS		9	111	80
S1-3R312SS		12	83	77
S1-3R315SS		15	67	78

Series SA - 0,25-1,50W Unregulated SIL4 Up to 3000VDC

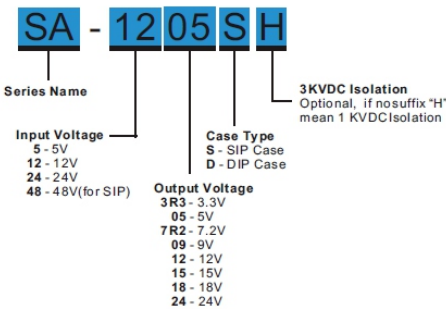

Model Number	Input Vdc	Output Vdc	Output Current (mA)	Efficiency at FL (%)
SA-3R33R3S1	3.3	3.3	29.10	72
SA-3R305S1		5	200	77
SA-3R37R2S1		7.2	18.5	79
SA-3R309S1		9	111	75
SA-3R312S1		12	100	77
SA-3R318S1		15	67	79
SA-3R324S1		18	56	76
SA-3R324S1		24	50	79

DC/DC Converters 0,25W ~ 600W

DC/DC converters 0,5W	DC/DC converters 1W SMT	DC/DC converters 1W DIL	DC/DC converters 1W SIL	DC/DC converters 2W SMT	DC/DC converters 2W SIL	DC/DC converters 6W
DC/DC converters 8W	DC/DC Converters 30W	DC/DC Converters 40W	SVRB24_LD-50W	SUMFS 50-66W	SLD50E 50W	SURF1D_QB-50WR3
SPV200-27	SYHD150	SYFD300W-400W	DC/DC Converters 66-119W	DC/DC Converters 120-600W	High Voltage DC/DC converters	Photovoltaic converters

Battery and Filters



www.atd-shop.com

Battery

BRC18650-4000mAh
Lithium battery 4000mAh
diam. 18,5mm* x 68mm



PLCT103450
5AH 5V/2,1A max. Input: 5V/1A
10.3 x 34.5 x 53mm



PLCT 252020
Lithium battery 3,7V, 1800mAh
2.5 x 20 x 23mm

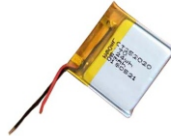

PLCT060002
Lithium battery 3,7V, 65mAh;
dimensions 142*75*13,6mm



SP-135x125-6V/2W



Solar Panel Power Bank

Solar panel

www.atd-shop.com/qx80V/baterie

Filtres IEC

SM SE 8000 EMC/EMI Filter

SE 8000

SE 8000S

SE 8000S1



Filter	Rated Current(A)	Rated Voltage(V)	Leakege Current(mA)
SE8000-1-01	1	120/250	0,5
SE8000-3-01	3	120/250	0,5
SE8000-6-01	6	120/250	0,5
SE8000-10-01	10	120/250	0,5
SE8000S-1-01	1	120/250	0,5
SE8000S-3-01	3	120/250	0,5
SE8000S-6-01	6	120/250	0,5
SE8000S-10-01	10	120/250	0,5
SE8000S1-1-01	1	120/250	0,5
SE8000S1-3-01	3	120/250	0,5
SE8000S1-6-01	6	120/250	0,5
SE8000S1-10-01	10	120/250	0,5

SM SE 8300/8400 EMC/EMI Filter With Fuse Holder and Switch

SE 8300
Single fuse Holder

SE 8400
Double fuse holder

SE8600



Filter	Rated Current(A)	Rated Voltage(V)	Leakege Current(mA)
SE8300-1-01	1	120/250	0,5
SE8300-3-01	3	120/250	0,5
SE8300-6-01	6	120/250	0,5
SE8300-10-01	10	120/250	0,5
SE8400-1-01	1	120/250	0,5
SE8400-3-01	3	120/250	0,5
SE8400-6-01	6	120/250	0,5
SE8400-10-01	10	120/250	0,5

SM SE8600 EMC/EMI Filter With Mains Switch

Filter	Rated Current(A)	Rated Voltage(V)	Leakege Current(mA)
SE8600-1-01	1	120/250	0,5
SE8600-3-01	3	120/250	0,5
SE8600-6-01	6	120/250	0,5
SE8600-10-01	10	120/250	0,5

SM 8100/8200 EMC/EMI Filter With Fuse Holder

SE 8100
Single Fuse Holder

SE 8200
Double Fuse Holder



Filter	Rated Current(A)	Rated Voltage(V)	Leakege Current(mA)
SE8100-1-01	1	120/250	0,5
SE8100-3-01	3	120/250	0,5
SE8100-6-01	6	120/250	0,5
SE8100-10-01	10	120/250	0,5
SE8200-1-01	1	120/250	0,5
SE8200-3-01	3	120/250	0,5
SE8200-6-01	6	120/250	0,5
SE8200-10-01	10	120/250	0,5

SE2202-10-03
~Milflex X31-1

SE8600-10-01
10A 250VAC

SE1000-1-02



Power Cords for North America

SCHURTER
6010.5274
Plug Type A on C7
SPT-2 2x18AWG
black 2m

SCHURTER
6010.5274
Plug Type A on C7
SPT-2 2x18AWG
black 2m

VOLEX
NUSSB7SX10B
Plug Type A on C7
SPT-2 2x18AWG
black 1m



www.atd-shop.com/qx519-en/filters

Coded Switches

CODED SWITCH 07 AND C07A



- 2 to 16 positions BCD, Hex or Gray coding
- Switching mode: Shorting or non-shorting
- For rugged environments
- Switching torque: Up to 3.5 Ncm
- Gold plated contacts
- THT vertical or horizontal
- IP68 front panel sealing (up to 5 bar)
- Operating temperature range: -40 to +85 °C
- Various options and customizations
- Vertical or horizontal mounting
- Bushing style
- BCD, Hex or Gray coding
- Shorting or non-shorting
- Number of positions
- Switching torque BCD: 2.2 or 3.5 Ncm
- Switching torque Hex and Gray: 3.2 or 3.5 Ncm
- With end stop or endless rotating
- Front panel sealing IP60 or IP68

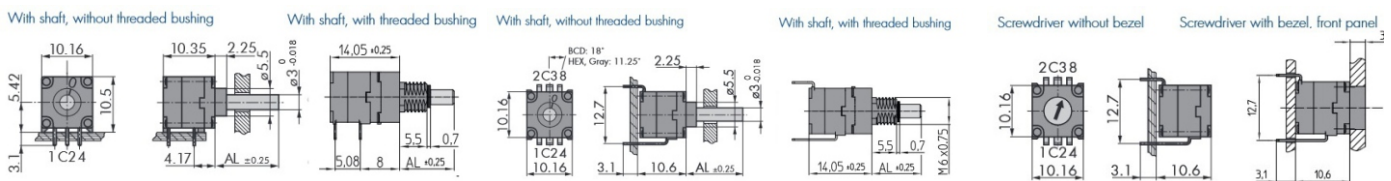

C08 THT or SMT | threaded or non-threaded | 16 positions

Compact switch with Gray coding, up to 16 positions and a 2.5 Ncm switching torque



C15 THT horizontal | non-threaded | 16 positions

Coded switch with Gray coding, switching torque up to 3 Ncm, operating temperatur -40 to +85° C and available with or...



C16 THT horizontal | threaded | 16 positions

Coded switch with Gray coding, switching torque up to 3 Ncm, operating temperatur -30 to +60° C and available with or...



07P2T push to turn | THT horizontal or vertical | 10 positions

Coded switch with push to turn function, BD coding, IP68 sealing, push force up to 11 N and switching torque up to 7 Ncm



X4 with FFC connector

High performance, hall-sensed switch with FFC connector up to 20 Ncm switching torque, up to 1 Mio switching cycles and...



08 coded switch | THT horizontal | BCD coding

Coded switch with Gray coding with up to 16 positions and a 2.5 Ncm switching torque



MR50 THT vertical | 10 positions | 1 pole | 1/4"-28 UNF

Highly robust Ø 1/2" selector with 36° indexing angle, up to 6 Ncm switching torque and operating temperature from -45 to...

Encoders



E37 THT | threaded or non-threaded

Incremental encoder with dual function, switching torque up to 4.5 Ncm, 16 or 32 detent positions and a rotational life up...



E33 Interface Solution | with Micro-MaTch, FFC or ribbon cable

Encoder with integrated PCB (with and without debouncing function) and various mechanical interface options



E33 THT or SMT | threaded or non-threaded

Encoder with or without push function, switching torque up to 4.5 Ncm, 16 or 32 detent positions and a rotational life up to...



E33 THT horizontal | threaded | up to 3 Ncm

Encoder with a fastening torque of nut M7 x 0.75, 32 detent positions, with or without push function, switching torque up to...



E18 THT horizontal | threaded | push button

Encoder with a fastening torque of nut M7 x 0.75, available with 16, 24 or 30 detent positions, switching torque up to 2.5...



E33 SMT vertical | threaded | up to 4.5 Ncm

Encoder with a fastening torque of nut M7 x 0.75, 16 detent positions, with or without push function, switching torque up to...



E33 Interface Solution with FFC connector

Encoder with integrated PCB and FFC connector

Knobs



Classic Collet | black | with line | matt or glossy | Ø 9 mm

Wing knob | black | with line | matt or glossy | Ø 10 mm

Classic Collet | gray | without line | matt or glossy | Ø 14.5 mm

Crank knob | black | glossy | Ø 19 mm

Wing knob | black | with line | matt or glossy | Ø 21 mm

Wing knob | gray | with line | matt or glossy | Ø 28 mm

Classic Collet | black | without line | matt or glossy | Ø 36 mm

Classic Collet | black | with line | glossy | Ø 45 mm

K1 Shape | silver or black

K1 Dimple | silver or black

K1 Medic | silver or black

K1 Robot | silver or black

K1 Space | silver or black

Multi Rotary Switch



01 with pins for PCB or soldering eyelets | 6, 10, 12 positions | M6, M8, M10

Multi wafer compact selector with up to 12 positions, 25'000 switching cycles and with up to 6 Ncm switching torque

04 with pins for PCB or soldering eyelets | 12, 24 positions | 1 - 4 wafers

Very robust, multi wafer selector with up to 24 positions, switching torque up to 20 Ncm and a rotational life up to 25'000...

08 THT horizontal | 1 - 4 wafers

Multi wafer selector for PCB mounting, up to 12 positions, switching torque up to 9 Ncm and 25'000 switching cycles

07R THT | horizontal or vertical | threaded or non-threaded

Miniatur selector with shaft or screwdriver with bezel, PCB mounting and up to 3.5 Ncm switching torque

Audio Solution



X4 with Micro-MaTch socket

High performance, hall-sensed switch with Micro-MaTch socket up to 20 Ncm switching torque, up to 1 Mio switching cycles and...

X4 with Micro-MaTch socket or FFC connector

High performance, hall-sensed switch for various coding, with mechanical and electrical interfaces, up to 20 Ncm switching...

MR50 THT vertical | 12 positions | 2 poles | 1/4"-28 UNF

Highly robust Ø 1/2" selector with 30° indexing angle, up to 6 Ncm switching torque and operating temperature from -45 to...

07R THT vertical | non-threaded | without shaft

Miniatur selector without shaft, PCB mounting and up to 3.5 Ncm switching torque

Enclosures, Cases and Front Panel



Flat front panels

Flat front panels for subracks and enclosures | 1 to 9 U and 2 to 84 HP | solid or perforated

FMC Mezzanine front panel

FPGA mezzanine card (FMC) front panels (according to Vita 57.1) | filler panels available

Customized front panels

Front panel according to customer requirements | complete services from raw sheet metal to tested units

EMC front panels

EMC front panels with an immunity from interference and limited emission of interference | front anodized, | rear passivated...

Front Panels for Plug-In-Units | IEC

Front panels for plug-in-units according to IEC | with or without EMC protection | aluminum 2.5 mm | clear anodised

Fan front panels

Fan front panels with vertical / horizontal ventilation or for direct fan mounting.

Front Panels for Plug-In-Units | IEEE

EMC front panel for IEEE plug-in-units | 3 and 6 U | up to 14 HP



Double LED arrays | bi-color | 20 mA

Double LED arrays | green / green | 2 or 10 mA

Double LED arrays | red / green | 2 or 10 mA

Single LED arrays | yellow | 2 or 10 mA

Single LED arrays | blue | 20 mA



Guardbox 33 easy - a simple but tough case in different sizes

A robust small enclosure in different sizes and designs. It guarantees optimal, professional covering of your cards or...

Stylebox 15 smart - for 19" plug-in or desktop application

A desktop, plug-in or portable enclosure according to 19" standards with scalable EMC protection. It enables many...

ID-Case 18 - sophisticated design with exceptional functionality

Combines an exceptionally functional construction with a sophisticated design. Thanks to its unique construction concept...

Shapebox 22 - plastic enclosure in customer defined shape

Individual plastic enclosures that can be manufactured without expensive molding tools. Therefore, prototypes are available...

BT Box 24 - a standard enclosure for many application

A basic enclosure for a variety of applications and designed cost effective for higher volumes. The enclosure is made of...

Guardbox 33 - a tough case in different sizes and outstanding protection options

The aluminum case is available in different sizes and designs. A very robust construction allows installation of Eurocards...

ELOS Box 54 - an extruded profile enclosure for two or three Eurocards

The box is an embedded enclosure for 2 to 3 controller cards. It consists of an aluminum profile and it is especially...

ID-Box 16 - versatile enclosure for high-quality electronic

A versatile enclosure for high-quality electronic components. Since it is independent of standards, the ID-Box 16 can be...

Compact Case 20 - practical enclosure in excellent design

The Compact Case 20 combines flexibility, practicability and intelligent design. Available in four different sizes and three...



Magic-Kit 11 - the cost-effective IEC solution

Shielded subracks for IEC applications. EMC subrack made of sheet steel for extremely fast mounting and EMC without seals.

Slimkit 10 FTTx - for fiber optic termination

Cable end distributor 19", 1 U for splitting fiber optic cables. Front panel and design can be customized.

ELMA ONLINE CONFIGURATOR - Anyone can be a designer

customer friendly 3D-configurator :

- Stylebox 15 e-Motion
- Guardbox 33
- Compact Case 20
- ID-Case 18
- EcoKit 11R
- Front Panel
- TechFrame 40

- and more to come



<https://elma.3d-configure.com/>

Capacitors



Power Capacitors made in Europe!

Screw Terminal Series

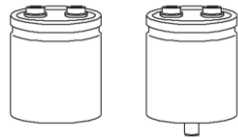

Snap In Series

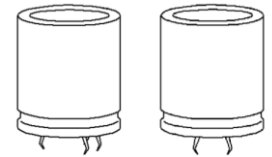

Series	Capacitance Range [uF]	Voltage range [V]	Temperature range [°C]	Case DxH [mm]	Expected lifetime [hrs]	Applications
AR	100-470-000	40-450	-25°, +85°	35x56 76x147	5000	. High CV . Long Life
AY	100-1000000	40-500	-25°, +85°	51x105 90x222	10000	. Extra Long Life . High Temperature . High Ripple
AP	1000-15000	350-500	-25°, +85°	64x107 90x222	12000	. High Reliability . Compact Size
AS	150-330000	25-500	-40°, +85°	35x56 90x222	15000	. Heavy Transient . Industrial Application
AF	1000-15000	350-500	-25°, +85°	64x107 90x222	20000	. Wind and Solar Energy . Power Supplies
AZ	1000-15000	160-450	-25°, +85°	51x105 90x222	3000	. Energy Storage . Railways Applications
AI	100-10'000	350-450	-25°, +85°	64x107 90x222	5000	. Medical Applications . Frequency Converters

Series	Capacitance Range [uF]	Voltage range [V]	Temperature range [°C]	Case DxH [mm]	Expected lifetime [hrs]	Applications
ARC/S/K	100-3300	200	-25°, +85°	30x40 45x100	2000	. Solder Pin Mounting
AKS	100-47000	40-450	-25°, +85°	30x40 40x100	5000	. 2-4-5 Pin . Long Life
ACC ACS	150-33000	25-500	-25°, +85°	30x40 45x100	5000	. Extra Long Life . Low ESR . Compact Size
AMC	330-560	500	-40°, +105°	35x40 35x60	5000	. Large Size . Industrial Application
AZK	100-2200	200-450	-25°, +105°	30x40 40x100	3000	. Wind and Solar Energy . Power Supplies
AZC AZS	100-4700	200-450	-25°, +105°	30x40 40x100	3000	. Energy Storage . Railways Applications
ATK	100-2200	160-450	-40°, +85°	30x40 40x100	5000	. Medical Applications . Frequency Converters
ATC ATS	100-1500	200-450	-40°, +85°	30x40 40x100	5000	. Motor control

Capacitors: SMD and THT version, Film, Aluminum Electrolytic, Ceramic, Tantalum, Audio, Super Capacitors, etc.



Conformal Coating

Conformal Coating AVR80 BA - environmentally friendly

AVR80BA FAMILY
 AVR80 BA DS.. : version ready to use
 AVR80 BA GEL
 AVR80 BA High viscosity
 AVR80 BA BM (Black & Matt)
 AVR80 BA G (Green)
 AVR80 BA ST (whiteout the UV TRACER)

Many options to apply AVR80 BA :

- Dispensing machine
- Film coater
- Jetting
- Spray
- Spray gun
- Aerosol
- Dipping
- Brush
- Pen



Qualification :

- UL94 V0
- NF EN 61086-2
- IPC-CC-830
- MIL-I-46058C
- NF EN 45545, NF EN 16101, NF EN 16102
- IEC 60068-2-60
- (4 gas test/ 21d, 75% RH; 25°C; C12: 10ppm; No2: 200; H2S 10ppm; SO2 : 200 ppm)
- Thermal chock :
- 65°C +125°C, 100 cycles, (IPC CC 830)
- 40°C +105°C, 1500 cycles (IEC 60068-2-14)
- SIR test :
- 20°C-65°C, 95%RH, 7days (IPC CC 830)



Conformal Coating Range

	AVR80 BA	UVP33/ UVP63	NVR95	SVR99	SVP52	High viscosity AVR80 BA GEL
Nature	Acrylic	Urethane	Rubber	Silicone	Silicone	Acrylic
Type of coating	Solvent	Solvent	Solvent	Solvent	Solvent	Solvent
Repairability	Yes	Yes (Locally)	Yes	Yes	Yes (Locally)	Yes
Viscosity (cP) at 25°C	250	230/100	210	155	65	Gel
Dry residue %	30	44/ 34	22	30	45	40
Temperature range	-65°C +150°C	-65°C +125°C	-65°C +150°C	-50°C +125°C	-60°C +200°C	-65°C +150°C
Curing type	RT / IR	RT / IR	RT / IR	RT / IR	RT / IR	RT / IR
Tack free time (mn) RT	20	20/40	10	20	30	30
Dielectric strength (kV/mm)	50	60	80	90	90	50
Stripper	SND/ ABclean	DVP	SND/ ABclean	SND/ ABclean	DVP	SND/ ABclean
Thinner	DVA BA	DVU	DVN	DVS	DVS	n.a
Standards	UL 94V0 /NF EN 61086 /NF EN 55545	UL (In progress)	UL (In progress)	UL 94V0	-	-
Packaging	Flacon 10mL, Stylo 10mL, Aerosol 400mL, 5L	5L	5L	Aerosol 400mL, 5L	5L	Syringe 30mL, 1L

Abchimie 526 UV

temperature range -55°C to +150°C
 Transparent coating with UV TRACER
 UV Mercury or LED curable
 No VOC
 Dual cure
 2 available viscosities :
 55 cSt
 140 cSt
 UL94 V0

	526 UV	746E UV
SIR Test	+++	+
Thermal Shock	+	+++
Residual tack	+	+++
Smell	+	+++

ABchimie 746E UV

temperature range -65°C to +150°C
 Transparent coating with UV TRACER
 UV Mercury or LED curable
 No VOC
 Dual cure
 UL94 V0
 UL746E
 No residual tack
 Soft material for thermal shock

UV Resins and Glues

Which application for UV resins and UV glues?

- Protection of electronic components
- Barriers to prevent capillarity rise of conformal coating
- Bonding of components
- Mechanical support (welds or legs of components)

The main advantage of UV curing products is the speed of curing: only a few seconds under a mercury or LED lamps.
Depending on your needs we will direct you to the most suitable solution



Discover the video of the ABchimie 42K UV resin



Abchimie 9030 UV

UV Glue used for a customer working in lighting to glue lenses on LEDs

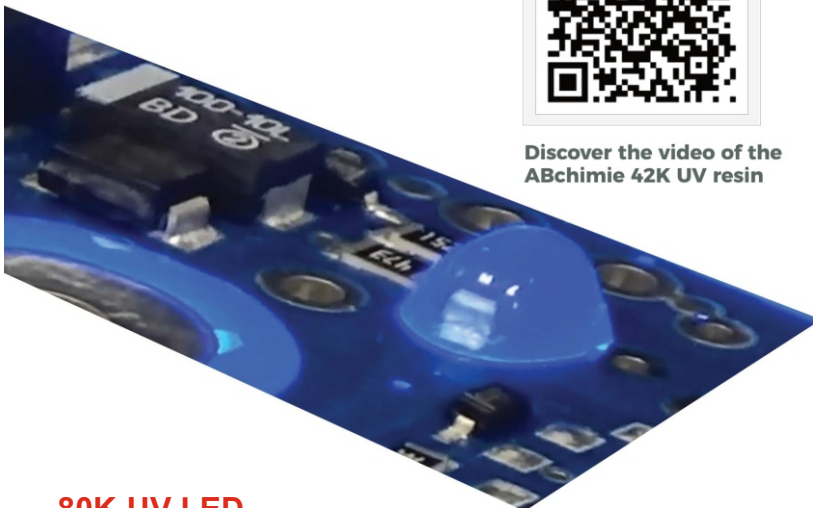

80K-UV LED

- Soft resin,
- Protection against humid thermal environments,
- Excellent adhesion on many substrates (PCB, plastics,...),
- No VOC,
- Curing until 5mm-thickness,
- Very fast curing under UV LED exposure
- LED lamp 395 nm
- UVA2 dose:3000mJ/cm2 for 1mm thickness
- High speed process,
- increase of the productivity,
- Flammability resistance
- approved UL 94V0 (QMJU2-E308681)

	GLUES							
	15K UV	42K UV	80K UV	6028 UV	9005 UV	9030 UV	9111 UV	UV PEELABLE
Nature	Acrylic							
Color	Transparent	Translucent	Transparent	Translucent	Transparent	Transparent	Transparent	Translucent
Hardness (Shore)	D40	D25	D15	D45	D20	D40	D45	A18
Viscosity (cP), 25°C	7,000	32,000	80,000	Thixotropic	40,000	20,000	10,000	Thixotropic
Temperature range	-50°C +150°C	-50°C +150°C	-50°C +150°C	-50°C +150°C	-50°C +130°C	-50°C +150°C	-50°C +150°C	-20°C +120°C
Curing	UV Hg / UV LED	UV Hg / UV LED	UV Hg / UV LED	UV Hg / UV LED	UV Hg / UV LED	UV Hg / UV LED	UV Hg / UV LED	UV Hg / UV LED
UVA dose mJ/cm2	9000	2000	2500	5000	6000	3300	5000	2000
Adhesion	PCBA / Glass / Alu	PCBA / Glass / Alu	PCBA / Glass / Alu	-	Glass / Alu / PMMA / ABS	PET / Glass / Alu / PMMA / PC	Glass / Alu / PMMA / PC	N.A.
Stripper	-	DVP	DVP	DVP	DVP	DVP	DVP	Peelable
Thickness maxi (mm)	5	5	5	4	2	2	2	5
UV resistance	-	--	-	-	+	-	--	N.A.
Standards	-	UL94V0	UL94V0	-	-	-	-	-
Packaging	Syringe 30ml, 330g, 1kg, 5kg, 20kg							

Cable Assemblies



SM C01 0805 40 L:120mm Shielded 0,5mm Type A-B



SM Cable RJ45 + SM C03 2003 08 HS Cable 300mm



SM Assembly Cable USB 2.0 A + 9 Pin Header



SMA-1.37-Cable-103mm-UFL



SM CAB DZD_LITE-0XX



SM C01 KAB-PFL-XX-L

Custom Flat Cable Assemblies

We can offer custom flat cables with connector pitch of RM1,27, RM2,0mm and RM2,54 according to customer requirements.

Customer can determine:

- Connector quantity
- number of poles,
- with (RC5B) strain relief
- without (RC5) strain relief
- cable length
- orientation of connectors (A, B, C, D, E, F).

How to Order:

SM C01 RC5B - X.XX- XX X X (XX) - X - (XX) - XX

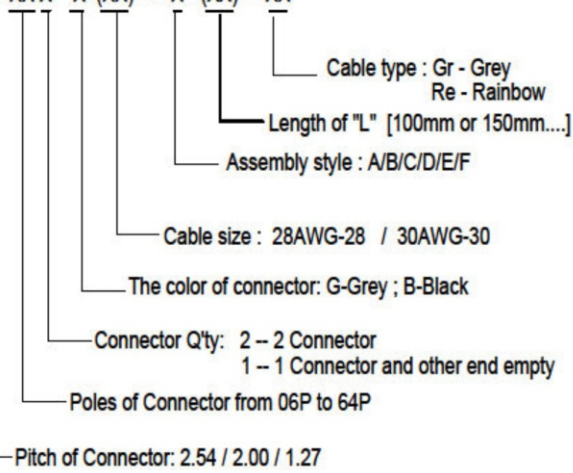

[Type C]

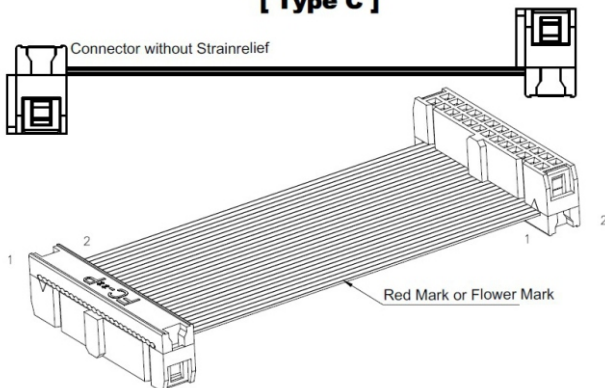

[Type F]

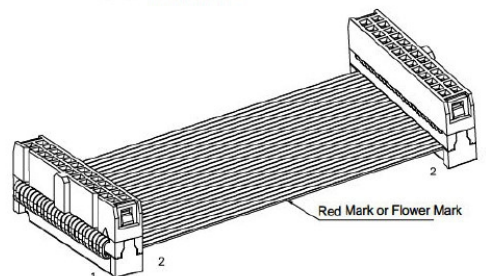
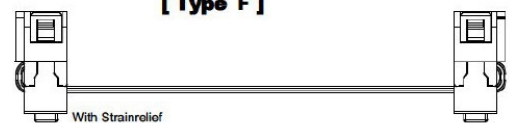

Custom wire wound parts

SCCON-H-502-2, 5A
SCCON-H-502-6, 12A
SCCON-H-502-3, 8A

STI-5026z-220M
STI-6026-121M
STI-7232-151M

TH2P2x27mH
TH2P2x47mH
TH3P2x6,8mH

SWM15

UU 9.8-333-33mH

AUT20-682N

VY-U-19-58



SM FILTER EE 11/6/3 140mH
SM FILTER EE 11/6/3 57mH
SM FILTER EE 11/6/3 10mH

ELG.RM6.FLY
ELG.RM8.HABR

SSC-SH-122
SCC-SH-103

SM TRANS 749-27

SM TRA EL 10

Custom magnet

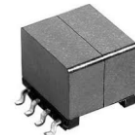

Custom EMI Gasket

57SSM100070100PI00

EMC 95.64.127.NS.TC.PSA
Neopren+Wire Mesh+PSA

EMC WM 0.80.0.80
Square+Neoprene

EMC CF 9005-02
Fingerstock

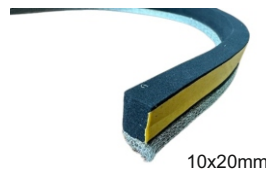

10x20mm

8x8mm

14,5x5,6mm

EMC 6585E
rubber seal+fabric

Custom absorber
cutouts

EMC AIR-Panel 209,5x387,3mm

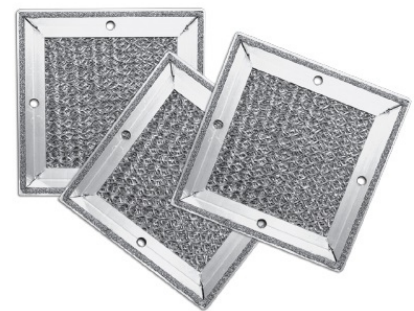
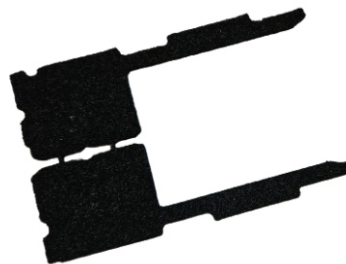

Custom DC/DC converters

- resources for railway applications and transport technology

SVRB4805D-40WG
40W, inp.36-75Vdc, out.5V

SRW-25
25W, EN 50155



Custom connectors

- we can offer production of connectors that have been discontinued

SM C DIN DFS 160W
replacement for ERNI 064711

SM M16 1002FFR01112
SM M16 1002MMZ01112
SM M16 M16 CAP M



Ferrites, Bobbins, Clamps



www.atd-shop.com



Patron
Passive Elektronik

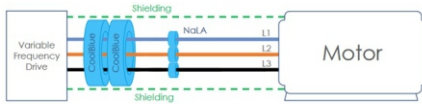

Types 30.000	Types 90.000	Nominal dim. [mm] do x di x h	Finished dim [mm] Do _{max} x Di _{max} x H _{max}	Al [µH] @ 10kHz 30.000	Al [µH] @ 10kHz 90.000	Lfe [cm]	Afe [cm²]
M-306	M-606	16 x 11 x 5	18.4 x 8.6 x 7.0	5.9 - 11.8	18.4 - 36.8	4.2	0.1
M-307	M-607	20 x 15 x 5	22.4 x 12.6 x 7.5	4.5 - 9.1	14.1 - 28.3	5.5	0.1
M-308	M-608	25 x 20 x 5	27.7 x 17.1 x 7.5	3.5 - 7.0	11.0 - 21.9	7.0	0.1
M-309	M-609	30 x 25 x 5	32.7 x 22.0 x 7.5	2.8 - 5.7	9.1 - 18.0	8.6	0.1
M-310	M-610	40 x 35 x 5	42.5 x 31.8 x 7.5	2.1 - 4.2	6.3 - 12.5	11.8	0.1
M-333	M-633	50 x 45 x 5	52.2 x 41.8 x 7.5	1.6 - 3.3	4.6 - 9.1	14.9	0.1
M-334	M-634	60 x 55 x 5	62.0 x 51.6 x 7.5	1.3 - 2.8	4.3 - 8.6	17.7	0.1
M-335	M-635	70 x 65 x 5	72.0 x 61.4 x 7.5	1.1 - 2.3	3.6 - 7.3	20.9	0.1



POT FERRITE



RM FERRITE



EE FERRITE



ETD FERRITE



FEY FERRITE



PEE FERRITE



TOROIDAL FERRITE



EF FERRITE



EC FERRITE



EFD10/EFD15



PEI FERRITE



PM FERRITE



F FBP Type Cores



UU FERRITE



TH Bobbin BASE



TH Bobbin CASE



TH Bobbin EE

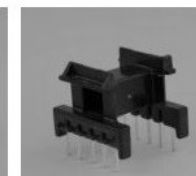

TH Bobbin EF



TH Bobbin POT



TH Bobbin PQ

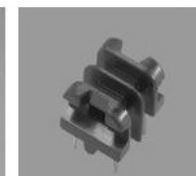

TH Bobbin UU



TH Bobbin RM



TH Bobbin EVD



TH Bobbin ER



TH Bobbin ETD



TH Bobbin EFD



TH Bobbin EP

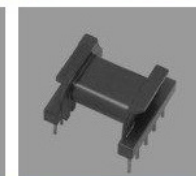

TH Bobbin EPC

Mn-Zn SERIES MATERIAL CROSS REFERENCE LIST

	MTL	P2	P3	P4	P5	HQ2K	H3K	H5K	H6K	H7K	H10K	H12K	H15K
	µi	2500	2300	2200	1400	2000	3000	5000	6000	7000	10000	12000	15000
Ferroxcube(PHILIPS)		3C80 3C85	3F3 3C94	3C96	3F4/3F3.5	3C10 3H3	3E1 3E28	3E4 3C11	3E25	3E27 3E26	3E5 3E55	3E6	3E7
MAGNETICS		P	R		G	F	J	J			W		H
SAMWHA		PL-5	PL-7	PL-9	PL-F1			SM-50		SM-70S	SM-100		SM-150
AVX/TPC		B1	B2/F1	F2	F4			A4	A5	A3	A2		
THOMSON		B30	B51			T13		T6	T4				
EPCOS(SIEMENS)		N41 N27 N26	N67 N87	N97 N53	N49	N48	N41 N61	N30	T35	T37 T44	T38	T42	T46

CHARACTERISTICS CURVE P3

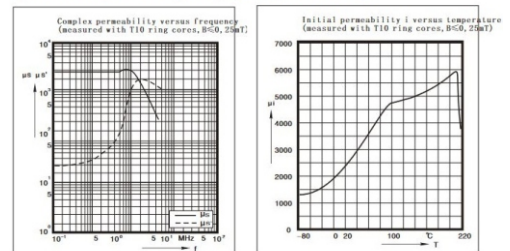

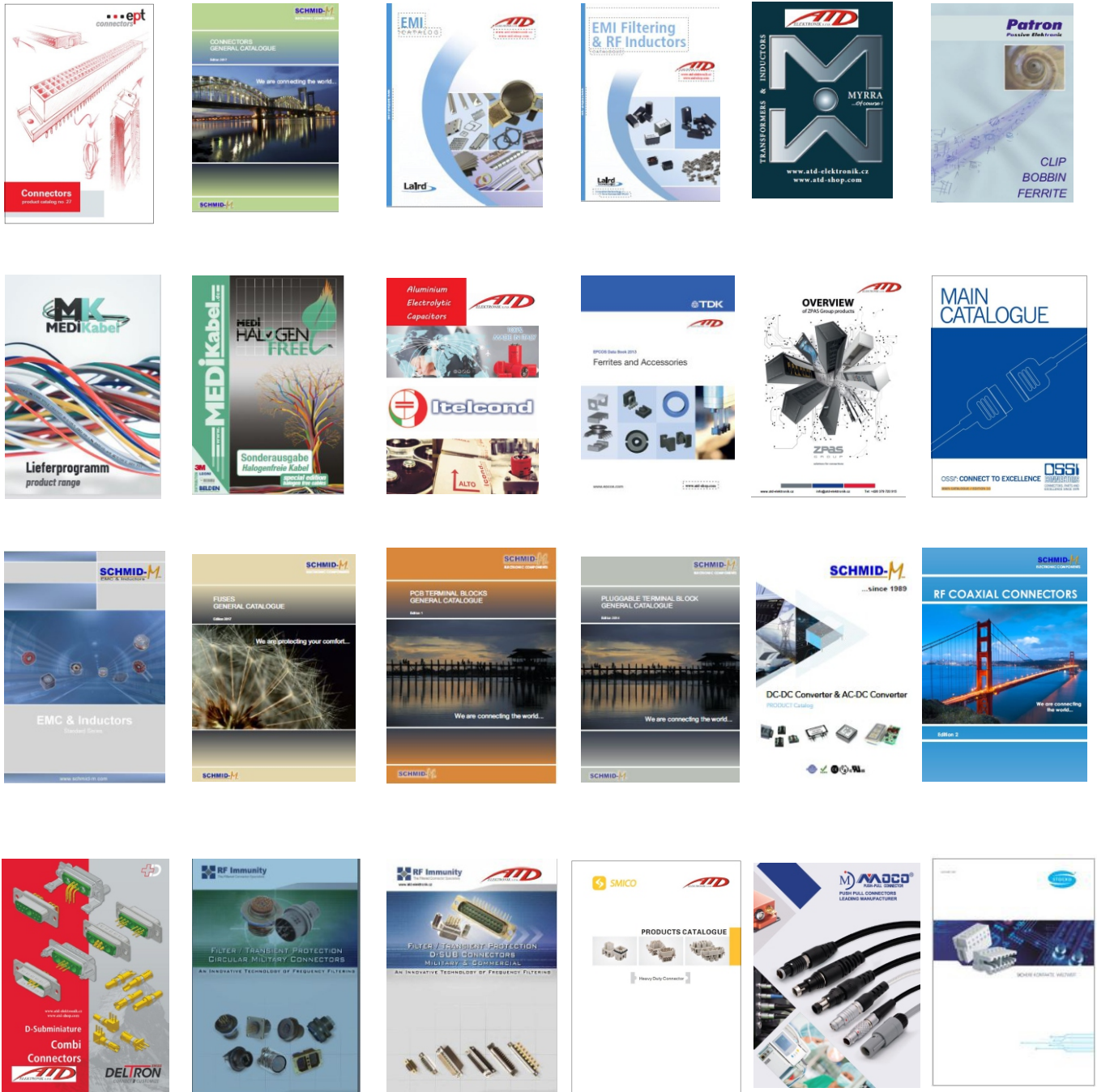

The catalogs can be downloaded at:
www.atd-elektronik.cz/katalogy.html

ATD Elektronik s.r.o.
 Luženice 10
 34401 Domažlice
 tel.: +420 379 723 915
info@atd-elektronik.cz
www.atd-elektronik.cz
www.atd-shop.com