

SMTB Series

Multilayer Ferrite Chip Beads



SMTB 060303 (0201) (0,3-0,15A)
SMTB 100505 (0402) (0,5-0,05A)
SMTB 160808 (0606) (0,4-0,05A)
SMTB 201209 (0805) (0,3-0,2A)
SMTB 321611 (1206) (0,8-0,2A)

SHTB Series

Multilayer Ferrite Chip Beads



SHTB 100505 (0402) (1-1,3A)
SHTB 160808 (1608) (3-1A)
SHTB 201209 (0805) (3-1A)
SHTB 321611 (1206) (3-1A)

SKTB Series

Multilayer Ferrite Chip Beads



SKTB 201209 (0808) (6-4A)
SKTB 321611 (1206) (6-4A)

SMCA Series

Multilayer Ferrite Chip Beads



SMCA 100505 (0402) (0,2-0,3A)
SMCA 160808A (0603) (0,3-0,05A)

SMBA Series

Bead Array



SMBA 321608 (1206) (0,15-0,05A)

SMTI Series

Multilayer Chip Inductors



SMTI 1608 (0603)
SMTI 2012 (0805)
SMTI 3216 (1206)

SHTI Series

Multilayer Ceramic Inductors



SHTI 1050 (0402)
SHTI 1608 (0603)

SMCI Series

Multilayer Ferrite High Current

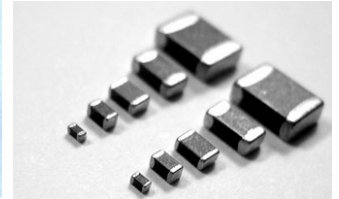

SMCI 2012 (0805)
SMCI 2016 (0806)
SMCI 2520 (1008)

SPTI Series

Thin Film Chip Inductors



SMTB 060303 (0201) (0,3-0,15A)
SMTB 100505 (0402) (0,5-0,05A)
SMTB 160808 (0606) (0,4-0,05A)
SMTB 201209 (0805) (0,3-0,2A)
SMTB 321611 (1206) (0,8-0,2A)

SPWC Series

SMD Common Mode Choke

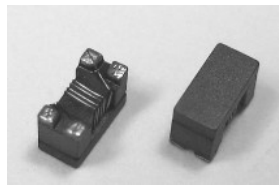

SHTB 100505 (0402) (1-1,3A)
SHTB 160808 (1608) (3-1A)
SHTB 201209 (0805) (3-1A)
SHTB 321611 (1206) (3-1A)

SWTI Series

Wire Wound Chip Inductors



SKTB 201209 (0808) (6-4A)
SKTB 321611 (1206) (6-4A)

SWUI Series

Wire Wound Ferrite Inductor

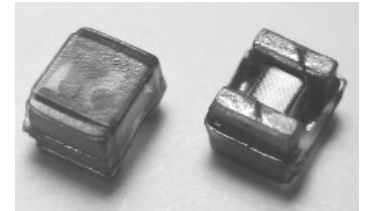

SMCA 100505 (0402) (0,2-0,3A)
SMCA 160808A (0603) (0,3-0,05A)

SWFI Series

Wire Wound Inductors (Ferrite)

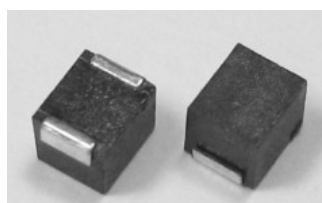

SWGFI Series

W.W. I. (Ferrite High Current)

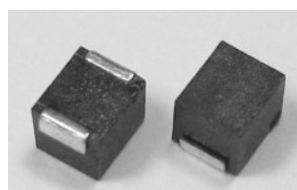

SPK Series

Radial THT inductors



SEC Series

Axial THT Inductors



SMD Power Inductors



www.atd-shop.com

SPRD Series

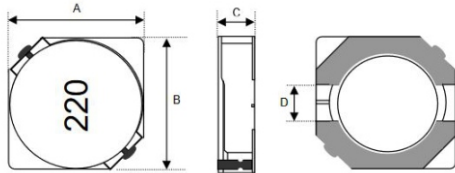
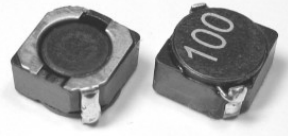

SPRD3018	3,8x3,8x1,65mm	1,5~100μH	1,75~0,25A Irms
SPRD3027	3,8x3,8x2,8mm	4,7~220μH	2,0~0,38A Irms
SPRD3028	3,8x3,8x2,8mm	3,3~100μH	1,95~0,48A Irms
SPRD4011	4,80x4,80x1,15mm	0,47~150μH	3,20~0,25A Irms
SPRD4018	4,80x4,80x1,80mm	1,0~100μH	2,70~0,40A Irms
SPRD4022	4,80x4,80x2,20mm	1,5~150μH	3,50~0,45A Irms
SPRD4028	4,80x4,80x2,80mm	1,2~560μH	3,10~0,22A Irms
SPRD5018	5,80x5,80x1,80mm	1,2~220μH	3,00~0,13A Irms
SPRD5028	5,80x5,80x2,80mm	2,6~680μH	3,00~0,13A Irms
SPRD6022	6,80x6,80x2,30mm	0,9~1000μH	4,80~0,16A Irms
SPRD6028	6,80x6,80x2,80mm	2,5~1000μH	2,80~0,15A Irms

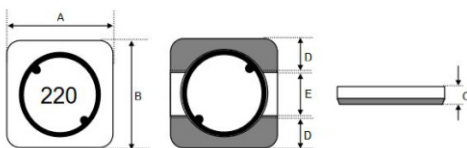

SPRD0318	3,8x3,8x2,0mm	1,0~220μH	2,40~0,13A
SPRD0418	4,7x4,7x2,0mm	1,0~220μH	1,72~0,13A
SPRD0422	4,7x4,7x2,4mm	1,5~150μH	2,00~0,21A
SPRD0403	4,7x4,7x3,0mm	1,2~220μH	2,56~0,2A
SPRD0518	5,7x5,7x3,0mm	2,2~470μH	2,30~0,18A
SPRD0503	5,7x5,7x3,0mm	2,2~680μH	2,60~0,18A
SPRD0603	6,7x6,7x3,0mm	1,0~330μH	6,15~0,35A
SPRD0604	6,7x6,7x4,0mm	1,0~330μH	5,60~0,39A

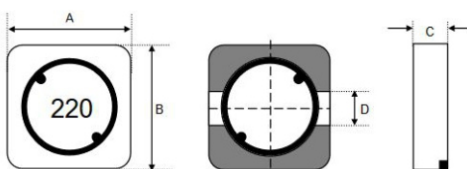

SPRD4010	3,8x3,8x1,25mm	1,00~180μH	1,60~0,11A
SPRD4020	3,8x3,8x2,00mm	0,47~1800μH	1,84~0,036A
SPRD4030	3,8x3,8x3,0mm	1,50~560μH	1,90~0,09A
SPRD5010	5,0x5,0x1,20mm	1,20~1000μH	1,77~0,067A
SPRD5020	5,0x5,0x2,0mm	1,00~820μH	2,70~0,12A
SPRD5030	5,0x5,0x3,0mm	1,00~2500μH	4,00~0,045A
SPRD6915	6,9x6,9x1,50mm	1,00~820μH	3,28~0,10A
SPRD6919	6,9x6,9x1,90mm	1,00~1500μH	3,52~0,095A
SPRD7040	7,3x7,3x4,3mm	0,36~1000μH	9,24~0,18A

SSPU Series

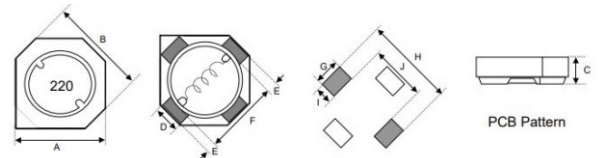

SSPU3009	3,30x3,50x0,95mm	1,3~22μH	1,00~0,22A (Irms)
SSPU3011	3,30x3,50x1,10mm	1,5~10μH	1,10~0,40A (Irms)
SSPU3014	3,30x3,50x1,40mm	1,2~22μH	1,85~0,32A (Irms)
SSPU3017	3,30x3,50x1,80mm	2,2~47μH	1,70~0,36A (Irms)
SSPU3018	3,30x3,50x1,80mm	1,5~15μH	1,65~0,50A (Irms)
SSPU3028	3,30x3,50x2,80mm	10~100μH	0,72~0,19A (Irms)

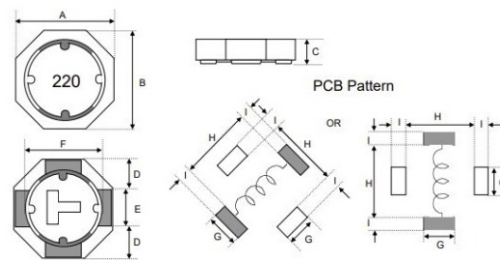

SSPU5011	5,20x5,20x1,10mm	1,5~100μH	1,80~0,20A (Irms)
SSPU5016	5,20x5,20x1,60mm	1,8~100μH	1,75~0,30A (Irms)
SSPU5018	5,20x5,20x1,80mm	1,0~100μH	2,80~0,32A (Irms)
SSPU5028	5,20x5,20x2,80mm	1,2~100μH	3,50~0,47A (Irms)

SSPU8030	8,00x8,00x2,80mm	3,3~100μH	5,00~0,85A (Irms)
SSPU8040	8,00x8,00x3,80mm	3,3~150μH	6,00~0,90A (Irms)
SSPU8045	8,00x8,00x4,50mm	3,5~100μH	5,00~1,00A (Irms)
SSPU8058	8,00x8,00x5,80mm	3,9~100μH	6,50~1,70A (Irms)
SSPU1030	10,0x10,0x2,80mm	3,5~150μH	5,00~0,85A (Irms)
SSPU1040	10,0x10,0x4,8mm	3,8~330μH	6,60~0,62A (Irms)
SSPU1050	10,0x10,0x4,8mm	4,7~1000μH	5,20~0,47A (Irms)
SSPU1065	10,0x10,0x6,6mm	2,8~100μH	6,50~1,80A (Irms)

SSPU8030	8,00x8,00x3,00mm	1,0~100μH	6,50~0,75A
SSPU8040	8,00x8,00x4,00mm	1,8~100μH	7,00~1,05A
SSPU8045	8,00x8,00x4,5mm	1,0~100μH	9,00~1,30A



SSPU0302	3,85x3,85x2,0mm	0,47~1800μH	1,84~0,036A
SSPU0303	3,85x3,85x3,0mm	1,0~3300μH	1,9~0,026A
SSPU0415	3,85x3,85x1,5mm	1,0~100μH	1,50~0,100A
SSPU0502	5,30x5,30x2,0mm	0,47~820μH	2,33~0,120A
SSPU0503	5,30x5,30x3,0mm	0,47~2500μH	4,82~0,045A
SSPU0603	5,90x5,90x3,0mm	1,00~3300μH	4,70~0,078A

SSDB Series

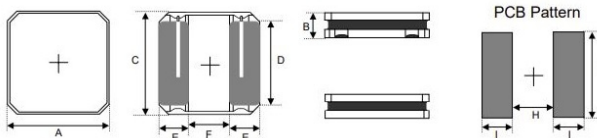
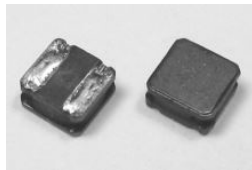

SSDB3010	3,00x1,00x3,00mm	1.0~47μH	1.525~0.270A (I _{rms})
SSDB3015	3,00x1,50x3,00mm	1.0~100μH	2.100~0.250A (I _{rms})

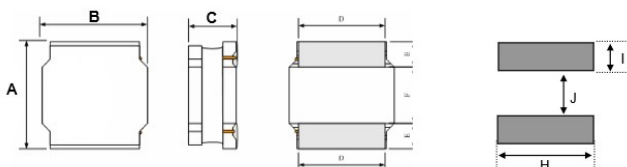

SSDB0418T	4,00x4,00x1,80mm	1.00~100μH	2.000~0.250A (I _{rms})
SSDB0430T	4,00x4,00x3,00mm	1.00~120μH	2.000~0.170A (I _{rms})

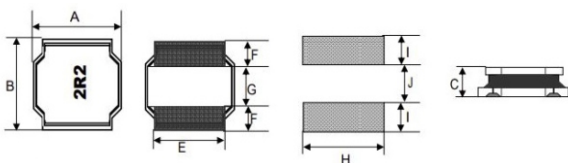

SSDB0520T	5,00x5,00x2,1mm	0.47~100μH	6.15 ~ 0.53A
SSDB0540T	5,00x5,00x4,2mm	1.00~1000μH	7.35 ~ 0.21A

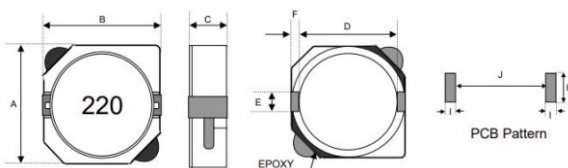

SSDB5D28	6,2x6,3x3,0mm	1.00~100μH	2.900~0.400A
SSDB1003	10,3x10,4x3,1mm	0.56~1000μH	6.200~0.230A
SSDB1004	10,3x10,4x4,0mm	0.56~1000μH	10.000~0.320A

SSPS Series

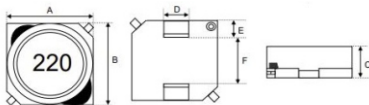

SSPS6028	6,00x6,00x2,80mm	1.0~1000μH	3.80~0.11A (I _{rms})
SSPS6038	6,00x6,00x3,80mm	1.0~1000μH	3.70~0.14A (I _{rms})
SSPS7032	7,00x7,00x3,20mm	3.3~1000μH	2.40~0.15A (I _{rms})
SSPS7045	7,00x7,00x4,50mm	1.0~680μH	5.20~0.40A (I _{rms})

SSPC Series

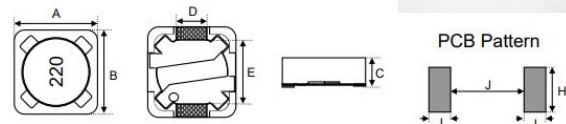
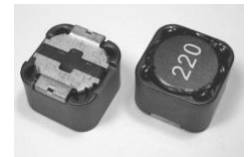

SSPC62B	6,2x5,9x3,0mm	1.5~330μH	3.50~0.19A
SSPC64B	6,2x5,9x5,0mm	10~1000μH	1.35~0.14A
SSPC73	7,3x7,3x3,4mm	1.0~1000μH	7.97~0.16A
SSPC74	7,3x7,3x4,5mm	1.0~1000μH	8.00~0.18A
SSPC124	12,0x12,0x4,5mm	1.5~330μH	8.75~0.50A
SSPC125	12,0x12,0x8,0mm	1.3~1000μH	8.00~0.40A
SSPC127	12,0x12,0x8,0mm	1.0~1000μH	10.00~0.55A
SSPC127H	12,0x12,0x8,0mm	2.2~1000μH	25.50~1.14A
SSPC129	12,0x12,0x10mm	1.0~1000μH	17.00~0.76A

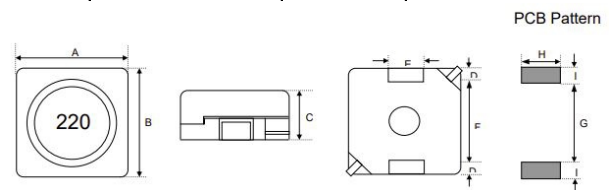

SSPS0603	6,5x6,5x3,10mm	1.5~1000μH	2.20~0.10A
SSPS0604	6,5x6,5x4,60mm	1.5~1000μH	2.80~0.12A

SSPS Series

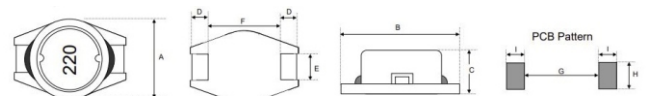

SSPS0804	8,00x10,5x3,70mm	5.0~470μH	1.70~0.16A
SSPS0805	8,00x10,5x4,5mm	2.2~1000μH	2.50~0.15A
SSPS1005	10x12,7x4,9mm	1.0~3300μH	5.80~0.18A

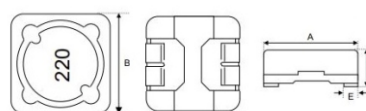

SSPS1205	12,7x12,7x5,0mm	2.5~820μH	5.00~0.30A
SSPS1206	12,7x12,7x6,0mm	2.5~1500μH	6.20~0.20A
SSPS1208	12,7x12,7x8,0mm	2.5~1500μH	7.80~0.36A

SMD Power Inductors



www.atd-shop.com

SSPS Series

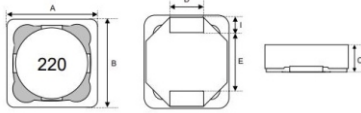

SSPS1240	12,5x12,5x4,0mm	1.0~1000μH	9.30~0.42A (I _{rms})
SSPS1260	12,5x12,5x6,0mm	1.0~1000μH	9.40~0.68A (I _{rms})
SSPS1280	12,5x12,5x7,5mm	1.1~1000μH	10.20~0.68A (I _{rms})

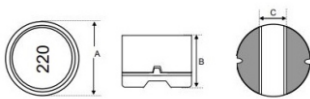

SSPS0704	7,50x4,00x2,60mm	10~270μH	1.70~0.32A (I _{rms})
SSPS1004	9,90x4,50x2,90mm	10~1500μH	3.50~0.26A (I _{rms})
SSPS1307	13,0x7,0x5,0mm	10~1000μH	4.60~0.50A (I _{rms})

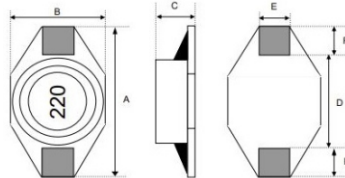

SSPS1608	6,6x4,45x2,92mm	1.0~10000μH	3.00~0.02A (I _{rms})
SSPS3316	12,95x9,40x5,21mm	1.0~1000μH	5.80~0.35A (I _{rms})
SSPS5022	18,54x15,24x7,62mm	1.0~1000μH	20.00~0.90A (I _{rms})

SSBS Series

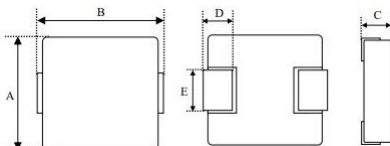

SSBS0412R	4,20x4,40x1,0mm	0.47~4.70μH	6.00~1.80A (I _{rms})
SSBS0420R	4,20x4,40x1,80mm	0.22~10.0μH	9.50~1.60A (I _{rms})
SSBS0518R	5,20x5,40x1,60mm	0.47~10.0μH	10.50~2.50A (I _{rms})
SSBS0530R	5,20x5,40x2,80mm	0.20~10.0μH	14.00~3.20A (I _{rms})
SSBS0618R	6,60x7,00x1,60mm	0.68~22.0μH	9.50~1.80A (I _{rms})
SSBS0624R	6,60x7,00x2,20mm	0.33~10.0μH	18.00~3.10A (I _{rms})
SSBS0630R	6,60x7,00x2,80mm	0.22~33.0μH	24.00~2.00A (I _{rms})
SSBS1040R	10,0x11,50x3,8mm	0.15~33.0μH	45.00~4.40A (I _{rms})

SSBS0420	4,10x4,50x2,1mm	0.10~3.30μH	12.00~2.50A (I _{rms})
SSBS0520	5,0x5,5x2,0mm	0.10~4.70μH	17.00~2.80A (I _{rms})
SSBS0530	5,0x5,5x3,0mm	0.10~4.70μH	23.00~3.50A (I _{rms})
SSBS0620	6,8x7,6x2,0mm	0.10~4.70μH	18.00~3.00A (I _{rms})
SSBS0625	6,8x7,6x2,5mm	0.10~10.0μH	30.00~2.50A (I _{rms})
SSBS0630	6,8x7,6x3,0mm	0.10~22.0μH	32.50~2.50A (I _{rms})
SSBS0650	6,8x7,6x5,0mm	0.56~10.0μH	20.00~4.50A (I _{rms})
SSBS1040	10,4x11,5x4,0mm	0.19~15.0μH	40.00~5.00A (I _{rms})
SSBS1340	13,0x14,2x4,0mm	0.10~10.0μH	43.00~7.00A (I _{rms})
SSBS1350	13,0x14,2x5,0mm	0.10~10.0μH	55.00~9.00A (I _{rms})
SSBS1365	13,0x14,2x6,5mm	0.10~22.0μH	60.00~10.00A (I _{rms})

SSB Series

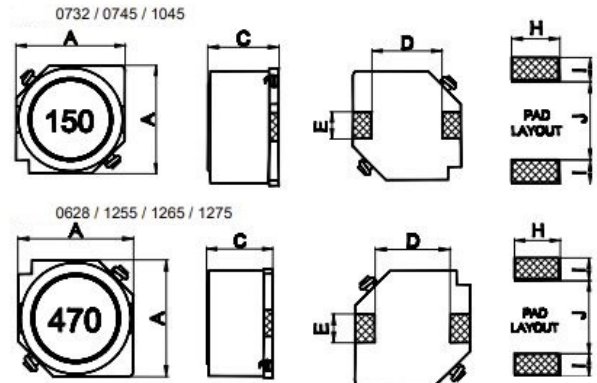

SSB0628	6,00x2,80x4,0mm	1.0~1000μH	2.10~0.12A (I _{rms})
SSB0732	7,00x3,20x4,0mm	1.0~1000μH	2.40~0.20A (I _{rms})
SSB0745	7,00x4,50x4,0mm	1.0~1500μH	3.50~0.15A (I _{rms})
SSB1045	10,1x4,5x6,0mm	1.0~1500μH	12.00~0.40A (I _{rms})
SSB1255	12,5x5,5x8,6mm	6.0~1500μH	4.90~0.48A (I _{rms})
SSB1265	12,5x6,5x8,6mm	2.0~150μH	8.00~0.80A (I _{rms})
SSB1275	12,5x7,5x8,6mm	1.2~330μH	10.40~0.88A (I _{rms})

SSPR Series

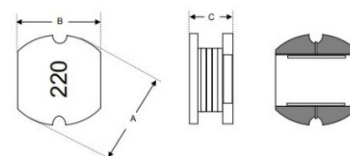

SSPR0301	3.5x3.0x1.45mm	1.0~390μH	1.40~0.10A
SSPR0302	3.5x3.0x2.40mm	1.0~470μH	2.20~0.070A
SSPR0403	4.5x4.0x3.50mm	1.0~1000μH	2.70~0.109A
SSPR0502	5.8x5.2x2.80mm	1.0~1000μH	4.00~0.14A
SSPR0503	5.8x5.2x3.3mm	1.0~1000μH	4.50~0.13A
SSPR0504	5.8x5.2x4.8mm	1.0~1000μH	5.00~0.26A
SSPR0703	7.8x7.0x4.0mm	1.0~1000μH	1.64~0.20A
SSPR0705	7.8x7.0x5.5mm	1.0~1000μH	3.40~0.30A
SSPR1004	10.0x9.0x4.5mm	1.0~560μH	8.70~0.32A
SSPR1005	10.0x9.0x5.8mm	1.2~1000μH	8.63~0.20A
SSPR1007	10.0x9.0x7.5mm	1.0~1000μH	9.50~0.46A

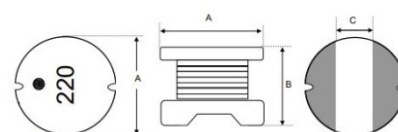

SSPR0603	5.60x3.7x2.3mm	1.5~470μH	3.0~0.15A
SSPR0604	5.60x4.5x2.3mm	1.2~820μH	4.2~0.14A
SSPR0805	7.5x5.0x2.6mm	1.5~4700μH	6.0~0.08A
SSPR1006	9.5x5.5x2.90mm	1.5~4700μH	6.4~0.10A

SSPQ Series

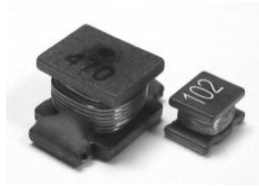
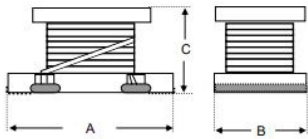

SSPQ322515	3.2x2.5x1.55mm	1.00~100μH	1.00~0.10A
SSPQ322520	3.2x2.5x2.0mm	1.00~560μH	0.445~0.04A
SSPQ453226	4.5x3.2x2.6mm	1.00~2200μH	0.50~0.03A
SSPQ322515C	3.2x2.5x1.55mm	0.47~120μH	3.40~0.17A
SSPQ322520C	3.2x2.5x2.0mm	1.00~560μH	1.00~0.06A
SSPQ453226C	4.5x3.2x2.6mm	1.00~470μH	1.08~0.09A
SSPQ575047C	5.7x5.0x4.7mm	0.12~10000μH	6.00~0.05A

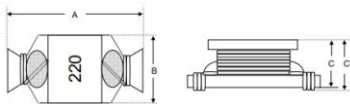

SSPQ0703	6.5x4.5x2.5mm	1.00~1000μH	2.20~0.08A
SSPQ0805	8.8x6.0x4.5mm	0.56~47μH	9.00~1.00A

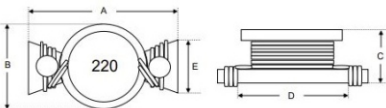

SSPQ1813	8.89x6.4x5.0mm	0.56~100μH	7.70~0.53A
SSPQ4920	19.4x13.3x6.8mm	0.47~100μH	25.10~1.80A

SSPB Series

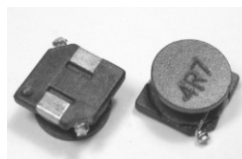
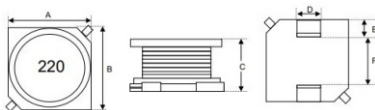

SSPB6028	6.0x6.0x2.8mm	1.5~1000μH	4.0~0.13A
SSPB7030	7.0x7.0x3.0mm	1.0~1000μH	3.0~0.15A
SSPB7045	7.0x7.0x4.5mm	1.2~1000μH	3.8~0.22A
SSPB1030	10x10x3.0mm	2.7~1000μH	3.0~0.20A
SSPB1045	10x10x4.5mm	2.7~1000μH	4.8~0.38A

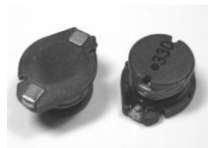
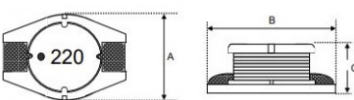

SSPB0805	8.00x10.5x5.0mm	3.3~330μH	5.0~0.46A
SSPB1005	10.0x12.7x5.0mm	1.0~10000μH	7.5~0.10A

SSPB Series

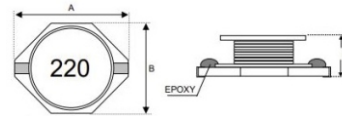

SSPB1608	6.6x4.45x2.92mm	1.0~1000μH	2.9~0.10A
SSPB3308	12.95x9.40x3.00mm	4.7~1000μH	4.2~0.29A
SSPB3316	12.95x9.40x3.00mm	1.0~1000μH	9.0~0.30A
SSPB3340	12.95x9.40x11.43mm	0.47~1000μH	40.0~0.80A
SSPB5022	18.54x15.24x7.11mm	1.0~1000μH	20.0~1.00A

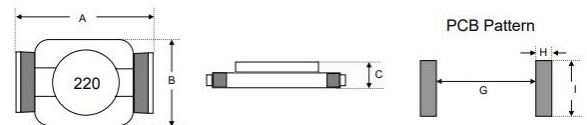

SSPB0610	6.5x5.3x1.0mm	1.2~330μH	2.1~0.13A
SSPB0612	6.5x5.3x1.2mm	1.2~100μH	1.8~0.235A
SSPB0620	6.5x5.3x2.0mm	1.0~1000μH	2.5~0.08A

SSLF Series SMD Line Filter

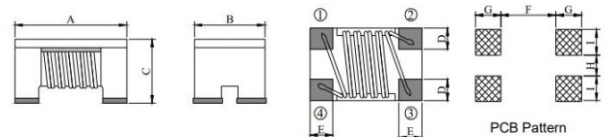
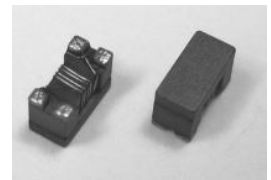

SSLF2012	2x1,2x1,2mm	30,67,90,120,160,180,200,220,260,360,370 Ohm
SSLF3216	3,2x1,6x1,8mm	90,120,160,260,600,1000,2200 Ohm

SSLF Series SMD Line Filter

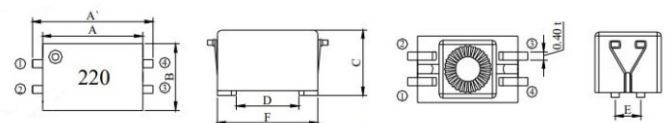
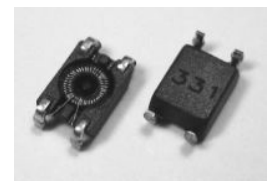

SSLF0503	6x3,3x3,3mm	11,22,33,50uH
SSLF0602	6,5x3,6x1,65mm	10,47,82,100,180,220,330uH
SSLF0904	9x5,4x4,7mm	11,25,51,100,470,1000,4700uH

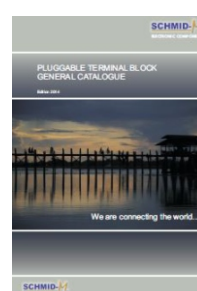
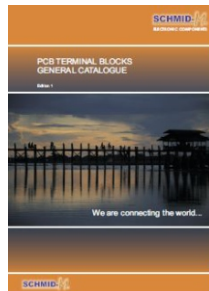
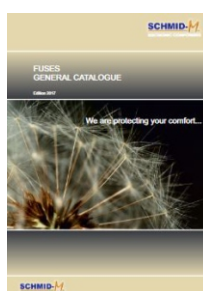
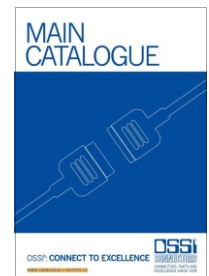
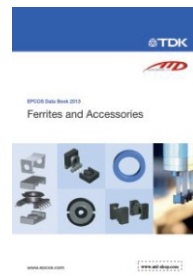
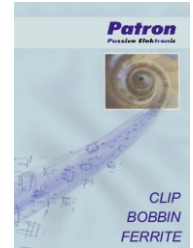
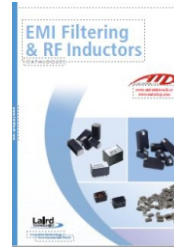

The catalogs can be downloaded at:
www.atd-elektronik.cz/katalogy.html

ATD Elektronik s.r.o.
 Luženice 10
 34401 Domažlice
 tel.: +420 379 723 915
info@atd-elektronik.cz
www.atd-elektronik.cz
www.atd-shop.com