

RF COAXIAL CONNECTORS



We are connecting
the world...

Edition 2

MMCX.....	1
MCX.....	3
MCX75 Ohm.....	5
SMA.....	6
SMB.....	15
SMB75 Ohm.....	18
SMC.....	19
N.....	21
BNC.....	26
TNC.....	30
BMA.....	33
MHV.....	34
7/16 Series.....	35
Reverse Polarity Connectors.....	36
Between Series Adapters.....	37
Cable Assemblies.....	38
UFL/MHF.....	43
Termination.....	44

On internet:
QMA, SMA, FME, Mini-UHF, BNC75 Ohm, Mini SMB75 Ohm, SMP, SSMA, Fakra.

The information provided by this catalogue may be changed without notice. Printing errors reserved.
Copyright 2016 SCHMID-MULTITECH GMBH

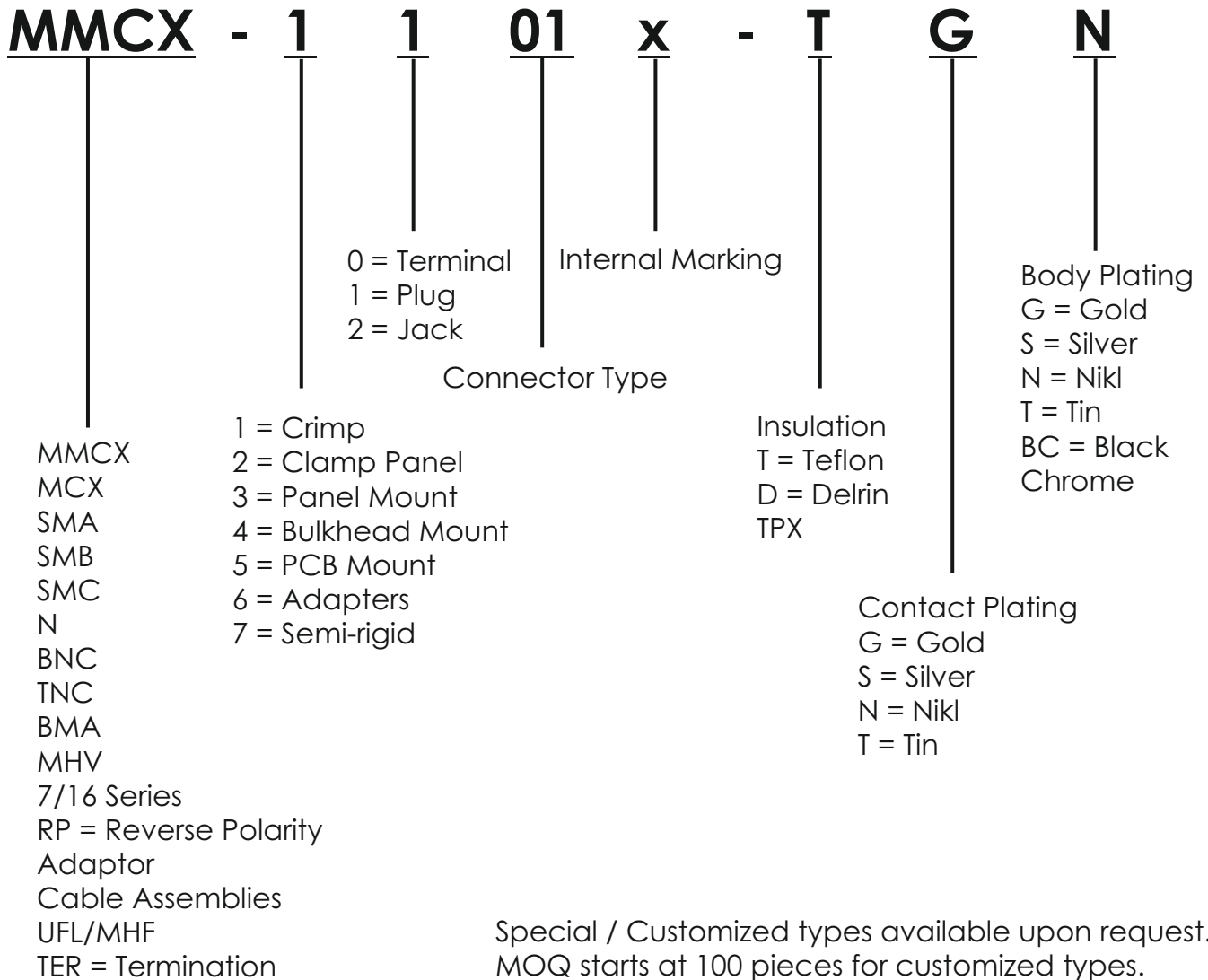

For example:

SMB75-5201c-TGGConnector SMB, 75 Ohm, PCB Mount, Jack, Teflon, Plating: Pin Gold, Body Gold, c - internal manufacturer marking

SMA-3206-TGGConnector SMA, 50 Ohm, Panel Mount, Jack Teflon, Plating: Pin Gold, Body Gold,

SPECIFICATION - MMCX

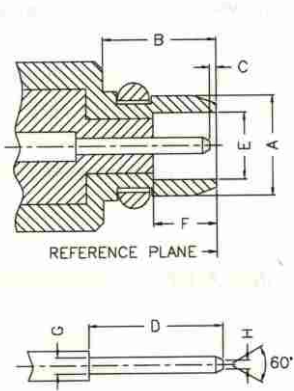

PLUG		
Letter	Millimeters	
	Minimum	Maximum
A	-	2.40
B	2.70	-
C	0.00	0.25
D	-	3.15
E	1.58	1.62
F	1.45	-
G	0.38	0.42
H	-	0.20

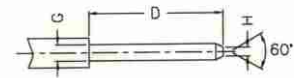

JACK		
Letter	Millimeters	
	Minimum	Maximum
A	2.41	-
B	2.60	-
C	0.90	1.20
D	0.68	0.72
E	1.40	-
F	3.00	3.04
G	2.87	2.90
H	1.57	1.63
I	2.30	2.34
J	-	0.23

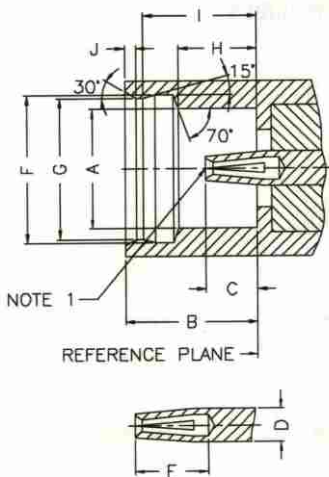

Electrical:	
Impedance	50 Ohm
Frequency Range	0 to 6.0 Ghz
VSWR	0 - 4 GHz = 1.2 max (straight)
	1.25 max (right angle)
	4 - 6 GHz = 1.25 max (straight)
	1.4 max (right angle)
Dielectric Withstanding Voltage	500 V Rms min. at sea level
Contact Resistance	center contact = 5.0 Milliohms max
	outer contact = 2.5 Milliohms max
RF Leakage	(-)60 dB min
Insertion Loss	0.4 dB max (straight)
	0.6 dB max (right angle)
Insulation Resistance	1.000 Megohms min

Mechanical & Environmental:	
Mating	"Push-pull" snap on coupling
Durability	500 matings
Cable Retention	RG - 174, 188, 316 - 20 lbs min
Temperature Range	(-)40 °C to 90 °C
Temperature Shock	MIL-STD-202 Method 107
Humidity	MIL-STD-202 Method 103

Material:		
	Material	Plating
Connector Body	Brass	Nickel or Gold
Center Contact	Male: Brass	Gold
	Female: Beryllium Copper	
Insulation	Teflon	None
Crimp Ferrule	Annealed Copper	Same as Body

Straight Crimp Plug/Male

R/A Crimp Plug/Male

Straight Crimp Plug/Male

Part No.	Applicable Cable RG/U
MMCX-1101-TGG	178, 196
MMCX-1102-TGG	174, 188, 316
MMCX-1103-TGG	RD316u

Part No.	Applicable Cable RG/U
MMCX-1105-TGG	178, 196
MMCX-1106-TGG	174, 188, 316
MMCX-1107-TGG	RD 316u
MMCX-1109-TGG	58, 141A/U, 58A/U

Part No.	Applicable Cable RG/U
MMCX-1108-TGG	58U, 58A/U, 141A/U

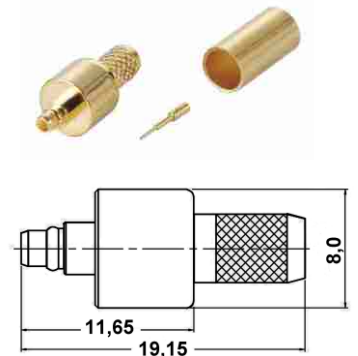
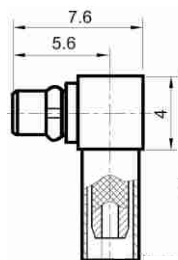
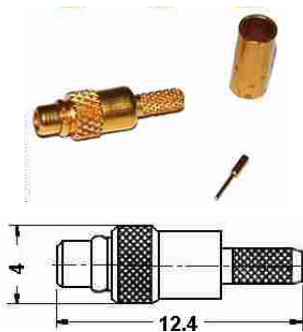

Straight Crimp Jack/Female

Part No.	Applicable Cable RG/U
MMCX-1204-TGG	174,188,316

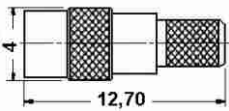

Straight Edge Card Plug/Male

Part No.
MMCX-5101-TGG

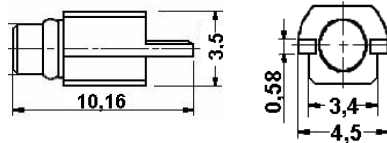

Straight PCB Mount Plug/Male

Part No.	Dimensions
MMCX-5105-TGG	L = 7,5 mm S = 3,5 mm
MMCX-5112-TGG	L = 5,3 mm S = 4,5 mm

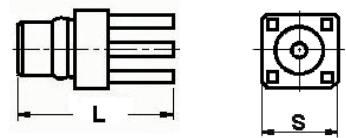

R/A PCB Mount Jack/Female

Part No.	Dimensions
MMCX-5201-TGG	L = 7,00 mm
MMCX-5206-TGG	L = 6,55 mm
MMCX-5207-TGG	L = 5,36 mm

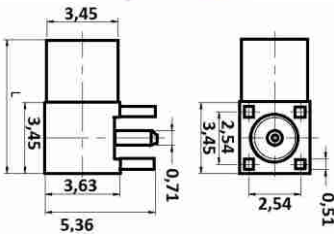

Straight Edge Card Jack/Female

Part No.	Dimensions
MMCX-5203-TGG	L = 8,26 mm
MMCX-5204-TGG	L = 7,37 mm

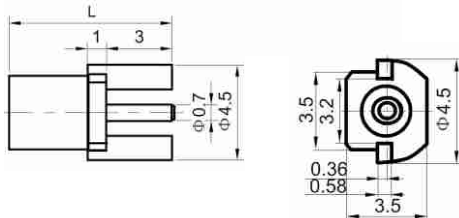

Straight PCB Mount Jack/Female

Part No.	Dimensions
MMCX-5208-TGG	L = 7,42 mm
MMCX-5209-TGG	L = 6,23 mm

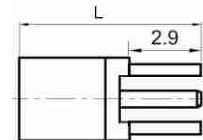

R/A PCB Jack/Female

Part No.
MMCX-5211-TGG

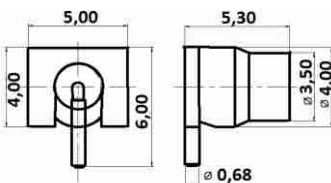

Straight Plug/Male

Part No.	Applicable Cable RG/U
MMCX-7101-TGG	RG 405/u (0.085")
MMCX-7102-TGG	RG 047 (0.047")
MMCX-7106-TGG	RG 402/u (0.141")

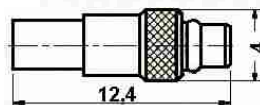

Right Angle Plug/Male

Part No.	Applicable Cable RG/U
MMCX-7103-TGG	RG 405/u (0.085")
MMCX-7104-TGG	RG 047 (0.047")

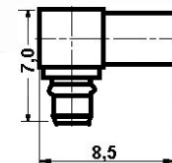

SPECIFICATION - MCX

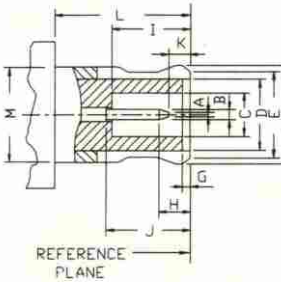

Letter	PLUG Millimeters(Inches)	
	Minimum	Maximum
A	-	0.25(.010)
B	0.48(.019)	0.53(.021)
C	2.00(.079)	2.07(.0815)
D	-	3.00(.118)
E	-	3.60(.142)
F	3.63(.143)	3.80(.150)
G	0.00(.000)	0.30(.012)
H	-	1.20(.047)
I	2.80(.110)	3.20(.126)
J	2.80(.110)	3.20(.126)
K	0.15(.006)	-
L	4.15(.163)	-
M	-	3.40(.134)

Electrical:

Impedance	50 Ohm
Frequency Range	0 to 6.0 GHz
VSWR	0-4 GHz = 1.2 max (straight)
	1.25 max (right angle)
	4-6 GHz = 1.25 max (straight)
	1.4 max (right angle)
Dielectric Withstanding Voltage	500 V Rms min. at sea level
Contact Resistance	center contact = 5.0 Milliohms max outer contact = 2.5 Milliohms max
RF Leakage	(-)>60 dB min
Insertion Loss	0.4 dB max (straight)
	0.6 dB max (right angle)
Insulation Resistance	1.000 Megohms min

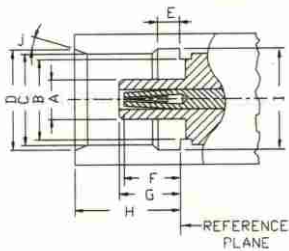

Letter	JACK Millimeters (Inches)	
	Minimum	Maximum
A	1.80 (.079)	1.98 (.078)
B	-	3.00 (.118)
C	3.42 (.135)	3.48 (.137)
D	3.80 (.150)	-
E	0.75 (.029)	0.85 (.033)
F	2.30 (.090)	2.80 (.110)
G	2.60 (.102)	2.80 (.110)
H	4.00 (.157)	4.12 (.162)
I	3.60 (.142)	3.80 (.150)
J	18°	22°

Mechanical & Environmental:

Mating	"Push-pull" snap on coupling
Durability	500 matings
Cable Retention	RG - 174, 188, 316 - 20 lbs min
Temperature Range	(-)>60 °C to 165 °C
Vibration	MIL-STD-202 Method 204 Test Con. B
Salt Spray	MIL-STD-202 Method 101 Test Con. B
Temperature Cycling	MIL-STD-1344 Method 1003 Test.Co.A

Material:

	Material	Plating
Connector Body	Brass	Nickel or Gold
Center Contact	Male: Brass	Gold
	Female: Beryllium Copper	
Insulation	Teflon	None
Crimp Ferrule	Annealed Copper	Same as Body

Straight Crimp Plug/Male

Part No.	Applicable Cable RG/U
MCX-1101-TGG	174, 188A, 316
MCX-1102-TGG	178, 196
MCX-1111-TGG	58, 58A, 141

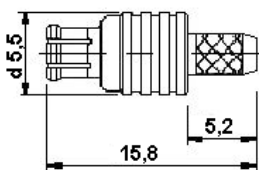

R/A Crimp Plug/Male

Part No.	Applicable Cable RG/U
MCX-1105-TGG	174, 188A, 316
MCX-1106-TGG	178, 196
MCX-1110-TGN	58, 58A, 141 Nickel
MCX-1112-TGG	Cabel HFX50
MCX-1113-TGG	LMR240

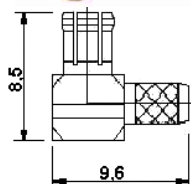

Straight Crimp Jack/Female

Part No.	Applicable Cable RG/U
MCX-1203-TGG	174, 188A, 316
MCX-1204-TGG	178, 196

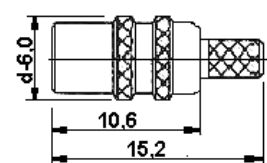

2 Holes Flange Jack/Female

Part No.
MCX-3201-TGG

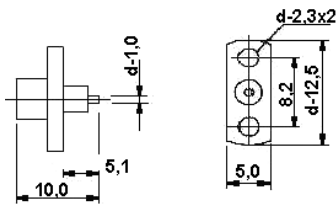

2 Holes Flange Jack/Female

Part No.
MCX-3202-TGG

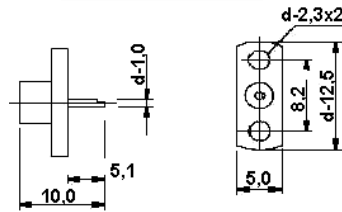

Bulkhead Jack/Female

Part No.
MCX-4201-TGG

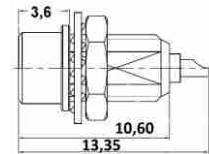

Straight PCB Cable Terminal Crimp

Part No.
MCX-5004-TG

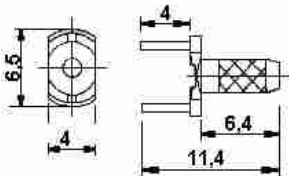

Straight PCB Plug/Male

Part No.	Applicable Cable RG/U
MCX-5101-TGG	L = 9.7 mm, L1 = 3.9 mm
MCX-5102-TGG	L = 8.7 mm, L1 = 2.9 mm
MCX-5103-TGG	L = 7.5 mm, L1 = 1.7 mm

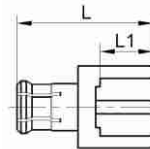

Straight PCB SMD Jack/Female

Part No.
MCX-5201-TGG

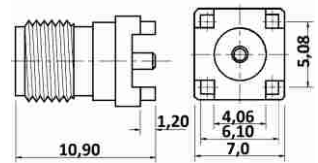

Straight PCB Jack/Female

Part No.
MCX-5202-TGG

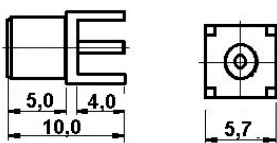

R/A PCB Jack/Female

Part No.
MCX-5203-TGG

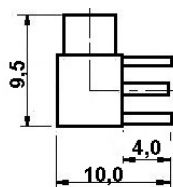

Straight SMT Jack/Female

Part No.
MCX-5205-TGG

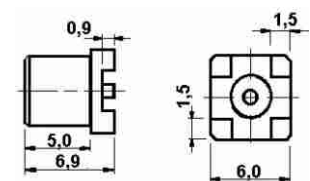

R/A SMT Jack/Female

Part No.
MCX-5206-TGG

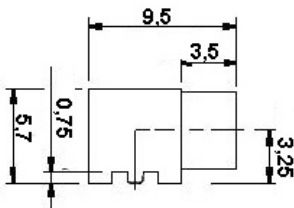

PCB Cable Terminal

Part No.	Applicable Cable RG/U
MCX-7003-G	RG405/U (0.085")

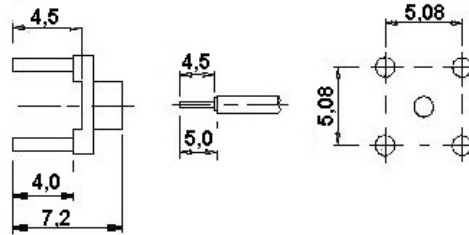

PCB Cable Terminal

Part No.	Applicable Cable RG/U
MCX-7004-G	RG405/U (0.085")

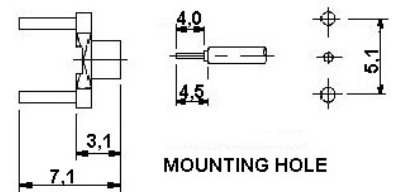

Straight Plug/Male

Part No.	Applicable Cable RG/U
MCX-7101-TGG	RG405/U (0.085")

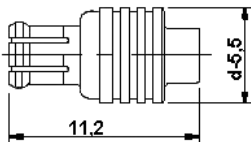

R/A Plug/Male

Part No.	Applicable Cable RG/U
MCX-7102-TGG	RG405/U (0.085")

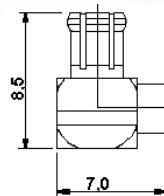

Bulkhead Front Mount Jack/Female

Part No.	Applicable Cable RG/U
MCX-7401-TGG	B1 = 1.3 mm
MCX-7403-TGG	B1 = 2.2 mm; Semi-rigid SFT-50-2-1

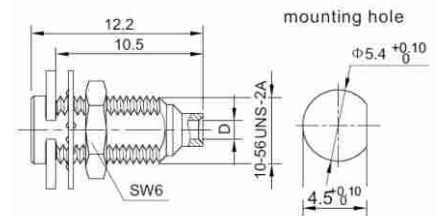

R/A Crimp 75Ohm Plug/Male

Part No.	Applicable Cable RG/U
MCX75-1101-TGG	179

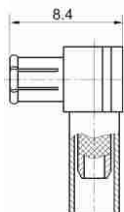

Straight Bulkhead 75Ohm Jack/Fem.

Part No.
MCX75-4201-TGG

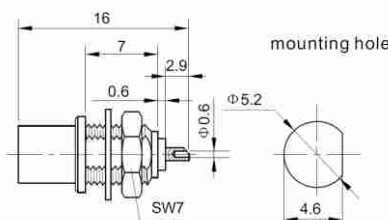

PCB Mount 75 Ohm Jack/Fem.

Part No.	Applicable Cable RG/U
MCX75-5202-TGG	L = 8.3 mm, h = 2.4 mm
MCX75-52021-TGG	L = 11.3 mm, h = 3.9 mm
MCX75-52022-TGG	L = 9.3 mm, h = 3.4 mm

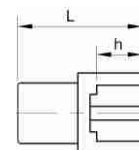

SPECIFICATION - SMA

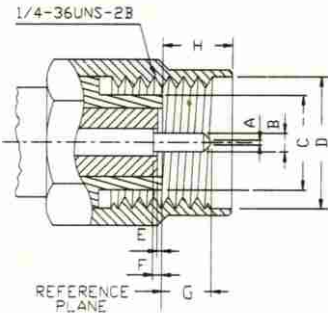

Letter	Millimeters(Inches)	
	Minimum	Maximum
A	0.00(.000)	0.38(0.15)
B	0.90(.0355)	0.94(.037)
C	-	4.59(.1808)
D	6.35(.250)	-
E	0.00(.000)	0.18(.007)
F	0.00(.000)	0.25(.010)
G	-	2.54(.100)
H	-	3.43(.135)

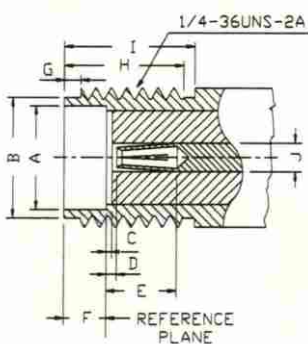

Letter	Millimeters(Inches)	
	Minimum	Maximum
A	4.60(.1810)	4.67(.1837)
B	5.28(.208)	5.49(.216)
C	0.00(.000)	0.18(.007)
D	0.00(.000)	0.25(.010)
E	2.92(.115)	-
F	1.88(.074)	1.98(.078)
G	0.38(.015)	1.14(.045)
H	4.32(.170)	-
I	5.54(.218)	-
J	1.24(.049)	1.30(.051)

Electrical:	
Impedance	50 Ohm
Frequency Range	0 to 18.0 GHz * for RG - 402 & RG405 semi-rigid cable - 0 to 18.0 GHz * for flexible cable ? max operation frequency of cable per MIL-C-17
VSWR	* 1.05 + 0.005 x f GHz max (straight) * 1.15 + 0.015 x f GHz max (right angle) RG - 402 (.141" OD.) - 1.05 + 0.005 x f GHz max RG - 405 (.085" OD.) - 1.05 + 0.005 x f GHz max RG - 58, 141, 142, 223 - 1.10 + 0.01 x f GHz max (straight) 1.15 + 0.02 x f GHz max (right angle) RG - 174, 188, 316 - 1.15 + 0.01 x f GHz max (straight) 1.18 + 0.02 x f GHz max (right angle) RG - 178, 196 - 1.20 + 0.020 x f GHz max (straight) 1.25 + 0.025 x f GHz max (right angle)
Voltage Rating	* RG - 402 (.141" OD.) - 500 V rms max * RG - 405 (.085" OD.) - 335 V rms max * RG - 58, 141, 142, 223 - 500 V rms max * RG - 174, 188, 316 - 335 V rms max * RG - 178, 196 - 250 V rms max
Dielectric Withstanding Voltage	* RG - 402 (.141" OD.) - 1 000 V rms max * RG - 405 (.085" OD.) - 750 V rms max * RG - 58, 141, 142, 223 - 1 000 V rms max * RG - 174, 188, 316 - 750 V rms max * RG - 178, 196 - 500 V rms max
Contact Resistance	center contact = 3.0 Milliohms max outer contact = 2.0 Milliohms max
RF Leakage	(-)90 dB min
Insertion Loss	0.04 dB max x \sqrt{f} GHz (straight) 0.06 dB max x \sqrt{f} GHz (right angle)
Insulation Resistance	5 000 Megohms min

Mechanical & Environmental:	
Mating	1/4" - 36 threaded coupling
Durability	500 matings
Coupling Nut Retention	Min 60 lbs
Recommend Nut Mating Torque	8 inch-pounds
Cable Retention	RG - 58, 141, 142, 223 - 40 lbs min RG - 174, 188, 316 - 20 lbs min
Temperature Range	(-)65 °C to 165 °C
Vibration	MIL-STD-202 Method 204 Test. Cond. D.
Salt Spray	MIL-STD-202 Method 101 Test. Cond. B.
Temperature Cycling	MIL-STD-202 Method 102 Test. Cond. C.

Material:		
Connector Body	Material: Stainless steel Brass	Plating: Passivated or gold Nickel or gold
Center Contact	Male: Brass Female: Beryllium Copper	Gold
Insulation	Teflon	None
Gasket	Silicone	None
Crimp Ferrule	Annealed Copper	Same as Body

Male Nut Cap with chain

Part No.
SM A-1001-TG N



R/A Crimp Plug/Male

Part No.	Applicable Cable RG/U
SMA-1101-TGG	58, 58A, 141A
SMA-1102-TGG	174, 188A, 316
SMA-1103-TGG	142B/U

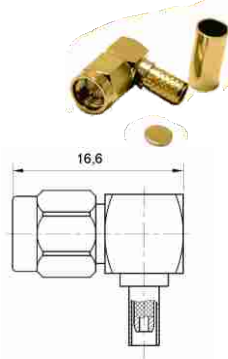

Straight Crimp Plug/Male

Part No.	Applicable Cable RG/U
SMA-1104-TGG	58, 58A, 141A
SMA-1105-TGG	174, 188A, 316
SMA-1106-TGG	142B/U

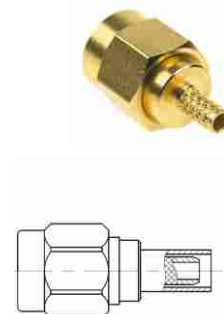

Straight Crimp Plug/Male

Part No.	Applicable Cable RG/U
SMA-1119-TGN	cabl LMR400
SMA-1127-TGN	cabl LMR300
SMA-1128-TGN	cabl LMR240
SMA-1130-TGN	cabl LMR200

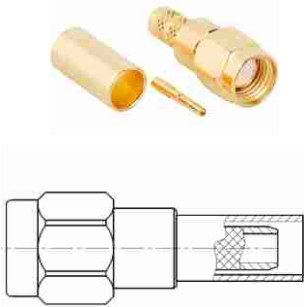

R/A Crimp Plug/Male

Part No.	Applicable Cable RG/U
SMA-1147-TGG	178, 196

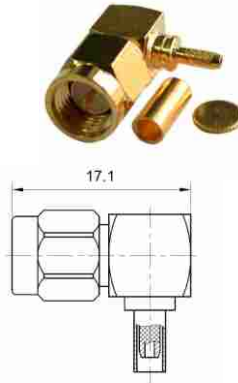

Straight Crimp Jack/Female

Part No.	Applicable Cable RG/U
SMA-1207-TGG	58, 58A, 141A
SMA-1208-TGG	174, 188A, 316
SMA-1209-TGG	142B/U

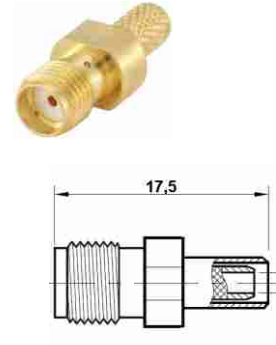

Straight Bulkhead Crimp Jack/F.

Part No.	Applicable Cable RG/U
SMA-1210-TGG	58, 58A, 141A
SMA-1211-TGG	174, 188A, 316
SMA-1212-TGG	142B/U

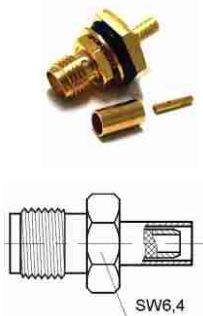

Straight Bulkhead Crimp Jack/F.

Part No.	Applicable Cable RG/U
SMA-1221-TGG	174, 188A/U, 316

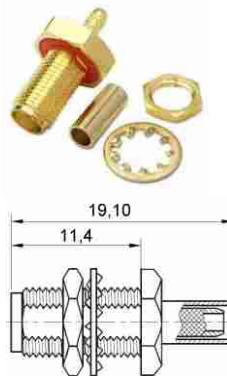

Straight Bulkhead Crimp Jack/F.

Part No.	Applicable Cable RG/U
SMA-1223-TGG	178, 196

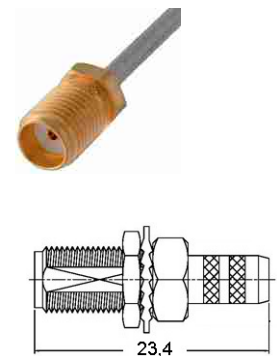

Straight Bulkhead Crimp Jack/F.

Part No.	Applicable Cable RG/U
SMA-1225-TGG	174, 188A/U, 316

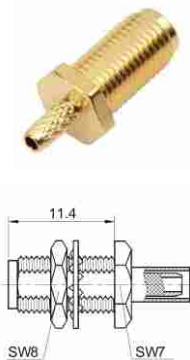

Straight Crimp Jack/Female

Part No.	Applicable Cable RG/U
SMA-1229-TGG	LMR240
SMA-1239-TGG	LMR400
SMA-1241-TGG	LMR200

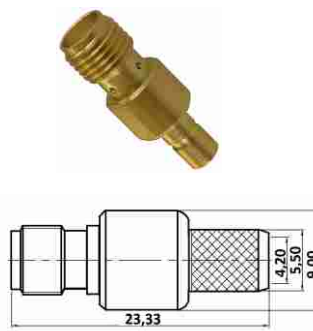

Straight Bulkhead Jack/Female

Part No.	Applicable Cable RG/U
SMA-1230-TGG	RG174, 188, 316
SMA-1231-TGG	SFF-50-2-1
SMA-1232-TGG	RG58, 58A, 141A

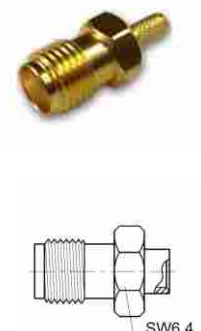

Square Flange Crimp Jack/F.

Part No.	Applicable Cable RG/U
SMA-1236-TGG	223U, 142, 400
SMA-1237-TGG	174U, 188A/U, 316U

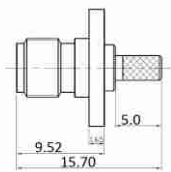

R/A Bulkhead Crimp Jack/Female

Part No.	Applicable Cable RG/U
SMA-1248-TGG	174U, 188A/U, 316U

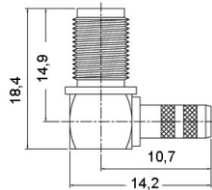

R/A PCB Crimp Jack/Female

Part No.	Applicable Cable RG/U
SMA-1249-TGG	174U, 188A/U, 316U

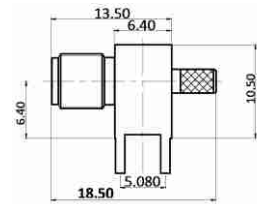

Straight Clamp Jack/F.

Part No.	Applicable Cable RG/U
SMA-2102-TGG	174, 188A, 316
SMA-2103-TGG	142B/U
SMA-2106-TGG	58, 58A, 141A, 142, 223

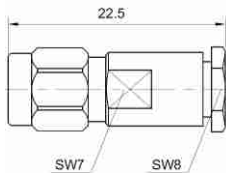

Square Flange Plug/Male

Part No.
SMA-3101-TGG
SMA-3112-TGG

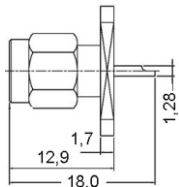

2 Holes Flange Plug/Male

Part No.
SMA-3103-TGG

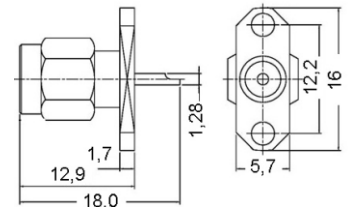

Square Flange Plug/Male

Part No.
SMA-3105-TGG

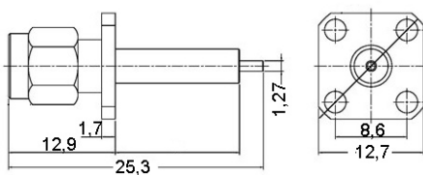

2 Holes Flange Plug/Male

Part No.
SMA-3107-TGG

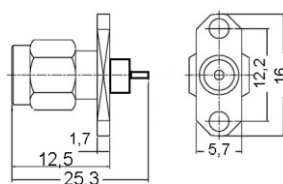

2 Holes Flange Plug/Male

Part No.
SMA-3110-TGG

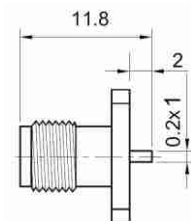

Square Flange Plug/Male

Part No.
SMA-3112-TGG

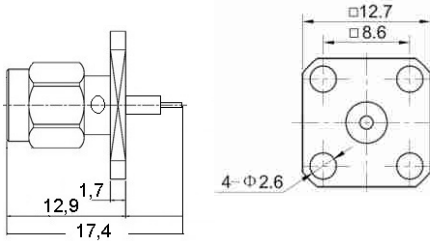

2 Holes Flange Plug/Male

Part No.
SMA-3114-TGG

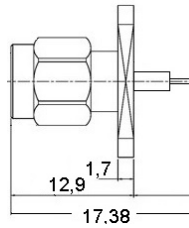

2 Holes Flange Plug/Male

Part No.
SMA-3135-TGG

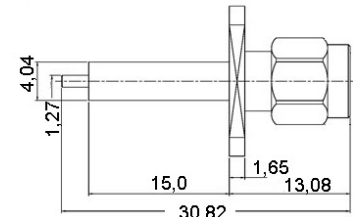

Square Flange Jack/Female

Part No.	Dimensions
SMA-3202-TGG	L = 14.4 mm, L1 = 0 mm, L2 = 4.9 mm
SMA-3201-TGG	L = 12.5 mm, L1 = 0 mm, L2 = 3 mm
SMA-32022-TGG	L = 16.5 mm, L1 = 4 mm, L2 = 3 mm
SMA-32023-TGG	L = 16.5 mm, L1 = 5.5 mm, L2 = 1.5 mm

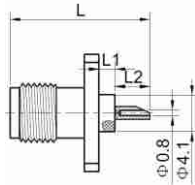

2 Holes Flange Jack/Female

Part No.
SMA-3204-TGG

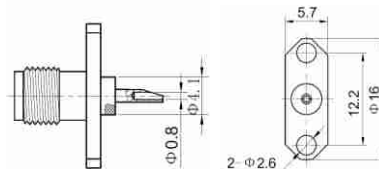

Square Flange Jack/Female

Part No.
SMA-3206-TGG

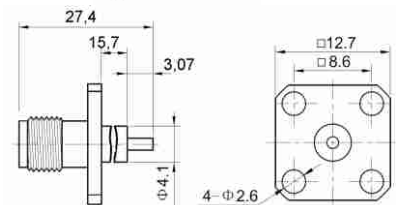

2 Holes Flange Jack/Female

Part No.	Dimensions
SMA-3208-TGG	L = 27.4 mm, L1 = 15 mm, L2 = 3 mm
SMA-32081-TGG	L = 17.5 mm, L1 = 17.5 mm, L2 = 4 mm
SMA-32082-TGG	L = 15.5 mm, L1 = 2 mm, L2 = 4 mm
SMA-32083-TGG	L = 20.5 mm, L1 = 8 mm, L2 = 3 mm
SMA-32084-TGG	L = 37 mm, L1 = 24.5 mm, L2 = 3 mm
SMA-32085-TGG	L = 11.5 mm, L1 = 0 mm, L2 = 2 mm

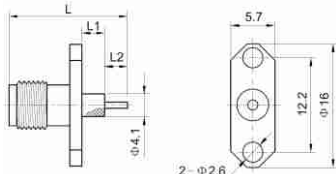

2 Holes Flange Jack/Female

Part No.
SMA-3211-TGG

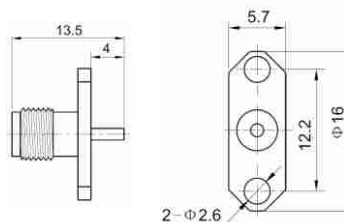

Square Flange Jack/Female

Part No.	Dimensions
SMA-3213-TGG	L=14mm, L1=3.2mm; L2=1.3mm
SMA-3216-TGG	for Microstrip Line Circuits

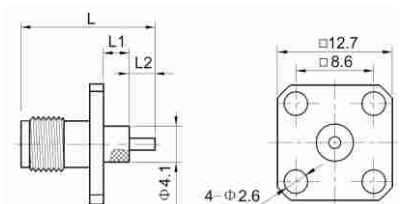

2 Holes Flange Jack/Female

Part No.	Note
SMA-3215-TGG	for Microstrip Line Circuits
SMA-3217-TGG	contact horizontal to panel
SMA-3218-TGG	contact vertical to panel

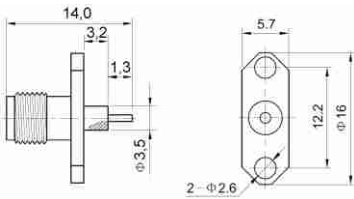

R/A Square Flange Jack/Female

Part No.
SM A-3219-TGG

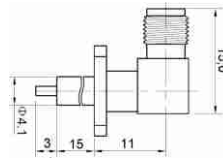

R/A 2 Holes Flange Jack/Female

Part No.
SM A-3220-TGG

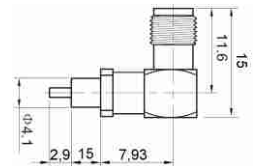

Square Flange Jack/Female

Part No.
SM A-3221-TGG

SLOTTED CONTACT

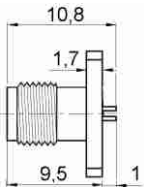

2 Hole Flange Jack/Female

Part No.	Note
SMA-3222-TGG	slotted contact

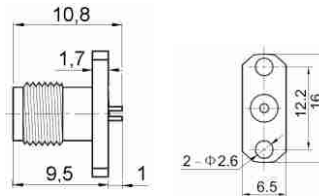

Square Flange Jack/Female

Part No.
SMA-3223-TGG

HALF ROUND CONTACT

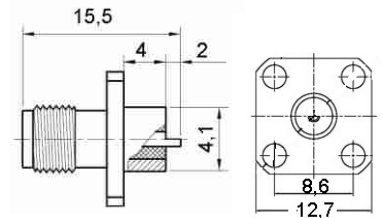

2 Holes Flange Jack/Female

Part No.
SM A-3224-TGG

HALF ROUND CONTACT

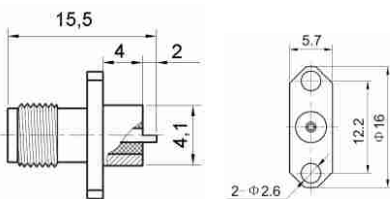

R/A 2 Hole Flange Jack/Female

Part No.
SM A-3233-TGN

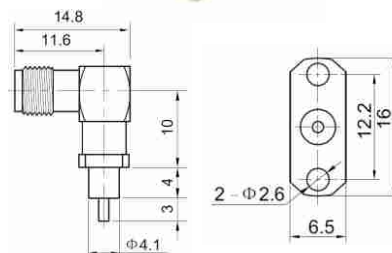

Bulkhead Plug/Male

Part No.
SMA-4115-TGN

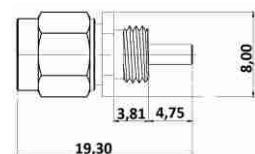

Straight Bulkhead Jack/Female

Part No.
SMA-4201-TGG

Front Mount

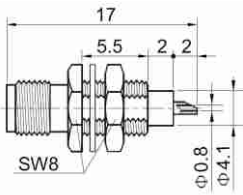

Straight Bulkhead Jack/Female

Part No.
SMA-4202-TGG

Rear Mount

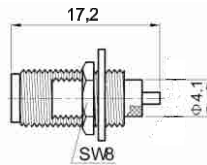
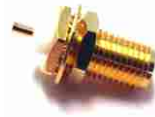

With Coaxial End Jack/Fem.

Part No.	Dimensions
SMA-4203-TGG	L = 16.7 mm, L1 = 2 mm, d = 1.2 mm
SMA-42031-TGG	L = 24.9 mm, L1 = 2.9 mm, d = 1.3 mm
SMA-42032-TGG	L = 15.6 mm, L1 = 3 mm, d = 0.5 mm
SMA-42033-TGG	L = 12 mm, L1 = 1.5 mm, d = 1 mm
	no nut/gasket
SMA-42034-TGG	L = 25.7 mm, L1 = 13 mm, d = 2 mm
	no nut/gasket
SMA-42035-TGG	L = 19.5 mm, L1 = 2.5 mm, d = 1.3 mm
	no nut/gasket

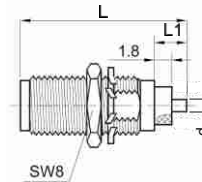

2 Hole Flange Press-in Jack/Female

Part No.
SMA-4204-TGG

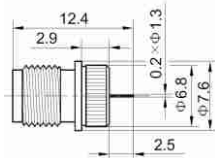

Thread Mount with EMI Bushing

Part No.
SMA-4207-TGG

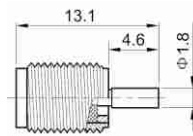

Bulkhead Jack/Female

Part No.
SMA-4209-TGG

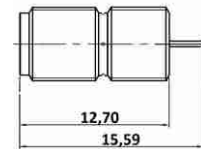

Bulkhead Jack/Female

Part No.
SMA-4211-TGG

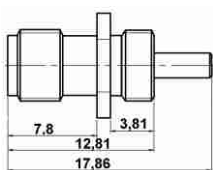

Straight PCB Jack/Female

Part No.	Dimensions
SMA-5201-TGG	L = 13.0 mm, L1 = 3.5 mm
SMA-52011-TGG	L = 13.5 mm, L1 = 3.9 mm
SMA-52012-TGG	L = 12.1 mm, L1 = 2.6 mm
SMA-52013-TGG	L = 15.5 mm, L1 = 2.9 mm

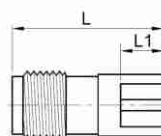

R/A PCB Jack/Female

Part No.
SMA-5202-TGG

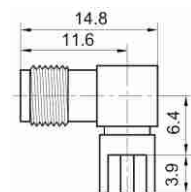

Straight SMD Jack/Female

Part No.
SMA-5203-TGG

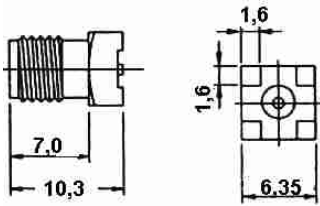

R/A SMD Jack/Female

Part No.
SMA-5204-TGG

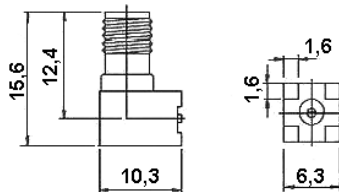

Edge Card Jack/Female

Part No.	Dimensions
SMA-5205-TGG	L = 9.52 mm, L1 = 1.73 mm
SMA-52051-TGG	L = 6.1 mm, L1 = 1.5 mm
SMA-52052-TGG	L = 6.7 mm, L1 = 2.2 mm
SMA-52053-TGG	L = 6.7 mm, L1 = 2 mm
SMA-52054-TGG	L = 6.7 mm, L1 = 2.5 mm
SMA-52055-TGG	L = 6.1 mm, L1 = 1.6 mm
SMA-52056-TGG	L = 6.1 mm, L1 = 1.0 mm

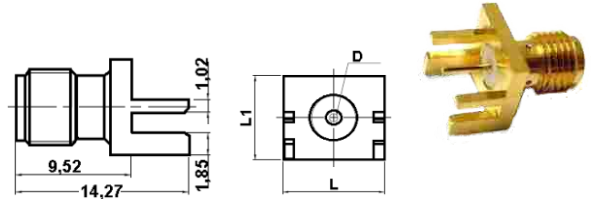

Edge Card Jack/Female

Part No.
SMA-5212-TGG

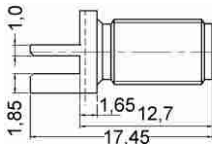

Edge Card Jack/Female

Part No.
SMA-5214-TGG

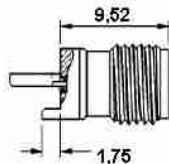

PCB Straight Jack/Female

Part No.
SMA-5215-TGG

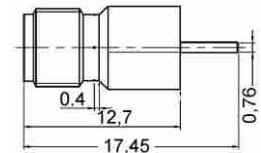

R/A PCB Jack/Female

Part No.
SMA-5223-TGG

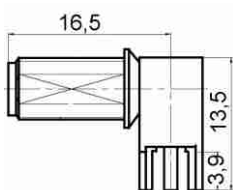

PCB Jack/Female

Part No.
SMA-5229-TGG

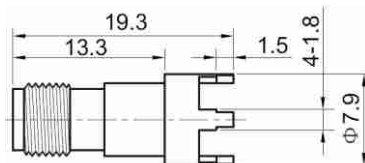

R/A Plug/Male - Jack/Female

Part No.
SMA-601-TGG

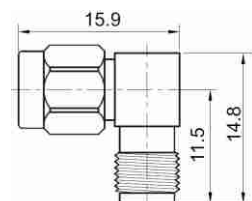

Bulkhead Jack/Female - Jack/Female Plug/Male - Plug/Male

Part No.
SM A-602-TGG

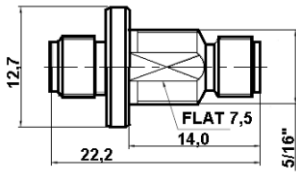

Part No.
SM A-603-TGG

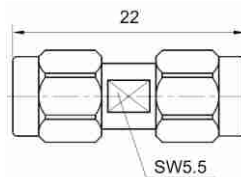

Part No.
SM A-604-TGG

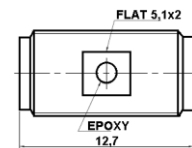

Bulkhead Jack/Female - Jack/Female R/A Plug/Male - Plug/Male R/A Jack/Female - Jack/Female

Part No.
SM A-605-TGG

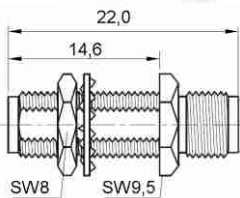

Part No.
SM A-608-TGG

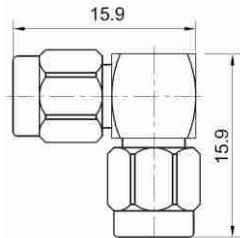

Part No.
SM A-609-TGG

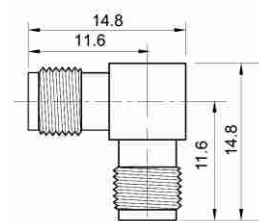

Straight Jack/Fem. - Plug/Male 4 Holes Flange Cable Terminal 2 Holes Flange Cable Terminal

Part No.
SM A-610-TGG

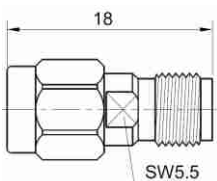

Part No.	Applicable Cable RG/U
SMA-7014-G	RG 402/U (0.141")
SMA-7015-G	RG 405/U (0.085")

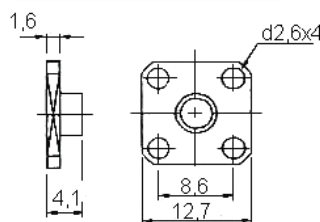

Part No.	Applicable Cable RG/U
SMA-7016-G	RG 402/U (0.141")
SMA-7017-G	RG 405/U (0.085")

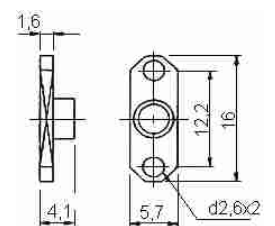

Straight (W/ Center Contact) Plug/Male

Part No.	Applicable Cable RG/U
SMA-7101-TGG	RG 402/U (0.141")
SMA-7102-TGG	RG 405/U (0.085")
SMA-7118-TGG	semi-rigid 0.047"

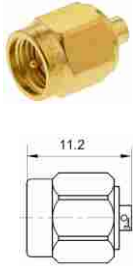

R/A Plug/Male

Part No.	Applicable Cable RG/U
SMA-7111-TGG	RG 402/U (0.141")
SMA-7112-TGG	RG 405/U (0.085")

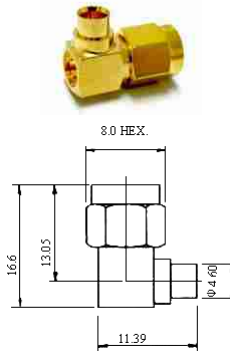

Straight Plug/Male

Part No.	Applicable Cable RG/U
SMA-7113-TGG	RG 401/U (0.250")

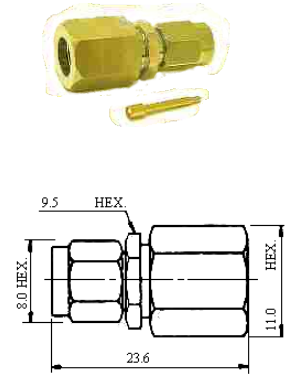

Straight Jack/Female

Part No.	Applicable Cable RG/U
SMA-7203-TGG	RG 402/U (0.141")
SMA-7204-TGG	RG 405/U (0.085")



Straight Bulkhead Jack/Female

Part No.	Applicable Cable RG/U
SMA-7205-TGG	RG 402/U (0.141")
SMA-7206-TGG	RG 405/U (0.085")

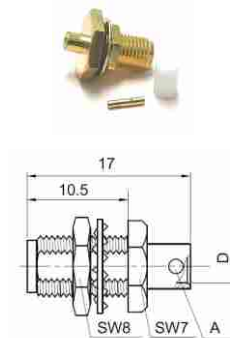

Square Flange Jack/Female

Part No.	Applicable Cable RG/U
SMA-7207-TGG	RG 402/U (0.141")
SMA-7208-TGG	RG 405/U (0.085")

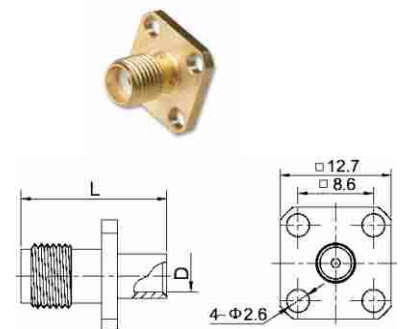

Straight 2 Hole Flange Jack/Female

Part No.	Applicable Cable RG/U
SMA-7209-TGG	RG 402/U (0.141")
SMA-7210-TGG	RG 405/U (0.085")

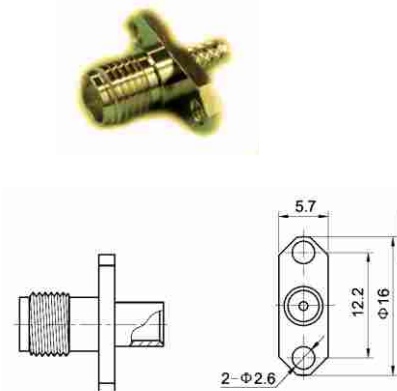

Straight Jack/Female

Part No.
SMA-7221-TGG

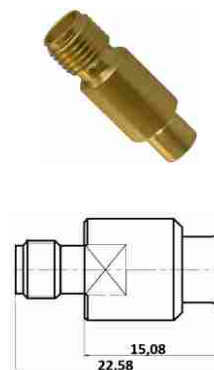

2 Hole Flange Jack/Female

Part No.	Applicable Cable RG/U
SMA-7241-TGG	RG 405/U, L = 12
SMA-7242-TGG	RG 405/U, L = 13.1

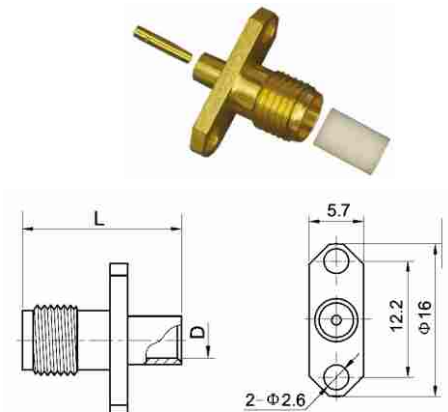

SPECIFICATION - SMB

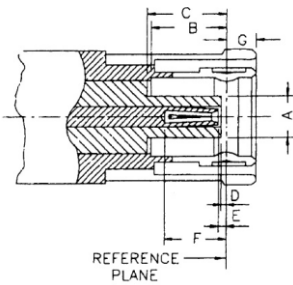

PLUG		
Letter	Millimeters (Inches)	
	Minimum	Maximum
A	2.01 (.079)	2.06 (.081)
B	3.58 (.141)	3.78 (.149)
C	3.58 (.141)	-
D	0.27 (.0105)	0.52 (.0205)
E	0.29 (.0115)	0.57 (.0225)
F	2.97 (.117)	-
G	-	1.63 (.064)

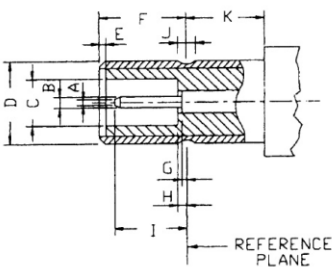

JACK		
Letter	Millimeters (Inches)	
	Minimum	Maximum
A	-	0.25 (.010)
B	0.48 (.019)	0.53 (.021)
C	2.08 (.082)	2.16 (.085)
D	3.66 (.144)	3.71 (.146)
E	0.04 (.0015)	0.24 (.0095)
F	3.33 (.131)	3.53 (.139)
G	0.04 (.0015)	0.18 (.007)
H	-	0.18 (.007)
I	2.39 (.094)	2.72 (.107)
J	0.69 (.027)	0.94 (.037)
K	1.65 (.065)	-

Electrical:	
Impedance	50 Ohm
Frequency Range	0 to 4.0 Ghz
VSWR	1.25 + 0.04 x f GHz max (straight)
	1.30 + 0.04 x f GHz max (right angle)
	* RG - 174,188,316 - 1.25 + 0.04 x f GHz max (straight)
	- 1.3 + 0.04 x f GHz max (right angle)
	* RG - 178,196 - 1.3 + 0.04 x f GHz max (straight)
- 1.4 + 0.06 x f GHz max (right angle)	
Voltage Rating	* RG - 174, 188, 316 - 335 V rms max
	* RG - 178, 196 - 250 V rms max
Dielectric Withstanding Voltage	* RG - 174, 188, 316 - 750 V rms max
	* RG - 178, 196 - 500 V rms max
Contact Resistance	center contact = 6.0 Milliohms max
	outer contact = 1.0 Milliohms max
RF Leakage	(-)55 dB min @ 3 Ghz
Insertion Loss	0.4 dB max (straight)
	0.6 dB max (right angle)
Insulation Resistance	1.000 Megohms min

Mechanical & Environmental:	
Mating	Snap-on coupling
Durability	500 matings
Coupling Nut Retention	40 lbs min
Cable Retention	RG - 174, 188, 316 - 20 lbs min
	RG - 178, 196 - 6 lbs min
Temperature Range	(-)65 °C to 165 °C
Vibration	MIL-STD-202 Method 204 Test Cond. B.
Salt Spray	MIL-STD-202 Method 101 Test Cond. B.
Temperature Cycling	MIL-STD-1344 Method 1003 Test Cond. A.

Material:		
	Material	Plating
Connector Body	Brass	Nickel or Gold
Center Contact	Male: Brass	Gold
	Female: Beryllium Copper	
Insulation	Teflon	None
Gasket	Silicone Rubber	None
Crimp Ferrule	Annealed Copper	Same as Body

An SMB jack has a male center pin, while an SMB plug has a female basket.

Straight Crimp Plug/Male

Part No.	Applicable Cable RG/U
SMB-1101-TGG	174, 188A, 316
SMB-1102-TGG	178, 196

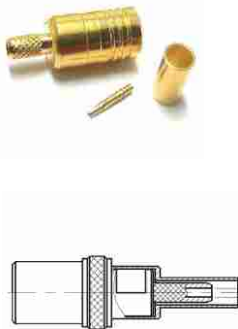

R/A Crimp Plug/Male

Part No.	Applicable Cable RG/U
SMB-1107-TGG	174, 188A, 316
SMB-1108-TGG	178, 196
SMB-1109-TGG	58U, 58A/U, 141A/U

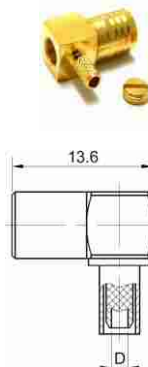

Straight Crimp Plug/Male

Part No.	Applicable Cable RG/U
SMB-1111-TGN	LMR240
SMB-1112-TGN	LMR240

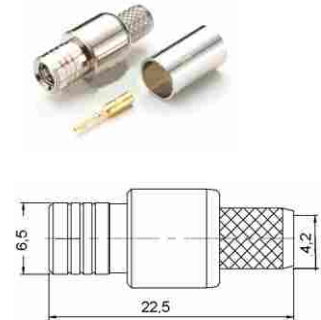

Straight Crimp Jack/Female

Part No.	Applicable Cable RG/U
SMB-1205-TGG	174, 188A, 316
SMB-1206-TGG	178, 196
SMB-1210-TGN	58U, 58A/U, 141A/U

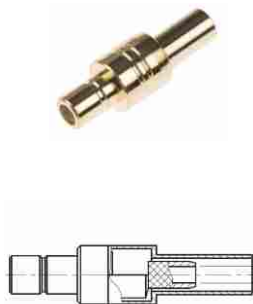

Straight Bulkhead Crimp Jack/Female

Part No.	Applicable Cable RG/U
SMB-1205-TGG	174, 188A, 316
SMB-1206-TGG	178, 196

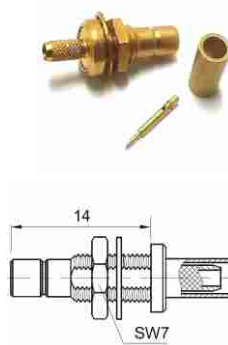

Straight Clamp Plug/Male

Part No.	Applicable Cable RG/U
SMB-2101-TGG	174, 188A, 316
SMB-2102-TGG	178, 196

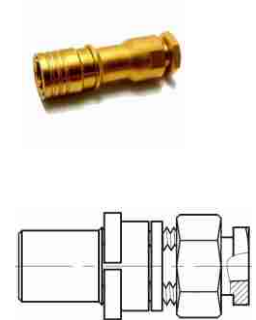

Straight Clamp Jack/Female

Part No.	Applicable Cable RG/U
SMB-2103-TGG	174, 188A, 316
SMB-2104-TGG	178, 196

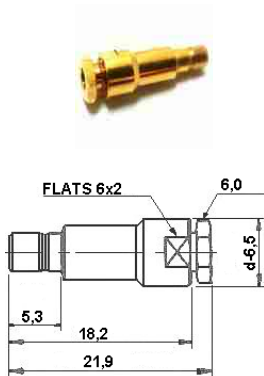

Square Flange Jack/Female

Part No.
SMB-3201-TGG

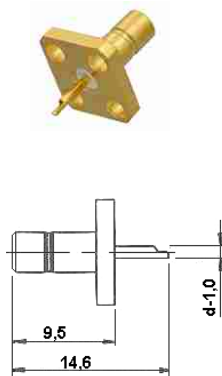

2 Hole Flange Jack/Female

Part No.
SMB-3202-TGG

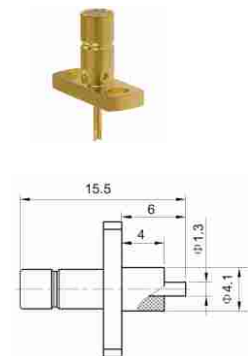

Straight Bulkhead Jack/Female

Part No.	Applicable Cable RG/U
SMB-4201-TGG	Rear Mount
SMB-4202-TGG	Front Mount

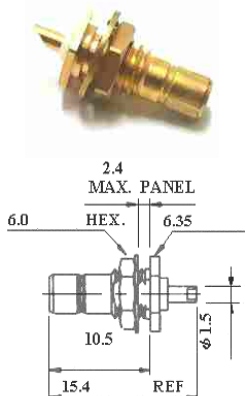

Straight Bulkhead Jack/Female

Part No.
SMB-4203-TGG

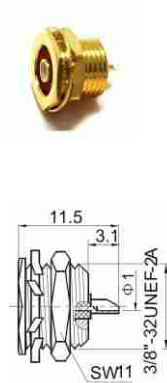

R/A PCB Plug/Male

Part No.	Applicable Cable RG/U
SMB-5101-TGG	
SMB-51011-TGG	with protection cap

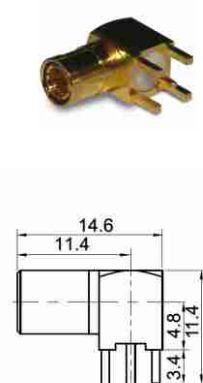

PCB Mount Rec. Plug/Male

Part No.
SMB-5102-TGG

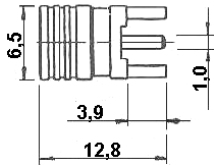

PCB Straight Plug/Male

Part No.	Dimensions
SMB-5103-TGG	L = 12.5 mm, L1 = 3.9 mm
SMB-51031-TGG	L = 21.5 mm, L1 = 2.9 mm

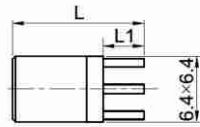

R/A PCB Mount Jack/Female

Part No.	Dimensions
SMB-5201-TGG	L = 15.4 mm, L1 = 12.3 mm
SMB-52011-TGG	L = 21.6 mm, L1 = 18.4 mm
SMB-52012-TGG	L = 13.7 mm, L1 = 10.8 mm
SMB-52013-TGG	L = 15.5 mm, L1 = 12.3 mm

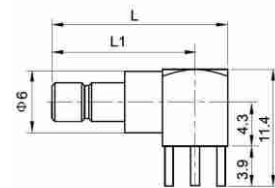

PCB Mount Jack/Female

Part No.	Dimensions
SMB-5203-TGG	L = 11.4 mm, L1 = 6.3 mm
SMB-52031-TGG	L = 10.7 mm, L1 = 5.6 mm
SMB-52032-TGG	L = 18.3 mm, L1 = 13.2 mm
SMB-52033-TGG	L = 13.7 mm, L1 = 8.6 mm
SMB-52034-TGG	L = 9.9 mm, L1 = 5.2 mm

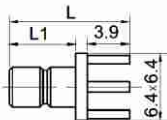
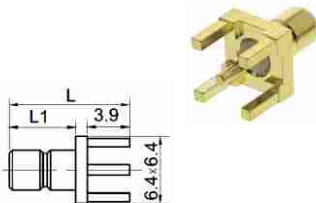

SMT Mount Jack/Female

Part No.
SMB-5204-TGG

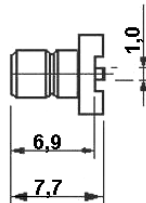

Edge Card Jack/Female

Part No.
SMB-5205-TGG

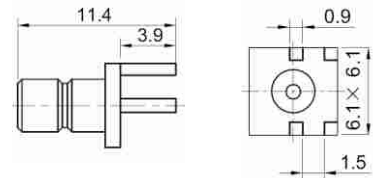

R/A PCB Jack/Female

Part No.
SMB-5206-TGG

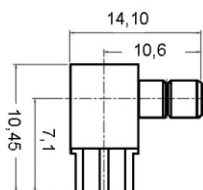

Straight PCB Jack/Female

Part No.
SMB-5207-TGG

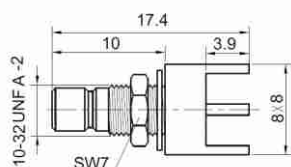

R/A PCB Jack/Female

Part No.	Dimensions
SMB-5210-TGG	L = 17.9 mm, L1 = 11.5 mm, L2 = 14.7 mm
SMB-52101-TGG	L = 21.6 mm, L2 = 15.2 mm, L2 = 18.4 mm
SMB-52102-TGG	L = 21.6 mm, L2 = 15.2 mm, L2 = 14.7 mm with double nut

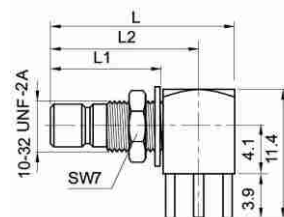

Plug/Male-Plug/Male

Part No.
SMB-601-TGG

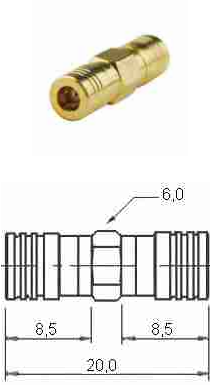

Bulkhead Jack/Female-Jack/Female

Part No.
SM B-602-TGG

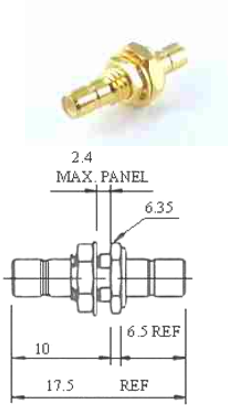

Straight Crimp Plug/Male

Part No.	Applicable Cable RG/U
SMB-7100-TGG	RG 402/U (0.141")
SMB-7101-TGG	RG 405/U (0.085")

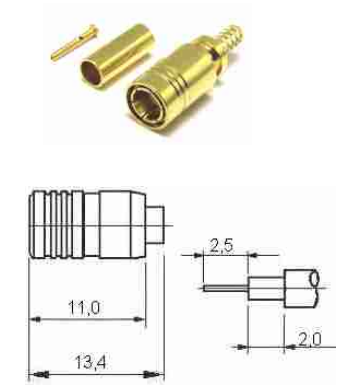

Straight Crimp Plug/Male

Part No.	Applicable Cable RG/U
SMB-7102-TGG	405/U (0.085)
SMB-7103-TGG	402/U; B1 = 3.6 mm cabel B3
SMB-7104-TGG	B1 = 1.3 mm cabel B1

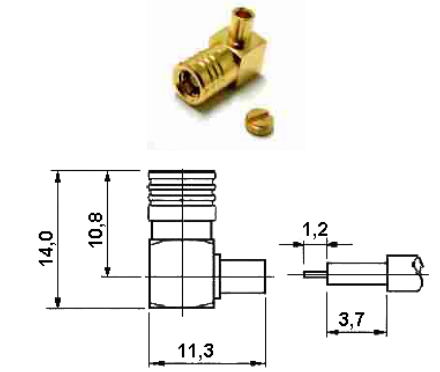

2 Holes Flange Jack/Female

Part No.	Applicable Cable RG/U
SM B-7241-TGG	RG 405/u (0.085")

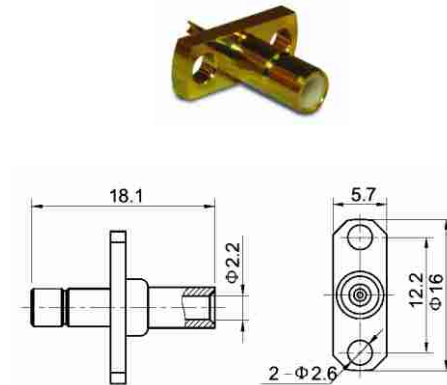

Straight Crimp (75 Ohm) Plug/Male

Part No.	Applicable Cable RG/U
SMB75-1101-TGG	179B, 187A
SMB75-1104-TGG	735A

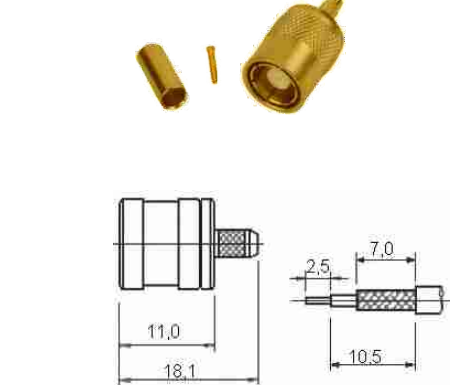

R/A Crimp (75 Ohm) Plug/Male

Part No.	Applicable Cable RG/U
SMB75-1102-TGG	179B, 187A

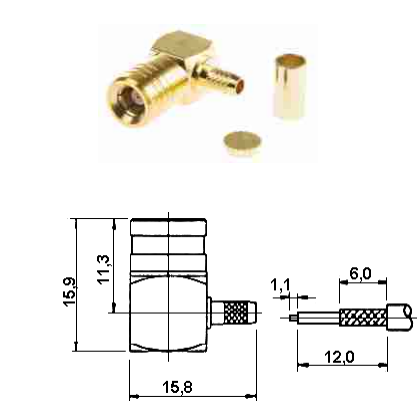

Straight Bulkhead (75 Ohm) Jack/Fem.

Part No.
SM B75-4201-TGG

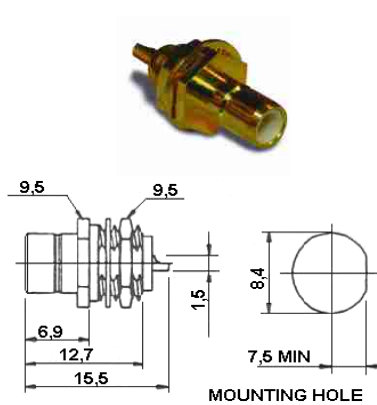

Straight PCB (75 Ohm) Jack/Fem.

Part No.
SMB75-5201-TGG

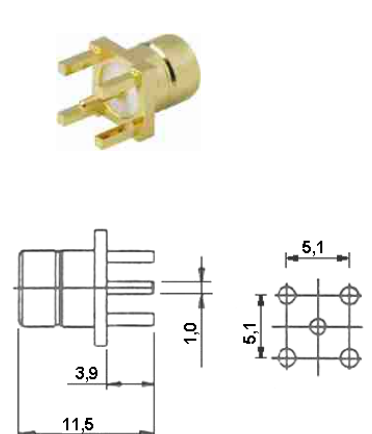

SPECIFICATION - SMC

Electrical:	
Impedance	50 Ohm
Frequency Range	0 to 10.0 Ghz
VSWR	1.15 + 0.04 x f GHz max (straight)
	1.25 + 0.04 x f GHz max (right angle)
	* RG - 174, 188, 316 - 1.15 + 0.04 x f GHz max (straight)
	- 1.25 + 0.04 x f GHz max (right angle)
Voltage Rating	* RG - 174, 188, 316 - 335 V rms max
	* RG - 178, 196 - 250 V rms max
Dielectric Withstanding Voltage	* RG - 174, 188, 316 - 750 V rms max
	* RG - 178, 196 - 500 V rms max
Contact Resistance	center contact = 6.0 Milliohms max outer contact = 1.0 Milliohms max
RF Leakage	(-)-55 dB min @ 3 GHz
Insertion Loss	0.4 dB max (straight)
	0.6 dB max (right angle)
Insulation Resistance	1.000 Megohms min

Mechanical & Environmental:	
Mating	# 10 - 32 threaded coupling
Durability	500 matings
Cable Retention	RG - 174, 188, 316 - 20 lbs min
	RG - 178, 196 - 6 lbs min
Coupling Nut Retention	40 lbs min
Temperature Range	(-)-65 °C to 165 °C
Vibration	MIL-STD-1344 Method 2005 Test Cond. IV.
Salt Spray	MIL-STD-202 Method 101 Test Cond. B.
Temperature Cycling	MIL-STD-1344 Method 1003 Test Cond. A.

Material:		
Connect or Body	Brass	Nickel or Gold
Center Contact	Male: Brass	Gold
	Female: Beryllium Copper	
Insulation	Teflon	None
Gasket	Silicone Rubber	None
Crimp Ferrule	Annealed Copper	Same as Body

PLUG		
Letter	Millimeters(Inches)	
	Minimum	Maximum
A	2.01(.079)	2.06(.081)
B	3.73(.147)	-
C	2.79(.110)	-
D	2.79(.110)	-
E	-	3.10(.122)
F	0.00(.000)	-
G	3.23(.127)	3.40(.134)
H	3.30(.130)	3.40(.134)
I	-	5.92(.233)

JACK		
Letter	Millimeters(Inches)	
	Minimum	Maximum
A	-	0.25(.010)
B	0.48(.019)	0.53(.021)
C	2.08(.082)	2.16(.085)
D	3.66(.144)	3.71(.146)
E	3.12(.123)	3.38(.133)
F	5.94(.234)	-
G	0.00(.000)	-
H	0.79(.031)	-
I	3.40(.134)	3.61(.142)
J	3.40(.134)	3.51(.138)

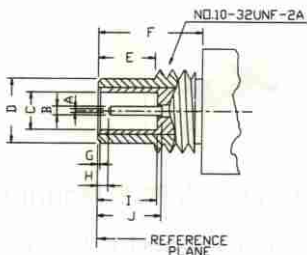
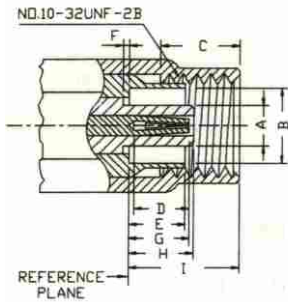

Straight Crimp Plug/Male

Part No.	Applicable Cable RG/U
SMC-1101-TGG	174, 188A, 316
SMC-1102-TGG	178, 196

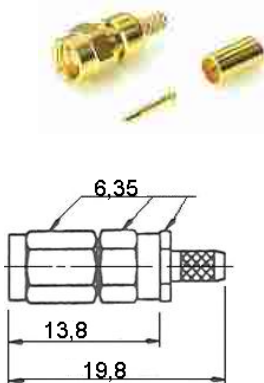

R/A Crimp Plug/Male

Part No.	Applicable Cable RG/U
SMC-1103-TGG	174, 188A, 316
SMC-1104-TGG	178, 196

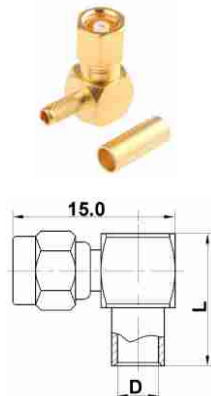

Straight Clamp Plug/Male

Part No.	Applicable Cable RG/U
SMC-2101-TGG	174, 188A, 316
SMC-2102-TGG	178, 196

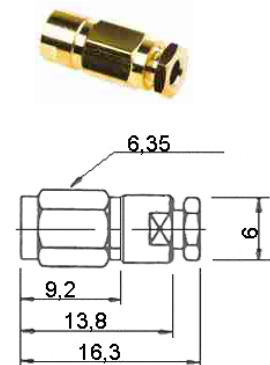

R/A Clamp Plug/Male

Part No.	Applicable Cable RG/U
SMC-2103-TGG	174, 188A, 316
SMC-2104-TGG	178, 196

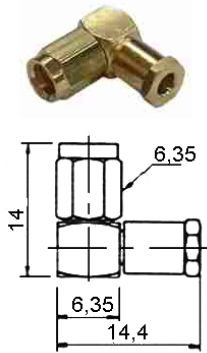

Square Flange Jack/Female

Part No.
SMC-3201-TGG

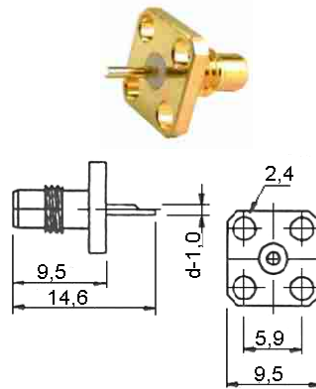

Straight Bulkhead Jack/Female

Part No.
SMC-4201-TGG

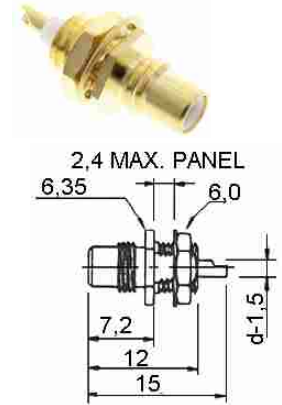

Straight PCB Jack/Female

Part No.
SMC-5201-TGG

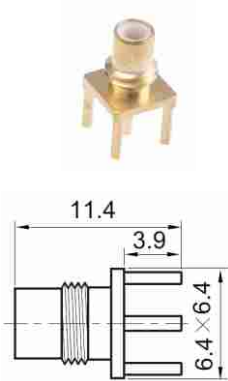

R/A PCB Jack/Female

Part No.
SMC-5202-TGG

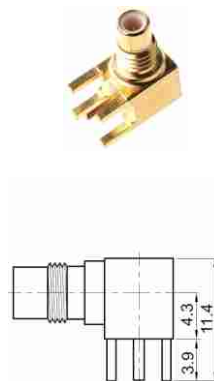

Straight SMD Jack/Female

Part No.
SMC-5203-TGG

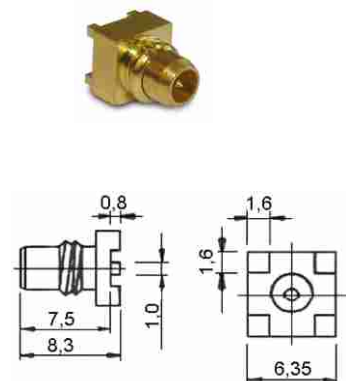

R/A SMD Jack/Fem.

Part No.
SMC-5204-TGG

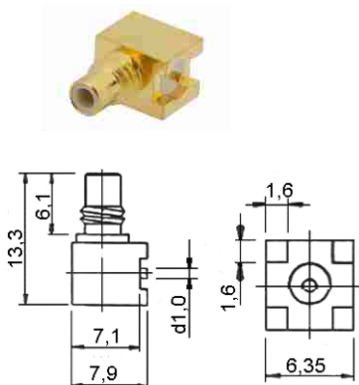

Straight Plug/Male

Part No.	Applicable Cable RG/U
SMC-7101-TGG	RG 405/u (0.085")

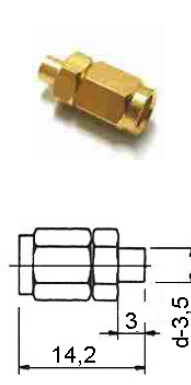

R/A Plug/Male

Part No.	Applicable Cable RG/U
SMC-7102-TGG	RG 405/u (0.085")



SPECIFICATION - N

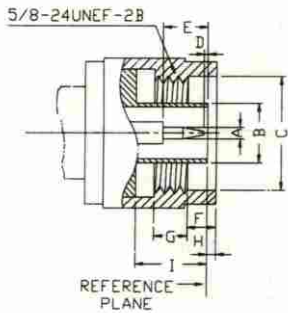

Letter	Millimeters(Inches)	
	Minimum	Maximum
A	1.60 (.063)	1.68 (.066)
B	7.95 (.313)	8.03 (.3158)
C	16.00 (.630)	-
D	0.08 (.003)	-
E	5.33 (.210)	5.84 (.230)
F	4.01 (.158)	4.27 (.168)
G	4.50 (.177)	-
H	0.41 (.016)	1.52 (.060)
I	10.11 (.398)	10.46 (.412)

Electrical:	
Impedance	50 Ohm 75 Ohm
Frequency Range	0 to 12.4 Ghz 0 to 1.5 GHz
VSWR	1.15 + 0.015 x f GHz max
Voltage Rating	1.500 V rms max
	* RG - 58, 141, 142, 223 - 500 V rms max * RG - 174, 188, 316 - 335 V rms max
Dielectric Withstanding Voltage	2.500 V rms max
	* RG - 58, 141, 142, 223 - 500 V rms max * RG - 174, 188, 316 - 750 V rms max
Contact Resistance	center contact = 1.0 Milliohms max
	outer contact = 0.2 Milliohms max
RF Leakage	(- 90 - f GHz) dB min
Insertion Loss	0.05 dB max x √f GHz
Insulation Resistance	5.000 Megohms min

Mechanical & Environmental:	
Mating	5/8" - 24 threaded coupling
Durability	500 matings
Cable Retention	RG - 58, 141, 142, 223 - 40 lbs min
	RG - 59, 62A, 210 - 40 lbs min
	RG - 174, 188, 316 - 20 lbs min
	RG - 8A, 9B, 213, 214 - 80 lbs min
Coupling Nut Retention	100 lbs min
Temperature Range	(-)65 °C to 165 °C
Vibration	MIL-STD-202 Method 204 Test Cond. B.
Salt Spray	MIL-STD-202 Method 101 Test Cond. B.
Temperature Cycling	MIL-STD-202 Method 107 Test Cond. B.

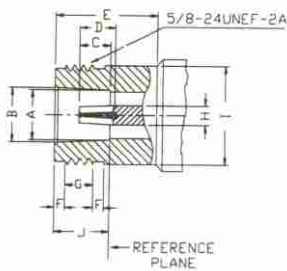

Letter	Millimeters(Inches)	
	Minimum	Maximum
A	8.03 (.316)	8.13 (.320)
B	8.53 (.336)	8.74 (.344)
C	4.75 (.187)	5.26 (.207)
D	5.33 (.210)	-
E	10.72 (.422)	-
F	1.19 (.047)	1.96 (.077)
G	4.37 (.172)	5.13 (.202)
H	3.00 (.118)	3.15 (.124)
I	-	15.93 (.627)
J	9.04 (.356)	9.19 (.362)

Material:		
Connector Body	Brass	Plating Nickel or Silver
Center Contact	Male: Brass	Gold
	Female: Brass	
	Phosphor Bronze or Beryllium Copper	
Insulation	Teflon	None
Gasket	Silicone Rubber, Rubber	None
Crimp Ferrule	Annealed Copper	Same as Body

Connector Cover + Chain

Part No.
N-1001-N

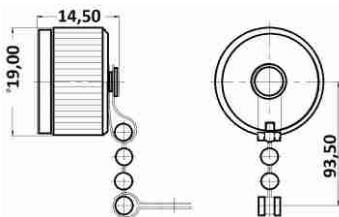

Straight Crimp Plug/Male

Part No.	Applicable Cable RG/U
N-1101-TGN	8A, 213 (UG No. 1681/I)
N-1102-TGN	9B, 214 (UG No. 1682/U)
N-1103-TGN	58, 58A, 141A
N-1104-TGN	59, 62A, 210
N-1118-TGN	LMR240
N-1124-TGN	LMR400
N-1125-TGN	LMR300
N-1129-TGN	LMR200
N-1134-TGN	Belden 9248
N-1148-TGN	LMR 600

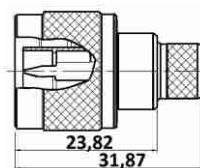

Straight Crimp Plug/Male

Part No.	Applicable Cable RG/U
N-1105-TGN	223, 58, 141
N-1106-TGN	174, 316
N-1149-TGN	178, 196

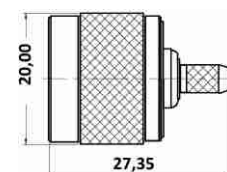

R/A Crimp Plug/Male

Part No.	Applicable Cable RG/U
N-1113-TGN	8A, 213
N-1114-TGN	9B, 214
N-1115-TGN	58, 58A, 141A
N-1116-TGN	59, 62A, 210
N-1119-TGN	174U, 188A/U, 316U

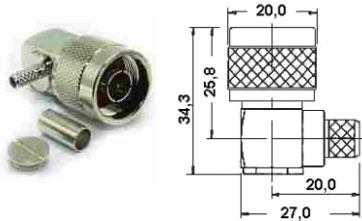

Straight Crimp Jack/Female

Part No.	Applicable Cable RG/U
N-1207-TGN	8A, 213 (UG No. 1688/U)
N-1208-TGN	9B, 214 (UG No. 1689/U)
N-1209-TGN	58, 58A, 141A
N-1210-TGN	59, 62A, 210
N-1211-TGN	58, 58A, 141A
N-1212-TGN	174, 188A, 316
N-1227-TGN	LMR400
N-1228-TGN	LMR200

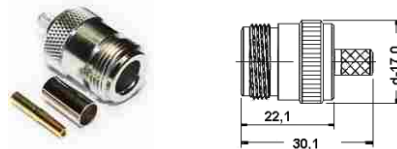

Straight Bulkhead Jack Crimp

Part No.	Applicable Cable RG/U
N-1217-TGN	174, 188A, 316
N-1220-TGN	142u
N-1226-TGN	LMR240
N-1235-TGN	LMR400
N-1240-TGN	178u, 196u

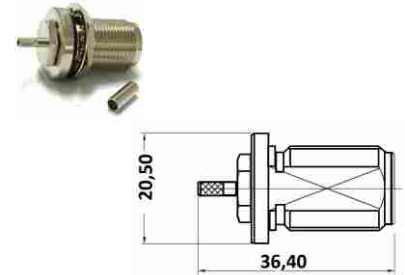

Square Flange Crimp Jack/Female

Part No.	Applicable Cable RG/U
N-1223-TGN	58, 141



Straight Clamp Plug/Male

Part No.	Applicable Cable RG/U
N-2101-TGN	8A, 213 (UG No. 21B/U)
N-2102-TGN	9B, 214
N-2103-TGN	8A, 213 (captive contact)
N-2104-TGN	9B, 214
N-2105-TGN	58, 58A, 141A (UG No. 536B/U)
N-2106-TGN	59, 62A, 210 (UG No. 603A/U)
N-2118-TGN	LMR400
N-2120-TGN	LMR 600
N-2122-TGN	FSJ1-50A
N-2124-TGN	LMR 900

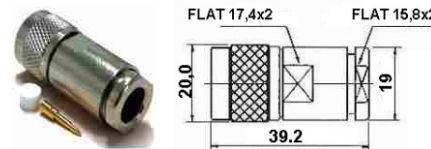

Straight Clamp Plug/Male

Part No.	Applicable Cable RG/U
N-2107-TGN	58U
N-2108-TGN	174U, 316U, 188U

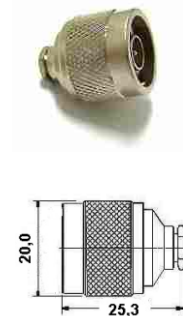

Straight Clamp Cable 1/4" Plug/Male

Part No.	Applicable Cable RG/U
N-2140-TGN	1/4", L = 38.10 mm
	center conductor solder
N-2141-TGN	1/4", L = 44.9 mm
	center conductor without solder



Straight Clamp 3/8" Plug/Male

Part No.	Applicable Cable RG/U
N-2143-TGN	3/8"; center conductor without solder

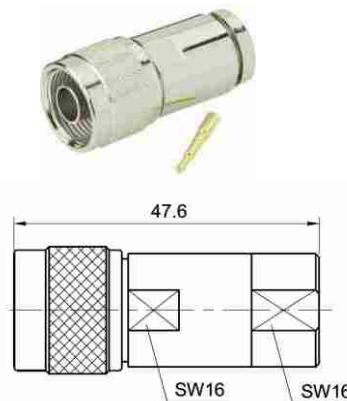

Straight Clamp Plug/Male

Part No.	Applicable Cable RG/U
N-2148-TGN	1/2"

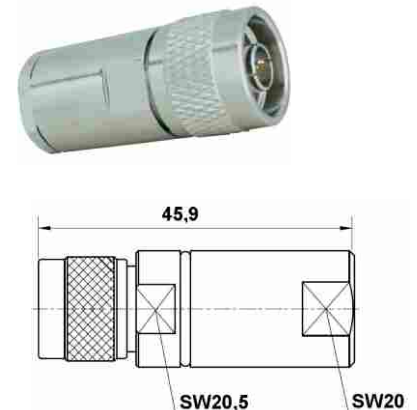

Straight Clamp Jack/Female

Part No.	Applicable Cable RG/U
N-2209-TGN	8A, 213 (L: 46,5 mm)
N-2212-TGN	9B, 214 (L: 35,7 mm)
N-2213-TGN	58, 58A, 141A

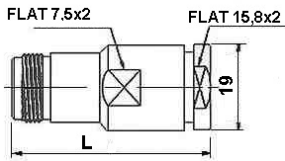

Straight Bulkhead Clamp Jack/Fem.

Part No.	Applicable Cable RG /U
N-2217-TGN	58, 58A, 141A
N-2218-TGN	174U, 188U, 316U

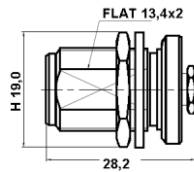

Straight Clamp Jack/Female

Part No.	Applicable Cable RG/U
N-2214-TGN	174U, 316U, 178, 188, 179U
N-2215-TGN	58A, 223U, 55U, 141, 142U, 303U

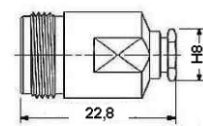

Straight Clamp Jack/Female

Part No.	Applicable Cable RG/U
N-2241-TGN	1/2"
N-2242-TGN	7/8"

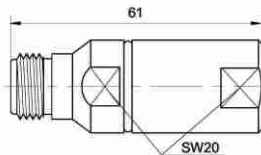

Square Flange Plug/Male

Part No.	Applicable Cable RG/U
N-3103-TGN	solder pot contact
N-3105-TGN	tab contact
N-3106-TGN	slotter contact

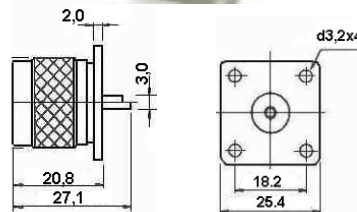

Square Flange Plug/Male

Part No.	Applicable Cable RG/U
N-3104-TGN	exposed teflon

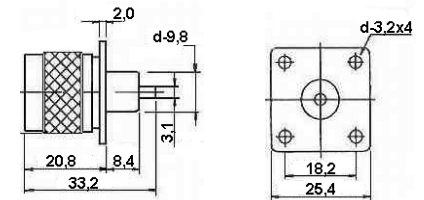

Square Flange Jack/Female

Part No.	Dimensions
N-3201-TGN	A: 6.5 ; B: 28

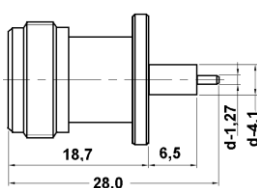

Square Flange Jack/Female

Part No.	Dimensions	Note
N-32011-TGN	L = 23.5 mm, L1 = 8.8 mm, L2 = 2 mm, d = 1.3 mm	seal rings
N-32012-TGN	L = 41.5 mm, L1 = 18.8 mm, L2 = 4 mm, d = 1.3 mm	seal rings
N-32013-TGN	L = 36.5 mm, L1 = 15 mm, L2 = 3 mm, d = 1.2 mm	
N-32014-TGN	L = 29.3 mm, L1 = 9.5 mm, L2 = 1.3 mm, d = 1.3 mm	
N-32015-TGN	L = 45.7 mm, L1 = 25 mm, L2 = 2 mm, d = 1.3 mm	seal rings
N-32016-TGN	L = 78.7 mm, L1 = 58 mm, L2 = 2 mm, d = 1.5 mm	seal rings

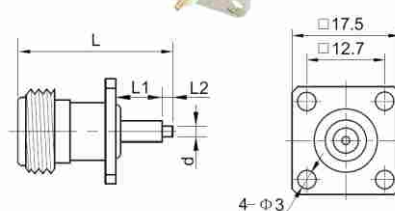

Square Flange Jack/Female

Part No.
N-3202-TGN

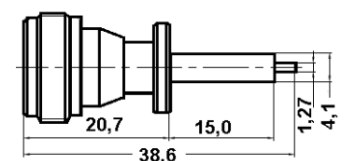

Bulkhead Square Flange Jack/Fem.

Part No.
N-3207-TGN

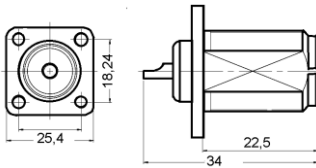

Square Flange Jack/Fem.

Part No.
N-3210-TGN

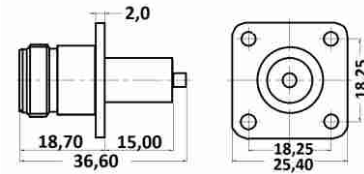

R/A Square Flange Jack/Fem.

Part No.	Applicable Cable RG/U
N-3211-TGN	with solder cup contact

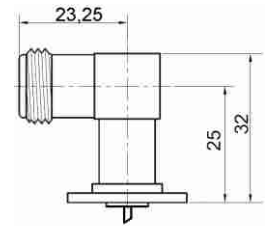

Square Flange Jack/Female

Part No.
N-3213-TGN

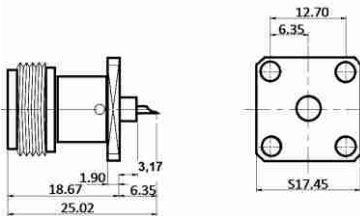

Square Flange Jack/Female

Part No.
N-3214-TGN

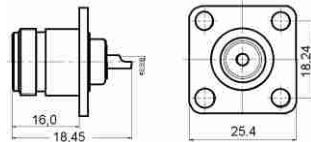

Square Flange Jack/Female

Part No.
N-3215-TGN

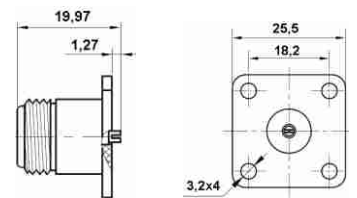

Straight Bulkhead Plug/Male

Part No.
N-4111-TGN

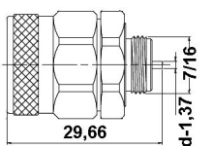

Straight Bulkhead Jack/Female

Part No.	Applicable Cable RG/U
N-4201-TGN	UG No. 680A/U

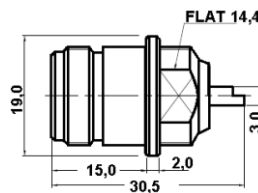

Straight Press-in Jack/Female

Part No.
N-4202-TGN

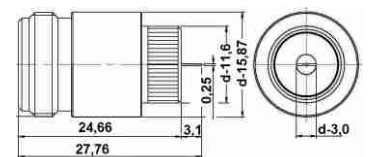

Straight Bulkhead Plug/Male

Adapter Plug/Male-Plug/Male

Adapter Jack/Fem.-Jack/Fem.

Part No.
N-4207-TGN

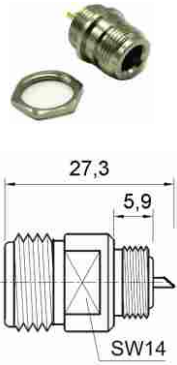

Part No.
N-601-TGN

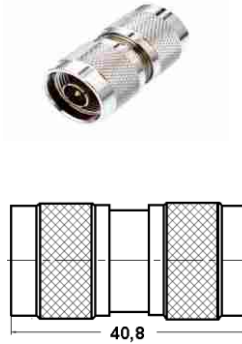

Part No.
N-602-TGN

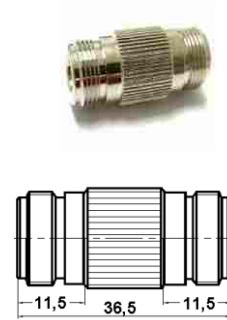

R/A Adapter Plug/Male-Jack/Fem.

T-Adapter N Plug/Male to N Jack/Fem.

Straight Plug/Male

Part No.
N-606-TGN



Part No.
N-608-TGN

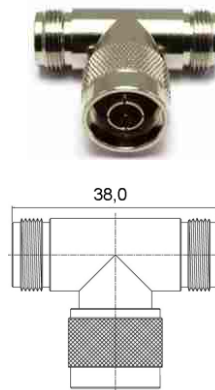

Part No.	Applicable Cable RG/U
N-7101-TGN	RG 402/U (0.141")
N-7102-TGN	RG 405/U (0.085")



Straight Jack/Female

Straight Bulkhead Jack/Female

Square Flange Jack/Female

Part No.	Applicable Cable RG/U
N-7203-TGN	RG 402/U (0.141")
N-7204-TGN	RG 405/U (0.085")
N-7205-TGN	RG 401/U (0.250")

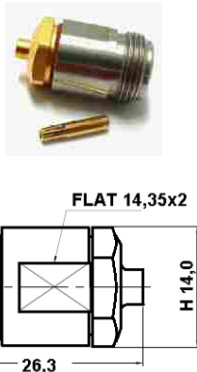

Part No.	Applicable Cable RG/U
N-7206-TGN	RG 402/U (0.141")
N-7207-TGN	RG 405/U (0.085")



Part No.	Applicable Cable RG/U
N-7209-TGN	RG 402/U (0.141")
N-7210-TGN	RG 405/U (0.085")

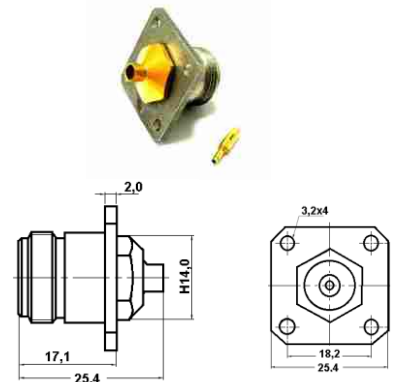

SPECIFICATION - BNC

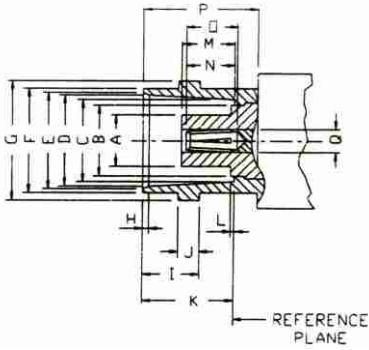

Letter	JACK	
	Millimeters(Inches)	
	Minimum	Maximum
A	-	4.72 (.186)
B	-	6.50 (.256)
C	8.10 (.319)	8.15 (.321)
D	8.31 (.327)	8.46 (.333)
E	8.80 (.346)	9.04 (.356)
F	9.60 (.378)	9.70 (.382)
G	10.97 (.432)	11.07 (.436)
H	0.38 (.015)	0.76 (.030)
I	5.18 (.204)	5.28 (.208)
J	1.91 (.075)	2.06 (.081)
K	8.31 (.327)	8.51 (.335)
L	-	0.15 (.006)
M	4.80 (.189)	5.28 (.208)
N	4.72 (.186)	5.23 (.206)
O	4.95 (.195)	-
P	10.52 (.414)	-
Q	2.06 (.081)	2.21 (.087)

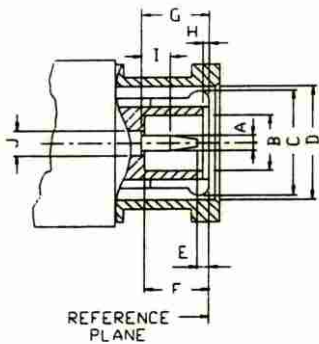

Letter	PLUG	
	Millimeters(Inches)	
	Minimum	Maximum
A	1.32 (.052)	1.37 (.054)
B	4.83 (.190)	-
C	SLOTTED AND FLARED TO MEET ELECTRICAL AND MECHANICAL REQUIREMENTS	
D	9.78 (.385)	9.91 (.390)
E	0.08 (.003)	-
F	5.28 (.208)	5.79 (.228)
G	5.33 (.210)	5.84 (.230)
H	0.15 (.006)	0.46 (.018)
I	2.00 (.078)	-
J	2.06 (.081)	2.21 (.087)

Electrical:		
Impedance	50 Ohm	75 Ohm
Frequency Range	0 to 6.0 Ghz	0 to 1 GHz
VSWR	1.3 max	
Voltage Rating	500 V rms max	
	* RG - 58, 141, 142, 223 - 500 V rms max * RG - 174, 188, 316 - 335 V rms max	
Dielectric Withstanding Voltage	1.500 V rms max	
	* RG - 58, 141, 142, 223 - 1.000 V rms max * RG - 174, 188, 316 - 750 V rms max	
Contact Resistance	center contact = 1.5 Milliohms max	
	outer contact = 0.5 Milliohms max	
RF Leakage	(-)55 dB min @ 3 GHz	
Insertion Loss	0.2 dB max @ 3 GHz	
Insulation Resistance	5.000 Megohms min	

Mechanical & Environmental:	
Mating	Two stud bayonet coupling
Durability	5800 matings
Coupling Nut Retention	100 lbs. Min
Cable Retention	* RG - 58, 141, 142, 223 - 40 lbs min
	* RG - 59, 62A, 210 - 40 lbs min
	* RG - 174, 188, 316 - 20 lbs min
	* RG - 179B, 187A - 20 lbs min
Temperature Range	(-)65 °C to 85 °C
Vibration	MIL-STD-202 Method 204 Test Cond. B.
Salt Spray	MIL-STD-202 Method 101 Test Cond. B.

Material:		
	Material	Plating
Connector Body	Brass	Nickel or Gold
Center Contact	Male: Brass	Gold
	Female: Beryllium Copper	
	Phosphor Bronze or Beryllium Copper	
Insulation	Teflon or Delrin	None
Basket	Silicone Rubber, Rubber	None
Crimp Ferrule	Annealed Copper	Same as Body

Cover Plug/Male + Chain

Part No.
BNC-1001

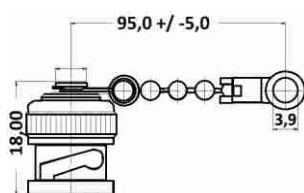

Cover Plug/Male + Chain

Part No.
BNC-1002

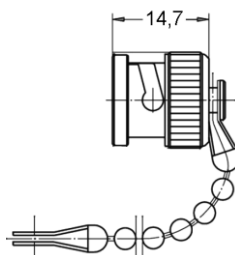

Straight Crimp Plug/Male

Part No.	Applicable Cable RG/U
BNC-1101-DGN	58, 58A, 141A
BNC-1102-DGN	59, 62A, 210
BNC-1103-TGN	174, 188A, 36 izol. Teflon
BNC-1104-DGN	174, 188A, 36
BNC-1115-TGN	LMR240
BNC-1118-TGN	Belden 8281

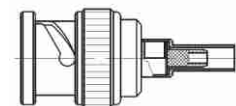

R/A Crimp Plug/Male

Part No.	Applicable Cable RG/U
BNC-1112-TGN	58, 58A, 141A
BNC-1113-DGN	59, 62A, 210
BNC-1114-DGN	174, 188A, 316
BNC-1117-TGN	LMR240
BNC-1125-TGN	LMR400

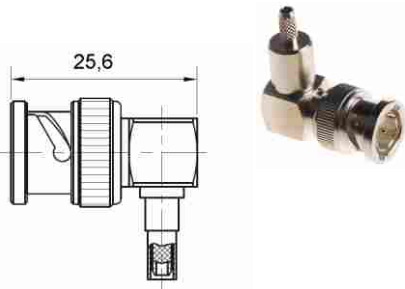

Straight Crimp Plug/Male

Part No.	Applicable Cable RG/U
BNC-1121-TGN	RG142U

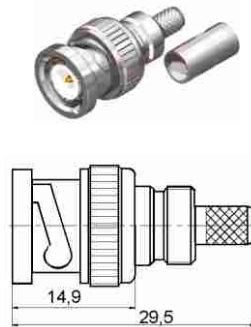

Straight Bulkhead Crimp Jack/Fem.

Part No.	Applicable Cable RG/U
BNC-1205-TGN	174, 188A, 316



Straight Bulkhead Crimp Jack/Fem.

Part No.	Applicable Cable RG/U
BNC-1206-DGN	58, 58A, 141A
BNC-1207-DGN	59, 62A, 210
BNC-1208-TGN	174, 188A, 316

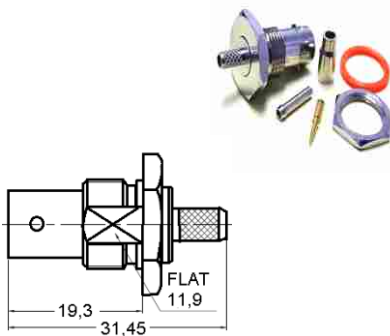

Straight Crimp Jack/Female

Part No.	Applicable Cable RG/U
BNC-1209-DGN	58, 58A, 141A
BNC-1210-DGN	59, 62A, 210
BNC-1211-TGN	174, 188A, 316
BNC-1216-TGN	RG 213U
BNC-1220-DGN	LMR400

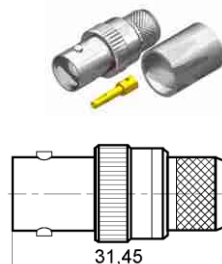

Square Flange Crimp Jack/Female

Part No.	Applicable Cable RG/U
BNC-1222-TGN	142U, 223U
BNC-1223-TGN	316U

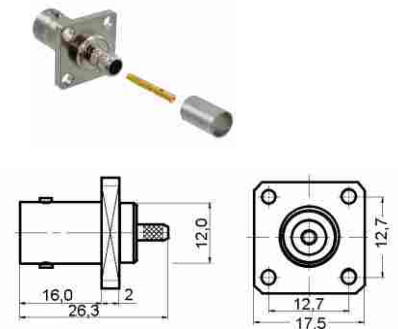

Straight Clamp Plug/Male

Part No.	Applicable Cable RG/U
BNC-2101-DGN	58, 58A, 141A
BNC-2102-DGN	59, 62A, 210
BNC-2104-DGN	174U, 188, 136
BNC-2106-DGN	214U

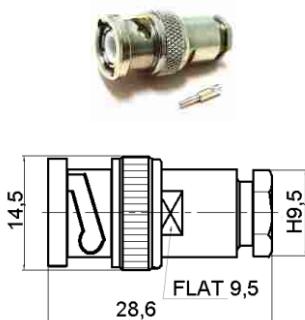

Straight Clamp Jack/Female

Part No.	Applicable Cable RG/U
BNC-2205-DGN	58, 58A, 141A

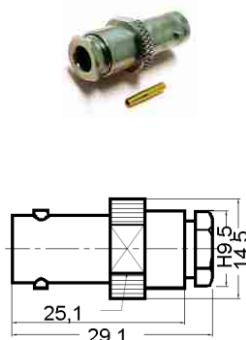

Square Flange Plug/Male

Part No.
BNC-3102-TGN

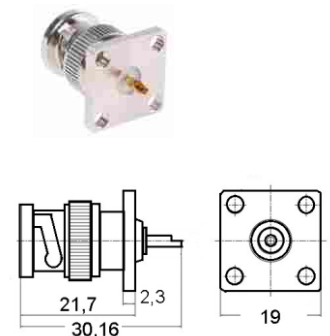

Square Flange Jack/Female

Part No.
BNC-3201-TGN

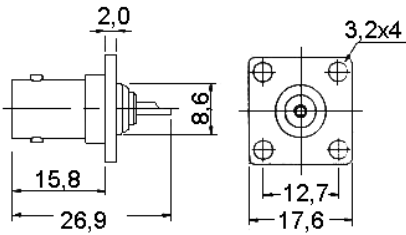

R/A Square Flange Jack/Female

Part No.
BNC-3211-TGN

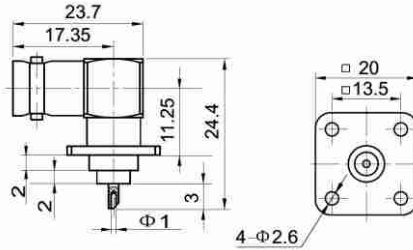

Straight Bulkhead Plug/Male

Part No.
BNC-4102-TGN

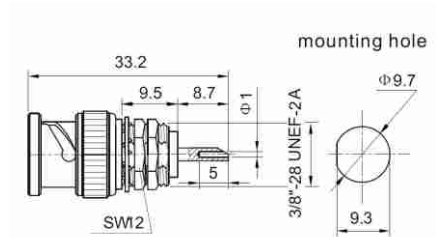

Straight Bulkhead Jack/Female

Part No.
BNC-4201-DGN

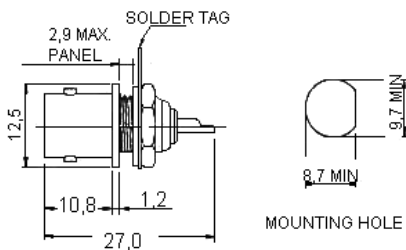

Straight Bulkhead Jack/Female

Part No.
BNC-4203-TGN

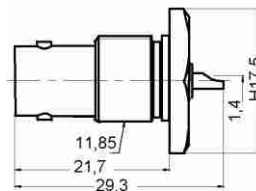

R/A PCB Jack/Female

Part No.
BNC-5101-TGN

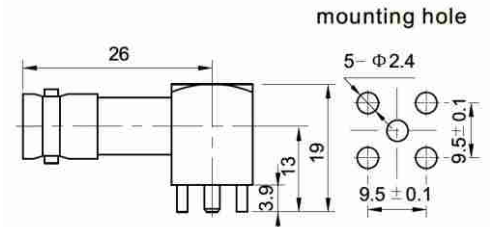

Straight PCB Jack/Female

Part No.
BNC-5201-TGN

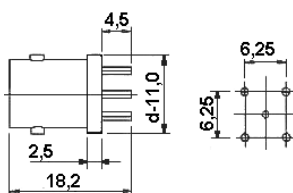

Straight PCB Jack/Female

Part No.
BNC-5202-DGN

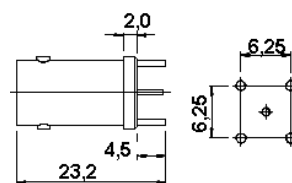

Straight PCB Jack/Female

Part No.
BNC-5203-TGN

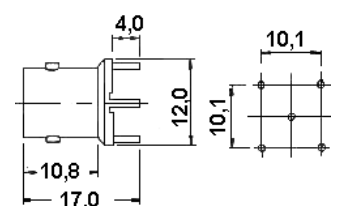

Straight PCB Jack/Female

Part No.
BNC-5204-TGN

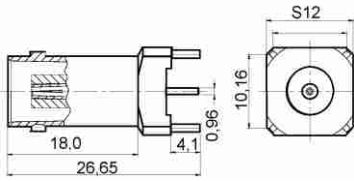

Straight PCB Jack/Female

Part No.
BNC-5206-TGN

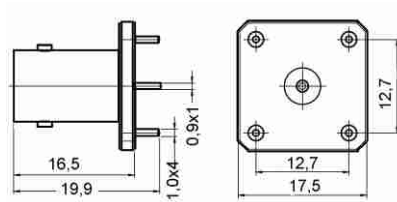

Straight PCB Threaded Jack/Female

Part No.
BNC-5207-TGN

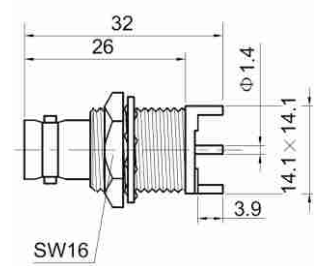

Bulkhead Jack/Fem. - Jack/Fem.

Part No.
BNC-601-DGN

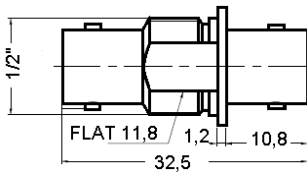

Plug/Male - Plug/Male

Part No.
BNC-603-DGN

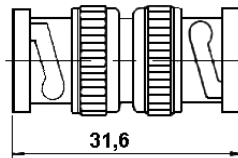

R/A Plug/Male - Jack/Female

Part No.
BNC-605-DGN

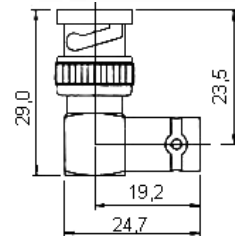

Plug/Male to T Type Jack/Female

Part No.
BNC-606-TGN

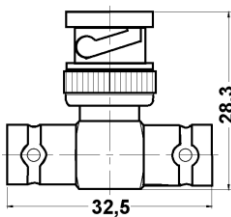

Straight Crimp Plug/Male

Part No.	Applicable Cable RG/U
BNC-7101-TGN	RG402U

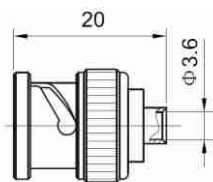

R/A Crimp Plug/Male

Part No.	Applicable Cable RG/U
BNC-7102-TGN	RG405

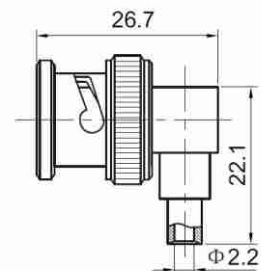
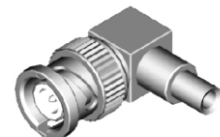

SPECIFICATION - TNC

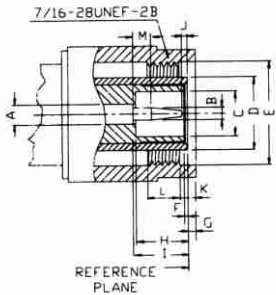

PLUG		
Letter	Millimeters(Inches)	
	Minimum	Maximum
A	2.06 (.081)	2.21 (.087)
B	1.30 (.052)	1.37 (.054)
C	4.83 (.190)	-
D	-	8.08 (.318)
E	11.18 (.440)	-
F	0.15 (.006)	-
G	-	1.98 (.078)
H	5.28 (.208)	5.79 (.228)
I	5.33 (.210)	5.84 (.230)
J	0.08 (.003)	1.02 (.040)
K	1.60 (0.63)	-
L	3.96 (.156)	-
M	1.98 (.078)	-

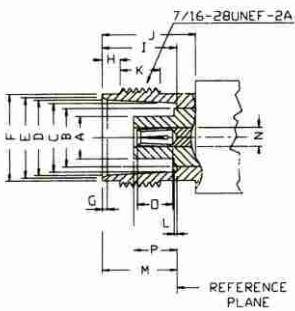

JACK		
Letter	Millimeters(Inches)	
	Minimum	Maximum
A	-	4.72 (.186)
B	-	6.50 (.256)
C	8.10 (.319)	8.15 (.321)
D	8.31 (.327)	8.46 (.333)
E	8.79 (.346)	9.04 (.356)
F	9.60 (.378)	9.68 (.381)
G	0.38 (.015)	0.77 (.030)
H	1.73 (.068)	2.24 (.088)
I	8.31 (.327)	8.51 (.335)
J	10.52 (.414)	-
K	4.75 (.187)	-
L	-	0.15 (.006)
M	4.78 (.188)	5.28 (.208)
N	2.06 (.081)	2.21 (.087)
O	4.95 (.195)	-
P	4.72 (.186)	5.23 (.206)

Electrical:	
Impedance	50 Ohm 75 Ohm
Frequency Range	0 to 11.0 Ghz 0 to 1.0 Ghz
VSWR	1.3 max
Voltage Rating	500 V rms max
	* RG - 58, 141, 142, 223 - 500 V rms max * RG - 174, 188, 316 - 335 V rms max
Dielectric Withstanding Voltage	1.500 V rms max
	* RG - 58, 141, 142, 223 - 1.000 V rms max * RG - 174, 188, 316 - 750 V rms max
Contact Resistance	center contact = 1.5 Milliohms max
	outer contact = 0.2 Milliohms max
RF Leakage	(-)55 dB min @3 Ghz
Insertion Loss	0.2 dB max @ 3 Ghz
Insulation Resistance	5.000 Megohms min

Mechanical & Environmental:	
Mating	7/16" - 28 threaded coupling
Durability	500 matings
	RG - 58, 141, 142, 223 - 40 lbs min
Cable Retention	RG - 59, 62A, 210 - 40 lbs min
	RG - 174, 188, 316 - 20 lbs min
Coupling Nut Retention	100 lbs min
Temperature Range	(-)65 °C to 165 °C
Vibration	MIL-STD-202 Method 204 Test Cond. B.
Salt Spray	MIL-STD-202 Method 101 Test Cond. B.

Material:		
	Material	Plating
Connector Body	Brass	Nickel or Gold
Center Contact	Male: Brass	Gold
	Female: Brass or Phosphor Bronze, Beryllium Copper	
Insulation	Teflon or Delrin	None
Gasket	Silicone Rubber, Rubber	None
Crimp Ferrule	Annealed Copper	Same as Body

Straight Crimp Plug/Male

Part No.	Applicable Cable RG/U
TNC-1101-DGN	58, 58A, 141A
TNC-1102-DGN	59, 62A, 210
TNC-1114-TGN	LMR240
TNC-1116-TGN	LMR300
TNC-1135-TGN	178U



Straight Crimp Plug/Male

Part No.	Applicable Cable RG/U
TNC-1103-TGN	174, 188A, 316
TNC-1104-TGN	179B, 187A (75 Ohms)

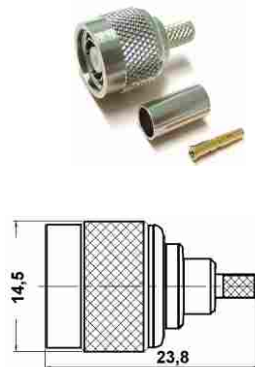

Straight Plug/Male

Part No.	Applicable Cable RG/U
TNC-1113-TGN	213
TNC-1120-TGN	LMR400

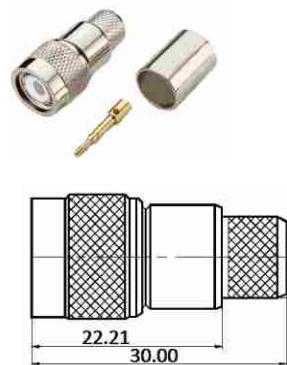

R/A Crimp Plug/Male

Part No.	Applicable Cable RG/U
TNC-1118-TGN	RG58U, RG141U
TNC-1122-TGN	LMR241
TNC-1133-TGN	LMR400

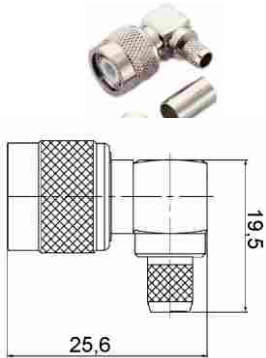

Straight Crimp Plug/Male

Part No.	Applicable Cable RG/U
TNC-1119-TGN	LMR500

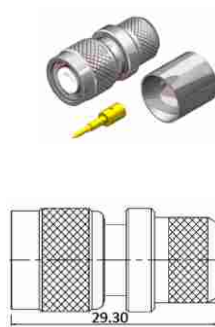

Straight Bulkhead Crimp Jack/Fem.

Part No.	Applicable Cable RG/U
TNC-1205-DGN	58, 58A, 141A
TNC-1206-DGN	59, 62A, 210
TNC-1207-TGN	174, 188A, 316
TNC-1208-TGN	179B, 187A (75 Ohm)



Straight Crimp Jack/Female

Part No.	Applicable Cable RG/U
TNC-1211-TGN	174, 188A, 316
TNC-1212-TGN	179B, 187A (75 Ohm)

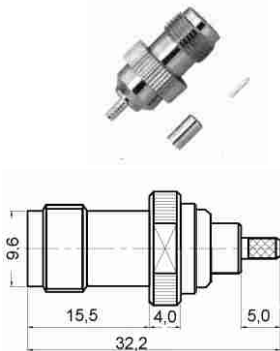

Straight Bulkhead Crimp Jack/Fem.

Part No.	Applicable Cable RG/U
TNC-1221-TGN	LMR400
TNC-1225-TGN	LMR240

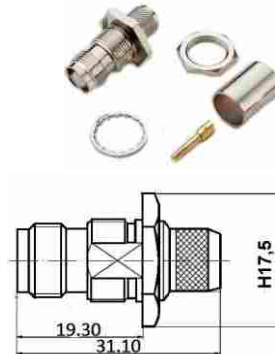

Straight Crimp Jack/Female

Part No.	Applicable Cable RG/U
TNC-1224-TGN	LMR240
TNC-1226-TGN	LMR400

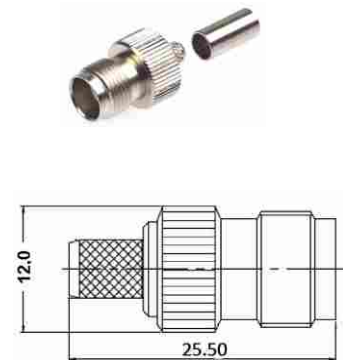

Straight Clamp Plug/Male

Part No.	Applicable Cable RG/U
TNC-2101-DGN	58, 58A, 141A
TNC-2102-DGN	59, 62A, 210



Straight Clamp Plug/Male

Part No.	Applicable Cable RG/U
TNC-2103-TGN	58U, 55U, 223U
TNC-2104-TGN	174, 188, 316U
TNC-2106-TGN	RG213U
TNC-2107-TGN	LMR240

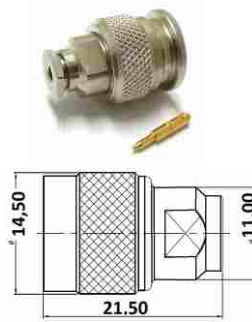

Straight Clamp Jack/Female

Part No.	Applicable Cable RG/U
TNC-2205-DGN	58, 58A, 141A
TNC-2206-DGN	59, 62A, 210

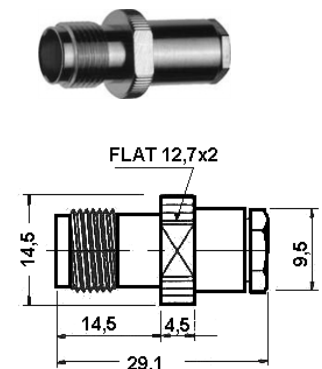

Square Flange Plug/Male

Part No.
TNC-3103-DGN

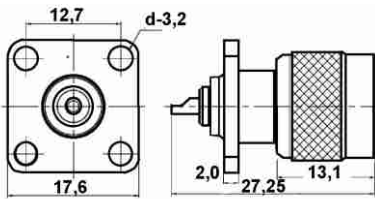

Square Flange Jack/Fem.

Part No.
TNC-3201-DGN

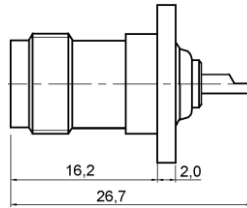

Square Flange Jack/Fem.

Part No.
TNC-3203-TGN

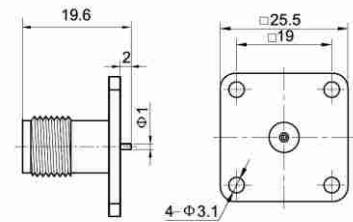

Straight Bulkhead Plug/Male

Part No.
TNC-4106-TGN

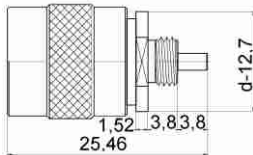

Straight Bulkhead Jack/Fem.

Part No.
TNC-4201-DGN

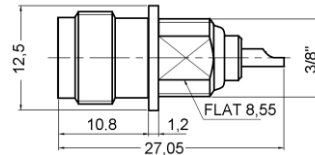

Straight Bulkhead Jack/Fem.

Part No.
TNC-4205-TGN

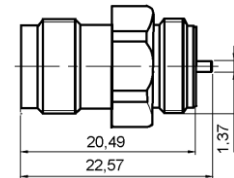

R/A PCB Jack/Female

Part No.
TNC-5201-TGN

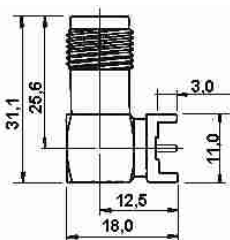

R/A PCB Threaded Jack/Female

Part No.
TNC-5202-TGN

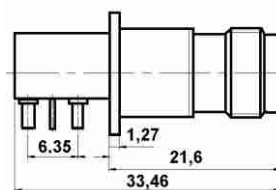

R/A PCB Threaded Jack/Female

Part No.
TNC-5205-TGN

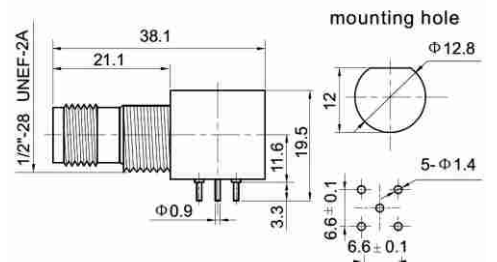
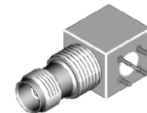

Jack/Female - Jack/Female

Part No.
TNC-601-DGN

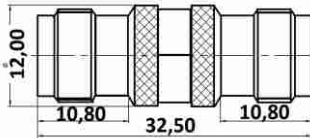

Bulkhead Jack/Fem. - Jack/Fem.

Part No.
TNC-602-DGN

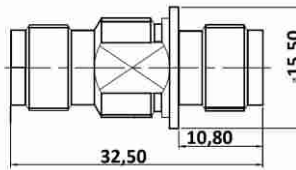

Straight Crimp Plug/Male

Part No.	Applicable Cable RG/U
TNC-7101-TGG	RG 402/u (0.141")
TNC-7102-TGG	RG 405/u (0.085")

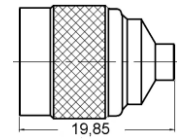

Straight Crimp Jack/Female

Part No.	Applicable Cable RG/U
TNC-7203-TGG	RG 402/u (0.141")
TNC-7204-TGG	RG 405/u (0.085")

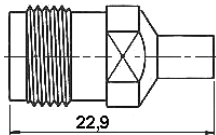

Bulkhead Jack/Female

Part No.	Applicable Cable RG/U
TNC-7206-TGG	RG402/u (0.141")
TNC-7207-TGG	RG405/u (0.085")

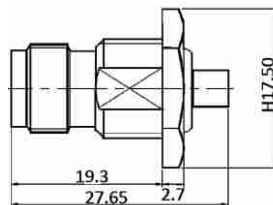

BMA R/A Bulkhead Plug/Male

Part No.
BMA-1104-TGG

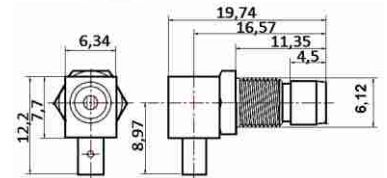

Bulkhead Solder Plug/Male

Part No.
BMA-4101-TGG

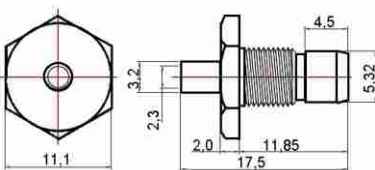

2 Hole Flange Jack/Female

Part No.
BMA-4201-TGG

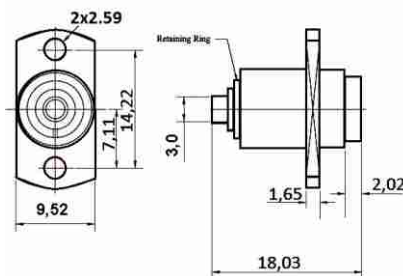

Square Flange Plug/Male

Part No.
BMA-4203-TGG

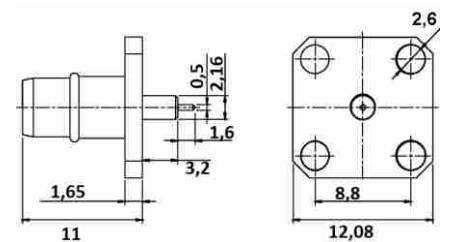

Straight Crimp Plug/Male

Part No.	Applicable Cable RG/U
MHV-1101-TGN	59, 62A, 210
MHV-1102-TGN	RG58U

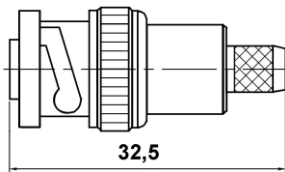

Straight Clamp Plug/Male

Part No.	Applicable Cable RG/U
MHV-2102-TGN	59, 62A, 210

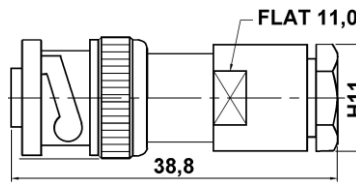

Straight Clamp Plug/Male

Part No.	Applicable Cable RG/U
MHV-2103-TGN	8A, 213

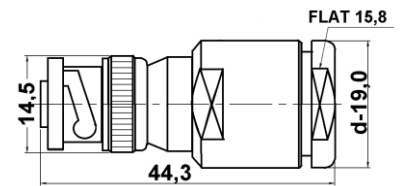

R/A Plug/Male

Part No.	Applicable Cable RG/U
MHV-2105-TGN	RG58U

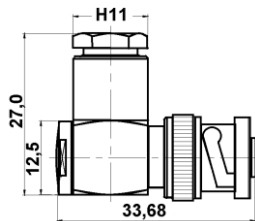

Straight Clamp Jack/Female

Part No.	Applicable Cable RG/U
MHV-2201-TGN	59, 62A, 210

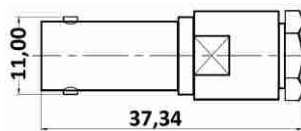

Square Flange Jack/Female

Part No.
MHV-3201-TGN

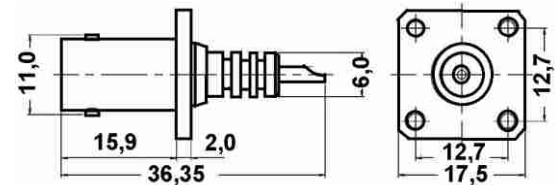

Straight Bulkhead Jack/Fem.

Part No.
MHV-4201-TGN

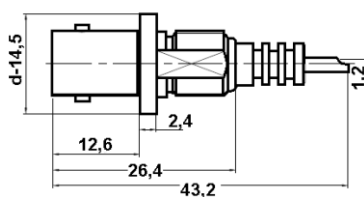

Straight Bulkhead Jack/Female

Part No.
MHV-4203-TGN

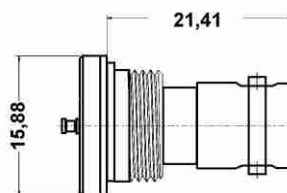

Jack/Female - Jack/Female

Part No.
MHV-601-TGN

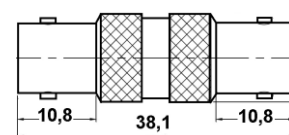

Straight Clamp Plug/Male

Part No.	Applicable Cable RG/U
716-1101-TSS	213/U
716-1102-TSS	214/U
716-1103-TSS	Belden 9913, LMR400
716-1105-TSS	LMR-500
716-1106-TSS	LMR-600

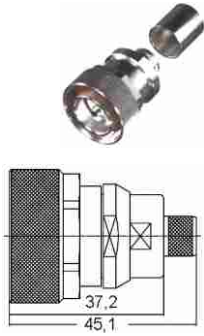

Straight Crimp Jack/Female

Part No.	Applicable Cable RG/U
716-1201-TSS	213/U
716-1202-TSS	214/U
716-1203-TSS	Belden 9913, LMR400
716-1206-TSS	LMR-600

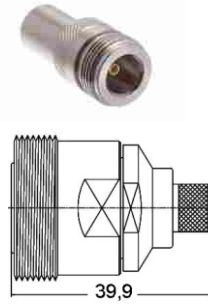

Straight Crimp Plug/Male

Part No.	Applicable Cable RG/U
716-2101-TSS	213/U
716-2102-TSS	214/U
716-2103-TSS	Belden 9913, LMR400
716-2106-TSS	LMR-600

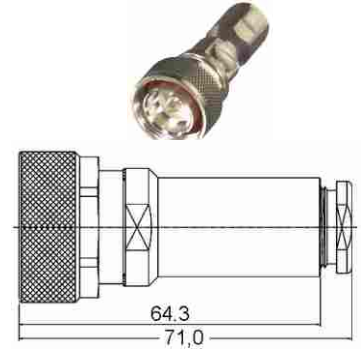

R/A Clamp Plug/Male

Part No.	Applicable Cable RG/U
716-2121-TSS	213/U
716-2122-TSS	214/U
716-2123-TSS	Belden 9913, LMR400

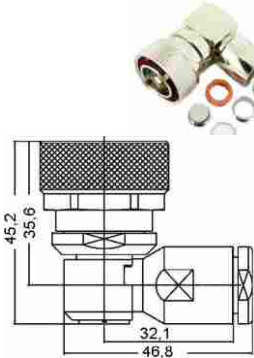

Square Flange Plug/Male

Part No.
716-3101-TSS

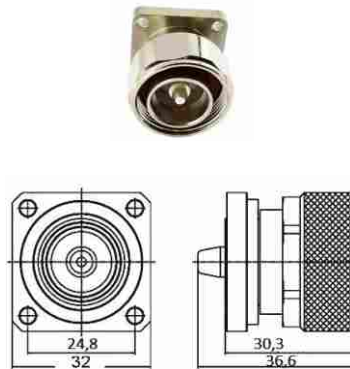

Square Flange Jack/Female

Part No.
716-3202-TSS

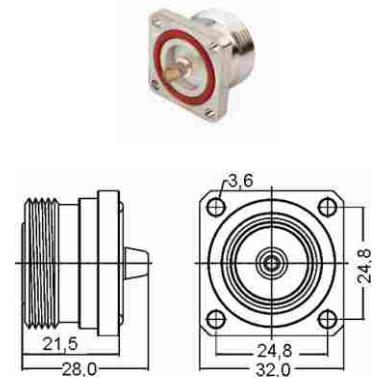

Bulkhead Jack/Female

Part No.
716-4201-TSS

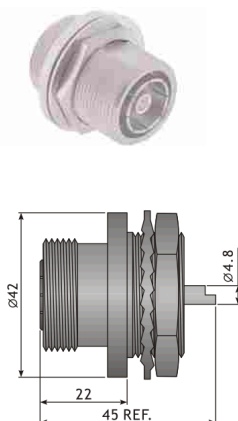

Adaptor Jack/Fem. to Jack/Fem.

Part No.
716-603-TSS



Adaptor Plug/Male to Plug/Male

Part No.
716-604-TSS

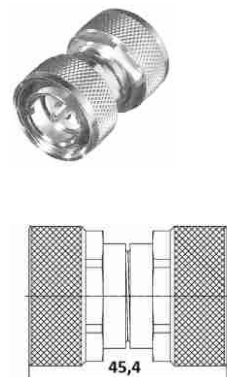

REVERSE POLARITY CONNECTORS

R/A Crimp Plug

Part No.	Applicable Cable RG/U
RP-SMA-1101-TGG	58, 58A, 141A
RP-SMA-1102-TGG	174, 188A, 316
RP-SMA-1103-TGG	142B/U

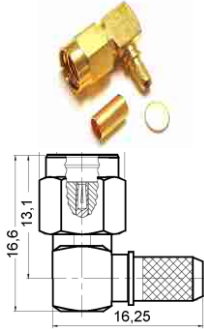

Straight Crimp Plug

Part No.	Applicable Cable RG/U
RP-SMA-1104-TGG	58, 58A, 141A
RP-SMA-1105-TGG	174, 188A, 316
RP-SMA-1106-TGG	142B/U
RP-SMA-1113-TGG	LMR400
RP-SMA-1117-TGG	LMR240
RP-SMA-1118-TGG	Belden 9913
RP-SMA-1120-TGG	LMR240
RP-SMA-1122-TGG	LMR400

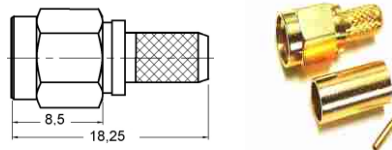

Straight Bulkhead Crimp

Part No.	Applicable Cable RG/U
RP-SMA-1207-TGG	58, 58A, 141A
RP-SMA-1208-TGG	174, 188A, 316
RP-SMA-1209-TGG	142B/U
RP-SMA-1221-TGG	LMR240
RP-SMA-1222-TGG	LMR400

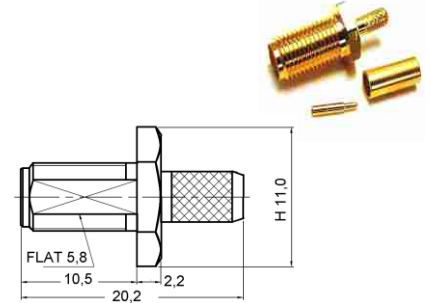

Straight Bulkhead Jack

Part No.
RP-SMA-4201-TGG

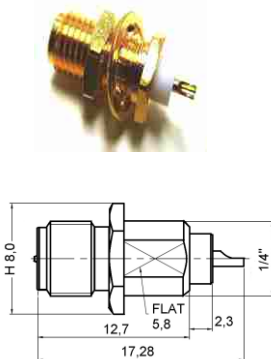

R/A PCB Jack

Part No.
RP-SMA-5201-TGG

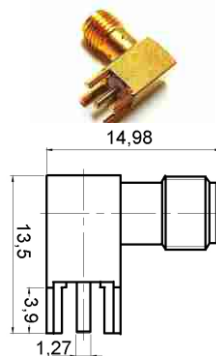

Straight Plug

Part No.	Applicable Cable RG/U
RP-SMA-7101-TGG	RG 402/u (0.141")
RP-SMA-7102-TGG	RG 405/u (0.085")

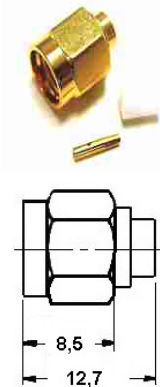

Straight Bulkhead Jack

Part No.	Applicable Cable RG/U
RP-SMA-7103-TGG	RG 402/u (0.141")
RP-SMA-7104-TGG	RG 405/u (0.085")

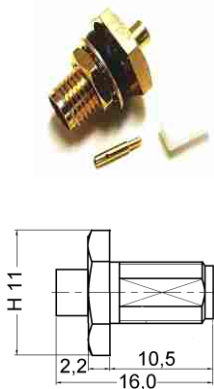

Straight Crimp Plug

Part No.	Applicable Cable RG/U
RP-TNC-1101-TGN	58, 58A, 141A
RP-TNC-1102-TGN	142B/U
RP-TNC-1116-TGN	LMR200

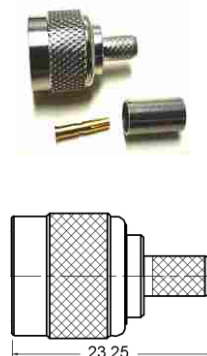

Straight Bulkhead Jack

Part No.	Applicable Cable RG/U
RP-TNC-1203-TGN	58, 58A, 141A
RP-TNC-1204-TGN	142B/U

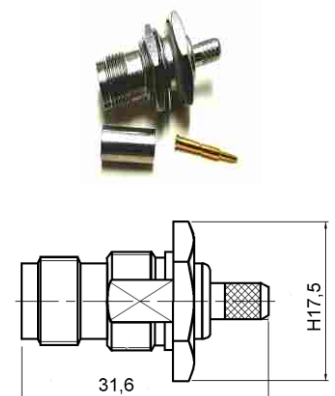

SMA Plug - N Plug

Part No.
SMAp-Np-601-TGN



SMA Plug - N Jack

Part No.
SMAp-Nj-602-TGN



SMA Jack - N Plug

Part No.
SMAj-Np-603-TGN



SMA Jack - N Jack

Part No.
SMAj-Nj-604-TGN



SMA Jack - N Panel Jack

Part No.
SMAj-Njp-605-TGN



SMA Jack - N Jack

Part No.
SMAj-Nj-605b-TGN



SMA Jack - N Bulkhead Jack

Part No.
SMAj-Njb-606-TGN



SMA Plug - BNC Jack

Part No.
SMAp-BNCj-607-TGN



SMA Jack - BNC Jack

Part No.
SMAj-BNCj-608-TGN



SMA Plug - TNC Plug

Part No.
SMAp-TNCp-609-TGN



SMA Plug - TNC Jack

Part No.
SMAp-TNCj-610-TGN



SMA Jack - TNC Plug

Part No.
SMAj-TNCp-611-TGN



SMA Jack - TNC Jack

Part No.
SMAj-TNCj-612-TGN



N Plug - BNC Jack

Part No.
Np-BNCj-613-DGN



N Jack - BNC Plug

Part No.
Nj-BNCp-614-DGN



N Plug - F Jack

Part No.
Np-Fj-615-TGN



N Jack - F Plug

Part No.
Nj-Fp-616-TGN



BNC Plug - UHF Jack

Part No.
BNCp-UHFj-617-DNN



BNC Jack - UHF Plug

Part No.
BNCj-UHFp-618-DNN



Mini UHF Jack - SMA Plug

Part No.
Mini UHFj-SMAp-623-TGN



Mini UHF Jack - SMA Plug

Part No.
Mini UHFj-SMAp-624-TGN



N Jack - SMA RP Plug

Part No.
Nj-SMApREV-625-TGN



TNC RP Plug - N Plug

Part No.
TNCpREV-Np-626-TGN



TNC RP Plug - N Jack

Part No.
TNCpREV-Nj-627-TGN



SMB Plug - BNC Jack

Part No.
SM Bp-BNCj-629-TGN



SMB Plug - N Jack

Part No.
SM Bp-Nj-630-TGN



SMA Jack - SMB Plug

Part No.
SMAj-SMBp-631-TGN



UHF Plug - N Plug

Part No.
UHFp-Np-632-TGN



SMA Plug RP - TNC Jack

Part No.
SMApREV-TNCj-633-TGN



BNC Plug - SMB Jack

Part No.
BNCp-SMBj-635-TGN



SSMA Jack - SMA Plug

Part No.
SSMAj-SMAp-636-TGN



TNC Plug RP - TNC Jack

Part No.
TNCpREV-TNCj-637-TGN



SMA Jack - SMA RP Plug

Part No.
SMAj-SMApREV-638-TGN



SMA RP Jack - SMA Plug

Part No.
SMAjREV-SMAp-639-TGN



TNC Plug - BNC Jack

Part No.
TNCp-BNCj-640-TGN



TNC Jack - BNC Jack

Part No.
TNCj-BNCj-641-TGN



SMA RP Plug - TNC RP Jack

Part No.
SMApREV-TNCjREV-642-TGN



SMA Jack - SMC Jack

Part No.
SM Aj-SM Cj-643-TGN



SMA Jack - UHF Jack

Part No.
SM Aj-U HFj-644-TGN



BNC Jack - F Plug

Part No.
BNCj-Fp-645-TGN



TNC RP Jack - TNC Plug

Part No.
TNCjREV-TNCp-648-TGN



SMA Jack - F Plug

Part No.
SMAj-Fp-649-TGN



N Jack - F Jack

Part No.
Nj-Fj-651-TGN



N Plug - TNC Jack

Part No.
Np-TNCj-652-TGN



UHF Plug - BNC Jack

Part No.
UHFp-BNCj-653-TGN



N Jack - TNC Jack

Part No.
Nj-TNCj-654-TGN



SMA Plug - SMB Jack

Part No.
SMAp-SMBj-655-TGG



SMA RP Jack - MCX Plug

Part No.
SMAjREV-MCXp-656-TGG



SMA RP Jack - N Plug

Part No.
SMAjREV-Np-657-TGN



SMA RP Jack - N RP Plug

Part No.
SMAjREV-NpREV-658-TGN



N Plug - TNC RP Jack

Part No.
Np-TNCjREV-660-TGN



BNC Jack - F Jack

Part No.
BNCj-Fj-661-TGN



SMA Plug - SMB Plug

Part No.
SMAp-SMBp-662-TGG



N Jack - TNC RP Jack

Part No.
Nj-TNCjREV-663-TGN



TNC Jack - QMA Jack

Part No.
TNCj-QMAj-665-TGN



QMA Jack N/TNC Plug

Part No.
QMAj-Np-666-TGN
QMAj-TNCp-667-TGN



QMA Jack - SMA Plug

Part No.
QMAj-SMAp-668-TGN



UHF Plug - N Jack

Part No.
UHFp-Nj-669-TGN



**TNC Bulkhead Jack -
MMCX Hermetic**

Part No.
TNCjBUL-MMCX-674-TGN-Hermetic



**TNC RP Plug -
TNC R/A Jack**

Part No.
TNCpREV-TNCj-675-RA-TGN



SMA Plug - MMCX Plug

Part No.
SMAp-MMCXp-677-TGG



SMA Jack - MMCX Jack

Part No.
SMAj-MMCXj-678-TGG



SMB Plug - MMCX Plug

Part No.
SMBp-MMCXp-679-TGN



SMB Jack - MMCX Jack

Part No.
SMBj-MMCXj-680-TGG



FME Plug - MCX Plug

Part No.
FMEp-MCXp-681-TGN
FMEp-MMCXp-682-TGN
FMEp-SMBj-683-TGN



QMA Plug - SMA Jack

Part No.
QMAp-SMAj-688-TGN



TNC Jack - MCX Jack

Part No.
TNCj-MCXj-689-TGN



SMA Jack - IPEX

Part No.
SMAj-IPEX-693-TGG



QMA Jack - SMA Jack

Part No.
QMAj-SMAj-694-TGN



QMA Jack - N Jack

Part No.
QMAj-Nj-695-TGN



N Plug - QMA Plug

Part No.
Np-QMAp-696-TGN



QMA Plug - SMA Plug

Part No.
QMAp-SMAp-697-TGN



QMA Plug - N Jack

Part No.
QMAp-Nj-698-TGN



N Plug - TNC Plug

Part No.
Np-TNCp-702-TGN



BNC Plug - SMA Jack

Part No.
BNCp-SMAj-703-TGN



SMA RP Jack - N Jack

Part No.
SMAjREV-Nj-704-TGN



MMCX Jack - SMA Plug

Part No.
MMCXj-SMAp-705-TGG



QN Plug - N Jack

Part No.
QNp-Nj-706-TGN



QN Plug - N Plug

Part No.
QNp-Np-707-TGN



QN Plug - SMA Jack

Part No.
QNp-SMAj-708-TGN



QN Plug - TNC Jack

Part No.
QNP-TNCj-709-TGN



QN Jack - N Jack

Part No.
QNj-Nj-714-TGN



TNC Jack - SMC Plug

Part No.
TNCj-SMCp-716-TGN



SMB Plug - FME Plug

Part No.
SMBp-FMEp-717-TGN



BNC Plug - TNC Jack

Part No.
BNCp-TNCj-719-TGN



FME Jack - N Jack

Part No.
FMEj-Nj-720-TGN



SMA Jack - FME Jack

Part No.
SMAj-FMEj-721-TGN



TNC RP Plug - SMA Jack

Part No.
TNCpREV-SMAj-724-TGN



MCX Plug - SMA Plug

Part No.
MCXp-SMAp-725-TGG



SMA Jack - SMC Plug

Part No.
SMAj-SMCp-727-TGG



BNC Plug - FME Jack

Part No.
BNCp-FMEj-729-TGN



N Plug - FME Jack

Part No.
Np-FMEj-730-TGN



TNC Jack - MCX Jack

Part No.
TNCj-MCXj-731-TGN



SMA Jack - TNC RP Jack

Part No.
SMAj-TNCjREV-733-TGN



SMA Jack - SMB Plug

Part No.
SMAj-SMBp-741-TGN



N Jack - SMA Plug

Part No.
Nj-SMAp-743-TGN



N Jack - SMA Jack

Part No.
Nj-SMAj-745-TGN



TNC Jack - BNC Jack

Part No.
TNCj-BNCj-747-TGN



N Jack - BNC Jack

Part No.
Nj-BNCj-748-TGN



MMCX Plug - SMA Jack

Part No.
MMCXp-SMAj-749-TGN



SMA (Bare End)

Description: Cable 001 RF
SMA Jack (Panel Mount Type w/ 4-Hole Flange) + RG-402 (Semi-Rigid) Cable (Bare End)



SMA to SMA

Description: Cable 002 RF
SMA Plug + RG-047 (Semi-Rigid) Cable + SMA Jack



SMA to SMA

Description: Cable 003 RF
SMA Plug + RG-402 (Semi-Rigid) Cable + SMA Plug



SMA to SMA

Description: Cable 004 RF
SMA Plug + RG-47 (Semi-Rigid) Cable + SMA Plug



SMA to SMA

Description: Cable 005 RF
SMA Plug + RG-405 (Semi-Rigid) Cable + SMA Plug



MMCX to SMA

Description: Cable 010 RF
MMCX Plug + RG-405 (Semi-Rigid) Cable + SMA Plug



N to SMA

Description: Cable 011 RF
N Bulkhead Jack + RG-402 (Semi-Flexible) Cable + SMA R/A Plug



N to SMA

Description: Cable 012 RF
N Jack (Panel Mount Type w/ 4 Hole Flange) + RG-402 (Semi-Flexible) Cable + SMA Plug



SMA to SMA

Description: Cable 021 RF
SMA Plug + SS-402 Cable + SMA Plug



SMA to SMA

Description: Cable 022 RF
SMA R/A Plug + RG-402 Cable (Semi-Flexible) + SMA R/A Plug



SMA to SMA

Description: Cable 023 RF
SMA Plug + RG-402 (Semi-Flexible) Cable + SMA Plug



SMA to SMA

Description: Cable 024 RF
SMA Plug + RG-402 (Semi-Flexible) Cable + SMA R/A Plug



SMA to SMP

Description: Cable 025 RF
SMA R/A Plug + RG-405 (Semi-Flexible) Cable + SMP R/A Jack



N to N

Description: Cable 030 RF
N Plug + SS-75086 Cable + N Plug



1.0/2.3 to BNC

Description: Cable 031 RF
1.0/2.3 Crimp Plug + Belden 1855A Cable + Real 75 Ohm BNC Crimp Plug



BNC to Mini BNC

Description: Cable 032 RF
1.0/2.3 Crimp Plug + Belden 1855A Cable + Real 75 Ohm BNC Crimp Plug



BNC to MMCX

Description: Cable 033 RF
BNC Bulkhead Crimp Jack (Front Mount Type) + RG-178 Cable + MMCX R/A Crimp Plug



BNC to Oupiin

Description: Cable 034 RF
BNC Bulkhead Crimp Jack + RG-179 Cable + Oupiin Connector



FME (Ip68) to MMCX

Description: Cable 035 RF
FME Crimp Jack (Ip68) + RG-316 Cable + MMCX R/A Crimp Plug



MMCX to N

Description: Cable 036 RF
MMCX R/A Crimp Plug + RG-178 Cable + N Bulkhead Crimp Jack



Pigtail UFL/R - Cable UFL/R Pigtail UFL/R - SMA f panel Pigtail UFL/R - N Male Pigtail UFL/R - SMA RP Plug

Cable 101 RF



Cable 102 RF



Cable 103 RF



Cable 104 RF



JSC to MHF MHF to MHF MHF to Stripped or Tinned End MHF to Stripped or Tinned End

Description: Cable 151 RF

Murata JSC Right Angle Plug to IPEX MHF R/A Plug



Description: Cable 152 RF

IPEX MHF IV R/A Plug to IPEX MHF R/A Plug



Description: Cable 153 RF

IPEX MHF Right Angle Plug to Stripped or Tinned end



Description: Cable 154 RF

IPEX MHF Right Angle Plug to Stripped or Tinned end



MHF to SMA MHF to SMA MHF to SMA MHF to SMA

Description: Cable 155 RF

IPEX MHF R/A Plug to SMA Straight Jack Rear Mount



Description: Cable 156 RF

IPEX MHF R/A Plug to SMA R/A Jack Rear Mount



Description: Cable 157 RF

IPEX MHF R/A Plug to SMA R/A Plug With O-Ring



Description: Cable 158 RF

IPEX MHF R/A Plug to SMA Straight Jack PCB Mount



MHF to SMA MHF to SMA MHF to SMA MHF to SMA

Description: Cable 159 RF

IPEX MHF R/A Plug to SMA Straight Jack Rear Mount Optional O-Ring



Description: Cable 160 RF

IPEX MHF R/A Plug to SMA Straight Jack Reverse Polarity Rear Mount With O-Ring IP67/IP68



Description: Cable 161 RF

IPEX MHF R/A Plug to SMA Straight Jack Reverse Polarity Front Mount With O-Ring IP67/IP68



Description: Cable 162 RF

IPEX MHF R/A Plug to SMA Straight Jack Reverse Polarity Front Mount



MHF to SMA MHF to SMA MHF to N MHF to TNC

Description: Cable 163 RF

IPEX MHF R/A Plug to SMA Straight Plug Reverse Polarity



Description: Cable 164 RF

IPEX MHF R/A Plug to SMA Straight Jack Reverse Polarity Rear Mount



Description: Cable 165 RF

IPEX MHF R/A Plug to N Straight Jack Rear Mount With O-Ring



Description: Cable 166 RF

IPEX MHF R/A Plug to TNC Straight Jack Front Mount With O-Ring



TER-BMA-50JR, 0.5W, 0-18GHz

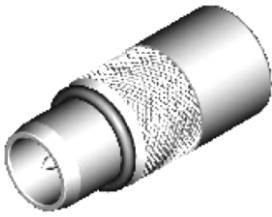

TER-BNC-50KR, 1W, 50 Ohm, 0-2GHz



TER-BNC-75JR, 1W, 75 Ohm, 0-1GHz

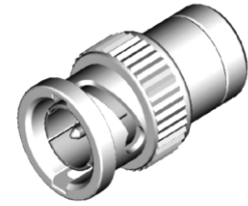

TER-J.STWX8-50KR, 2W, 0.5-17GHz



TER-N-50JR, 1W, 0-8GHz



TER-N-50JR-5W, 5W, 0-8GHz



TER-N-50JR-15W, 15W, 0-8GHz



TER-SMA-50JR, 0.5W, 0-18GHz



TER-SMA-50JR-2W, 2W, 0-18GHz

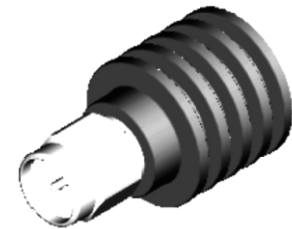

TER-SMA-50JR-5W, 5W, 0-18GHz



TER-SMA-50JR-15W, 15W, 0-8GHz



TER-SMA-KR, 0.5W, 0.5-1.7GHz



TER-TNC-50JR, 1W



TER-TNC-50JRG-5W, 5W, 0-8GHz



TER-TNC-50KR, 1W, 0-8GHz





SCHMID-MULTITECH, GmbH
Weinbergstraße 60b, 93105 Tegenheim
Tel.: +49-9403-9510-0
info@schmid-m.de
www.schmid-m.de



SCHMID-MULTITECH, GmbH
Of Ziemendorf, Dorfstraße 49g
49-39384-9848-0
info@schmid-m.de
www.schmid-m.de



ATD Elektronik, s.r.o.
Lužnice 10, 344 01 Domažlice
tel.: +420 379 723 915
info@atd-elektronik.cz
www.atd-elektronik.cz



ABC Elektronik Sp. z o.o.
ul. Kolejowa 10, 38-300 Gorlice
tel.: +48 18 353-66-65
info@abcpol.pl
www.abcpol.pl



SCHMID-MULTITECH, s.r.o.
Podjavorinskej 5, 911 05 Trenčín
tel.: +421-32-7 440 186
mkovacik@smsk.sk
www.schmid-multitech.sk



ANGIELA ELEKTRONIK SRL
Str. Slanic Nr. 1 Ap3, 400413 Cluj-Napoca
tel.: +42-264-403-284
info@angiel-elektronik.ro
www.angiel-elektronik.ro



ADMM Kft.
Rumi u, 284, H-9700 Szombathely
tel.: +36-94 510-522
mail@admm.hu
www.admm.hu

We are connecting
the world...

