

# RF COAXIAL CONNECTORS



We are connecting  
the world...

Edition 2

MMCX.....	1
MCX.....	3
MCX75 Ohm.....	5
SMA.....	6
SMB.....	15
SMB75 Ohm.....	18
SMC.....	19
N.....	21
BNC.....	26
TNC.....	30
BMA.....	33
MHV.....	34
7/16 Series.....	35
Reverse Polarity Connectors.....	36
Between Series Adapters.....	37
Cable Assemblies.....	38
UFL/MHF.....	43
Termination.....	44

On internet:  
QMA, SMA, FME, Mini-UHF, BNC75 Ohm, Mini SMB75 Ohm, SMP, SSMA, Fakra.

The information provided by this catalogue may be changed without notice. Printing errors reserved.  
Copyright 2016 SCHMID-MULTITECH GMBH

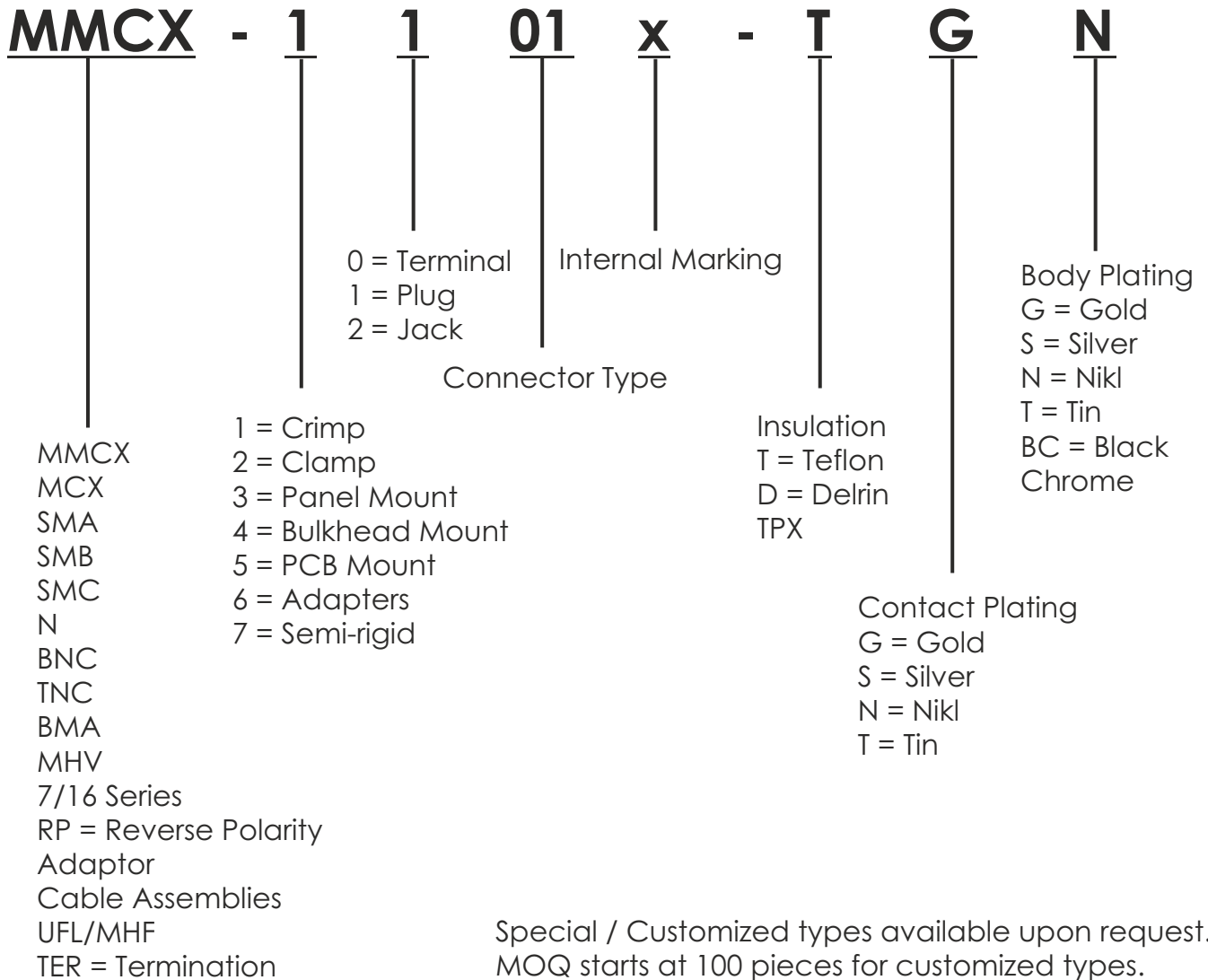

**For example:**

**SMB75-5201c-TGG** .....Connector SMB, 75 Ohm, PCB Mount, Jack, Teflon, Plating: Pin Gold, Body Gold, c - internal manufacturer marking

**SMA-3206-TGG** .....Connector SMA, 50 Ohm, Panel Mount, Jack Teflon, Plating: Pin Gold, Body Gold,

## SPECIFICATION - MMCX

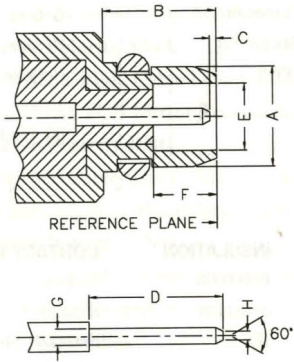

PLUG		
Letter	Millimeters	
	Minimum	Maximum
A	-	2.40
B	2.70	-
C	0.00	0.25
D	-	3.15
E	1.58	1.62
F	1.45	-
G	0.38	0.42
H	-	0.20

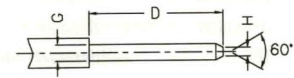

JACK		
Letter	Millimeters	
	Minimum	Maximum
A	2.41	-
B	2.60	-
C	0.90	1.20
D	0.68	0.72
E	1.40	-
F	3.00	3.04
G	2.87	2.90
H	1.57	1.63
I	2.30	2.34
J	-	0.23

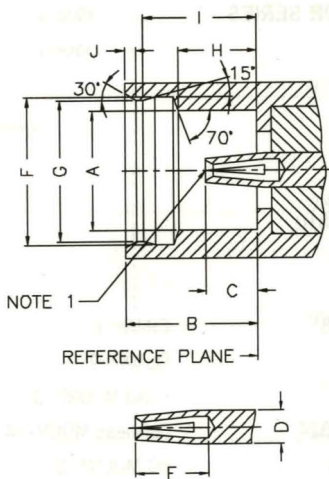

Electrical:	
Impedance	50 Ohm
Frequency Range	0 to 6.0 Ghz
VSWR	0 - 4 GHz = 1.2 max (straight)
	1.25 max (right angle)
	4 - 6 GHz = 1.25 max (straight)
	1.4 max (right angle)
Dielectric Withstanding Voltage	500 V Rms min. at sea level
Contact Resistance	center contact = 5.0 Milliohms max
	outer contact = 2.5 Milliohms max
RF Leakage	(-)60 dB min
Insertion Loss	0.4 dB max (straight)
	0.6 dB max (right angle)
Insulation Resistance	1.000 Megohms min

Mechanical & Environmental:	
Mating	"Push-pull" snap on coupling
Durability	500 matings
Cable Retention	RG - 174, 188, 316 - 20 lbs min
Temperature Range	(-)40 °C to 90 °C
Temperature Shock	MIL-STD-202 Method 107
Humidity	MIL-STD-202 Method 103

Material:		
	Material	Plating
Connector Body	Brass	Nickel or Gold
Center Contact	Male: Brass	Gold
	Female: Beryllium Copper	
Insulation	Teflon	None
Crimp Ferrule	Annealed Copper	Same as Body

### Straight Crimp Plug/Male

Part No.	Applicable Cable RG/U
MMCX-1101-TGG	178, 196
MMCX-1102-TGG	174, 188, 316
MMCX-1103-TGG	RD316u

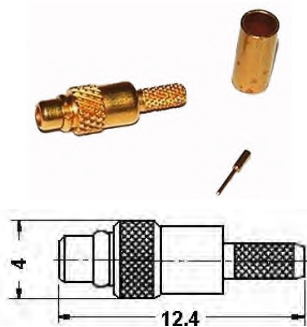

### R/A Crimp Plug/Male

Part No.	Applicable Cable RG/U
MMCX-1105-TGG	178, 196
MMCX-1106-TGG	174, 188, 316
MMCX-1107-TGG	RD 316u
MMCX-1109-TGG	58, 141A/U, 58A/U

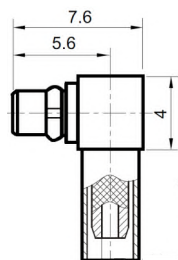

### Straight Crimp Plug/Male

Part No.	Applicable Cable RG/U
MMCX-1108-TGG	58U, 58A/U, 141A/U

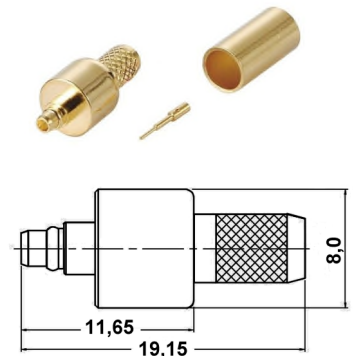



### Straight Crimp Jack/Female

Part No.	Applicable Cable RG/U
MMCX-1204-TGG	174,188,316

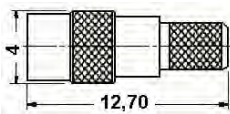

### Straight Edge Card Plug/Male

Part No.
MMCX-5101-TGG

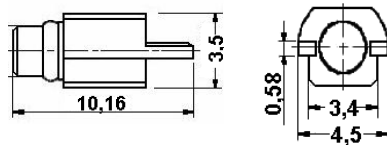

### Straight PCB Mount Plug/Male

Part No.	Dimensions
MMCX-5105-TGG	L = 7,5 mm S = 3,5 mm
MMCX-5112-TGG	L = 5,3 mm S = 4,5 mm

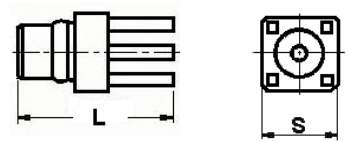

### R/A PCB Mount Jack/Female

Part No.	Dimensions
MMCX-5201-TGG	L = 7,00 mm
MMCX-5206-TGG	L = 6,55 mm
MMCX-5207-TGG	L = 5,36 mm

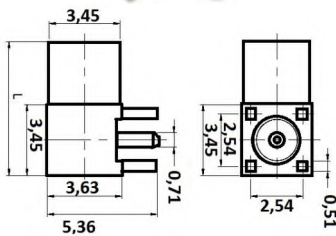

### Straight Edge Card Jack/Female

Part No.	Dimensions
MMCX-5203-TGG	L = 8,26 mm
MMCX-5204-TGG	L = 7,37 mm

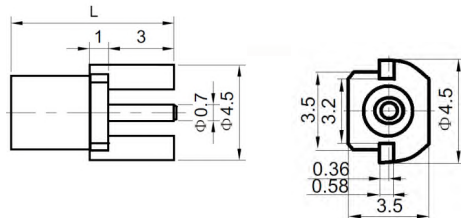

### Straight PCB Mount Jack/Female

Part No.	Dimensions
MMCX-5208-TGG	L = 7,42 mm
MMCX-5209-TGG	L = 6,23 mm

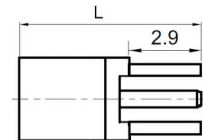

### R/A PCB Jack/Female

Part No.
MMCX-5211-TGG

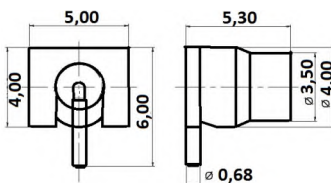

### Straight Plug/Male

Part No.	Applicable Cable RG/U
MMCX-7101-TGG	RG 405/u (0.085")
MMCX-7102-TGG	RG 047 (0.047")
MMCX-7106-TGG	RG 402/u (0.141")

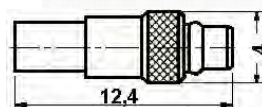

### Right Angle Plug/Male

Part No.	Applicable Cable RG/U
MMCX-7103-TGG	RG 405/u (0.085")
MMCX-7104-TGG	RG 047 (0.047")

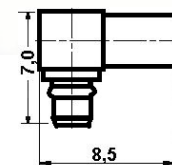

## SPECIFICATION - MCX

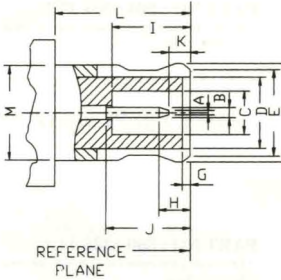

Letter	PLUG Millimeters(Inches)	
	Minimum	Maximum
A	-	0.25(.010)
B	0.48(.019)	0.53(.021)
C	2.00(.079)	2.07(.0815)
D	-	3.00(.118)
E	-	3.60(.142)
F	3.63(.143)	3.80(.150)
G	0.00(.000)	0.30(.012)
H	-	1.20(.047)
I	2.80(.110)	3.20(.126)
J	2.80(.110)	3.20(.126)
K	0.15(.006)	-
L	4.15(.163)	-
M	-	3.40(.134)

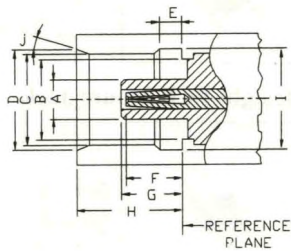

Letter	JACK Millimeters (Inches)	
	Minimum	Maximum
A	1.80 (.079)	1.98 (.078)
B	-	3.00 (.118)
C	3.42 (.135)	3.48 (.137)
D	3.80 (.150)	-
E	0.75 (.029)	0.85 (.033)
F	2.30 (.090)	2.80 (.110)
G	2.60 (.102)	2.80 (.110)
H	4.00 (.157)	4.12 (.162)
I	3.60 (.142)	3.80 (.150)
J	18°	22°

Electrical:	
Impedance	50 Ohm
Frequency Range	0 to 6.0 GHz
VSWR	0-4 GHz = 1.2 max (straight)
	1.25 max (right angle)
	4-6 GHz = 1.25 max (straight)
	1.4 max (right angle)
Dielectric Withstanding Voltage	500 V Rms min. at sea level
Contact Resistance	center contact = 5.0 Milliohms max outer contact = 2.5 Milliohms max
RF Leakage	(-)>60 dB min
Insertion Loss	0.4 dB max (straight)
	0.6 dB max (right angle)
Insulation Resistance	1.000 Megohms min

Mechanical & Environmental:	
Mating	"Push-pull" snap on coupling
Durability	500 matings
Cable Retention	RG - 174, 188, 316 - 20 lbs min
Temperature Range	(-)>60 °C to 165 °C
Vibration	MIL-STD-202 Method 204 Test Con. B
Salt Spray	MIL-STD-202 Method 101 Test Con. B
Temperature Cycling	MIL-STD-1344 Method 1003 Test.Co.A

Material:		
	Material	Plating
Connector Body	Brass	Nickel or Gold
Center Contact	Male: Brass	Gold
	Female: Beryllium Copper	
Insulation	Teflon	None
Crimp Ferrule	Annealed Copper	Same as Body

### Straight Crimp Plug/Male

Part No.	Applicable Cable RG/U
MCX-1101-TGG	174, 188A, 316
MCX-1102-TGG	178, 196
MCX-1111-TGG	58, 58A, 141

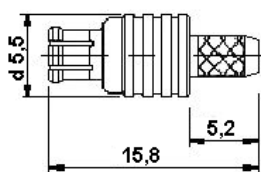

### R/A Crimp Plug/Male

Part No.	Applicable Cable RG/U
MCX-1105-TGG	174, 188A, 316
MCX-1106-TGG	178, 196
MCX-1110-TGN	58, 58A, 141 Nickel
MCX-1112-TGG	Cabel HFX50
MCX-1113-TGG	LMR240

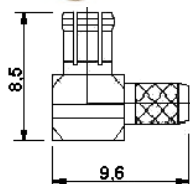

### Straight Crimp Jack/Female

Part No.	Applicable Cable RG/U
MCX-1203-TGG	174, 188A, 316
MCX-1204-TGG	178, 196

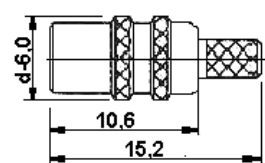

2 Holes Flange Jack/Female

<b>Part No.</b>
MCX-3201-TGG

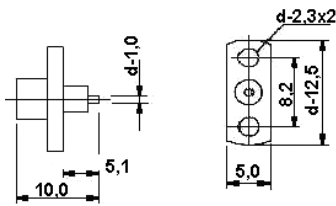

2 Holes Flange Jack/Female

<b>Part No.</b>
MCX-3202-TGG

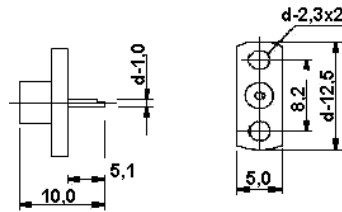

Bulkhead Jack/Female

<b>Part No.</b>
MCX-4201-TGG

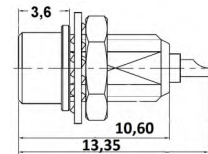

Straight PCB Cable Terminal Crimp

<b>Part No.</b>
MCX-5004-TG

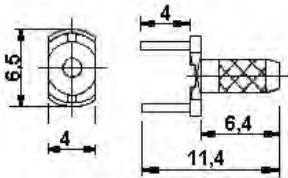

Straight PCB Plug/Male

Part No.	Applicable Cable RG/U
MCX-5101-TGG	L = 9.7 mm, L1 = 3.9 mm
MCX-5102-TGG	L = 8.7 mm, L1 = 2.9 mm
MCX-5103-TGG	L = 7.5 mm, L1 = 1.7 mm

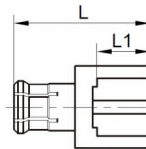

Straight PCB SMD Jack/Female

<b>Part No.</b>
MCX-5201-TGG

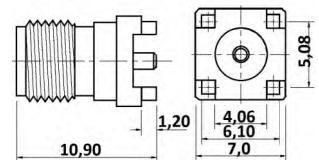

Straight PCB Jack/Female

<b>Part No.</b>
MCX-5202-TGG

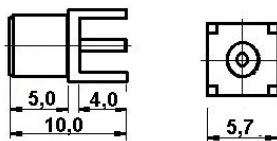

R/A PCB Jack/Female

<b>Part No.</b>
MCX-5203-TGG

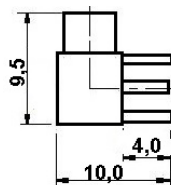

Straight SMT Jack/Female

<b>Part No.</b>
MCX-5205-TGG

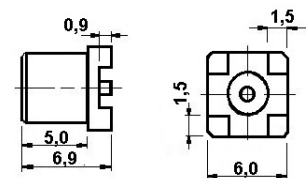

**R/A SMT Jack/Female**

Part No.
MCX-5206-TGG

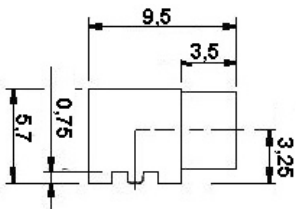

**PCB Cable Terminal**

Part No.	Applicable Cable RG/U
MCX-7003-G	RG405/U (0.085")

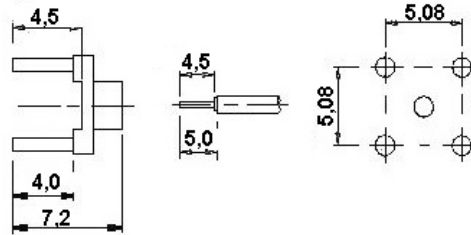

**PCB Cable Terminal**

Part No.	Applicable Cable RG/U
MCX-7004-G	RG405/U (0.085")

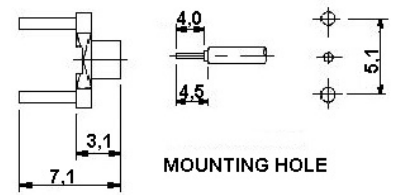

**Straight Plug/Male**

Part No.	Applicable Cable RG/U
MCX-7101-TGG	RG405/U (0.085")

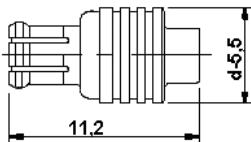

**R/A Plug/Male**

Part No.	Applicable Cable RG/U
MCX-7102-TGG	RG405/U (0.085")

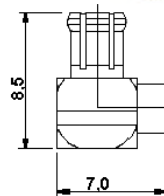

**Bulkhead Front Mount Jack/Female**

Part No.	Applicable Cable RG/U
MCX-7401-TGG	B1 = 1.3 mm
MCX-7403-TGG	B1 = 2.2 mm; Semi-rigid SFT-50-2-1

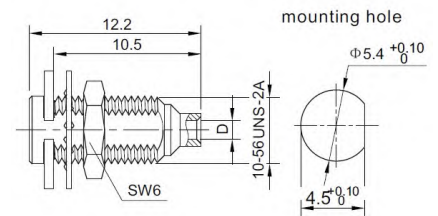

**R/A Crimp 75Ohm Plug/Male**

Part No.	Applicable Cable RG/U
MCX75-1101-TGG	179

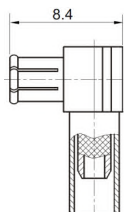

**Straight Bulkhead 75Ohm Jack/Fem.**

Part No.
MCX75-4201-TGG

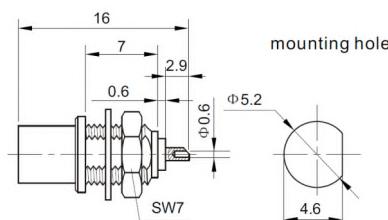

**PCB Mount 75 Ohm Jack/Fem.**

Part No.	Applicable Cable RG/U
MCX75-5202-TGG	L = 8.3 mm, h = 2.4 mm
MCX75-52021-TGG	L = 11.3 mm, h = 3.9 mm
MCX75-52022-TGG	L = 9.3 mm, h = 3.4 mm

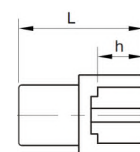



## SPECIFICATION - SMA

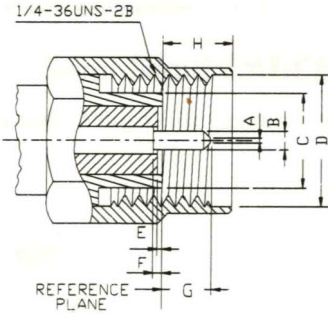

PLUG		
Letter	Millimeters(Inches)	
	Minimum	Maximum
A	0.00(.000)	0.38(0.15)
B	0.90(.0355)	0.94(.037)
C	-	4.59(.1808)
D	6.35(.250)	-
E	0.00(.000)	0.18(.007)
F	0.00(.000)	0.25(.010)
G	-	2.54(.100)
H	-	3.43(.135)

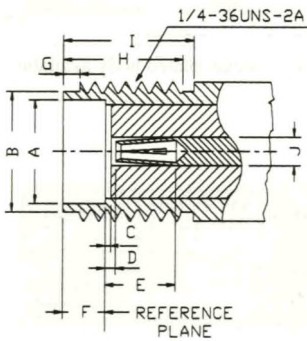

JACK		
Letter	Millimeters(Inches)	
	Minimum	Maximum
A	4.60(.1810)	4.67(.1837)
B	5.28(.208)	5.49(.216)
C	0.00(.000)	0.18(.007)
D	0.00(.000)	0.25(.010)
E	2.92(.115)	-
F	1.88(.074)	1.98(.078)
G	0.38(.015)	1.14(.045)
H	4.32(.170)	-
I	5.54(.218)	-
J	1.24(.049)	1.30(.051)

Electrical:	
Impedance	50 Ohm
Frequency Range	0 to 18.0 GHz * for RG - 402 & RG405 semi-rigid cable - 0 to 18.0 GHz * for flexible cable ? max operation frequency of cable per MIL-C-17
VSWR	* 1.05 + 0.005 x f GHz max (straight) * 1.15 + 0.015 x f GHz max (right angle) RG - 402 (.141" OD.) - 1.05 + 0.005 x f GHz max RG - 405 (.085" OD.) - 1.05 + 0.005 x f GHz max RG - 58, 141, 142, 223 - 1.10 + 0.01 x f GHz max (straight) 1.15 + 0.02 x f GHz max (right angle) RG - 174, 188, 316 - 1.15 + 0.01 x f GHz max (straight) 1.18 + 0.02 x f GHz max (right angle) RG - 178, 196 - 1.20 + 0.020 x f GHz max (straight) 1.25 + 0.025 x f GHz max (right angle)
Voltage Rating	* RG - 402 (.141" OD.) - 500 V rms max * RG - 405 (.085" OD.) - 335 V rms max * RG - 58, 141, 142, 223 - 500 V rms max * RG - 174, 188, 316 - 335 V rms max * RG - 178, 196 - 250 V rms max
Dielectric Withstanding Voltage	* RG - 402 (.141" OD.) - 1 000 V rms max * RG - 405 (.085" OD.) - 750 V rms max * RG - 58, 141, 142, 223 - 1 000 V rms max * RG - 174, 188, 316 - 750 V rms max * RG - 178, 196 - 500 V rms max
Contact Resistance	center contact = 3.0 Milliohms max outer contact = 2.0 Milliohms max
RF Leakage	(- )90 dB min
Insertion Loss	0.04 dB max x $\sqrt{f}$ GHz (straight) 0.06 dB max x $\sqrt{f}$ GHz (right angle)
Insulation Resistance	5 000 Megohms min

Mechanical & Environmental:	
Mating	1/4" - 36 threaded coupling
Durability	500 matings
Coupling Nut Retention	Min 60 lbs
Recommend Nut Mating Torque	8 inch-pounds
Cable Retention	RG - 58, 141, 142, 223 - 40 lbs min RG - 174, 188, 316 - 20 lbs min
Temperature Range	(-)65 °C to 165 °C
Vibration	MIL-STD-202 Method 204 Test. Cond. D.
Salt Spray	MIL-STD-202 Method 101 Test. Cond. B.
Temperature Cycling	MIL-STD-202 Method 102 Test. Cond. C.

Material:		
Connector Body	Stainless steel	Plating Passivated or gold
	Brass	Nickel or gold
Center Contact	Male: Brass Female: Beryllium Copper	Gold
Insulation	Teflon	None
Gasket	Silicone	None
Crimp Ferrule	Annealed Copper	Same as Body

### Male Nut Cap with chain

Part No.
SM A-1001-TG N

### R/A Crimp Plug/Male

Part No.	Applicable Cable RG/U
SMA-1101-TGG	58, 58A, 141A
SMA-1102-TGG	174, 188A, 316
SMA-1103-TGG	142B/U

### Straight Crimp Plug/Male

Part No.	Applicable Cable RG/U
SMA-1104-TGG	58, 58A, 141A
SMA-1105-TGG	174, 188A, 316
SMA-1106-TGG	142B/U

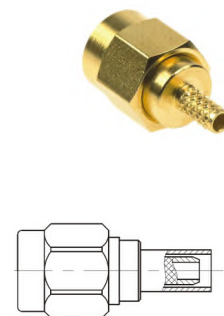
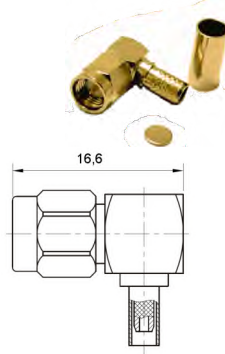
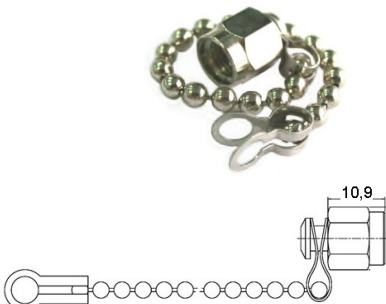

### Straight Crimp Plug/Male

### R/A Crimp Plug/Male

### Straight Crimp Jack/Female

Part No.	Applicable Cable RG/U
SMA-1119-TGN	cabl LMR400
SMA-1127-TGN	cabl LMR300
SMA-1128-TGN	cabl LMR240
SMA-1130-TGN	cabl LMR200

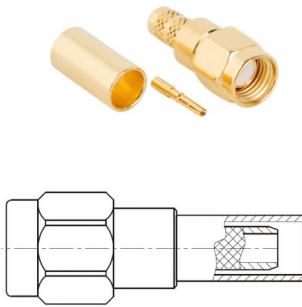

Part No.	Applicable Cable RG/U
SMA-1147-TGG	178, 196

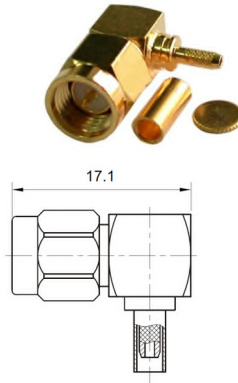

Part No.	Applicable Cable RG/U
SMA-1207-TGG	58, 58A, 141A
SMA-1208-TGG	174, 188A, 316
SMA-1209-TGG	142B/U

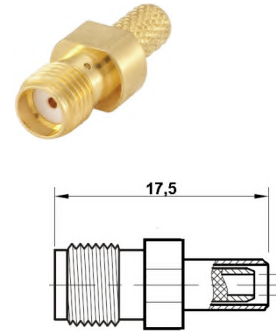

### Straight Bulkhead Crimp Jack/F.

### Straight Bulkhead Crimp Jack/F.

### Straight Bulkhead Crimp Jack/F.

Part No.	Applicable Cable RG/U
SMA-1210-TGG	58, 58A, 141A
SMA-1211-TGG	174, 188A, 316
SMA-1212-TGG	142B/U

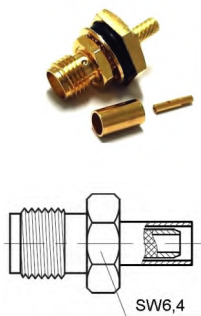

Part No.	Applicable Cable RG/U
SMA-1221-TGG	174, 188A/U, 316



Part No.	Applicable Cable RG/U
SMA-1223-TGG	178, 196

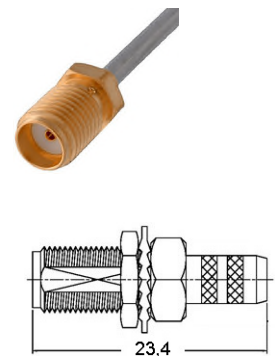

### Straight Bulkhead Crimp Jack/F.

### Straight Crimp Jack/Female

### Straight Bulkhead Jack/Female

Part No.	Applicable Cable RG/U
SMA-1225-TGG	174, 188A/U, 316

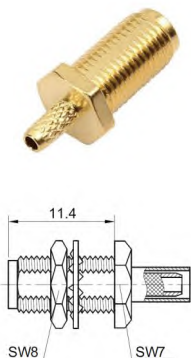

Part No.	Applicable Cable RG/U
SMA-1229-TGG	LMR240
SMA-1239-TGG	LMR400
SMA-1241-TGG	LMR200

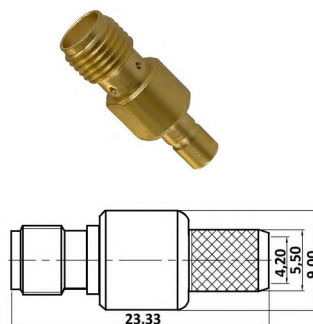

Part No.	Applicable Cable RG/U
SMA-1230-TGG	RG174, 188, 316
SMA-1231-TGG	SFF-50-2-1
SMA-1232-TGG	RG58, 58A, 141A

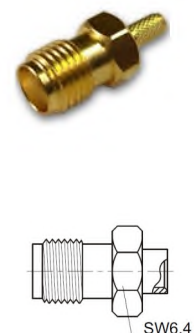

### Square Flange Crimp Jack/F.

Part No.	Applicable Cable RG/U
SMA-1236-TGG	223U, 142, 400
SMA-1237-TGG	174U, 188A/U, 316U

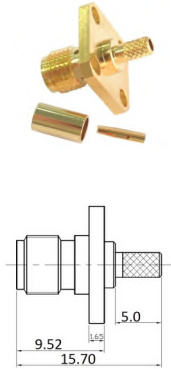

### R/A Bulkhead Crimp Jack/Female

Part No.	Applicable Cable RG/U
SMA-1248-TGG	174U, 188A/U, 316U

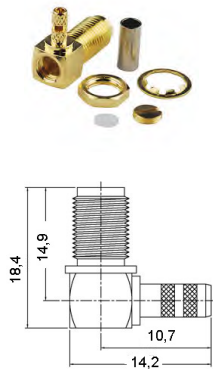

### R/A PCB Crimp Jack/Female

Part No.	Applicable Cable RG/U
SMA-1249-TGG	174U, 188A/U, 316U

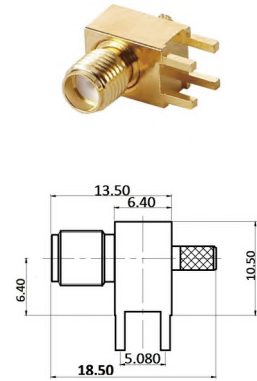

### Straight Clamp Jack/F.

Part No.	Applicable Cable RG/U
SMA-2102-TGG	174, 188A, 316
SMA-2103-TGG	142B/U
SMA-2106-TGG	58, 58A, 141A, 142, 223

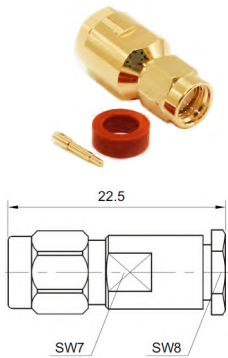

### Square Flange Plug/Male

Part No.
SMA-3101-TGG
SMA-3112-TGG

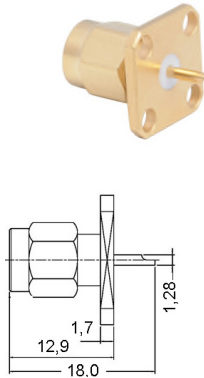

### 2 Holes Flange Plug/Male

Part No.
SMA-3103-TGG

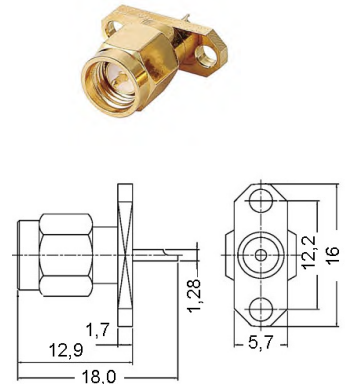

### Square Flange Plug/Male

Part No.
SMA-3105-TGG

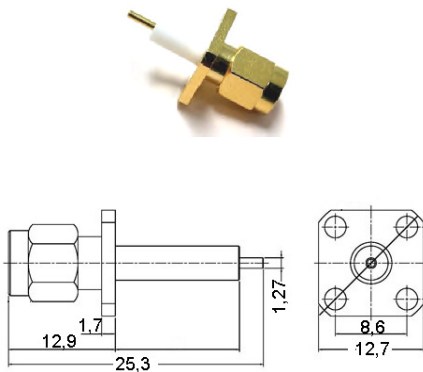

### 2 Holes Flange Plug/Male

Part No.
SMA-3107-TGG

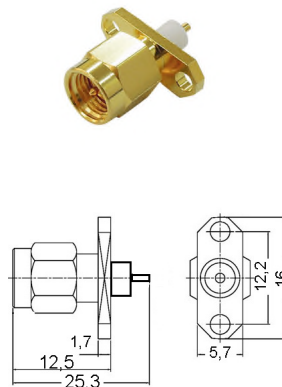

### 2 Holes Flange Plug/Male

Part No.
SMA-3110-TGG

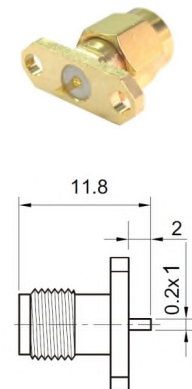

### Square Flange Plug/Male

Part No.
SMA-3112-TGG

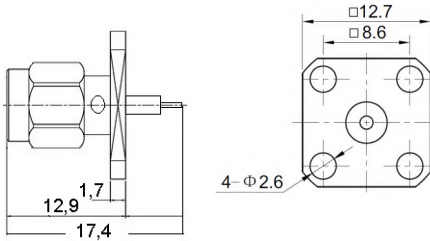

### 2 Holes Flange Plug/Male

Part No.
SMA-3114-TGG

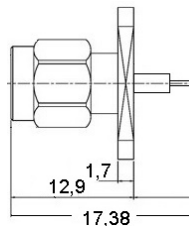

### 2 Holes Flange Plug/Male

Part No.
SMA-3135-TGG

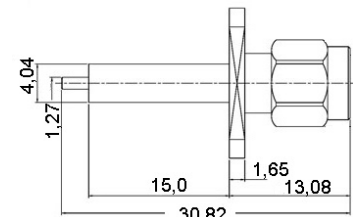

### Square Flange Jack/Female

Part No.	Dimensions
SMA-3202-TGG	L = 14.4 mm, L1 = 0 mm, L2 = 4.9 mm
SMA-3201-TGG	L = 12.5 mm, L1 = 0 mm, L2 = 3 mm
SMA-32022-TGG	L = 16.5 mm, L1 = 4 mm, L2 = 3 mm
SMA-32023-TGG	L = 16.5 mm, L1 = 5.5 mm, L2 = 1.5 mm

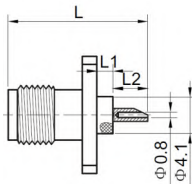

### 2 Holes Flange Jack/Female

Part No.
SMA-3204-TGG

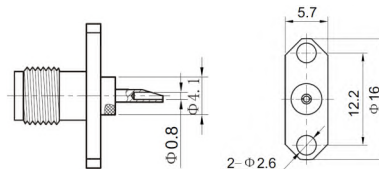

### Square Flange Jack/Female

Part No.
SMA-3206-TGG

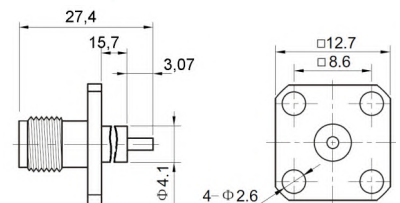

### 2 Holes Flange Jack/Female

Part No.	Dimensions
SMA-3208-TGG	L = 27.4 mm, L1 = 15 mm, L2 = 3 mm
SMA-32081-TGG	L = 17.5 mm, L1 = 17.5 mm, L2 = 4 mm
SMA-32082-TGG	L = 15.5 mm, L1 = 2 mm, L2 = 4 mm
SMA-32083-TGG	L = 20.5 mm, L1 = 8 mm, L2 = 3 mm
SMA-32084-TGG	L = 37 mm, L1 = 24.5 mm, L2 = 3 mm
SMA-32085-TGG	L = 11.5 mm, L1 = 0 mm, L2 = 2 mm

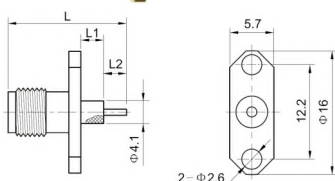

### 2 Holes Flange Jack/Female

Part No.
SMA-3211-TGG

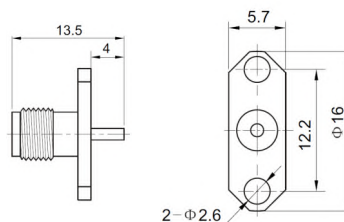

### Square Flange Jack/Female

Part No.	Dimensions
SMA-3213-TGG	L=14mm, L1=3.2mm; L2=1.3mm
SMA-3216-TGG	for Microstrip Line Circuits

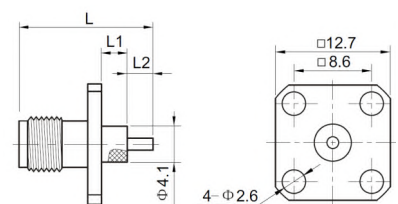



### 2 Holes Flange Jack/Female

Part No.	Note
SMA-3215-TGG	for Microstrip Line Circuits
SMA-3217-TGG	contact horizontal to panel
SMA-3218-TGG	contact vertical to panel

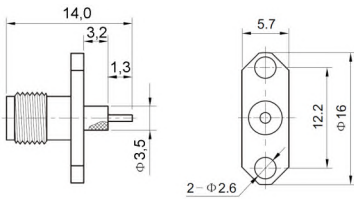

### R/A Square Flange Jack/Female

Part No.
SM A-3219-TGG

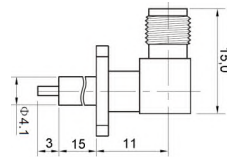

### R/A 2 Holes Flange Jack/Female

Part No.
SM A-3220-TGG

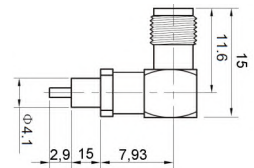

### Square Flange Jack/Female

Part No.
SM A-3221-TGG

SLOTTED CONTACT

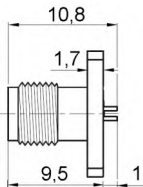

### 2 Hole Flange Jack/Female

Part No.	Note
SMA-3222-TGG	slotted contact

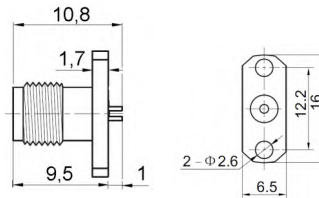

### Square Flange Jack/Female

Part No.
SMA-3223-TGG

HALF ROUND CONTACT

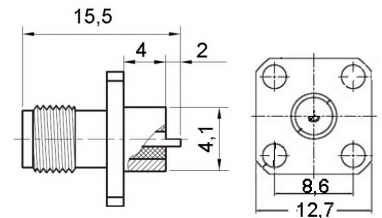

### 2 Holes Flange Jack/Female

Part No.
SM A-3224-TGG

HALF ROUND CONTACT

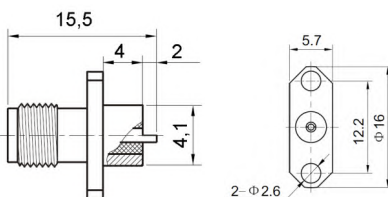

### R/A 2 Hole Flange Jack/Female

Part No.
SM A-3233-TGN

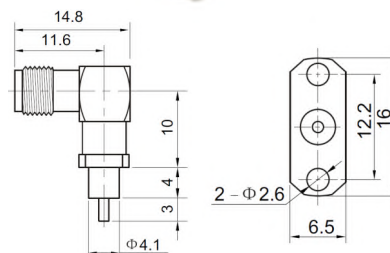

### Bulkhead Plug/Male

Part No.
SMA-4115-TGN

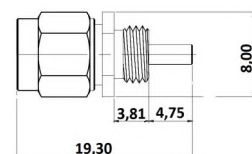

**Straight Bulkhead Jack/Female**

Part No.
SMA-4201-TGG

Front Mount

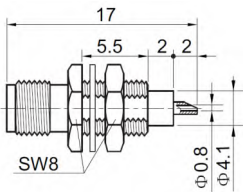

**Straight Bulkhead Jack/Female**

Part No.
SMA-4202-TGG

Rear Mount

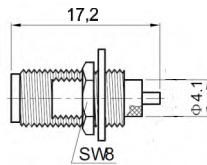
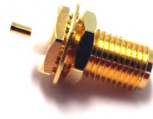

**With Coaxial End Jack/Fem.**

Part No.	Dimensions
SMA-4203-TGG	L = 16.7 mm, L1 = 2 mm, d = 1.2 mm
SMA-42031-TGG	L = 24.9 mm, L1 = 2.9 mm, d = 1.3 mm
SMA-42032-TGG	L = 15.6 mm, L1 = 3 mm, d = 0.5 mm
SMA-42033-TGG	L = 12 mm, L1 = 1.5 mm, d = 1 mm
	no nut/gasket
SMA-42034-TGG	L = 25.7 mm, L1 = 13 mm, d = 2 mm
	no nut/gasket
SMA-42035-TGG	L = 19.5 mm, L1 = 2.5 mm, d = 1.3 mm
	no nut/gasket

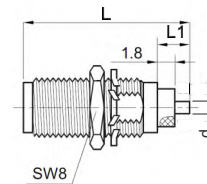

**2 Hole Flange Press-in Jack/Female**

Part No.
SMA-4204-TGG

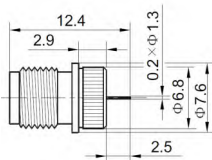

**Thread Mount with EMI Bushing**

Part No.
SMA-4207-TGG

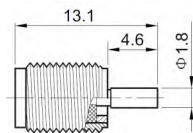

**Bulkhead Jack/Female**

Part No.
SMA-4209-TGG

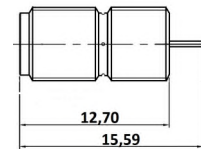

**Bulkhead Jack/Female**

Part No.
SMA-4211-TGG

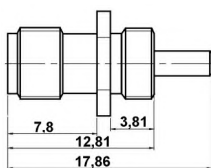

**Straight PCB Jack/Female**

Part No.	Dimensions
SMA-5201-TGG	L = 13.0 mm, L1 = 3.5 mm
SMA-52011-TGG	L = 13.5 mm, L1 = 3.9 mm
SMA-52012-TGG	L = 12.1 mm, L1 = 2.6 mm
SMA-52013-TGG	L = 15.5 mm, L1 = 2.9 mm

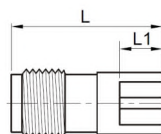

**R/A PCB Jack/Female**

Part No.
SMA-5202-TGG

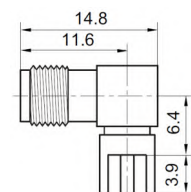

### Straight SMD Jack/Female

Part No.
SMA-5203-TGG

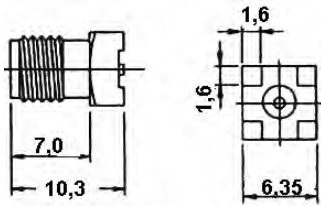

### R/A SMD Jack/Female

Part No.
SMA-5204-TGG

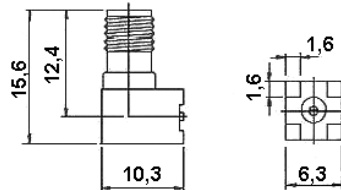

### Edge Card Jack/Female

Part No.	Dimensions
SMA-5205-TGG	L = 9.52 mm, L1 = 1.73 mm
SMA-52051-TGG	L = 6.1 mm, L1 = 1.5 mm
SMA-52052-TGG	L = 6.7 mm, L1 = 2.2 mm
SMA-52053-TGG	L = 6.7 mm, L1 = 2 mm
SMA-52054-TGG	L = 6.7 mm, L1 = 2.5 mm
SMA-52055-TGG	L = 6.1 mm, L1 = 1.6 mm
SMA-52056-TGG	L = 6.1 mm, L1 = 1.0 mm

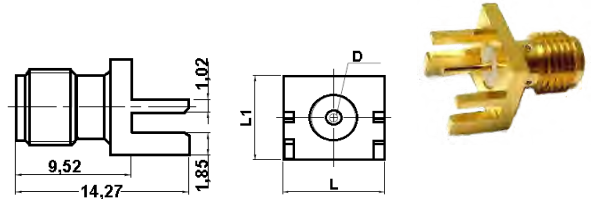

### Edge Card Jack/Female

Part No.
SMA-5212-TGG

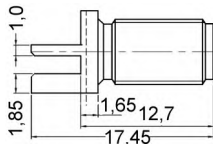

### Edge Card Jack/Female

Part No.
SMA-5214-TGG

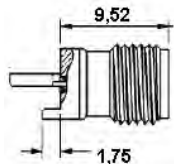

### PCB Straight Jack/Female

Part No.
SMA-5215-TGG

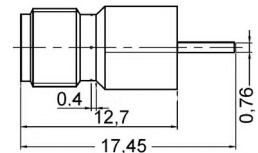

### R/A PCB Jack/Female

Part No.
SMA-5223-TGG

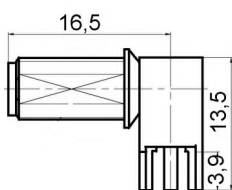

### PCB Jack/Female

Part No.
SMA-5229-TGG

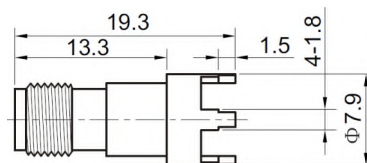

### R/A Plug/Male - Jack/Female

Part No.
SMA-601-TGG

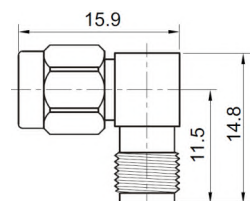

**Bulkhead Jack/Female - Jack/Female Plug/Male - Plug/Male**

<b>Part No.</b>
SM A-602-TGG

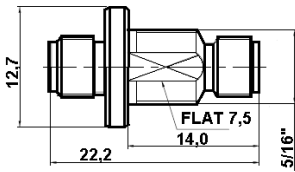

<b>Part No.</b>
SM A-603-TGG

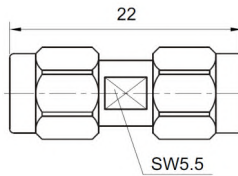

<b>Part No.</b>
SM A-604-TGG

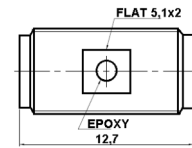

**Bulkhead Jack/Female - Jack/Female R/A Plug/Male - Plug/Male R/A Jack/Female - Jack/Female**

<b>Part No.</b>
SM A-605-TGG

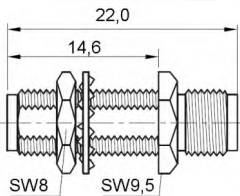

<b>Part No.</b>
SM A-608-TGG

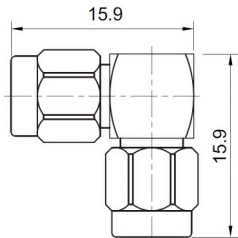

<b>Part No.</b>
SM A-609-TGG

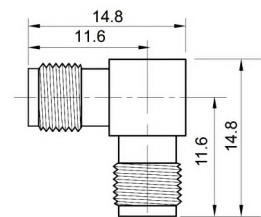

**Straight Jack/Fem. - Plug/Male 4 Holes Flange Cable Terminal 2 Holes Flange Cable Terminal**

<b>Part No.</b>
SM A-610-TGG

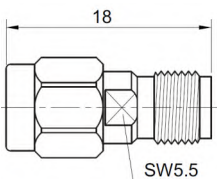

Part No.	Applicable Cable RG/U
SMA-7014-G	RG 402/U (0.141")
SMA-7015-G	RG 405/U (0.085")

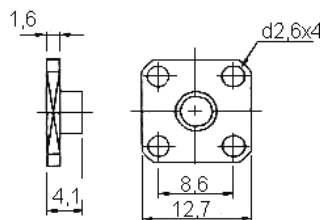

Part No.	Applicable Cable RG/U
SMA-7016-G	RG 402/U (0.141")
SMA-7017-G	RG 405/U (0.085")

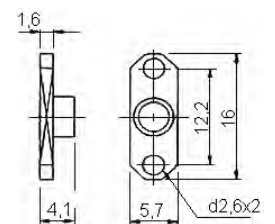



### Straight (W/ Center Contact) Plug/Male

Part No.	Applicable Cable RG/U
SMA-7101-TGG	RG 402/U (0.141")
SMA-7102-TGG	RG 405/U (0.085")
SMA-7118-TGG	semi-rigid 0.047"

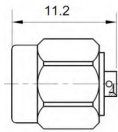

### R/A Plug/Male

Part No.	Applicable Cable RG/U
SMA-7111-TGG	RG 402/U (0.141")
SMA-7112-TGG	RG 405/U (0.085")

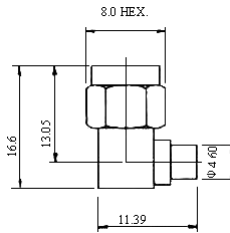

### Straight Plug/Male

Part No.	Applicable Cable RG/U
SMA-7113-TGG	RG 401/U (0.250")

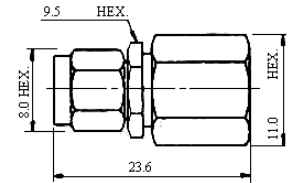

### Straight Jack/Female

Part No.	Applicable Cable RG/U
SMA-7203-TGG	RG 402/U (0.141")
SMA-7204-TGG	RG 405/U (0.085")

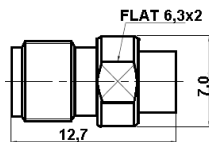

### Straight Bulkhead Jack/Female

Part No.	Applicable Cable RG/U
SMA-7205-TGG	RG 402/U (0.141")
SMA-7206-TGG	RG 405/U (0.085")

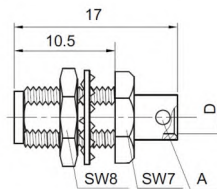

### Square Flange Jack/Female

Part No.	Applicable Cable RG/U
SMA-7207-TGG	RG 402/U (0.141")
SMA-7208-TGG	RG 405/U (0.085")

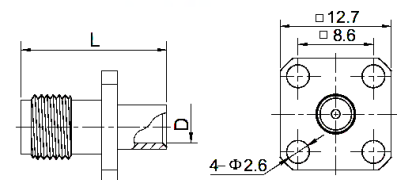

### Straight 2 Hole Flange Jack/Female

Part No.	Applicable Cable RG/U
SMA-7209-TGG	RG 402/U (0.141")
SMA-7210-TGG	RG 405/U (0.085")

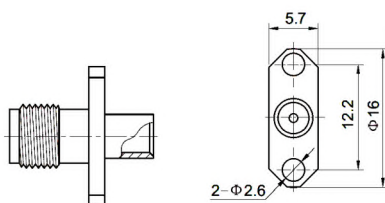

### Straight Jack/Female

Part No.
SMA-7221-TGG

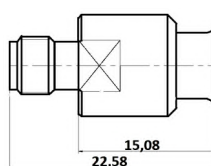

### 2 Hole Flange Jack/Female

Part No.	Applicable Cable RG/U
SMA-7241-TGG	RG 405/U, L = 12
SMA-7242-TGG	RG 405/U, L = 13.1

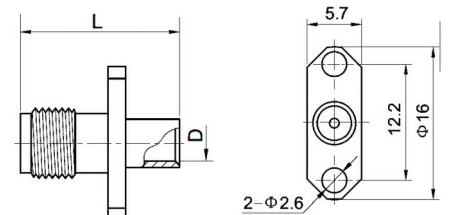

## SPECIFICATION - SMB

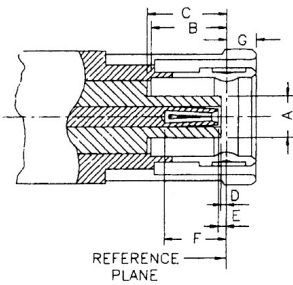

PLUG		
Letter	Millimeters (Inches)	
	Minimum	Maximum
A	2.01 (.079)	2.06 (.081)
B	3.58 (.141)	3.78 (.149)
C	3.58 (.141)	-
D	0.27 (.0105)	0.52 (.0205)
E	0.29 (.0115)	0.57 (.0225)
F	2.97 (.117)	-
G	-	1.63 (.064)

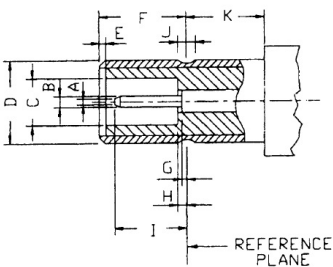

JACK		
Letter	Millimeters (Inches)	
	Minimum	Maximum
A	-	0.25 (.010)
B	0.48 (.019)	0.53 (.021)
C	2.08 (.082)	2.16 (.085)
D	3.66 (.144)	3.71 (.146)
E	0.04 (.0015)	0.24 (.0095)
F	3.33 (.131)	3.53 (.139)
G	0.04 (.0015)	0.18 (.007)
H	-	0.18 (.007)
I	2.39 (.094)	2.72 (.107)
J	0.69 (.027)	0.94 (.037)
K	1.65 (.065)	-

Electrical:	
Impedance	50 Ohm
Frequency Range	0 to 4.0 Ghz
VSWR	1.25 + 0.04 x f GHz max (straight)
	1.30 + 0.04 x f GHz max (right angle)
	* RG - 174,188,316 - 1.25 + 0.04 x f GHz max (straight)
	- 1.3 + 0.04 x f GHz max (right angle)
	* RG - 178,196 - 1.3 + 0.04 x f GHz max (straight)
- 1.4 + 0.06 x f GHz max (right angle)	
Voltage Rating	* RG - 174, 188, 316 - 335 V rms max
	* RG - 178, 196 - 250 V rms max
Dielectric Withstanding Voltage	* RG - 174, 188, 316 - 750 V rms max
	* RG - 178, 196 - 500 V rms max
Contact Resistance	center contact = 6.0 Milliohms max
	outer contact = 1.0 Milliohms max
RF Leakage	(-)55 dB min @ 3 Ghz
Insertion Loss	0.4 dB max (straight)
	0.6 dB max (right angle)
Insulation Resistance	1.000 Megohms min

Mechanical & Environmental:	
Mating	Snap-on coupling
Durability	500 matings
Coupling Nut Retention	40 lbs min
Cable Retention	RG - 174, 188, 316 - 20 lbs min
	RG - 178, 196 - 6 lbs min
Temperature Range	(-)65 °C to 165 °C
Vibration	MIL-STD-202 Method 204 Test Cond. B.
Salt Spray	MIL-STD-202 Method 101 Test Cond. B.
Temperature Cycling	MIL-STD-1344 Method 1003 Test Cond. A.

Material:		
	Material	Plating
Connector Body	Brass	Nickel or Gold
Center Contact	Male: Brass	Gold
	Female: Beryllium Copper	
Insulation	Teflon	None
Gasket	Silicone Rubber	None
Crimp Ferrule	Annealed Copper	Same as Body

An SMB jack has a male center pin, while an SMB plug has a female basket.

### Straight Crimp Plug/Male

Part No.	Applicable Cable RG/U
SMB-1101-TGG	174, 188A, 316
SMB-1102-TGG	178, 196

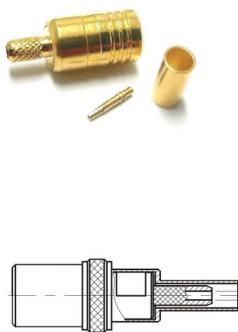

### R/A Crimp Plug/Male

Part No.	Applicable Cable RG/U
SMB-1107-TGG	174, 188A, 316
SMB-1108-TGG	178, 196
SMB-1109-TGG	58U, 58A/U, 141A/U

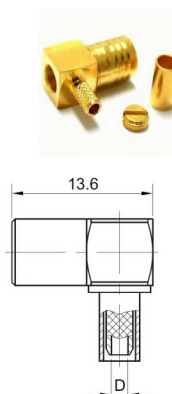

### Straight Crimp Plug/Male

Part No.	Applicable Cable RG/U
SMB-1111-TGN	LMR240
SMB-1112-TGN	LMR240

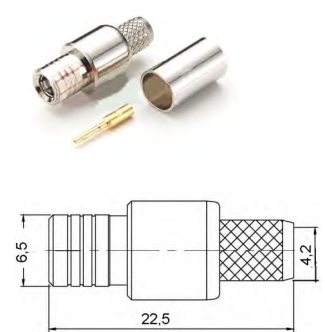

**Straight Crimp Jack/Female**

Part No.	Applicable Cable RG/U
SMB-1205-TGG	174, 188A, 316
SMB-1206-TGG	178, 196
SMB-1210-TGN	58U, 58A/U, 141A/U

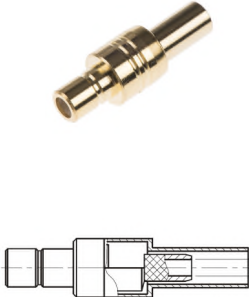

**Straight Bulkhead Crimp Jack/Female**

Part No.	Applicable Cable RG/U
SMB-1205-TGG	174, 188A, 316
SMB-1206-TGG	178, 196

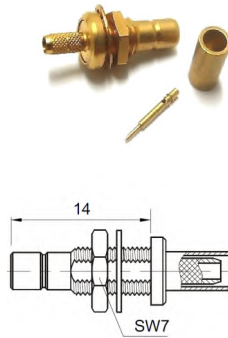

**Straight Clamp Plug/Male**

Part No.	Applicable Cable RG/U
SMB-2101-TGG	174, 188A, 316
SMB-2102-TGG	178, 196

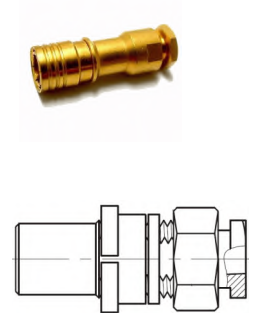

**Straight Clamp Jack/Female**

Part No.	Applicable Cable RG/U
SMB-2103-TGG	174, 188A, 316
SMB-2104-TGG	178, 196

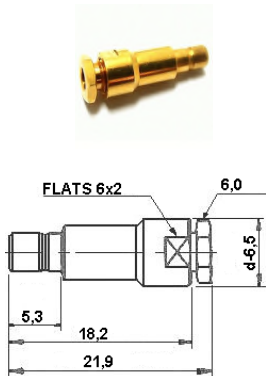

**Square Flange Jack/Female**

Part No.
SMB-3201-TGG

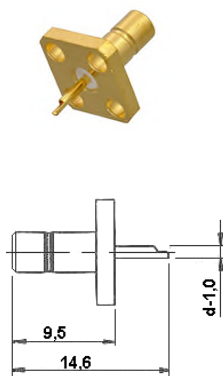

**2 Hole Flange Jack/Female**

Part No.
SMB-3202-TGG

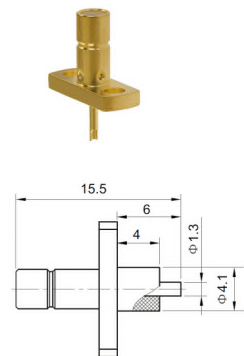

**Straight Bulkhead Jack/Female**

Part No.	Applicable Cable RG/U
SMB-4201-TGG	Rear Mount
SMB-4202-TGG	Front Mount

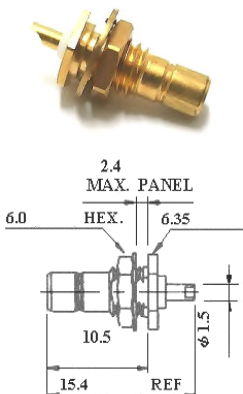

**Straight Bulkhead Jack/Female**

Part No.
SMB-4203-TGG

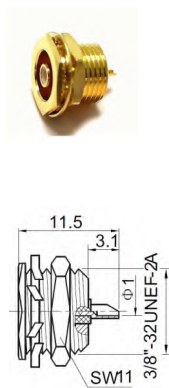

**R/A PCB Plug/Male**

Part No.	Applicable Cable RG/U
SMB-5101-TGG	
SMB-51011-TGG	with protection cap

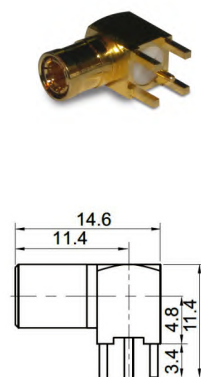

### PCB Mount Rec. Plug/Male

Part No.
SMB-5102-TGG

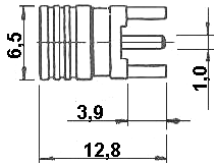

### PCB Straight Plug/Male

Part No.	Dimensions
SMB-5103-TGG	L = 12.5 mm, L1 = 3.9 mm
SMB-51031-TGG	L = 21.5 mm, L1 = 2.9 mm

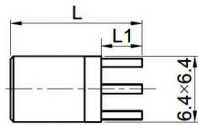

### R/A PCB Mount Jack/Female

Part No.	Dimensions
SMB-5201-TGG	L = 15.4 mm, L1 = 12.3 mm
SMB-52011-TGG	L = 21.6 mm, L1 = 18.4 mm
SMB-52012-TGG	L = 13.7 mm, L1 = 10.8 mm
SMB-52013-TGG	L = 15.5 mm, L1 = 12.3 mm

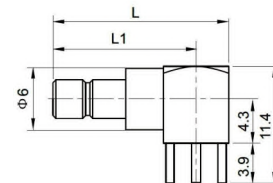

### PCB Mount Jack/Female

Part No.	Dimensions
SMB-5203-TGG	L = 11.4 mm, L1 = 6.3 mm
SMB-52031-TGG	L = 10.7 mm, L1 = 5.6 mm
SMB-52032-TGG	L = 18.3 mm, L1 = 13.2 mm
SMB-52033-TGG	L = 13.7 mm, L1 = 8.6 mm
SMB-52034-TGG	L = 9.9 mm, L1 = 5.2 mm

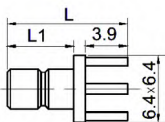
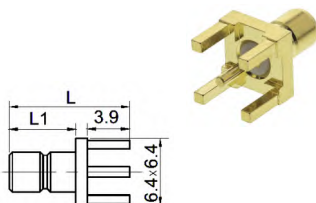

### SMT Mount Jack/Female

Part No.
SMB-5204-TGG

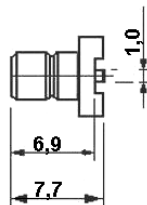

### Edge Card Jack/Female

Part No.
SMB-5205-TGG

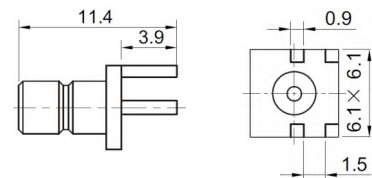

### R/A PCB Jack/Female

Part No.
SMB-5206-TGG

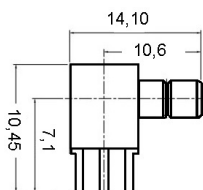

### Straight PCB Jack/Female

Part No.
SMB-5207-TGG

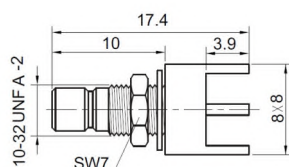

### R/A PCB Jack/Female

Part No.	Dimensions
SMB-5210-TGG	L = 17.9 mm, L1 = 11.5 mm, L2 = 14.7 mm
SMB-52101-TGG	L = 21.6 mm, L2 = 15.2 mm, L2 = 18.4 mm
SMB-52102-TGG	L = 21.6 mm, L2 = 15.2 mm, L2 = 14.7 mm with double nut

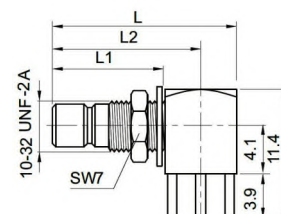



### Plug/Male-Plug/Male

Part No.
SMB-601-TGG

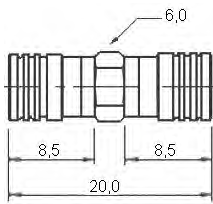

### Bulkhead Jack/Female-Jack/Female

Part No.
SM B-602-TGG

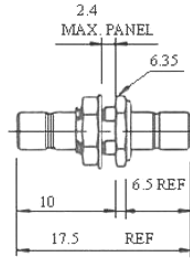

### Straight Crimp Plug/Male

Part No.	Applicable Cable RG/U
SMB-7100-TGG	RG 402/U (0.141")
SMB-7101-TGG	RG 405/U (0.085")

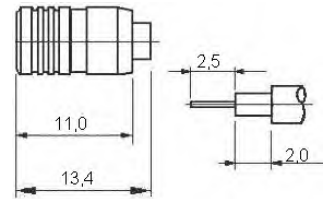

### Straight Crimp Plug/Male

Part No.	Applicable Cable RG/U
SMB-7102-TGG	405/U (0.085)
SMB-7103-TGG	402/U; B1 = 3.6 mm cabel B3
SMB-7104-TGG	B1 = 1.3 mm cabel B1

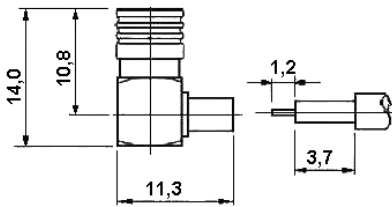

### 2 Holes Flange Jack/Female

Part No.	Applicable Cable RG/U
SM B-7241-TGG	RG 405/u (0.085")

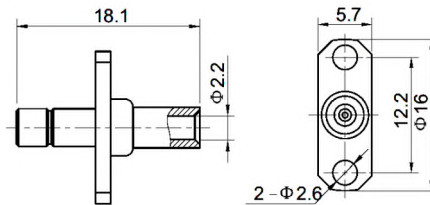

### Straight Crimp (75 Ohm) Plug/Male

Part No.	Applicable Cable RG/U
SMB75-1101-TGG	179B, 187A
SMB75-1104-TGG	735A

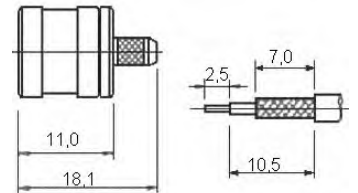

### R/A Crimp (75 Ohm) Plug/Male

Part No.	Applicable Cable RG/U
SMB75-1102-TGG	179B, 187A

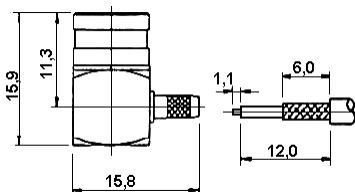

### Straight Bulkhead (75 Ohm) Jack/Fem.

Part No.
SM B75-4201-TGG

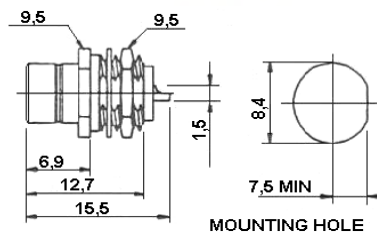

### Straight PCB (75 Ohm) Jack/Fem.

Part No.
SMB75-5201-TGG

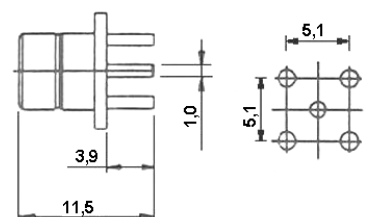

## SPECIFICATION - SMC

Electrical:	
Impedance	50 Ohm
Frequency Range	0 to 10.0 Ghz
VSWR	1.15 + 0.04 x f GHz max (straight)
	1.25 + 0.04 x f GHz max (right angle)
	* RG - 174, 188, 316 - 1.15 + 0.04 x f GHz max (straight)
	- 1.25 + 0.04 x f GHz max (right angle)
Voltage Rating	* RG - 174, 188, 316 - 335 V rms max
	* RG - 178, 196 - 250 V rms max
Dielectric Withstanding Voltage	* RG - 174, 188, 316 - 750 V rms max
	* RG - 178, 196 - 500 V rms max
Contact Resistance	center contact = 6.0 Milliohms max outer contact = 1.0 Milliohms max
RF Leakage	(-)-55 dB min @ 3 GHz
Insertion Loss	0.4 dB max (straight)
	0.6 dB max (right angle)
Insulation Resistance	1.000 Megohms min

Mechanical & Environmental:	
Mating	# 10 - 32 threaded coupling
Durability	500 matings
Cable Retention	RG - 174, 188, 316 - 20 lbs min
	RG - 178, 196 - 6 lbs min
Coupling Nut Retention	40 lbs min
Temperature Range	(-)-65 °C to 165 °C
Vibration	MIL-STD-1344 Method 2005 Test Cond. IV.
Salt Spray	MIL-STD-202 Method 101 Test Cond. B.
Temperature Cycling	MIL-STD-1344 Method 1003 Test Cond. A.

Material:		
	Material	Plating
Connector Body	Brass	Nickel or Gold
Center Contact	Male: Brass	Gold
	Female: Beryllium Copper	
Insulation	Teflon	None
Gasket	Silicone Rubber	None
Crimp Ferrule	Annealed Copper	Same as Body

PLUG		
Letter	Millimeters(Inches)	
	Minimum	Maximum
A	2.01(.079)	2.06(.081)
B	3.73(.147)	-
C	2.79(.110)	-
D	2.79(.110)	-
E	-	3.10(.122)
F	0.00(.000)	-
G	3.23(.127)	3.40(.134)
H	3.30(.130)	3.40(.134)
I	-	5.92(.233)

JACK		
Letter	Millimeters(Inches)	
	Minimum	Maximum
A	-	0.25(.010)
B	0.48(.019)	0.53(.021)
C	2.08(.082)	2.16(.085)
D	3.66(.144)	3.71(.146)
E	3.12(.123)	3.38(.133)
F	5.94(.234)	-
G	0.00(.000)	-
H	0.79(.031)	-
I	3.40(.134)	3.61(.142)
J	3.40(.134)	3.51(.138)

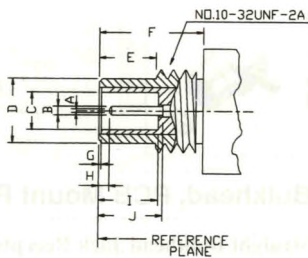
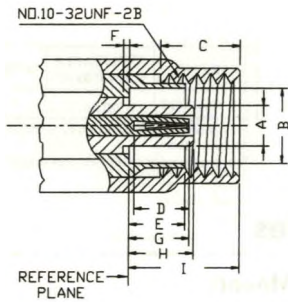

### Straight Crimp Plug/Male

Part No.	Applicable Cable RG/U
SMC-1101-TGG	174, 188A, 316
SMC-1102-TGG	178, 196

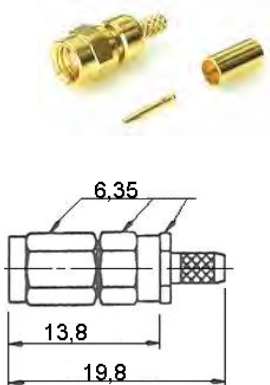

### R/A Crimp Plug/Male

Part No.	Applicable Cable RG/U
SMC-1103-TGG	174, 188A, 316
SMC-1104-TGG	178, 196

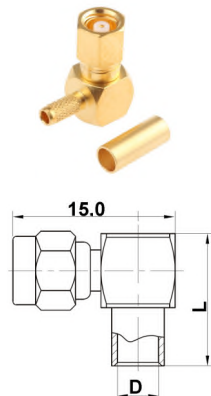

### Straight Clamp Plug/Male

Part No.	Applicable Cable RG/U
SMC-2101-TGG	174, 188A, 316
SMC-2102-TGG	178, 196

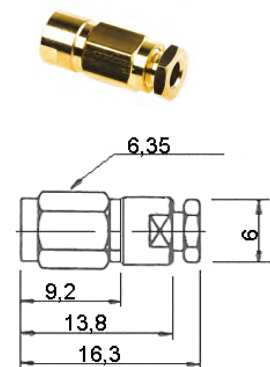

**R/A Clamp Plug/Male**

Part No.	Applicable Cable RG/U
SMC-2103-TGG	174, 188A, 316
SMC-2104-TGG	178, 196

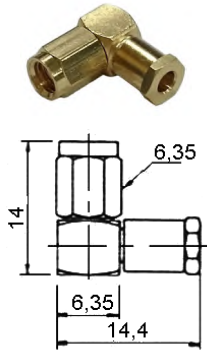

**Square Flange Jack/Female**

Part No.
SMC-3201-TGG

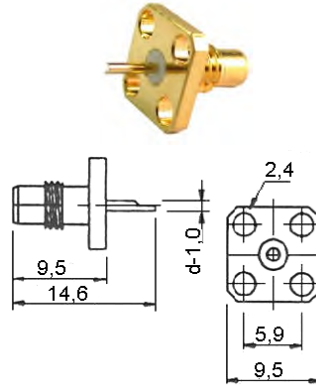

**Straight Bulkhead Jack/Female**

Part No.
SMC-4201-TGG

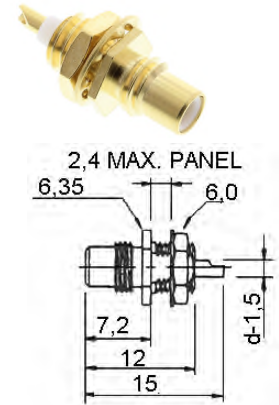

**Straight PCB Jack/Female**

Part No.
SMC-5201-TGG

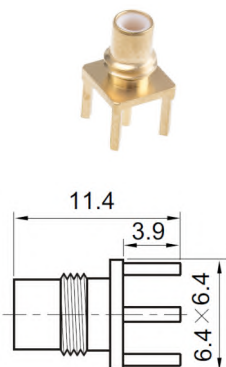

**R/A PCB Jack/Female**

Part No.
SMC-5202-TGG

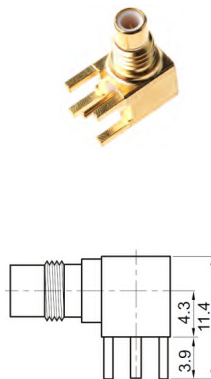

**Straight SMD Jack/Female**

Part No.
SMC-5203-TGG

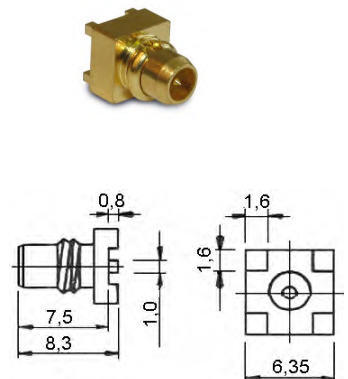

**R/A SMD Jack/Fem.**

Part No.
SMC-5204-TGG

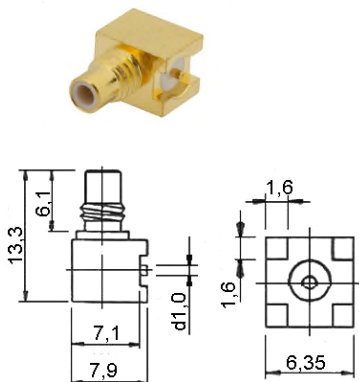

**Straight Plug/Male**

Part No.	Applicable Cable RG/U
SMC-7101-TGG	RG 405/u (0.085")

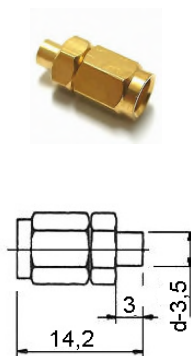

**R/A Plug/Male**

Part No.	Applicable Cable RG/U
SMC-7102-TGG	RG 405/u (0.085")

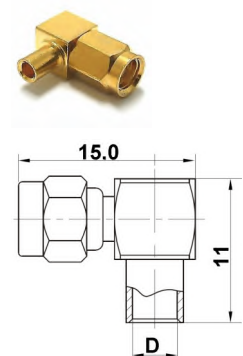

## SPECIFICATION - N

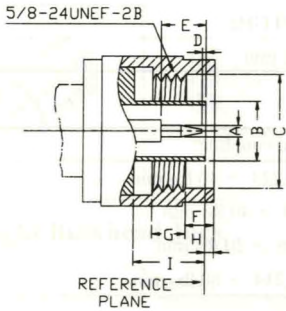

PLUG		
Letter	Millimeters(Inches)	
	Minimum	Maximum
A	1.60 (.063)	1.68 (.066)
B	7.95 (.313)	8.03 (.3158)
C	16.00 (.630)	-
D	0.08 (.003)	-
E	5.33 (.210)	5.84 (.230)
F	4.01 (.158)	4.27 (.168)
G	4.50 (.177)	-
H	0.41 (.016)	1.52 (.060)
I	10.11 (.398)	10.46 (.412)

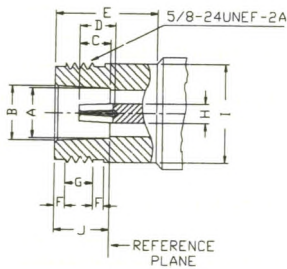

JACK		
Letter	Millimeters(Inches)	
	Minimum	Maximum
A	8.03 (.316)	8.13 (.320)
B	8.53 (.336)	8.74 (.344)
C	4.75 (.187)	5.26 (.207)
D	5.33 (.210)	-
E	10.72 (.422)	-
F	1.19 (.047)	1.96 (.077)
G	4.37 (.172)	5.13 (.202)
H	3.00 (.118)	3.15 (.124)
I	-	15.93 (.627)
J	9.04 (.356)	9.19 (.362)

Electrical:	
Impedance	50 Ohm 75 Ohm
Frequency Range	0 to 12.4 Ghz 0 to 1.5 GHz
VSWR	1.15 + 0.015 x f GHz max
Voltage Rating	1.500 V rms max
	* RG - 58, 141, 142, 223 - 500 V rms max * RG - 174, 188, 316 - 335 V rms max
Dielectric Withstanding Voltage	2.500 V rms max
	* RG - 58, 141, 142, 223 - 500 V rms max * RG - 174, 188, 316 - 750 V rms max
Contact Resistance	center contact = 1.0 Milliohms max
	outer contact = 0.2 Milliohms max
RF Leakage	(- 90 - f GHz) dB min
Insertion Loss	0.05 dB max x √f GHz
Insulation Resistance	5.000 Megohms min

Mechanical & Environmental:	
Mating	5/8" - 24 threaded coupling
Durability	500 matings
Cable Retention	RG - 58, 141, 142, 223 - 40 lbs min
	RG - 59, 62A, 210 - 40 lbs min
	RG - 174, 188, 316 - 20 lbs min
	RG - 8A, 9B, 213, 214 - 80 lbs min
Coupling Nut Retention	100 lbs min
Temperature Range	(-)65 °C to 165 °C
Vibration	MIL-STD-202 Method 204 Test Cond. B.
Salt Spray	MIL-STD-202 Method 101 Test Cond. B.
Temperature Cycling	MIL-STD-202 Method 107 Test Cond. B.

Material:		
Connector Body	Brass	Plating Nickel or Silver
Center Contact	Male: Brass	Gold
	Female: Brass	
	Phosphor Bronze or Beryllium Copper	
Insulation	Teflon	None
Gasket	Silicone Rubber, Rubber	None
Crimp Ferrule	Annealed Copper	Same as Body

### Connector Cover + Chain

Part No.
N-1001-N

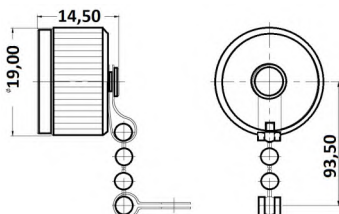

### Straight Crimp Plug/Male

Part No.	Applicable Cable RG/U
N-1101-TGN	8A, 213 (UG No. 1681/I)
N-1102-TGN	9B, 214 (UG No. 1682/U)
N-1103-TGN	58, 58A, 141A
N-1104-TGN	59, 62A, 210
N-1118-TGN	LMR240
N-1124-TGN	LMR400
N-1125-TGN	LMR300
N-1129-TGN	LMR200
N-1134-TGN	Belden 9248
N-1148-TGN	LMR 600

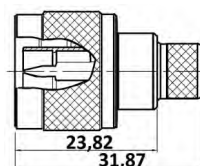

### Straight Crimp Plug/Male

Part No.	Applicable Cable RG/U
N-1105-TGN	223, 58, 141
N-1106-TGN	174, 316
N-1149-TGN	178, 196

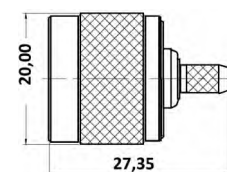



R/A Crimp Plug/Male

Part No.	Applicable Cable RG/U
N-1113-TGN	8A, 213
N-1114-TGN	9B, 214
N-1115-TGN	58, 58A, 141A
N-1116-TGN	59, 62A, 210
N-1119-TGN	174U, 188A/U, 316U

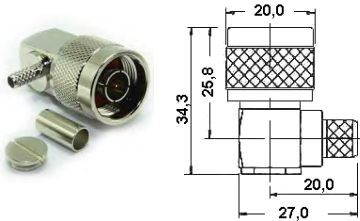

Straight Crimp Jack/Female

Part No.	Applicable Cable RG/U
N-1207-TGN	8A, 213 (UG No. 1688/U)
N-1208-TGN	9B, 214 (UG No. 1689/U)
N-1209-TGN	58, 58A, 141A
N-1210-TGN	59, 62A, 210
N-1211-TGN	58, 58A, 141A
N-1212-TGN	174, 188A, 316
N-1227-TGN	LMR400
N-1228-TGN	LMR200

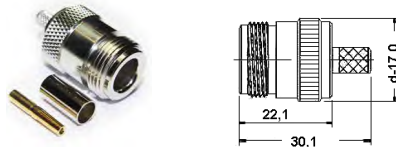

Straight Bulkhead Jack Crimp

Part No.	Applicable Cable RG/U
N-1217-TGN	174, 188A, 316
N-1220-TGN	142u
N-1226-TGN	LMR240
N-1235-TGN	LMR400
N-1240-TGN	178u, 196u

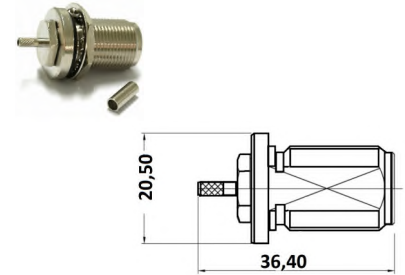

Square Flange Crimp Jack/Female

Part No.	Applicable Cable RG/U
N-1223-TGN	58, 141



Straight Clamp Plug/Male

Part No.	Applicable Cable RG/U
N-2101-TGN	8A, 213 (UG No. 21B/U)
N-2102-TGN	9B, 214
N-2103-TGN	8A, 213 (captive contact)
N-2104-TGN	9B, 214
N-2105-TGN	58, 58A, 141A (UG No. 536B/U)
N-2106-TGN	59, 62A, 210 (UG No. 603A/U)
N-2118-TGN	LMR400
N-2120-TGN	LMR 600
N-2122-TGN	FSJ1-50A
N-2124-TGN	LMR 900

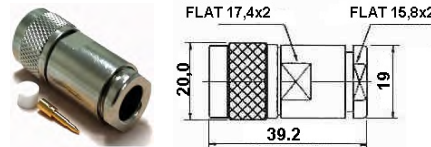

Straight Clamp Plug/Male

Part No.	Applicable Cable RG/U
N-2107-TGN	58U
N-2108-TGN	174U, 316U, 188U

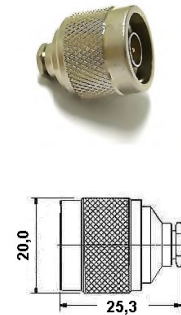

Straight Clamp Cable 1/4" Plug/Male

Part No.	Applicable Cable RG/U
N-2140-TGN	1/4", L = 38.10 mm
	center conductor solder
N-2141-TGN	1/4", L = 44.9 mm
	center conductor without solder

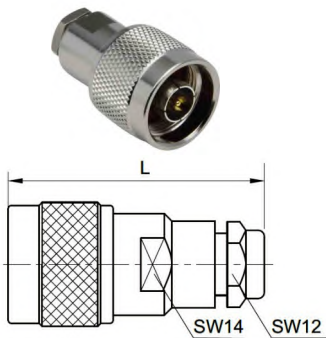

Straight Clamp 3/8" Plug/Male

Part No.	Applicable Cable RG/U
N-2143-TGN	3/8"; center conductor without solder

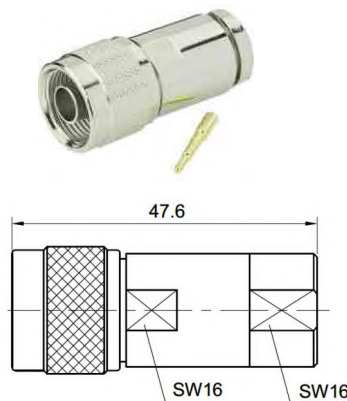

Straight Clamp Plug/Male

Part No.	Applicable Cable RG/U
N-2148-TGN	1/2"

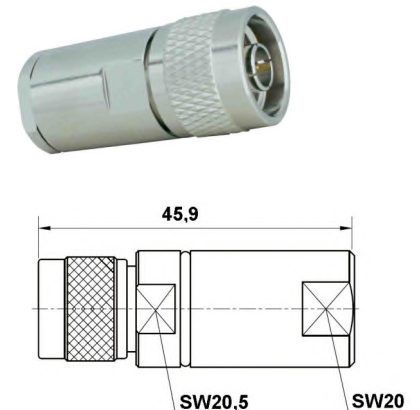

**Straight Clamp Jack/Female**

Part No.	Applicable Cable RG/U
N-2209-TGN	8A, 213 (L: 46,5 mm)
N-2212-TGN	9B, 214 (L: 35,7 mm)
N-2213-TGN	58, 58A, 141A

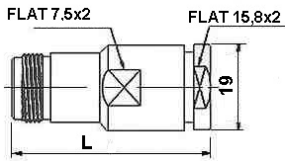

**Straight Bulkhead Clamp Jack/Fem.**

Part No.	Applicable Cable RG /U
N-2217-TGN	58, 58A, 141A
N-2218-TGN	174U, 188U, 316U

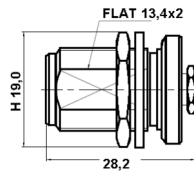

**Straight Clamp Jack/Female**

Part No.	Applicable Cable RG/U
N-2214-TGN	174U, 316U, 178, 188, 179U
N-2215-TGN	58A, 223U, 55U, 141, 142U, 303U

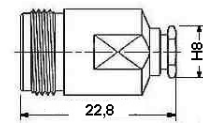

**Straight Clamp Jack/Female**

Part No.	Applicable Cable RG/U
N-2241-TGN	1/2"
N-2242-TGN	7/8"

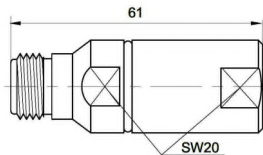

**Square Flange Plug/Male**

Part No.	Applicable Cable RG/U
N-3103-TGN	solder pot contact
N-3105-TGN	tab contact
N-3106-TGN	slotter contact

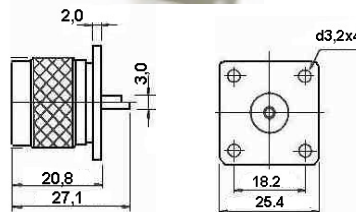

**Square Flange Plug/Male**

Part No.	Applicable Cable RG/U
N-3104-TGN	exposed teflon

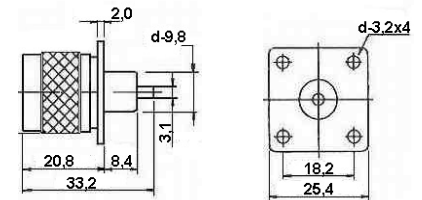

**Square Flange Jack/Female**

Part No.	Dimensions
N-3201-TGN	A: 6.5 ; B: 28

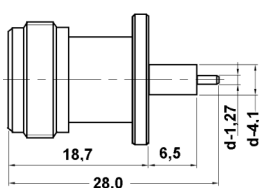

**Square Flange Jack/Female**

Part No.	Dimensions	Note
N-32011-TGN	L = 23.5 mm, L1 = 8.8 mm, L2 = 2 mm, d = 1.3 mm	seal rings
N-32012-TGN	L = 41.5 mm, L1 = 18.8 mm, L2 = 4 mm, d = 1.3 mm	seal rings
N-32013-TGN	L = 36.5 mm, L1 = 15 mm, L2 = 3 mm, d = 1.2 mm	
N-32014-TGN	L = 29.3 mm, L1 = 9.5 mm, L2 = 1.3 mm, d = 1.3 mm	
N-32015-TGN	L = 45.7 mm, L1 = 25 mm, L2 = 2 mm, d = 1.3 mm	seal rings
N-32016-TGN	L = 78.7 mm, L1 = 58 mm, L2 = 2 mm, d = 1.5 mm	seal rings

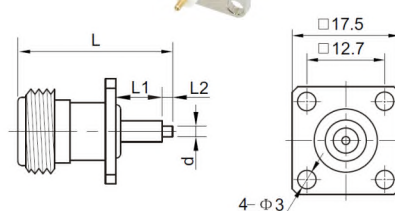

**Square Flange Jack/Female**

Part No.
N-3202-TGN

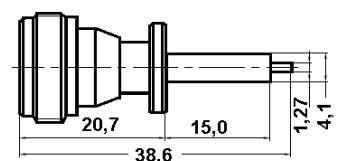

**Bulkhead Square Flange Jack/Fem.**

Part No.
N-3207-TGN

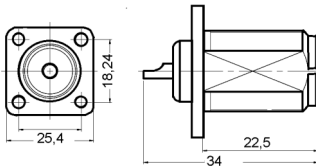

**Square Flange Jack/Fem.**

Part No.
N-3210-TGN

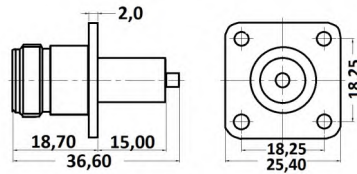

**R/A Square Flange Jack/Fem.**

Part No.	Applicable Cable RG/U
N-3211-TGN	with solder cup contact

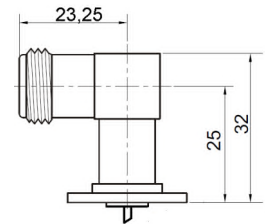

**Square Flange Jack/Female**

Part No.
N-3213-TGN

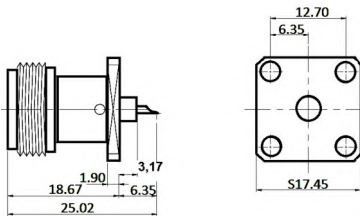

**Square Flange Jack/Female**

Part No.
N-3214-TGN

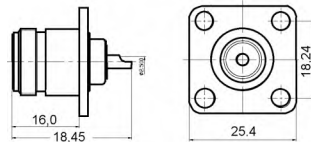

**Square Flange Jack/Female**

Part No.
N-3215-TGN

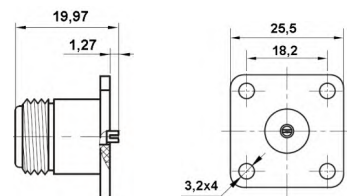

**Straight Bulkhead Plug/Male**

Part No.
N-4111-TGN

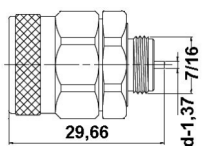

**Straight Bulkhead Jack/Female**

Part No.	Applicable Cable RG/U
N-4201-TGN	UG No. 680A/U

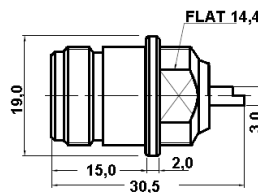

**Straight Press-in Jack/Female**

Part No.
N-4202-TGN

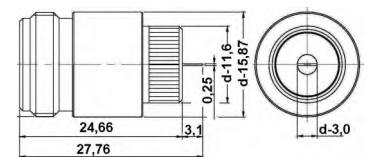

Straight Bulkhead Plug/Male

Adapter Plug/Male-Plug/Male

Adapter Jack/Fem.-Jack/Fem.

Part No.
N-4207-TGN

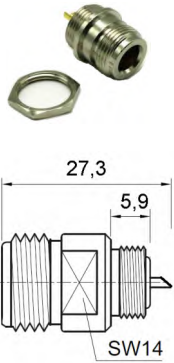

Part No.
N-601-TGN

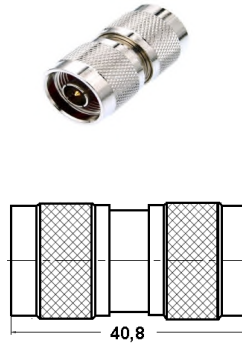

Part No.
N-602-TGN

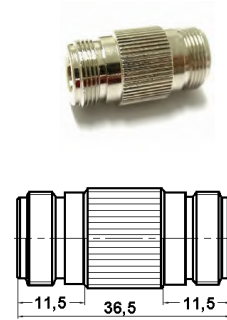

R/A Adapter Plug/Male-Jack/Fem.

T-Adapter N Plug/Male to N Jack/Fem.

Straight Plug/Male

Part No.
N-606-TGN

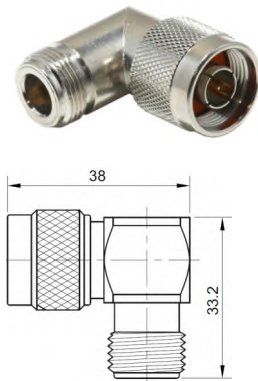

Part No.
N-608-TGN

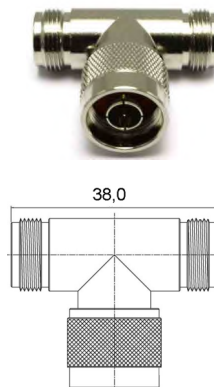

Part No.	Applicable Cable RG/U
N-7101-TGN	RG 402/U (0.141")
N-7102-TGN	RG 405/U (0.085")



Straight Jack/Female

Straight Bulkhead Jack/Female

Square Flange Jack/Female

Part No.	Applicable Cable RG/U
N-7203-TGN	RG 402/U (0.141")
N-7204-TGN	RG 405/U (0.085")
N-7205-TGN	RG 401/U (0.250")

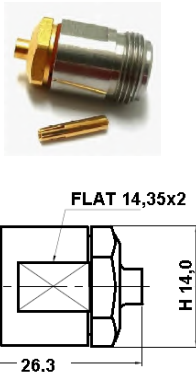

Part No.	Applicable Cable RG/U
N-7206-TGN	RG 402/U (0.141")
N-7207-TGN	RG 405/U (0.085")



Part No.	Applicable Cable RG/U
N-7209-TGN	RG 402/U (0.141")
N-7210-TGN	RG 405/U (0.085")

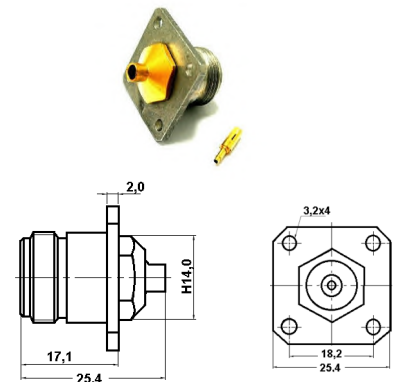



## SPECIFICATION - BNC

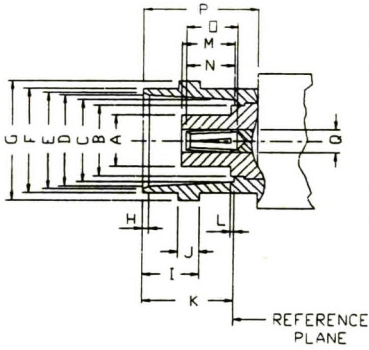

Letter	JACK	
	Millimeters(Inches)	
	Minimum	Maximum
A	-	4.72 (.186)
B	-	6.50 (.256)
C	8.10 (.319)	8.15 (.321)
D	8.31 (.327)	8.46 (.333)
E	8.80 (.346)	9.04 (.356)
F	9.60 (.378)	9.70 (.382)
G	10.97 (.432)	11.07 (.436)
H	0.38 (.015)	0.76 (.030)
I	5.18 (.204)	5.28 (.208)
J	1.91 (.075)	2.06 (.081)
K	8.31 (.327)	8.51 (.335)
L	-	0.15 (.006)
M	4.80 (.189)	5.28 (.208)
N	4.72 (.186)	5.23 (.206)
O	4.95 (.195)	-
P	10.52 (.414)	-
Q	2.06 (.081)	2.21 (.087)

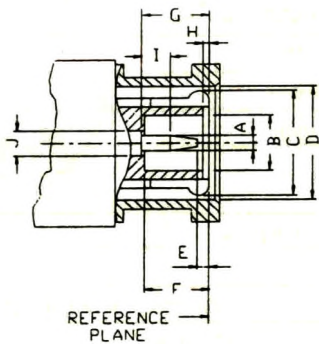

Letter	PLUG	
	Millimeters(Inches)	
	Minimum	Maximum
A	1.32 (.052)	1.37 (.054)
B	4.83 (.190)	-
C	SLOTTED AND FLARED TO MEET ELECTRICAL AND MECHANICAL REQUIREMENTS	
D	9.78 (.385)	9.91 (.390)
E	0.08 (.003)	-
F	5.28 (.208)	5.79 (.228)
G	5.33 (.210)	5.84 (.230)
H	0.15 (.006)	0.46 (.018)
I	2.00 (.078)	-
J	2.06 (.081)	2.21 (.087)

Electrical:		
Impedance	50 Ohm	75 Ohm
Frequency Range	0 to 6.0 Ghz	0 to 1 GHz
VSWR	1.3 max	
Voltage Rating	500 V rms max	
	* RG - 58, 141, 142, 223 - 500 V rms max * RG - 174, 188, 316 - 335 V rms max	
Dielectric Withstanding Voltage	1.500 V rms max	
	* RG - 58, 141, 142, 223 - 1.000 V rms max * RG - 174, 188, 316 - 750 V rms max	
Contact Resistance	center contact = 1.5 Milliohms max	
	outer contact = 0.5 Milliohms max	
RF Leakage	(-)55 dB min @ 3 GHz	
Insertion Loss	0.2 dB max @ 3 GHz	
Insulation Resistance	5.000 Megohms min	

Mechanical & Environmental:	
Mating	Two stud bayonet coupling
Durability	5800 matings
Coupling Nut Retention	100 lbs. Min
Cable Retention	* RG - 58, 141, 142, 223 - 40 lbs min
	* RG - 59, 62A, 210 - 40 lbs min
	* RG - 174, 188, 316 - 20 lbs min
	* RG - 179B, 187A - 20 lbs min
Temperature Range	(-)65 °C to 85 °C
Vibration	MIL-STD-202 Method 204 Test Cond. B.
Salt Spray	MIL-STD-202 Method 101 Test Cond. B.

Material:		
	Material	Plating
Connector Body	Brass	Nickel or Gold
Center Contact	Male: Brass	Gold
	Female: Beryllium Copper	
	Phosphor Bronze or Beryllium Copper	
Insulation	Teflon or Delrin	None
Basket	Silicone Rubber, Rubber	None
Crimp Ferrule	Annealed Copper	Same as Body

### Cover Plug/Male + Chain

Part No.
BNC-1001

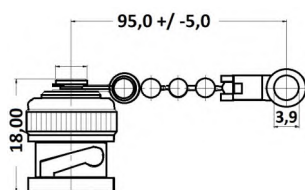

### Cover Plug/Male + Chain

Part No.
BNC-1002

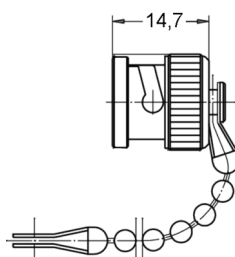

### Straight Crimp Plug/Male

Part No.	Applicable Cable RG/U
BNC-1101-DGN	58, 58A, 141A
BNC-1102-DGN	59, 62A, 210
BNC-1103-TGN	174, 188A, 36 izol. Teflon
BNC-1104-DGN	174, 188A, 36
BNC-1115-TGN	LMR240
BNC-1118-TGN	Belden 8281

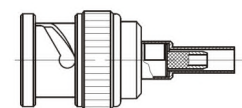

### R/A Crimp Plug/Male

Part No.	Applicable Cable RG/U
BNC-1112-TGN	58, 58A, 141A
BNC-1113-DGN	59, 62A, 210
BNC-1114-DGN	174, 188A, 316
BNC-1117-TGN	LMR240
BNC-1125-TGN	LMR400

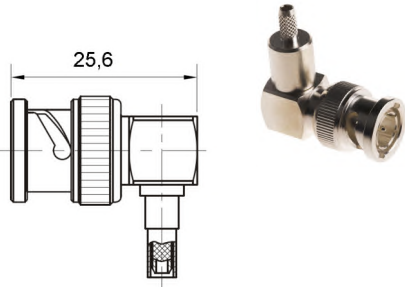

### Straight Crimp Plug/Male

Part No.	Applicable Cable RG/U
BNC-1121-TGN	RG142U

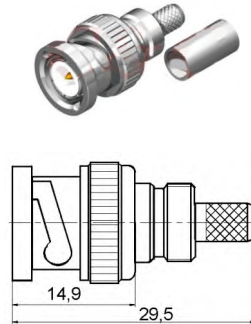

### Straight Bulkhead Crimp Jack/Fem.

Part No.	Applicable Cable RG/U
BNC-1205-TGN	174, 188A, 316

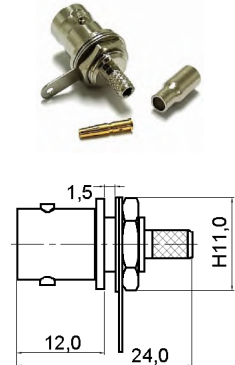

### Straight Bulkhead Crimp Jack/Fem.

Part No.	Applicable Cable RG/U
BNC-1206-DGN	58, 58A, 141A
BNC-1207-DGN	59, 62A, 210
BNC-1208-TGN	174, 188A, 316

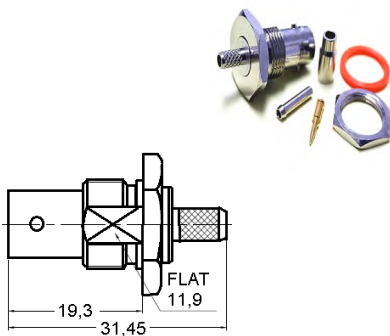

### Straight Crimp Jack/Female

Part No.	Applicable Cable RG/U
BNC-1209-DGN	58, 58A, 141A
BNC-1210-DGN	59, 62A, 210
BNC-1211-TGN	174, 188A, 316
BNC-1216-TGN	RG 213U
BNC-1220-DGN	LMR400

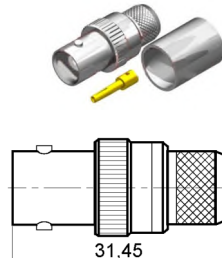

### Square Flange Crimp Jack/Female

Part No.	Applicable Cable RG/U
BNC-1222-TGN	142U, 223U
BNC-1223-TGN	316U

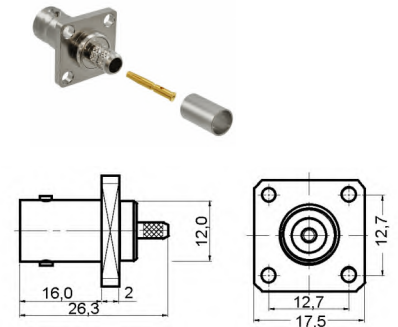

### Straight Clamp Plug/Male

Part No.	Applicable Cable RG/U
BNC-2101-DGN	58, 58A, 141A
BNC-2102-DGN	59, 62A, 210
BNC-2104-DGN	174U, 188, 136
BNC-2106-DGN	214U

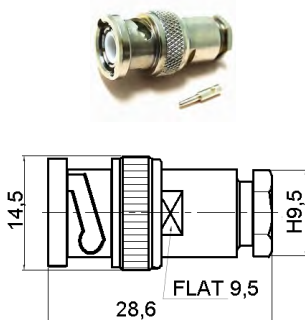

### Straight Clamp Jack/Female

Part No.	Applicable Cable RG/U
BNC-2205-DGN	58, 58A, 141A

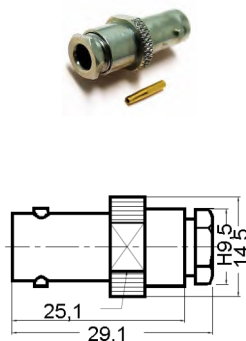

### Square Flange Plug/Male

Part No.
BNC-3102-TGN

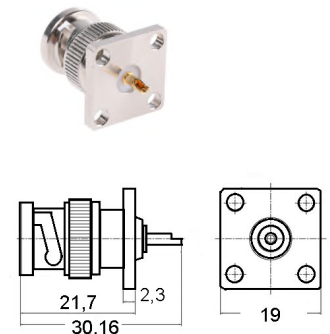

Square Flange Jack/Female

Part No.  
BNC-3201-TGN

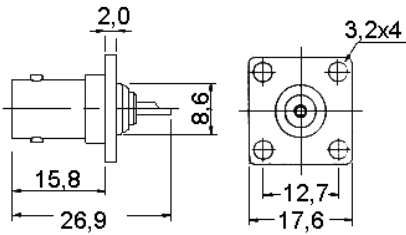

R/A Square Flange Jack/Female

Part No.  
BNC-3211-TGN

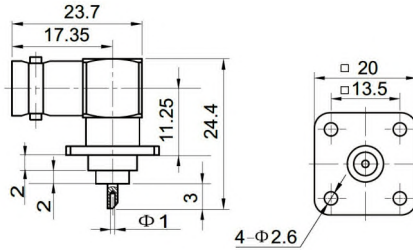

Straight Bulkhead Plug/Male

Part No.  
BNC-4102-TGN

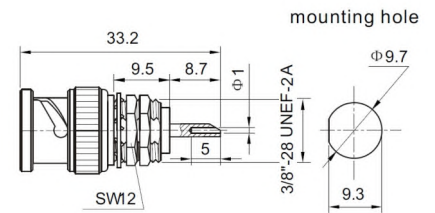

Straight Bulkhead Jack/Female

Part No.  
BNC-4201-DGN

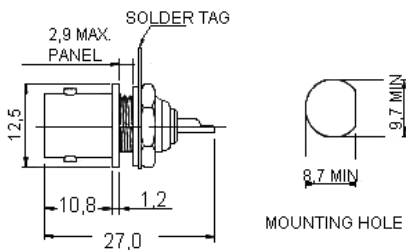

Straight Bulkhead Jack/Female

Part No.  
BNC-4203-TGN

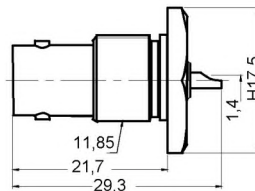

R/A PCB Jack/Female

Part No.  
BNC-5101-TGN

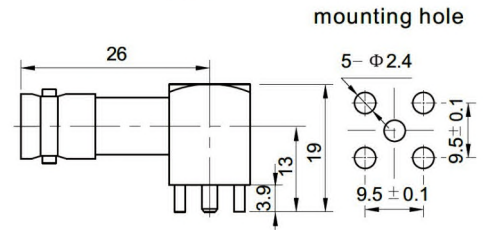
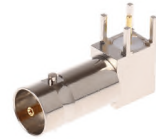

Straight PCB Jack/Female

Part No.  
BNC-5201-TGN

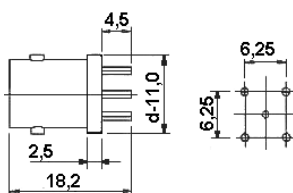

Straight PCB Jack/Female

Part No.  
BNC-5202-DGN

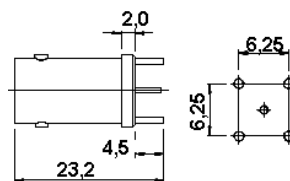

Straight PCB Jack/Female

Part No.  
BNC-5203-TGN

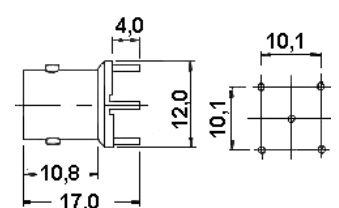

**Straight PCB Jack/Female**

<b>Part No.</b>
BNC-5204-TGN

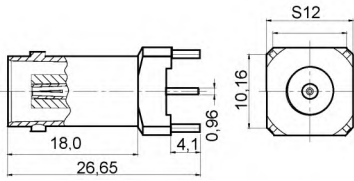

**Straight PCB Jack/Female**

<b>Part No.</b>
BNC-5206-TGN

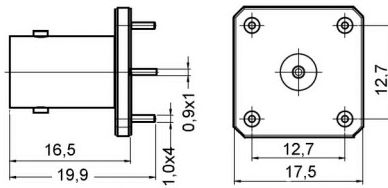

**Straight PCB Threaded Jack/Female**

<b>Part No.</b>
BNC-5207-TGN

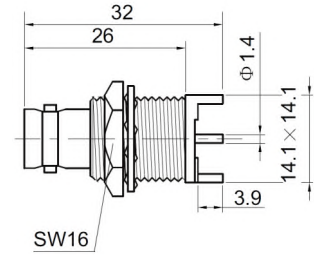

**Bulkhead Jack/Fem. - Jack/Fem.**

<b>Part No.</b>
BNC-601-DGN

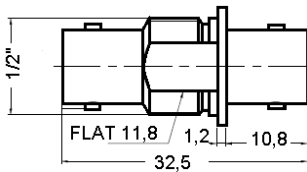

**Plug/Male - Plug/Male**

<b>Part No.</b>
BNC-603-DGN

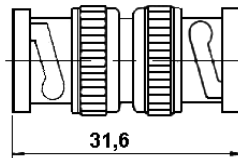

**R/A Plug/Male - Jack/Female**

<b>Part No.</b>
BNC-605-DGN

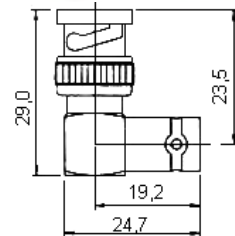

**Plug/Male to T Type Jack/Female**

<b>Part No.</b>
BNC-606-TGN

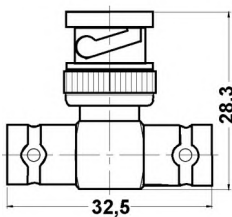

**Straight Crimp Plug/Male**

<b>Part No.</b>	<b>Applicable Cable RG/U</b>
BNC-7101-TGN	RG402U

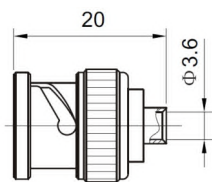

**R/A Crimp Plug/Male**

<b>Part No.</b>	<b>Applicable Cable RG/U</b>
BNC-7102-TGN	RG405

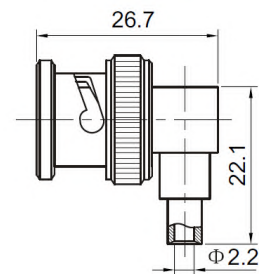
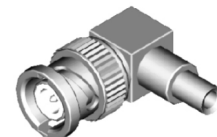



## SPECIFICATION - TNC

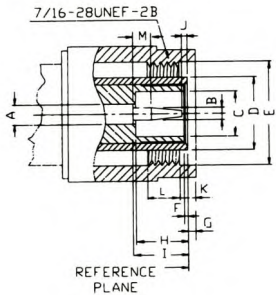

PLUG		
Letter	Millimeters(Inches)	
	Minimum	Maximum
A	2.06 (.081)	2.21 (.087)
B	1.30 (.052)	1.37 (.054)
C	4.83 (.190)	-
D	-	8.08 (.318)
E	11.18 (.440)	-
F	0.15 (.006)	-
G	-	1.98 (.078)
H	5.28 (.208)	5.79 (.228)
I	5.33 (.210)	5.84 (.230)
J	0.08 (.003)	1.02 (.040)
K	1.60 (0.63)	-
L	3.96 (.156)	-
M	1.98 (.078)	-

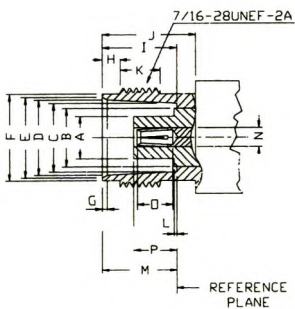

JACK		
Letter	Millimeters(Inches)	
	Minimum	Maximum
A	-	4.72 (.186)
B	-	6.50 (.256)
C	8.10 (.319)	8.15 (.321)
D	8.31 (.327)	8.46 (.333)
E	8.79 (.346)	9.04 (.356)
F	9.60 (.378)	9.68 (.381)
G	0.38 (.015)	0.77 (.030)
H	1.73 (.068)	2.24 (.088)
I	8.31 (.327)	8.51 (.335)
J	10.52 (.414)	-
K	4.75 (.187)	-
L	-	0.15 (.006)
M	4.78 (.188)	5.28 (.208)
N	2.06 (.081)	2.21 (.087)
O	4.95 (.195)	-
P	4.72 (.186)	5.23 (.206)

Electrical:	
Impedance	50 Ohm      75 Ohm
Frequency Range	0 to 11.0 Ghz      0 to 1.0 Ghz
VSWR	1.3 max
Voltage Rating	500 V rms max
	* RG - 58, 141, 142, 223 - 500 V rms max * RG - 174, 188, 316 - 335 V rms max
Dielectric Withstanding Voltage	1.500 V rms max
	* RG - 58, 141, 142, 223 - 1.000 V rms max * RG - 174, 188, 316 - 750 V rms max
Contact Resistance	center contact = 1.5 Milliohms max
	outer contact = 0.2 Milliohms max
RF Leakage	(-)55 dB min @3 Ghz
Insertion Loss	0.2 dB max @ 3 Ghz
Insulation Resistance	5.000 Megohms min

Mechanical & Environmental:	
Mating	7/16" - 28 threaded coupling
Durability	500 matings
	RG - 58, 141, 142, 223 - 40 lbs min
Cable Retention	RG - 59, 62A, 210 - 40 lbs min
	RG - 174, 188, 316 - 20 lbs min
Coupling Nut Retention	100 lbs min
Temperature Range	(-)65 °C to 165 °C
Vibration	MIL-STD-202 Method 204 Test Cond. B.
Salt Spray	MIL-STD-202 Method 101 Test Cond. B.

Material:		
	Material	Plating
Connector Body	Brass	Nickel or Gold
Center Contact	Male: Brass	Gold
	Female: Brass or Phosphor Bronze, Beryllium Copper	
Insulation	Teflon or Delrin	None
Gasket	Silicone Rubber, Rubber	None
Crimp Ferrule	Annealed Copper	Same as Body

### Straight Crimp Plug/Male

Part No.	Applicable Cable RG/U
TNC-1101-DGN	58, 58A, 141A
TNC-1102-DGN	59, 62A, 210
TNC-1114-TGN	LMR240
TNC-1116-TGN	LMR300
TNC-1135-TGN	178U



### Straight Crimp Plug/Male

Part No.	Applicable Cable RG/U
TNC-1103-TGN	174, 188A, 316
TNC-1104-TGN	179B, 187A (75 Ohms)

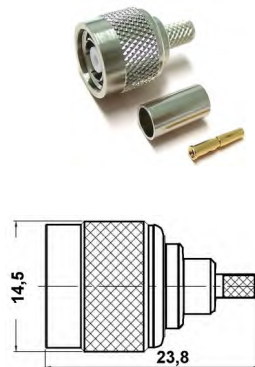

### Straight Plug/Male

Part No.	Applicable Cable RG/U
TNC-1113-TGN	213
TNC-1120-TGN	LMR400

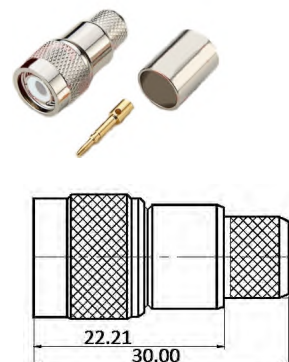

### R/A Crimp Plug/Male

Part No.	Applicable Cable RG/U
TNC-1118-TGN	RG58U, RG141U
TNC-1122-TGN	LMR241
TNC-1133-TGN	LMR400

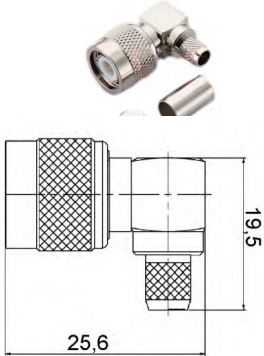

### Straight Crimp Plug/Male

Part No.	Applicable Cable RG/U
TNC-1119-TGN	LMR500

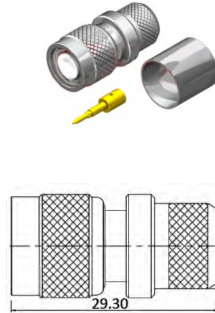

### Straight Bulkhead Crimp Jack/Fem.

Part No.	Applicable Cable RG/U
TNC-1205-DGN	58, 58A, 141A
TNC-1206-DGN	59, 62A, 210
TNC-1207-TGN	174, 188A, 316
TNC-1208-TGN	179B, 187A (75 Ohm)



### Straight Crimp Jack/Female

Part No.	Applicable Cable RG/U
TNC-1211-TGN	174, 188A, 316
TNC-1212-TGN	179B, 187A (75 Ohm)

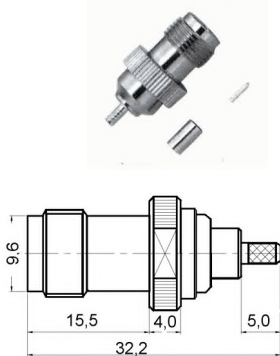

### Straight Bulkhead Crimp Jack/Fem.

Part No.	Applicable Cable RG/U
TNC-1221-TGN	LMR400
TNC-1225-TGN	LMR240

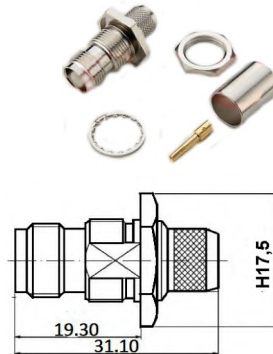

### Straight Crimp Jack/Female

Part No.	Applicable Cable RG/U
TNC-1224-TGN	LMR240
TNC-1226-TGN	LMR400

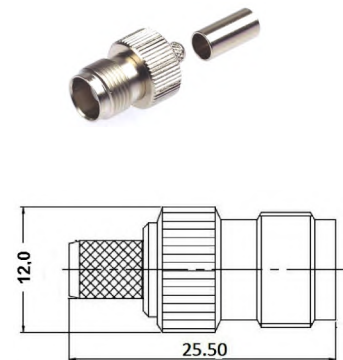

### Straight Clamp Plug/Male

Part No.	Applicable Cable RG/U
TNC-2101-DGN	58, 58A, 141A
TNC-2102-DGN	59, 62A, 210



### Straight Clamp Plug/Male

Part No.	Applicable Cable RG/U
TNC-2103-TGN	58U, 55U, 223U
TNC-2104-TGN	174, 188, 316U
TNC-2106-TGN	RG213U
TNC-2107-TGN	LMR240

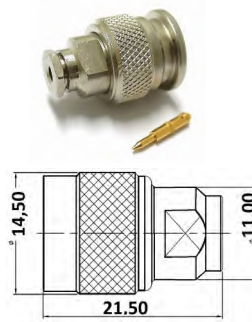

### Straight Clamp Jack/Female

Part No.	Applicable Cable RG/U
TNC-2205-DGN	58, 58A, 141A
TNC-2206-DGN	59, 62A, 210

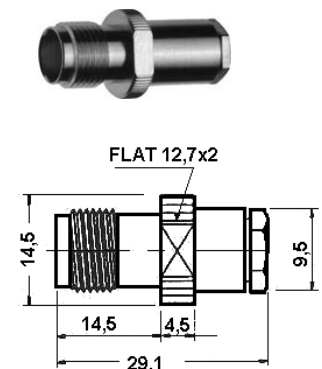

Square Flange Plug/Male

Part No.  
TNC-3103-DGN

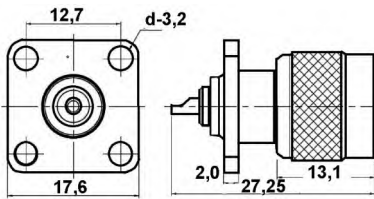

Square Flange Jack/Fem.

Part No.  
TNC-3201-DGN

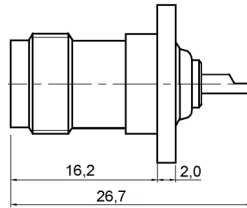

Square Flange Jack/Fem.

Part No.  
TNC-3203-TGN

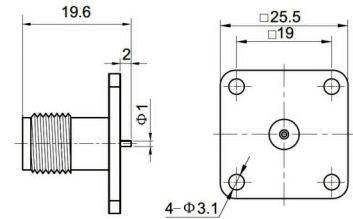

Straight Bulkhead Plug/Male

Part No.  
TNC-4106-TGN

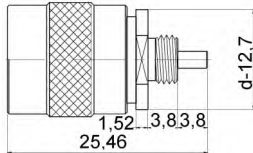

Straight Bulkhead Jack/Fem.

Part No.  
TNC-4201-DGN

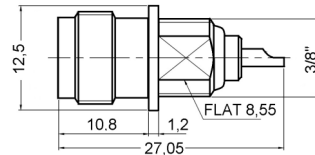

Straight Bulkhead Jack/Fem.

Part No.  
TNC-4205-TGN

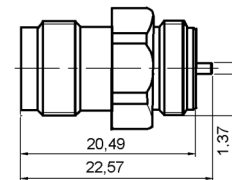

R/A PCB Jack/Female

Part No.  
TNC-5201-TGN

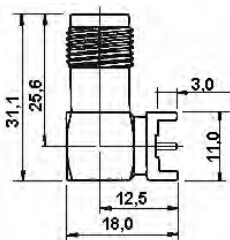

R/A PCB Threaded Jack/Female

Part No.  
TNC-5202-TGN

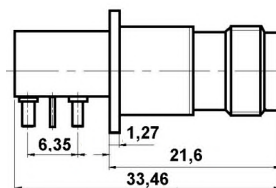

R/A PCB Threaded Jack/Female

Part No.  
TNC-5205-TGN

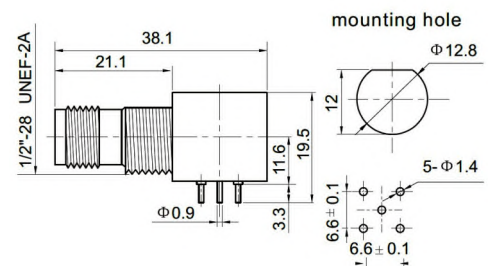
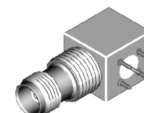



Jack/Female - Jack/Female

Part No.
TNC-601-DGN

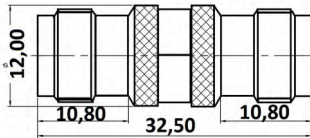

Bulkhead Jack/Fem. - Jack/Fem.

Part No.
TNC-602-DGN

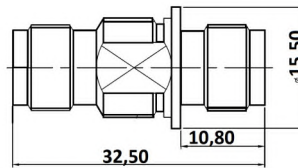

Straight Crimp Plug/Male

Part No.	Applicable Cable RG/U
TNC-7101-TGG	RG 402/u (0.141")
TNC-7102-TGG	RG 405/u (0.085")

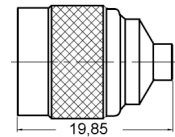

Straight Crimp Jack/Female

Part No.	Applicable Cable RG/U
TNC-7203-TGG	RG 402/u (0.141")
TNC-7204-TGG	RG 405/u (0.085")

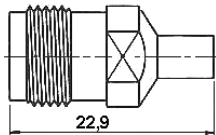

Bulkhead Jack/Female

Part No.	Applicable Cable RG/U
TNC-7206-TGG	RG402/u (0.141")
TNC-7207-TGG	RG405/u (0.085")

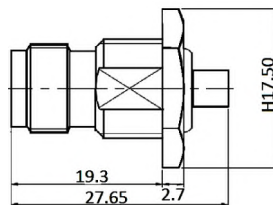

BMA R/A Bulkhead Plug/Male

Part No.
BMA-1104-TGG

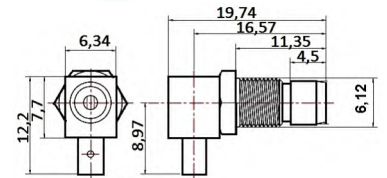

Bulkhead Solder Plug/Male

Part No.
BMA-4101-TGG

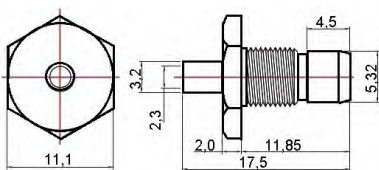

2 Hole Flange Jack/Female

Part No.
BMA-4201-TGG

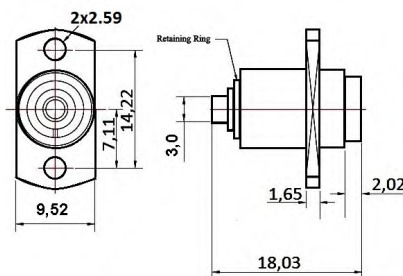

Square Flange Plug/Male

Part No.
BMA-4203-TGG

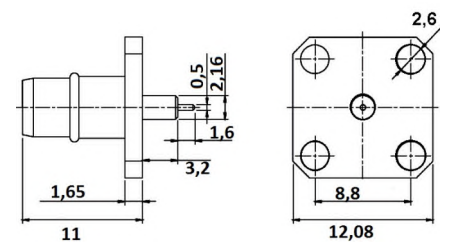



### Straight Crimp Plug/Male

Part No.	Applicable Cable RG/U
MHV-1101-TGN	59, 62A, 210
MHV-1102-TGN	RG58U

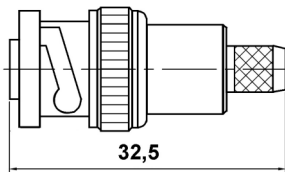

### Straight Clamp Plug/Male

Part No.	Applicable Cable RG/U
MHV-2102-TGN	59, 62A, 210

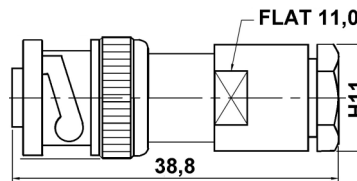

### Straight Clamp Plug/Male

Part No.	Applicable Cable RG/U
MHV-2103-TGN	8A, 213

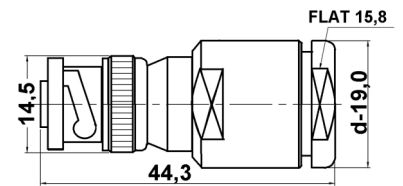

### R/A Plug/Male

Part No.	Applicable Cable RG/U
MHV-2105-TGN	RG58U

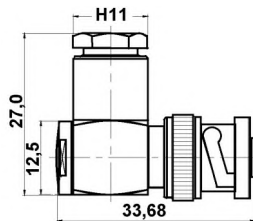

### Straight Clamp Jack/Female

Part No.	Applicable Cable RG/U
MHV-2201-TGN	59, 62A, 210

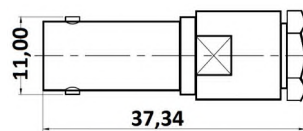

### Square Flange Jack/Female

Part No.
MHV-3201-TGN

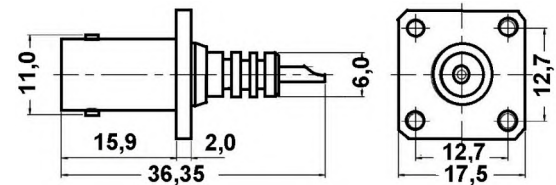

### Straight Bulkhead Jack/Fem.

Part No.
MHV-4201-TGN

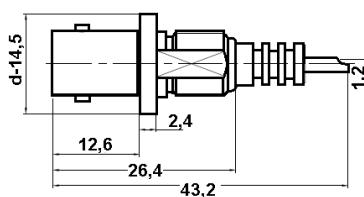

### Straight Bulkhead Jack/Female

Part No.
MHV-4203-TGN

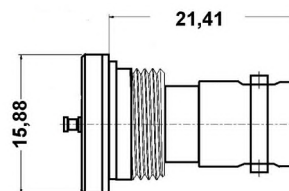

### Jack/Female - Jack/Female

Part No.
MHV-601-TGN

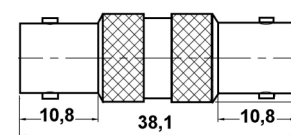

### Straight Clamp Plug/Male

Part No.	Applicable Cable RG/U
716-1101-TSS	213/U
716-1102-TSS	214/U
716-1103-TSS	Belden 9913, LMR400
716-1105-TSS	LMR-500
716-1106-TSS	LMR-600

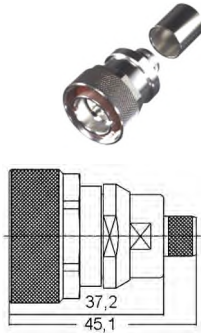

### Straight Crimp Jack/Female

Part No.	Applicable Cable RG/U
716-1201-TSS	213/U
716-1202-TSS	214/U
716-1203-TSS	Belden 9913, LMR400
716-1206-TSS	LMR-600

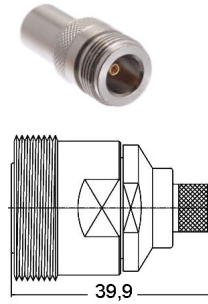

### Straight Crimp Plug/Male

Part No.	Applicable Cable RG/U
716-2101-TSS	213/U
716-2102-TSS	214/U
716-2103-TSS	Belden 9913, LMR400
716-2106-TSS	LMR-600

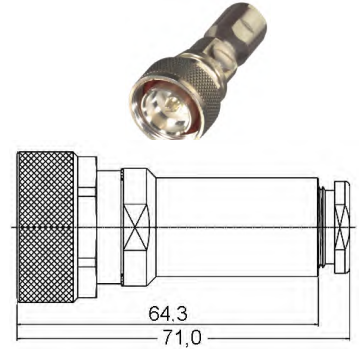

### R/A Clamp Plug/Male

Part No.	Applicable Cable RG/U
716-2121-TSS	213/U
716-2122-TSS	214/U
716-2123-TSS	Belden 9913, LMR400

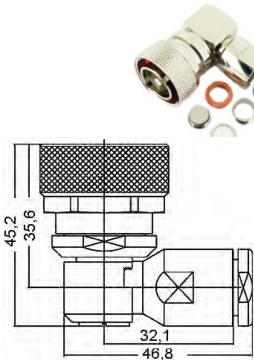

### Square Flange Plug/Male

Part No.
716-3101-TSS

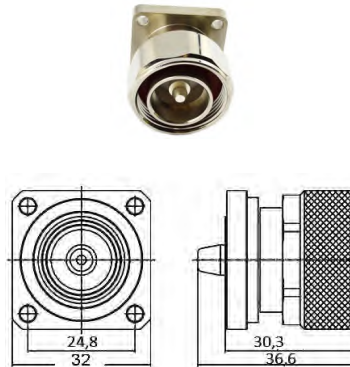

### Square Flange Jack/Female

Part No.
716-3202-TSS

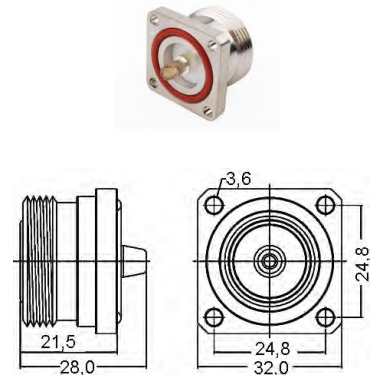

### Bulkhead Jack/Female

Part No.
716-4201-TSS

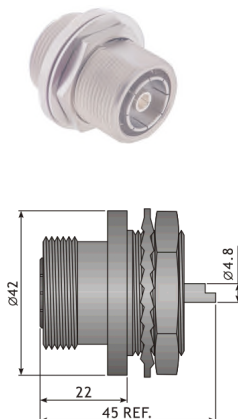

### Adaptor Jack/Fem. to Jack/Fem.

Part No.
716-603-TSS

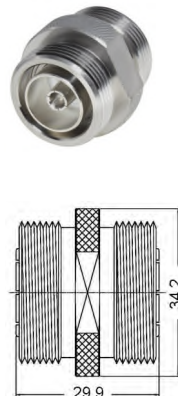

### Adaptor Plug/Male to Plug/Male

Part No.
716-604-TSS

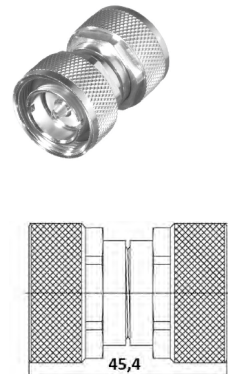

## R/A Crimp Plug

Part No.	Applicable Cable RG/U
RP-SMA-1101-TGG	58, 58A, 141A
RP-SMA-1102-TGG	174, 188A, 316
RP-SMA-1103-TGG	142B/U

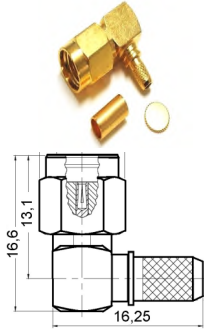

## Straight Crimp Plug

Part No.	Applicable Cable RG/U
RP-SMA-1104-TGG	58, 58A, 141A
RP-SMA-1105-TGG	174, 188A, 316
RP-SMA-1106-TGG	142B/U
RP-SMA-1113-TGG	LMR400
RP-SMA-1117-TGG	LMR240
RP-SMA-1118-TGG	Belden 9913
RP-SMA-1120-TGG	LMR240
RP-SMA-1122-TGG	LMR400

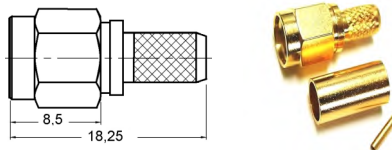

## Straight Bulkhead Crimp

Part No.	Applicable Cable RG/U
RP-SMA-1207-TGG	58, 58A, 141A
RP-SMA-1208-TGG	174, 188A, 316
RP-SMA-1209-TGG	142B/U
RP-SMA-1221-TGG	LMR240
RP-SMA-1222-TGG	LMR400

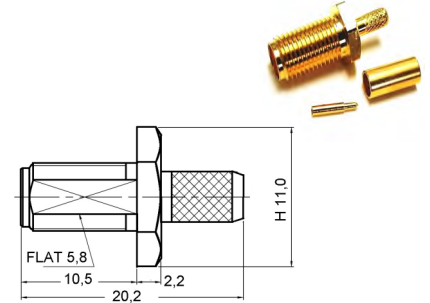

## Straight Bulkhead Jack

Part No.
RP-SMA-4201-TGG

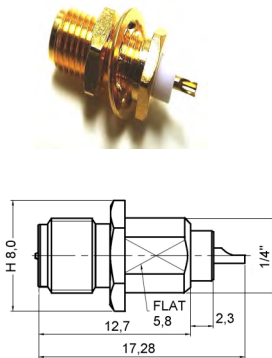

## R/A PCB Jack

Part No.
RP-SMA-5201-TGG

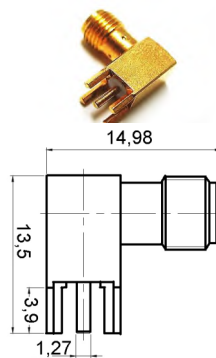

## Straight Plug

Part No.	Applicable Cable RG/U
RP-SMA-7101-TGG	RG 402/u (0.141")
RP-SMA-7102-TGG	RG 405/u (0.085")

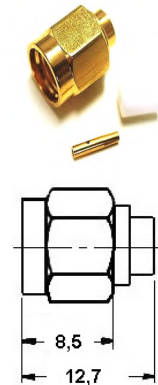

## Straight Bulkhead Jack

Part No.	Applicable Cable RG/U
RP-SMA-7103-TGG	RG 402/u (0.141")
RP-SMA-7104-TGG	RG 405/u (0.085")

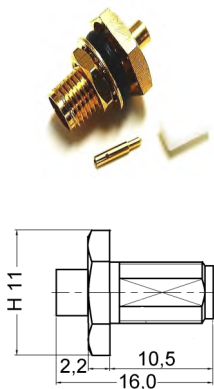

## Straight Crimp Plug

Part No.	Applicable Cable RG/U
RP-TNC-1101-TGN	58, 58A, 141A
RP-TNC-1102-TGN	142B/U
RP-TNC-1116-TGN	LMR200

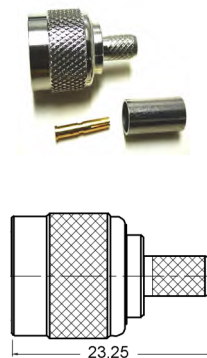

## Straight Bulkhead Jack

Part No.	Applicable Cable RG/U
RP-TNC-1203-TGN	58, 58A, 141A
RP-TNC-1204-TGN	142B/U

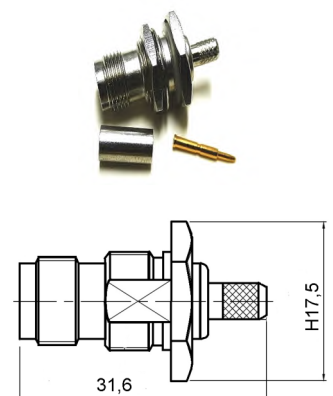

**SMA Plug - N Plug**

<b>Part No.</b>
SMAp-Np-601-TGN



**SMA Plug - N Jack**

<b>Part No.</b>
SMAp-Nj-602-TGN



**SMA Jack - N Plug**

<b>Part No.</b>
SMAj-Np-603-TGN



**SMA Jack - N Jack**

<b>Part No.</b>
SMAj-Nj-604-TGN



**SMA Jack - N Panel Jack**

<b>Part No.</b>
SMAj-Njp-605-TGN



**SMA Jack - N Jack**

<b>Part No.</b>
SMAj-Nj-605b-TGN



**SMA Jack - N Bulkhead Jack**

<b>Part No.</b>
SMAj-Njb-606-TGN



**SMA Plug - BNC Jack**

<b>Part No.</b>
SMAp-BNCj-607-TGN



**SMA Jack - BNC Jack**

<b>Part No.</b>
SMAj-BNCj-608-TGN



**SMA Plug - TNC Plug**

<b>Part No.</b>
SMAp-TNCp-609-TGN



**SMA Plug - TNC Jack**

<b>Part No.</b>
SMAp-TNCj-610-TGN



**SMA Jack - TNC Plug**

<b>Part No.</b>
SMAj-TNCp-611-TGN



**SMA Jack - TNC Jack**

<b>Part No.</b>
SMAj-TNCj-612-TGN



**N Plug - BNC Jack**

<b>Part No.</b>
Np-BNCj-613-DGN



**N Jack - BNC Plug**

<b>Part No.</b>
Nj-BNCp-614-DGN



**N Plug - F Jack**

<b>Part No.</b>
Np-Fj-615-TGN



**N Jack - F Plug**

<b>Part No.</b>
Nj-Fp-616-TGN



**BNC Plug - UHF Jack**

<b>Part No.</b>
BNCp-UHFj-617-DNN



**BNC Jack - UHF Plug**

<b>Part No.</b>
BNCj-UHFp-618-DNN



**Mini UHF Jack - SMA Plug**

<b>Part No.</b>
Mini UHFj-SMAp-623-TGN





Mini UHF Jack - SMA Plug

<b>Part No.</b>
Mini UHFj-SMAp-624-TGN



N Jack - SMA RP Plug

<b>Part No.</b>
Nj-SMApREV-625-TGN



TNC RP Plug - N Plug

<b>Part No.</b>
TNCpREV-Np-626-TGN



TNC RP Plug - N Jack

<b>Part No.</b>
TNCpREV-Nj-627-TGN



SMB Plug - BNC Jack

<b>Part No.</b>
SM Bp-BNCj-629-TGN



SMB Plug - N Jack

<b>Part No.</b>
SM Bp-Nj-630-TGN



SMA Jack - SMB Plug

<b>Part No.</b>
SMAj-SMBp-631-TGN



UHF Plug - N Plug

<b>Part No.</b>
UHFp-Np-632-TGN



SMA Plug RP - TNC Jack

<b>Part No.</b>
SMApREV-TNCj-633-TGN



BNC Plug - SMB Jack

<b>Part No.</b>
BNCp-SMBj-635-TGN



SSMA Jack - SMA Plug

<b>Part No.</b>
SSMAj-SMAp-636-TGN



TNC Plug RP - TNC Jack

<b>Part No.</b>
TNCpREV-TNCj-637-TGN



SMA Jack - SMA RP Plug

<b>Part No.</b>
SMAj-SMApREV-638-TGN



SMA RP Jack - SMA Plug

<b>Part No.</b>
SMAjREV-SMAp-639-TGN



TNC Plug - BNC Jack

<b>Part No.</b>
TNCp-BNCj-640-TGN



TNC Jack - BNC Jack

<b>Part No.</b>
TNCj-BNCj-641-TGN



SMA RP Plug - TNC RP Jack

<b>Part No.</b>
SMApREV-TNCjREV-642-TGN



SMA Jack - SMC Jack

<b>Part No.</b>
SM Aj-SM Cj-643-TGN



SMA Jack - UHF Jack

<b>Part No.</b>
SM Aj-U HFj-644-TGN



BNC Jack - F Plug

<b>Part No.</b>
BNCj-Fp-645-TGN



**TNC RP Jack - TNC Plug**

**Part No.**  
TNCjREV-TNCp-648-TGN



**SMA Jack - F Plug**

**Part No.**  
SMAj-Fp-649-TGN



**N Jack - F Jack**

**Part No.**  
Nj-Fj-651-TGN



**N Plug - TNC Jack**

**Part No.**  
Np-TNCj-652-TGN



**UHF Plug - BNC Jack**

**Part No.**  
UHFp-BNCj-653-TGN



**N Jack - TNC Jack**

**Part No.**  
Nj-TNCj-654-TGN



**SMA Plug - SMB Jack**

**Part No.**  
SMAp-SMBj-655-TGG



**SMA RP Jack - MCX Plug**

**Part No.**  
SMAjREV-MCXp-656-TGG



**SMA RP Jack - N Plug**

**Part No.**  
SMAjREV-Np-657-TGN



**SMA RP Jack - N RP Plug**

**Part No.**  
SMAjREV-NpREV-658-TGN



**N Plug - TNC RP Jack**

**Part No.**  
Np-TNCjREV-660-TGN



**BNC Jack - F Jack**

**Part No.**  
BNCj-Fj-661-TGN



**SMA Plug - SMB Plug**

**Part No.**  
SMAp-SMBp-662-TGG



**N Jack - TNC RP Jack**

**Part No.**  
Nj-TNCjREV-663-TGN



**TNC Jack - QMA Jack**

**Part No.**  
TNCj-QMAj-665-TGN



**QMA Jack N/TNC Plug**

**Part No.**  
QMAj-Np-666-TGN  
QMAj-TNCp-667-TGN



**QMA Jack - SMA Plug**

**Part No.**  
QMAj-SMAp-668-TGN



**UHF Plug - N Jack**

**Part No.**  
UHFp-Nj-669-TGN



**TNC Bulkhead Jack -  
MMCX Hermetic**

**Part No.**  
TNCjBUL-MMCX-674-TGN-Hermetic



**TNC RP Plug -  
TNC R/A Jack**

**Part No.**  
TNCpREV-TNCj-675-RA-TGN



**SMA Plug - MMCX Plug**

<b>Part No.</b>
SMAp-MMCXp-677-TGG



**SMA Jack - MMCX Jack**

<b>Part No.</b>
SMAj-MMCXj-678-TGG



**SMB Plug - MMCX Plug**

<b>Part No.</b>
SMBp-MMCXp-679-TGN



**SMB Jack - MMCX Jack**

<b>Part No.</b>
SMBj-MMCXj-680-TGG



**FME Plug - MCX Plug**

<b>Part No.</b>
FMEp-MCXp-681-TGN
FMEp-MMCXp-682-TGN
FMEp-SMBj-683-TGN



**QMA Plug - SMA Jack**

<b>Part No.</b>
QMAp-SMAj-688-TGN



**TNC Jack - MCX Jack**

<b>Part No.</b>
TNCj-MCXj-689-TGN



**SMA Jack - IPEX**

<b>Part No.</b>
SMAj-IPEX-693-TGG



**QMA Jack - SMA Jack**

<b>Part No.</b>
QMAj-SMAj-694-TGN



**QMA Jack - N Jack**

<b>Part No.</b>
QMAj-Nj-695-TGN



**N Plug - QMA Plug**

<b>Part No.</b>
Np-QMAp-696-TGN

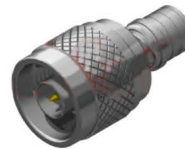

**QMA Plug - SMA Plug**

<b>Part No.</b>
QMAp-SMAp-697-TGN



**QMA Plug - N Jack**

<b>Part No.</b>
QMAp-Nj-698-TGN



**N Plug - TNC Plug**

<b>Part No.</b>
Np-TNCp-702-TGN



**BNC Plug - SMA Jack**

<b>Part No.</b>
BNCp-SMAj-703-TGN



**SMA RP Jack - N Jack**

<b>Part No.</b>
SMAjREV-Nj-704-TGN



**MMCX Jack - SMA Plug**

<b>Part No.</b>
MMCXj-SMAp-705-TGG



**QN Plug - N Jack**

<b>Part No.</b>
QNp-Nj-706-TGN



**QN Plug - N Plug**

<b>Part No.</b>
QNp-Np-707-TGN



**QN Plug - SMA Jack**

<b>Part No.</b>
QNp-SMAj-708-TGN





QN Plug - TNC Jack

**Part No.**  
QNP-TNCj-709-TGN



QN Jack - N Jack

**Part No.**  
QNj-Nj-714-TGN



TNC Jack - SMC Plug

**Part No.**  
TNCj-SMCp-716-TGN



SMB Plug - FME Plug

**Part No.**  
SMBp-FMEp-717-TGN



BNC Plug - TNC Jack

**Part No.**  
BNCp-TNCj-719-TGN



FME Jack - N Jack

**Part No.**  
FMEj-Nj-720-TGN



SMA Jack - FME Jack

**Part No.**  
SMAj-FMEj-721-TGN



TNC RP Plug - SMA Jack

**Part No.**  
TNCpREV-SMAj-724-TGN



MCX Plug - SMA Plug

**Part No.**  
MCXp-SMAp-725-TGG



SMA Jack - SMC Plug

**Part No.**  
SMAj-SMCp-727-TGG



BNC Plug - FME Jack

**Part No.**  
BNCp-FMEj-729-TGN



N Plug - FME Jack

**Part No.**  
Np-FMEj-730-TGN



TNC Jack - MCX Jack

**Part No.**  
TNCj-MCXj-731-TGN



SMA Jack - TNC RP Jack

**Part No.**  
SMAj-TNCjREV-733-TGN



SMA Jack - SMB Plug

**Part No.**  
SMAj-SMBp-741-TGN



N Jack - SMA Plug

**Part No.**  
Nj-SMAp-743-TGN



N Jack - SMA Jack

**Part No.**  
Nj-SMAj-745-TGN



TNC Jack - BNC Jack

**Part No.**  
TNCj-BNCj-747-TGN



N Jack - BNC Jack

**Part No.**  
Nj-BNCj-748-TGN



MMCX Plug - SMA Jack

**Part No.**  
MMCXp-SMAj-749-TGN





## SMA (Bare End)

Description: Cable 001 RF  
SMA Jack (Panel Mount Type w/ 4-Hole Flange) + RG-402 (Semi-Rigid) Cable (Bare End)



## SMA to SMA

Description: Cable 002 RF  
SMA Plug + RG-047 (Semi-Rigid) Cable + SMA Jack



## SMA to SMA

Description: Cable 003 RF  
SMA Plug + RG-402 (Semi-Rigid) Cable + SMA Plug



## SMA to SMA

Description: Cable 004 RF  
SMA Plug + RG-47 (Semi-Rigid) Cable + SMA Plug



## SMA to SMA

Description: Cable 005 RF  
SMA Plug + RG-405 (Semi-Rigid) Cable + SMA Plug



## MMCX to SMA

Description: Cable 010 RF  
MMCX Plug + RG-405 (Semi-Rigid) Cable + SMA Plug



## N to SMA

Description: Cable 011 RF  
N Bulkhead Jack + RG-402 (Semi-Flexible) Cable + SMA R/A Plug



## N to SMA

Description: Cable 012 RF  
N Jack (Panel Mount Type w/ 4 Hole Flange) + RG-402 (Semi-Flexible) Cable + SMA Plug



## SMA to SMA

Description: Cable 021 RF  
SMA Plug + SS-402 Cable + SMA Plug



## SMA to SMA

Description: Cable 022 RF  
SMA R/A Plug + RG-402 Cable (Semi-Flexible) + SMA R/A Plug



## SMA to SMA

Description: Cable 023 RF  
SMA Plug + RG-402 (Semi-Flexible) Cable + SMA Plug



## SMA to SMA

Description: Cable 024 RF  
SMA Plug + RG-402 (Semi-Flexible) Cable + SMA R/A Plug



## SMA to SMP

Description: Cable 025 RF  
SMA R/A Plug + RG-405 (Semi-Flexible) Cable + SMP R/A Jack



## N to N

Description: Cable 030 RF  
N Plug + SS-75086 Cable + N Plug



## 1.0/2.3 to BNC

Description: Cable 031 RF  
1.0/2.3 Crimp Plug + Belden 1855A Cable + Real 75 Ohm BNC Crimp Plug



## BNC to Mini BNC

Description: Cable 032 RF  
1.0/2.3 Crimp Plug + Belden 1855A Cable + Real 75 Ohm BNC Crimp Plug



## BNC to MMCX

Description: Cable 033 RF  
BNC Bulkhead Crimp Jack (Front Mount Type) + RG-178 Cable + MMCX R/A Crimp Plug



## BNC to Oupiin

Description: Cable 034 RF  
BNC Bulkhead Crimp Jack + RG-179 Cable + Oupiin Connector



## FME (Ip68) to MMCX

Description: Cable 035 RF  
FME Crimp Jack (Ip68) + RG-316 Cable + MMCX R/A Crimp Plug



## MMCX to N

Description: Cable 036 RF  
MMCX R/A Crimp Plug + RG-178 Cable + N Bulkhead Crimp Jack



Pigtail UFL/R - Cable UFL/R    Pigtail UFL/R - SMA f panel    Pigtail UFL/R - N Male    Pigtail UFL/R - SMA RP Plug

Cable 101 RF



Cable 102 RF



Cable 103 RF



Cable 104 RF



JSC to MHF

MHF to MHF

MHF to Stripped or Tinned End

MHF to Stripped or Tinned End

Description: Cable 151 RF

Murata JSC Right Angle Plug to IPEX MHF R/A Plug



Description: Cable 152 RF

IPEX MHF IV R/A Plug to IPEX MHF R/A Plug



Description: Cable 153 RF

IPEX MHF Right Angle Plug to Stripped or Tinned end



Description: Cable 154 RF

IPEX MHF Right Angle Plug to Stripped or Tinned end



MHF to SMA

MHF to SMA

MHF to SMA

MHF to SMA

Description: Cable 155 RF

IPEX MHF R/A Plug to SMA Straight Jack Rear Mount



Description: Cable 156 RF

IPEX MHF R/A Plug to SMA R/A Jack Rear Mount



Description: Cable 157 RF

IPEX MHF R/A Plug to SMA R/A Plug With O-Ring



Description: Cable 158 RF

IPEX MHF R/A Plug to SMA Straight Jack PCB Mount



MHF to SMA

MHF to SMA

MHF to SMA

MHF to SMA

Description: Cable 159 RF

IPEX MHF R/A Plug to SMA Straight Jack Rear Mount Optional O-Ring



Description: Cable 160 RF

IPEX MHF R/A Plug to SMA Straight Jack Reverse Polarity Rear Mount With O-Ring IP67/IP68



Description: Cable 161 RF

IPEX MHF R/A Plug to SMA Straight Jack Reverse Polarity Front Mount With O-Ring IP67/IP68



Description: Cable 162 RF

IPEX MHF R/A Plug to SMA Straight Jack Reverse Polarity Front Mount



MHF to SMA

MHF to SMA

MHF to N

MHF to TNC

Description: Cable 163 RF

IPEX MHF R/A Plug to SMA Straight Plug Reverse Polarity



Description: Cable 164 RF

IPEX MHF R/A Plug to SMA Straight Jack Reverse Polarity Rear Mount



Description: Cable 165 RF

IPEX MHF R/A Plug to N Straight Jack Rear Mount With O-Ring



Description: Cable 166 RF

IPEX MHF R/A Plug to TNC Straight Jack Front Mount With O-Ring



TER-BMA-50JR, 0.5W, 0-18GHz

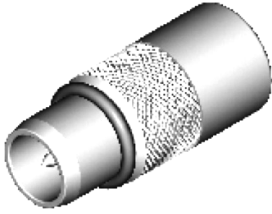

TER-BNC-50KR, 1W, 50 Ohm, 0-2GHz



TER-BNC-75JR, 1W, 75 Ohm, 0-1GHz

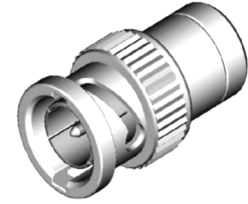

TER-J.STWX8-50KR, 2W, 0.5-17GHz



TER-N-50JR, 1W, 0-8GHz



TER-N-50JR-5W, 5W, 0-8GHz



TER-N-50JR-15W, 15W, 0-8GHz

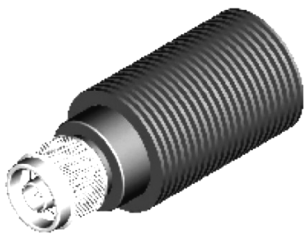

TER-SMA-50JR, 0.5W, 0-18GHz



TER-SMA-50JR-2W, 2W, 0-18GHz

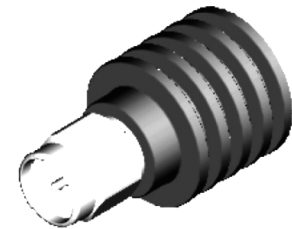

TER-SMA-50JR-5W, 5W, 0-18GHz



TER-SMA-50JR-15W, 15W, 0-8GHz



TER-SMA-KR, 0.5W, 0.5-1.7GHz



TER-TNC-50JR, 1W



TER-TNC-50JRG-5W, 5W, 0-8GHz

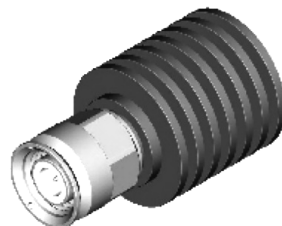

TER-TNC-50KR, 1W, 0-8GHz





SCHMID-MULTITECH, GmbH  
Weinbergstraße 60b, 93105 Tegenheim  
Tel.: +49-9403-9510-0  
info@schmid-m.de  
www.schmid-m.de



SCHMID-MULTITECH, GmbH  
Of Ziemendorf, Dorfstraße 49g  
49-39384-9848-0  
info@schmid-m.de  
www.schmid-m.de



ATD Elektronik, s.r.o.  
Lužnice 10, 344 01 Domažlice  
tel.: +420 379 723 915  
info@atd-elektronik.cz  
www.atd-elektronik.cz



ABC Elektronik Sp. z o.o.  
ul. Kolejowa 10, 38-300 Gorlice  
tel.: +48 18 353-66-65  
info@abcpol.pl  
www.abcpol.pl



SCHMID-MULTITECH, s.r.o.  
Podjavorinskej 5, 911 05 Trenčín  
tel.: +421-32-7 440 186  
mkovacik@smsk.sk  
www.schmid-multitech.sk



ANGIELA ELEKTRONIK SRL  
Str. Slanic Nr. 1 Ap3, 400413 Cluj-Napoca  
tel.: +40-264-403-284  
info@angiel-elektronik.ro  
www.angiel-elektronik.ro



ADMM Kft.  
Rumi u. 284, H-9700 Szombathely  
tel.: +36-94 510-522  
mail@admm.hu  
www.admm.hu

We are connecting  
the world...

**MMCX - 1 1 01 x - T G N**

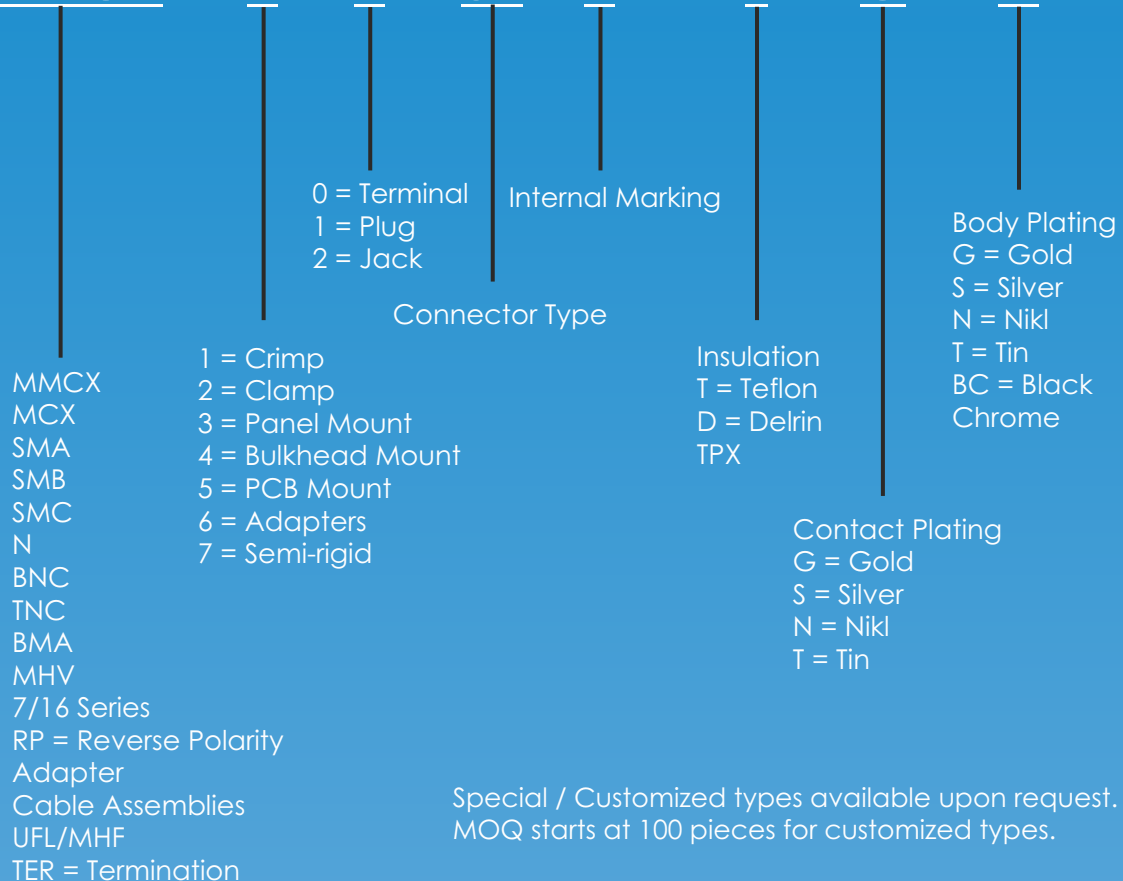

Special / Customized types available upon request.  
MOQ starts at 100 pieces for customized types.