

6: Extrusions

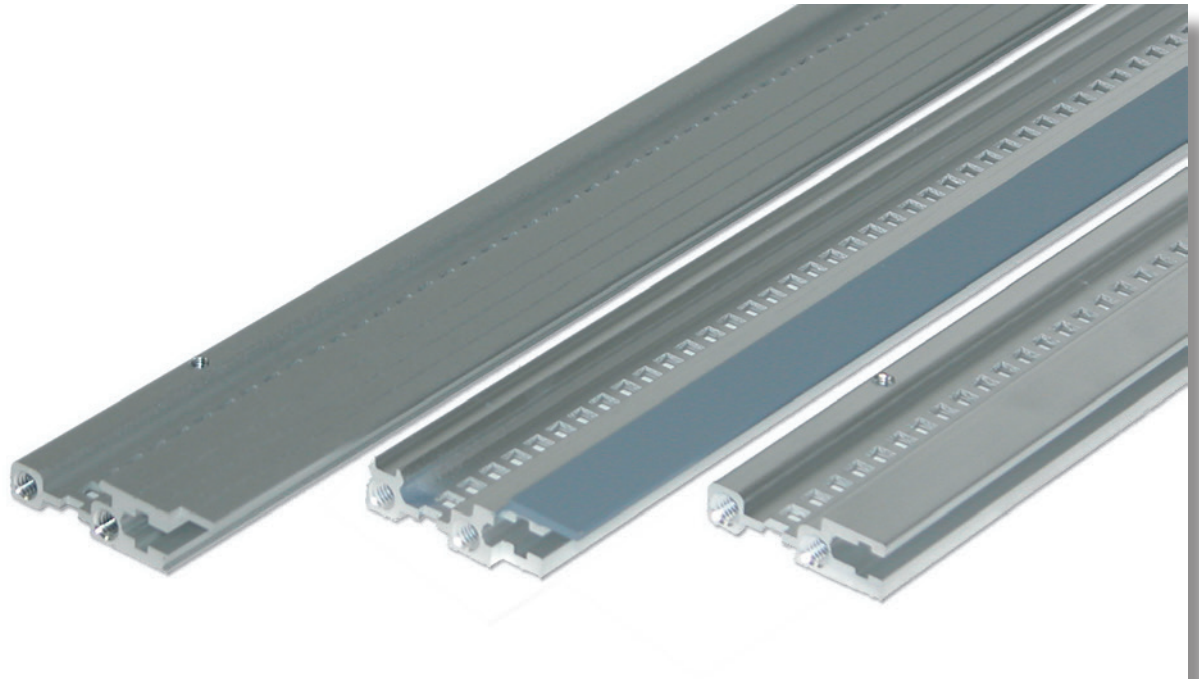

6.1 Front Extrusions

- Material: Aluminium unless otherwise specified

6.1.1 Front Extrusion 66-111, IEC

- For sub racks and cases front
- Accept 2 x 6 mm tapped strips
- **Scope of delivery:**
 - 1 front extrusion without assembly material

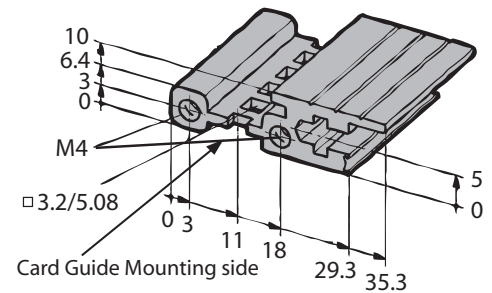

6.1.1.1 Standard Version

| Length for HP | Length | | Part-No. clear anodised | clear passivated | raw |
|---------------------|--------|-------|-------------------------------|---------------------|-----------|
| | mm | inch | | | |
| 21 | 111.8 | 4.40 | 66-111-26 | - | |
| 28 | 147.3 | 5.80 | 66-111-25 | - | - |
| 32 | 167.6 | 6.80 | 66-111-62 | - | - |
| 42 | 218.4 | 8.60 | 66-111-60 | 66-111-75 | - |
| 42 | 218.4 | 8.60 | - | 66-111-160* | - |
| 63 | 325.1 | 12.80 | 66-111-61 | 66-111-76 | - |
| 81 | 416.6 | 16.40 | 66-111-22 | 66-111-77 | - |
| 84 | 431.8 | 17.00 | 66-111-23 | 66-111-78 | - |
| | 1350.0 | 53.15 | | - | 66-111-19 |

* for Systemkit 12K

6.1.1.2 EMC Version

| Length for HP | Length | | Holes n x C | Part-No. clear passivated |
|---------------------|--------|-------|----------------|------------------------------|
| | mm | inch | | |
| 42 | 218.4 | 8.60 | 2 x 71.42 | 66-111-50 |
| 63 | 325.1 | 12.80 | 3 x 83.17 | 66-111-51 |
| 81 | 416.6 | 16.40 | 4 x 85.24 | 66-111-52 |
| 84 | 431.8 | 17.00 | 4 x 89.05 | 66-111-53 |
| 84 | 431.8 | 17.00 | 4 x 89.05 | 66-111-153* |

* for Systemkit 12K

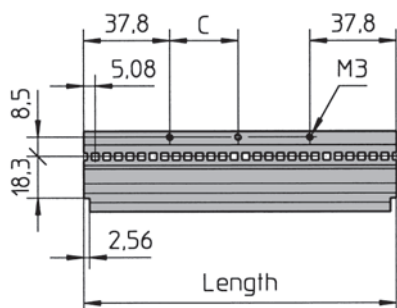
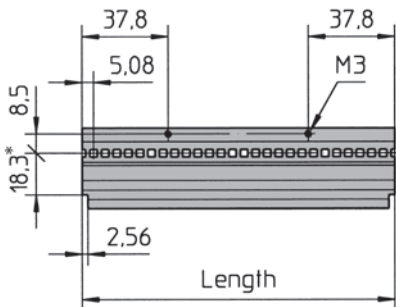

6: Extrusions

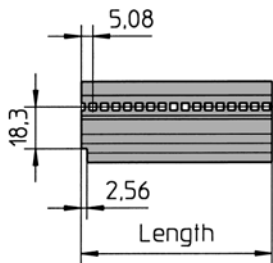
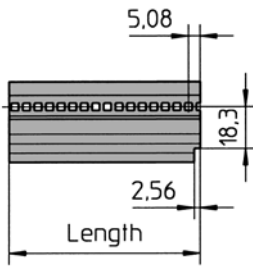

6.1.1.3 Height Divider Right, IEC

| Length for HP | Length | | Part-No. anodised |
|---------------|--------|------|-------------------|
| | mm | inch | |
| 8.5 | 43.18 | 1.70 | 66-111-71 |
| 12.5 | 63.50 | 2.50 | 66-111-72 |

6.1.1.4 Height Divider Left, IEC

| Length for HP | Length | | Part-No. anodised |
|---------------|--------|------|-------------------|
| | mm | inch | |
| 8.5 | 43.18 | 1.70 | 66-111-81 |
| 12.5 | 63.50 | 2.50 | 66-111-82 |

6.1.2 Front Extrusion 66-112

- For sub racks and cases front, without protrusion
- Accept 2 x 6 mm tapped strips
- **Scope of delivery:**
 - 1 front extrusion without assembly material

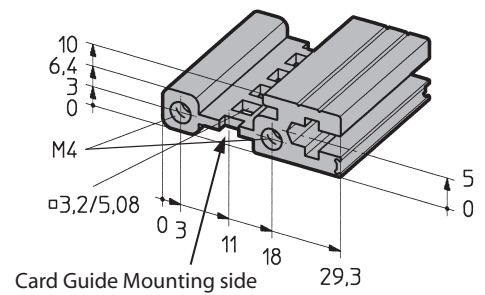
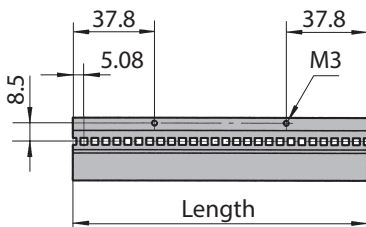

6.1.2.1 Standard Version

| Length for HP | Length | | Part No. clear | |
|---------------|--------|-------|----------------|-----------|
| | mm | inch | passivated | raw |
| 21 | 111.8 | 4.40 | 66-112-26 | - |
| 28 | 147.3 | 5.80 | 66-112-25 | - |
| 32 | 167.6 | 6.80 | 66-112-47* | - |
| 42 | 218.4 | 8.60 | 66-112-60 | - |
| 63 | 325.1 | 12.80 | 66-112-61 | - |
| 81 | 416.6 | 16.40 | 66-112-22 | - |
| 84 | 431.8 | 17.00 | 66-112-23 | - |
| | 1350.0 | 53.15 | - | 66-112-19 |

*=without M3

6.1.3 Front Extrusion 66-665, IEC

- For Magic-Kit 11 according to IEC/EN standard
- Accept 2 x 6 mm tapped strips
- **Scope of delivery:**
 - 1 front extrusion without assembly material

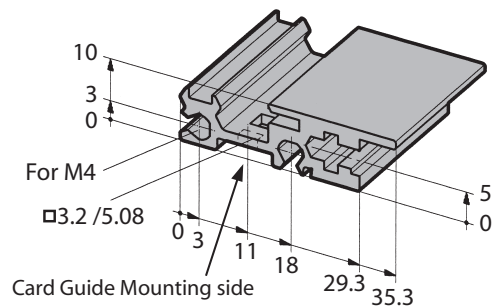
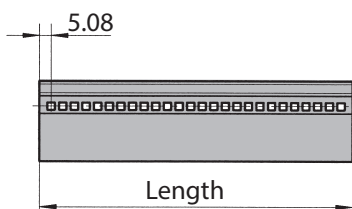

6.1.3.1 Standard Version

| Length for HP | mm | inch | Part-No. clear passivated |
|---------------|-------|-------|---------------------------|
| 84 | 431.8 | 17.00 | 66-665-53 |

6: Extrusions

6.1.4 Horizontal Front Sub Division Extrusion 66-245, IEC

- Card guide can be applied
- Accept 2 x 6 mm tapped strips
- **Scope of delivery:**
 - 1 front double extrusion IEC-special without assembly material

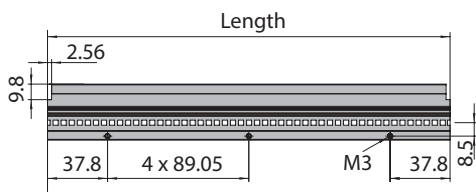
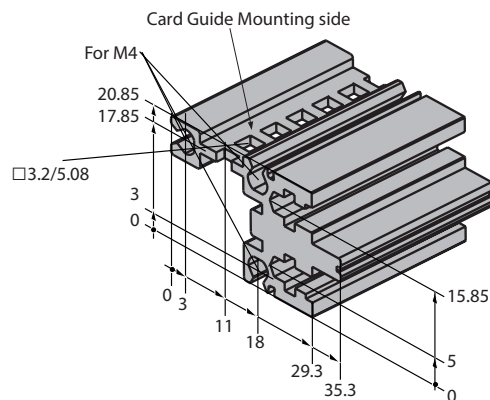

6.1.4.1 Standard Version

| Length for HP | mm | inch | Part-No. | |
|---------------|--------|-------|------------------|-----------|
| | | | clear passivated | raw |
| 84 | 431.8 | 17.00 | 66-245-23 | |
| | 1350.0 | 53.14 | - | 66-245-19 |

6.1.5 Horizontal Front Sub Division Extrusion 66-243, IEC

- Card guide cannot be applied
- Accept 2 x 6 mm tapped strips
- **Scope of delivery:**
 - 1 front double extrusion IEC-special without assembly material

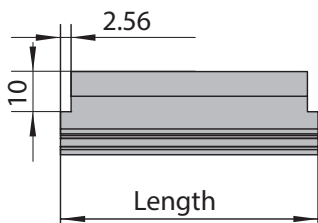
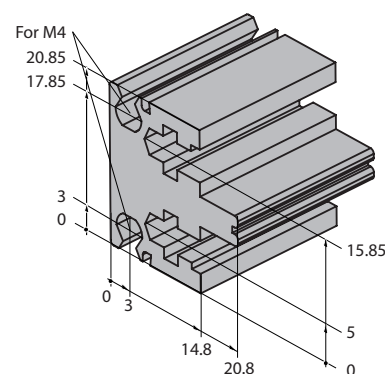

6.1.5.1 Standard Version

| Length for HP | mm | inch | Part-No. clear passivated |
|---------------|-------|-------|---------------------------|
| 84 | 431.8 | 17.00 | 66-243-23 |

6.1.6 Front Extrusion 66-282, IEC

- For Stylebox 15 Smart
- **Scope of delivery:**
 - 1 front extrusion without assembly material

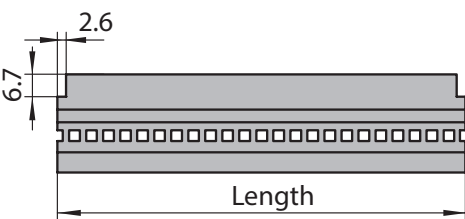
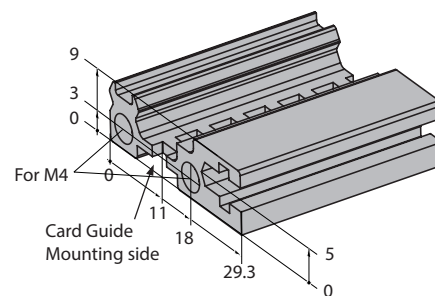

6.1.6 Front Extrusion 66-282, IEC

| Length for HP | mm | inch | Part-No. clear passivated |
|---------------|-------|-------|---------------------------|
| 42 | 218.4 | 8.60 | 66-282-26 |
| 63 | 325.1 | 12.80 | 66-282-27 |
| 84 | 431.8 | 17.00 | 66-282-28 |
| | 1350 | 53.15 | 66-282-19 |

6: Extrusions

6.1.7 Front Extrusion 66-677, IEEE

- Front separation extrusion according to IEEE standard
- Accept 2 x 6 mm tapped strips
- **Scope of delivery:**
 - 1 front extrusion without assembly material

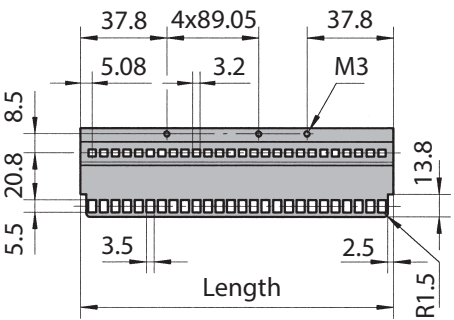
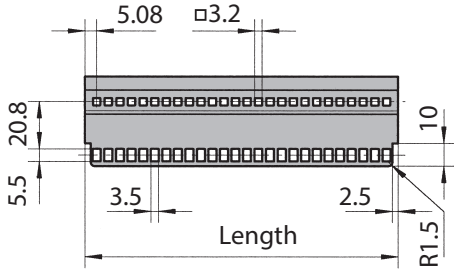
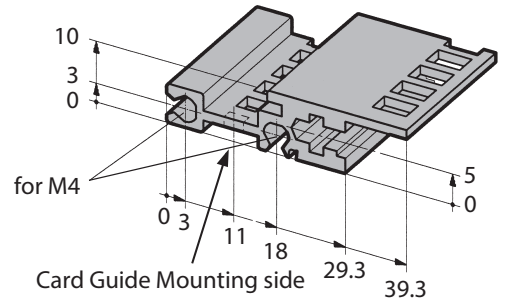

6.1.7.1 Version for type 11 spirit according to IEEE standard

| Length for HP | Length | | Part-No. clear passivated |
|------------------|--------|-------|------------------------------|
| | mm | inch | |
| 84 | 431.8 | 17.00 | 66-677-23 |

6.1.7.2 Version for Systemkit 12K and Stylebox 15 according to IEEE standard

| Length for HP | Length | | Part-No. clear passivated |
|------------------|--------|-------|------------------------------|
| | mm | inch | |
| 84 | 431.8 | 17.00 | 66-677-33 |

6: Extrusions

6.1.8 Front Extrusion 66-678, IEEE

- Front separation extrusion according to IEEE standard
- Accept 2 x 6 mm tapped strips
- **Scope of delivery:**
 - 1 front extrusion without assembly material

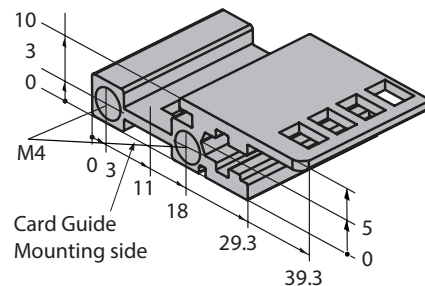
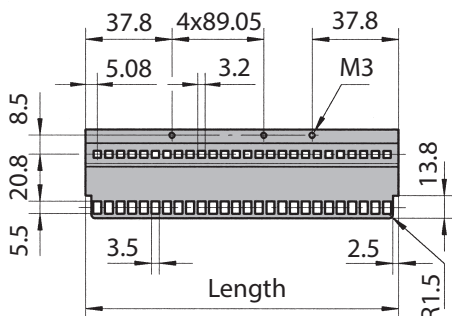

6.1.8.1 Version for Systemkit 12K according to IEEE standard

| Length for HP | mm | inch | Part-No. clear passivated |
|---------------|-------|-------|---------------------------|
| 84 | 431.8 | 17.00 | 66-678-23 |

6.1.9 Front Extrusion 66-666, IEEE

- For Spirit-Kit 11 according to IEEE standard
- Accept 2 x 6 mm tapped strips
- **Scope of delivery:**
 - 1 front extrusion without assembly material

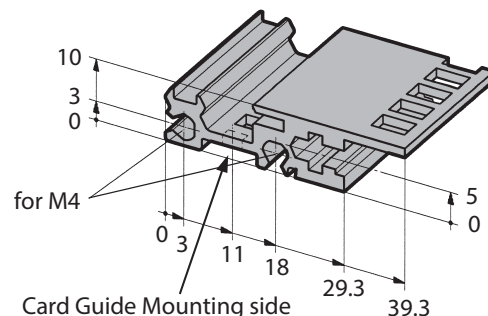
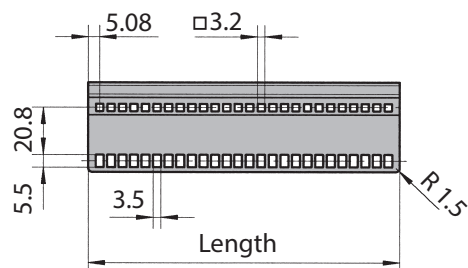

6.1.9.1 Standard Version

| Length for HP | mm | inch | Part-No. clear passivated |
|---------------|-------|-------|---------------------------|
| 84 | 431.8 | 17.00 | 66-666-53 |

6.1.10 Front Extrusion 66-281, IEEE

- For Stylebox 15 standard according to IEEE
- Accept 2 x 6 mm tapped strips
- **Scope of delivery:**
 - 1 front extrusion without assembly material, powder-coated

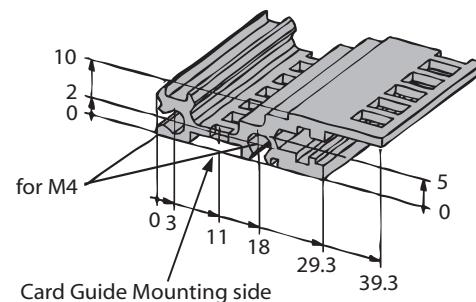
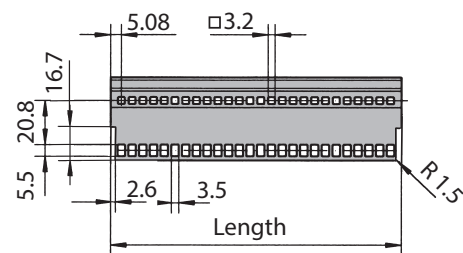

6.1.10.1 Standard Version

| Length for HP | mm | inch | Part-No. |
|---------------|-------|-------|-----------|
| 42 | 218.4 | 8.60 | 66-281-60 |
| 63 | 325.1 | 12.80 | 66-281-61 |
| 84 | 431.8 | 17.00 | 66-281-54 |

6: Extrusions

6.1.11 Horizontal Front Sub Division Extrusion 66-240, IEEE

- Card guide can be applied
- Accept 2 x 6 mm tapped strips
- **Scope of delivery:**
 - 1 front double extrusion IEEE-special without assembly material

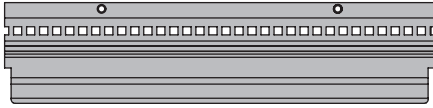
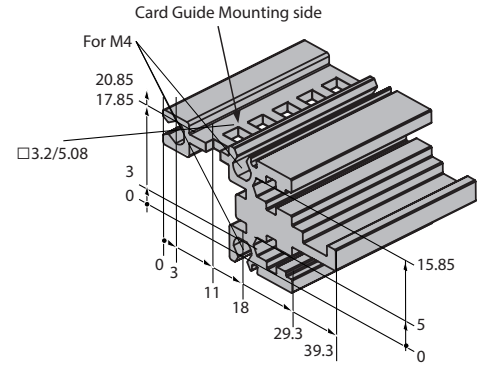

6.1.11.1 Standard Version

| Length for HP | | | Part-No. | |
|------------------|--------|-------|------------------|-----------|
| | mm | inch | clear passivated | raw |
| 84 | 431.8 | 17.00 | 66-240-153 | - |
| | 1350.0 | 53.14 | - | 66-240-19 |

6.1.12 uTCA Extrusion 66-242, uTCA

- Accept 2 x 6 mm tapped strips
- **Scope of delivery:**
 - 1 uTCA extrusion without assembly material

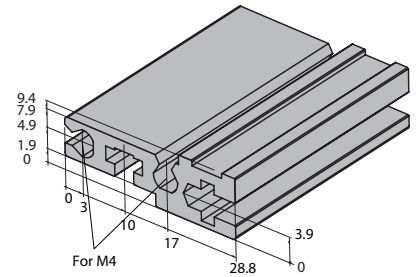

6.1.12.1 uTCA Extrusion

| Description | Part-No. |
|----------------------------|------------|
| uTCA Extrusion L=443.32 mm | 66-242-443 |