

2: Assembly Material

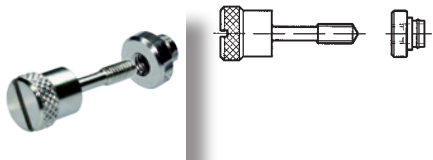

2.1 Front Panel Screws M2.5



2.1.1 Milled Edge Screw Slotted, Head Ø 7, Press-Fit Bush

Description	Material	Part-No.
M2.5 x 11.3	Steel, nickel-plated	10 pcs. 63-443

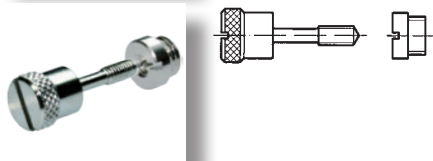

2.1.2 Milled Edge Screw Slotted, Head Ø 7, Threaded Bush

Description	Material	Part-No.
M2.5 x 11.3; M2.5/M5 x 0.5	Steel/brass, nickel-plated	10 pcs. 63-130

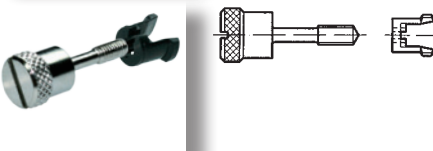

2.1.3 Milled Edge Screw Slotted, Head Ø 7, Retainer

Description	Material	Part-No.
M2.5 x 11.3	Steel, nickel-plated / plastic	10 pcs. 63-157

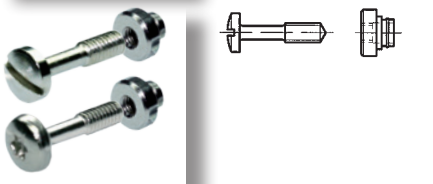

2.1.4 Round Head Screw, Head Ø 5 (Torx Ø 6), Press-Fit Bush

Description	Material	Part-No.
Slotted, M2.5 x 11.3	Steel, nickel-plated	10 pcs. 63-444
Torx, M2.5 x 11.3, size T8	Steel, nickel-plated	63K480

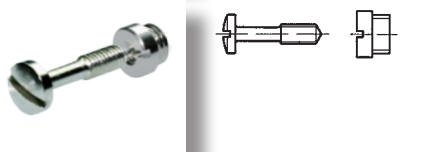

2.1.5 Round Head Screw Slotted, Head Ø 5, Threaded Bush

Description	Material	Part-No.
M2.5 x 11.3; M2.5/M5 x 0.5	Steel/brass, nickel-plated	10 pcs. 63-129

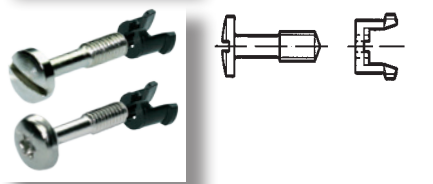

2.1.6 Round Head Screw, Head Ø 5 (Torx Ø 6), Retainer

Description	Material	Part-No.
Slotted M2.5 x 11.3	Steel, nickel-plated / plastic	10 pcs. 63-159
Torx, M2.5 x 11.3, size T8	Steel, nickel-plated / plastic	63K159

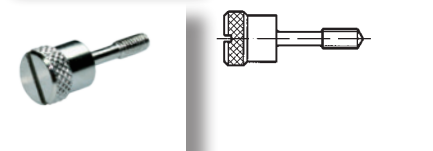

2.1.7 Milled Edge Screw Slotted, Head Ø 7

Description	Material	Part-No.
M2.5 x 11.3	Steel, nickel-plated	61-267
M2.5 x 11.3	Steel, nickel-plated, black	61-267-01

2: Assembly Material

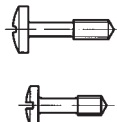

2.1.8 Round Head Screw Slotted, Head Ø 5

Description	Material	Part-No.
M2.5 x 9	Steel, nickel-plated	61-252
M2.5 x 11.3	Steel, nickel-plated	61-256



2.1.9 Round Head Screw, Head Ø 6

Description	Material	Part-No.
Philips M2.5 x 12.7	Steel, nickel-plated	61-287
Philips M2.5 x 12.7	Steel, nickel-plated, black	61-294
Torx M2.5 x 11.3, size T8	Steel, nickel-plated	5443-08
Freedrive M2.5 x 11.3	Steel, nickel-plated	61-295
Freedrive M2.5 x 11.3	Steel, nickel-plated, black	61-295-01



2.1.10 Press-Fit Bush, Drilling Ø 3.7^{+0.11} 0

Description	Material	Part-No.
M2.5 Mat. ≥ 2.5 mm	Steel, nickel-plated	61-201
M2.5 Mat. ≥ 2.5 mm	Steel, nickel-plated, black	61-207
M2.5 Mat. ≥ 1 mm	Steel, nickel-plated	61-225
M2.5 Mat. ≥ 1 mm	Steel, nickel-plated, black	61-223

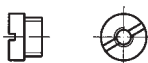

2.1.11 Threaded Bush

Description	Material	Part-No.
M2.5/M5 x 0.5	Brass, nickel-plated	61-200



2.1.12 Screw Retainer

Description	Material	Part-No.
M2.5 + M3	Plastic	61-008

2: Assembly Material



2.2 Miscellaneous Screws

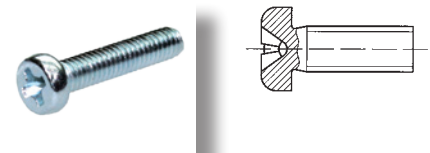

2.2.1 Philips Cylindrical Screw, ~DIN 84A

Description	Material	Part-No.
M2.5 x 4	Steel, zinc-plated	5325-04
M2.5 x 4, Torx T8	Stainless steel	5470-07
M2.5 x 5, Torx T8	Stainless steel	5470-07
M2.5 x 6	Steel, zinc-plated	5325-06
M2.5 x 6, Torx T8	Stainless steel	5470-04
M2.5 x 8	Steel, zinc-plated	5325-08
M2.5 x 8, Torx T8	Stainless steel	5470-10
M2.5 x 10	Steel, zinc-plated	5325-10
M2.5 x 10, Torx T8	Stainless steel	5470-09
M2.5 x 12	Steel, zinc-plated	5325-12
M2.5 x 12, Torx T8	Rostfreier Stahl	5470-12
M3 x 4, Torx T10	Steel, zinc-plated	5470-01
M3 x 6, Torx T10	Steel, zinc-plated	5470-02
M3 x 8	Steel, zinc-plated	5338-08
M3 x 8, Torx T10	Steel, zinc-plated	5470-03
M3 x 12	Steel, zinc-plated	5330-12
M3 x 12, Torx T10	Steel, zinc-plated	5470-05
M4 x 8	Steel, zinc-plated	5348-08
M4 x 8, Torx T10	Steel, zinc-plated	5470-06
M4 x 12	Steel, zinc-plated	5348-12

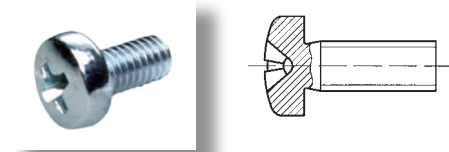

2.2.2 Philips Round Head Screw, DIN 7985A

Description	Material	Part-No.
M3 x 4	Steel, zinc-plated	5331-04
M3 x 6	Steel, zinc-plated	5330-06
M3 x 8	Steel, zinc-plated	5330-08
M3 x 10	Steel, zinc-plated	5330-10
M4 x 6	Steel, zinc-plated	5340-06
M4 x 8	Steel, zinc-plated	5340-08
M6 x 8	Steel, zinc-plated	5360-08

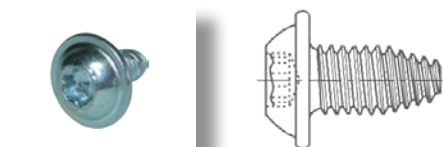

2.2.3 SHEETtracs® Screw

Description	Material	Part-No.
3 x 6, Torx T10	Steel, zinc-plated	5477-01

2: Assembly Material

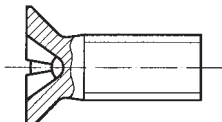

2.2.4 Philips Countersunk Screw, DIN 965A

Description	Material	Part-No.
M2.5 x 4	Steel, zinc-plated	5322-04
M2.5 x 4, Torx T8	Stainless steel	5470-25
M2.5 x 6	Steel, zinc-plated	5322-06
M2.5 x 6, Torx T8	Stainless steel	5470-20
M2.5 x 8	Steel, zinc-plated	5322-08
M2.5 x 8, Torx T8	Stainless steel	5470-21
M2.5 x 16, Torx T8	Stainless steel	5470-30
M3 x 6	Steel, zinc-plated	5332-06
M3 x 6, Torx T10	Steel, zinc-plated	5470-22
M3 x 8	Steel, zinc-plated	5332-08
M3 x 8, Torx T10	Steel, zinc-plated	5470-28
M3 x 10	Steel, zinc-plated	5332-10
M3 x 10, Torx T10	Steel, zinc-plated	5470-23
M4 x 6, Torx T20	Steel, zinc-plated	5470-27
M4 x 8, Torx T20	Steel, zinc-plated	5470-29
M4 x 10	Steel, zinc-plated	5342-08
M4 x 10, Torx T20	Steel, zinc-plated	5470-26
M4 x 10	Steel, zinc-plated	5342-10

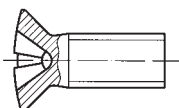

2.2.5 Philips Countersunk Round Head Screw, DIN 966A

Description	Material	Part-No.
M3 x 6	Steel, nickel-plated	5333-06
M3 x 8	Steel, nickel-plated	5333-08

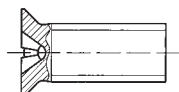

2.2.6 Philips Countersunk Screw with Small Head Ø 6

Description	Material	Part-No.
M4 x 5	Steel, zinc-plated	5441-50
M4 x 5	Steel, zinc-plated, black	5441-53
M4 x 5, Torx T10	Steel, zinc-plated	5441-58
M4 x 5, Torx T10	Steel, zinc-plated, black	5441-59
M4 x 10	Steel, zinc-plated	5441-51
M4 x 10	Steel, zinc-plated, black	5441-52
M4 x 10, Torx T10	Steel, zinc-plated	5441-54
M4 x 10, Torx T10	Steel, zinc-plated, black	5441-57

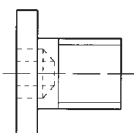

2.2.7 Cylindrical Allen Screw with Extremely Low Head

Description	Material	Part-No.
M5 x 6	Steel, zinc-plated	5441-22

2.2.8 Special Low-Head Allen Screw with Collar

- Ø 8.2 x 1.3 for 19" perforation in cabinets

Description	Material	Part-No.
M6 x 15	Steel, zinc-plated	5441-15

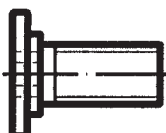

2.2.9 Slotted Cylindrical Screw with Small Head Ø 3.2 / Ø 3.8 (M3)

Description	Material	Part-No.
M2.5 x 4	Steel, zinc-plated	5526-04
M3 x 6	Steel, zinc-plated	5536-06

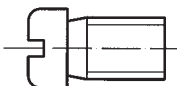

2: Assembly Material

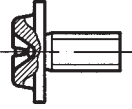

2.2.10 Philips Round Head Screw with Integrated Washer

Description	Material	Part-No.
M2.5 x 10, Torx 8	Steel, zinc-plated	5473-04
M3 x 4, Torx T10	Steel, zinc-plated	5473-02
M3 x 6	Steel, zinc-plated	5335-06
M3 x 6, Torx T10	Steel, zinc-plated	5473-01
M3 x 8, Torx T10	Steel, zinc-plated	5473-05
M4 x 12, Torx T20	Stainless steel	5473-03
M4 x 16, Torx T20	Steel, zinc-plated	5473-06
M5 x 16, Torx T25	Steel, zinc-plated	5473-07

2.2.11 Philips Round Head Screw with Integrated Washer, Tuflock-Coated

Description	Material	Part-No.
M2.5 x 10	Steel, zinc-plated	5336-10

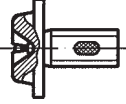

2.3 Earthing Screws

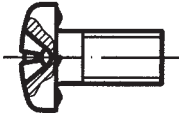

2.3.1 Special Philips Round Head Earthing Screw

Description	Material	Part-No.
M3 x 6	Steel, zinc-plated	61-283
M3 x 6	Steel, zinc-plated, black	61-293

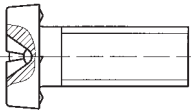

2.3.2 Special Philips Cylindrical Earthing Screw

Description	Material	Part-No.
M3 x 6, Torx T10	Steel, zinc-plated	5443-04
M4 x 6		61-279
M4 x 6, Torx T20	Steel, zinc-plated	5443-06
M4 x 10	Steel, zinc-plated	61-260
M4 x 10, Torx T20	Steel, zinc-plated	5443-01
M4 x 16, Torx T20	Steel, zinc-plated	5443-07

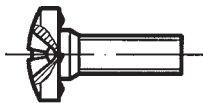

2.3.3 Special Philips Round Head Earthing Screw

- With collar $\varnothing 3.2 \times 0.9$ for front panels

Description	Material	Part-No.
M2.5 x 8	Steel, nickel-plated	61-286
M2.5 x 8, Torx T8	Steel, nickel-plated	61-298

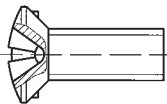

2.3.4 Philips Countersunk Round Head Earthing Screw

Description	Material	Part-No.
M3 x 8	Steel, zinc-plated	61-270
M3 x 8	Steel, zinc-plated, black	61-292
M4 x 12	Steel, zinc-plated	63-271

2: Assembly Material

2.4 Self-Tapping Screws

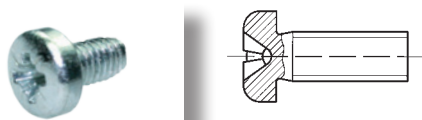

2.4.1 Self-Tapping Philips Round Head Screw

Description	Material	Part-No.
M3 x 5	Steel, zinc-plated	5338-05
M4 x 6, Torx T20	Steel, zinc-plated	5471-01
M4 x 8, Torx T20	Steel, zinc-plated	5471-02



2.4.2 Self-Tapping Philips Countersunk Earthing Screw

Description	Material	Part-No.
M3 x 8.8	Steel, zinc-plated	61-272



2.4.3 Self-Tapping Countersunk Screw

Description	Material	Part-No.
M4 x 12, Torx T20	Steel, zinc-plated	5472-01

2.5 PT Screws

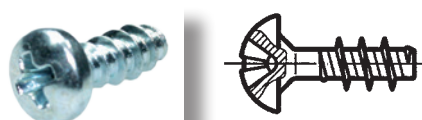

2.5.1 Philips PT Round Head Screw

Description	Material	Part-No.
Ø 2.2 x 8	Steel, zinc-plated	5535-13
Ø 2.2 x 12	Steel, zinc-plated	5535-12
Ø 2.5 x 8	Steel, zinc-plated	5588-08
Ø 3 x 8	Steel, zinc-plated	61-276

2.6 Sheet Metal Screws

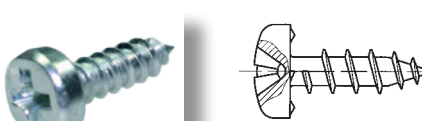

2.6.1 Special Philips Round Head Sheet Metal Earthing Screw

Description	Material	Part-No.
Ø 2.9 x 6.5, Torx T10	Steel, zinc-plated	5443-09
Ø 2.9 x 9.5	Steel, zinc-plated	5441-33
Ø 4.8 x 9.5, Torx T25	Steel, zinc-plated	5575-40

2.7 Threaded Bolts

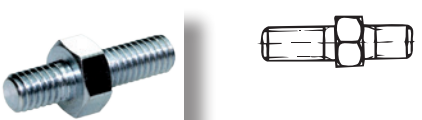

2.7.1 Threaded Earthing Bolt

Description	Material	Part-No.
M4 x 9/6	Steel, zinc-plated	61-096

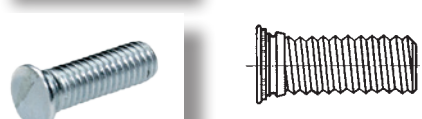

2.7.2 Press-in Threaded Stud for Earth Connector

Description	Material	Part-No.
M3 x 8	Steel, zinc-plated	5815-32
M4 x 8	Steel, zinc-plated	5815-41
M4 x 10	Steel, zinc-plated	5815-42
M4 x 12	Steel, zinc-plated	5815-43



2.7.3 ESD Snap-faster Hook-up

Description	Material	Part-No.
M3 / 4.5 mm, L= 9.5 mm	Brass	61-001

2.8 Set Screws



2.8.1 Set Screws for Fixing of Tapped Strips

Description	Material	Part-No.
M2.5 x 8	Steel, zinc-plated	5412-08
M3 x 6	Steel, zinc-plated	5413-06