

## 2.6 Extrusions

### 2.6.1 Front Extrusions

#### 2.6.1.1 Front Extrusion 66-111, IEC

- For sub rack and cases front
- Accept 2 x 6 mm tapped strips
- **Scope of delivery:**
  - 1 front extrusion without assembly material

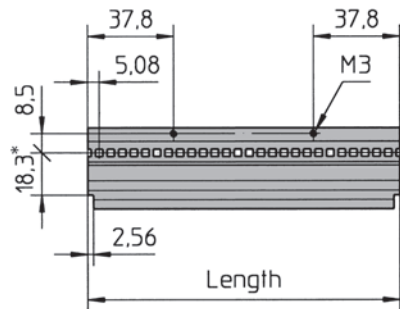
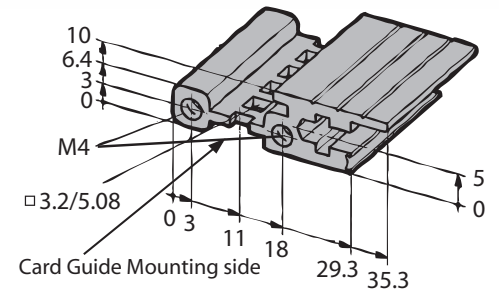

\* 14,0 for Systemkit 12K

#### 2.6.1.1 Standard Version

Length for HP	mm		Part-No. clear anodised	clear passivated	raw
	mm	inch			
21	111.8	4.40	66-111-26	—	—
28	147.3	5.80	66-111-25		
32	167.6	6.80	66-111-62	66-111-162*	—
42	218.4	8.60	66-111-60	66-111-75	—
42	218.4	8.60		66-111-160*	—
63	325.1	12.80	66-111-61	66-111-76	—
81	416.6	16.40	66-111-22	66-111-77	—
84	431.8	17.00	66-111-23	66-111-78	—
	1350.0	53.15	—	—	66-111-19

\* for Systemkit 12K

#### 2.6.1.2 Height Divider Right

Length for HP	mm	inch	Part-No. anodised
4.5	22.86	0.90	66-111-70
8.5	43.18	1.70	66-111-71
12.5	63.50	2.50	66-111-72
16.5	83.82	3.30	66-111-73

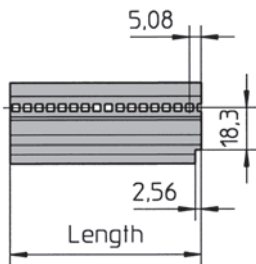

#### 2.6.1.3 Height Divider Left

Length for HP	mm	inch	Part-No. anodised
4.5	22.86	0.90	66-111-80
8.5	43.18	1.70	66-111-81
12.5	63.50	2.50	66-111-82
16.5	83.82	3.30	66-111-83

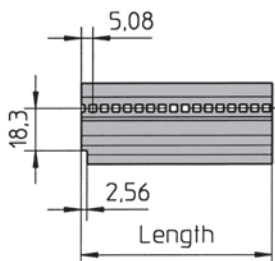

# 2: Ecockit 11

## 2.6.2 Height Extrusions

### 2.6.2.1 Height Extrusion 19" 66-175

- 19" height extrusion type 11
- For standard side panel 2 mm
- **Scope of delivery:**
  - 1 height extrusion without assembly material

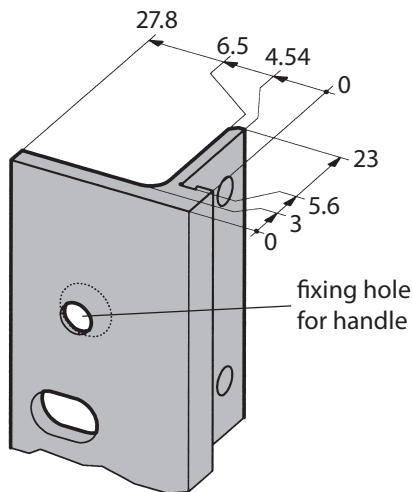

Length for U			Part-No. clear anodised fixing hole for handle	
	mm	inch	without	with
3	132.5	5.20	66-175-23	66-175-33
4	177.0	6.96	66-175-24	66-175-34
6	165.9	10.46	66-175-26	66-175-36
7	310.3	12.20	66-175-27	66-175-37
8	354.8	13.96	66-175-28	66-175-38
9	399.2	15.71	66-175-26	66-175-39
10	443.7	17.47	66-175-40	-
12	532.6	20.96	66-175-32	66-175-42

## 2.6.3 Internal Extrusions

### 2.6.3.1 Standard Internal Extrusion 66-144

- Standard extrusion for mounting supplementary edge connector extrusions in sub racks and cases
- Accept 2 x 6 mm tapped strips
- **Scope of delivery:**
  - 1 internal extrusion without assembly material

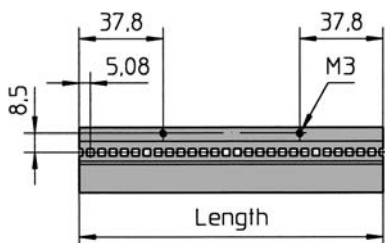
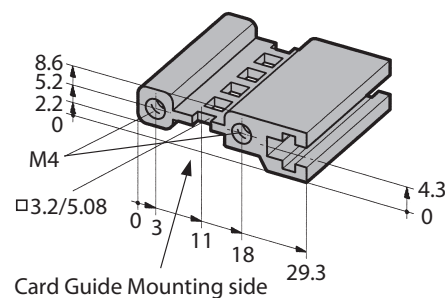

#### 2.6.3.1 Standard Version

Length for HP			Part-No.	
	mm	inch	clear passivated	raw
42	218.4	8.60	66-144-60	-
63	325.1	12.80	66-144-61	-
81	416.6	16.40	66-144-22	-
84	431.8	17.00	66-144-23	-
	1350.0	53.14	-	66-144-19

### 2.6.3.2 Internal Extrusion 66-193 for use of Insulating Strip

- For mounting backplanes in sub racks
- Insulating strip see 2.6.3.3
- Accept 1.8 x 5 mm tapped strips
- **Scope of delivery:**
  - 1 extrusion without assembly material

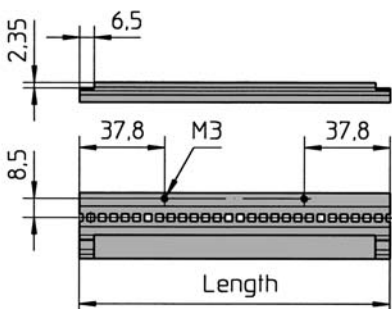
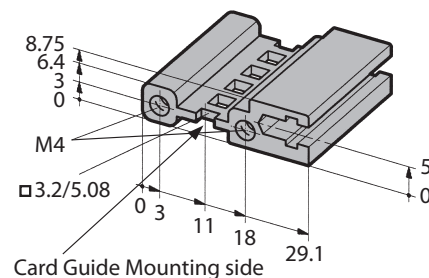

#### 2.6.3.2 Internal Extrusion 66-193 for Use of Insulating Strip

Length for HP	mm	inch	Part-No. clear passivated
81	416.6	16.40	66-193-24
84	431.8	17.00	66-193-25

# 2: Ecockit 11

## 2.6.3.3 Insulating Strips 66-901

- Plastic grey
- In use with extrusions 66-112, 66-192, 66-193, 66-288
- **Scope of delivery:**
  - 1 insulating strip without assembly material

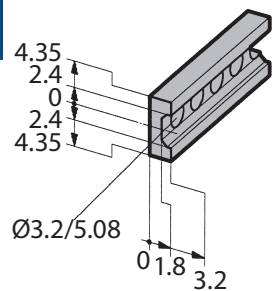

## 2.6.3.3 Insulating Strips 66-901

Length for HP	Length		Part-No.
	mm	inch	
42	216.44	8.52	66-901-20
63	323.12	12.72	66-901-21
81	414.56	16.32	66-901-22
84	429.80	16.92	66-901-23

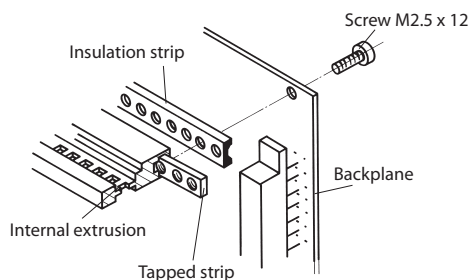

## Mounting with Insulation Strips

Description	Part-No.	
	1 pcs.	100 pcs.
Cross recessed cylinderhead earthing screw M2.5 x 12	5325-12	1910-07

## 2.6.3.4 Internal Extrusion 66-194 without use of Insulating Strip

- For mounting backplanes without an insulating strip
- **Scope of delivery:**
  - 1 extrusion without assembly material

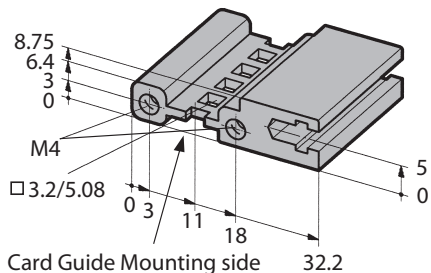

## 2.6.3.4 Internal Extrusion 66-194 without Use of Insulating Strip

Length for HP	Length		Holes n x C	Part-No. clear passivated
	mm	inch		
81	416.6	16.40	2 x 170.48	66-194-24
84	431.8	17.00	2 x 178.1	66-194-25
84	431.8	17.00	4 X 89.05	66-194-29

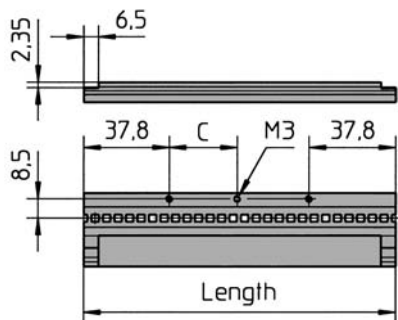

## 2.6.4 Center Extrusions

### 2.6.4.1 Double Extrusion 66-192 for use of Insulating Strip

- For mounting backplanes, matches 66-193, 66-288
- For use with insulating strips
- Insulating strip see 2.6.3.3
- Accept 2 x 6 mm tapped strips
- **Scope of delivery:**
  - 1 extrusion without assembly material

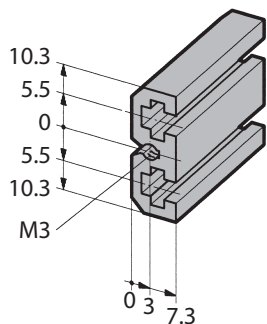

Length for HP	Length		Part-No.	
	mm	inch	clear passivated	raw
84	431.8	17.00	66-192-24	-
	1350.0	53.14	-	66-192-14

Length for HP	mm	inch	Part-No. clear passivated
42	213.4	8.40	66-192-20
63	320.0	12.59	66-192-21
81	411.5	16.20	66-192-22
84	426.7	16.79	66-192-23

Assembly material with adapter: 63-175 (63K175 with Torx)

### 2.6.4.2 Double Extrusion 66-195 without use of Insulating Strip

- For mounting backplanes without insulating strips
- Matches 66-194, 66-289, 66-290
- Accept 2 x 6 mm tapped strips
- **Scope of delivery:**
  - 1 extrusion without assembly material

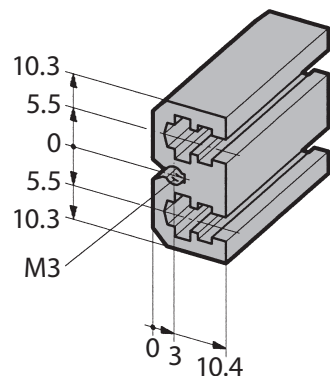

Length for HP	mm	inch	Part-No. clear passivated
84	431.8	17.00	66-195-24

Length for HP	mm	inch	Part-No. clear passivated
81	411.5	16.20	66-195-22
84	426.7	16.77	66-195-23

Assembly material with adapter: 63-175 (63K175 with Torx)

### 2.6.4.3 Double Extrusion 66-124

- For mounting of supplementary edge connector extrusion
- Matches 66-144
- Accept 2 x 6 mm tapped strips
- **Scope of delivery:**
  - 1 extrusion without assembly material

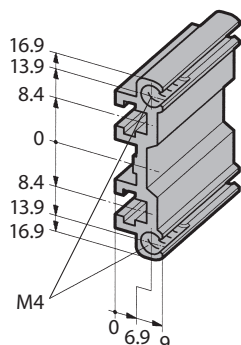

Length for HP	Length		Part-No.	
	mm	inch	clear passivated	raw
42	218.4	8.60	66-124-60	-
63	325.1	12.80	66-124-61	-
81	416.6	16.40	66-124-22	-
84	431.8	17.00	66-124-23	-
	1350.0	53.14	-	66-124-14

## 2.6.5 Edge Connector Extrusions

### 2.6.5.1 Edge Connector Extrusion 66-145

- Supplementary edge connector extrusion for IEC 60603-2 connectors
- Matches 66-144, 66-133 and 66-124
- **Scope of delivery:**
  - 1 supplementary edge connector extrusion without assembly material

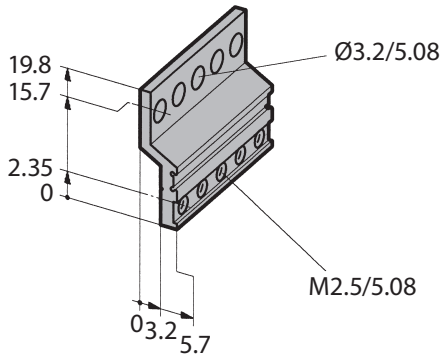
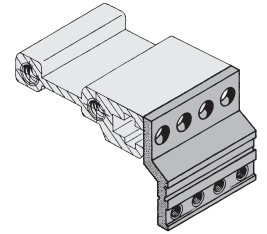

### 2.6.5.1 Edge Connector Extrusion 66-145

Length for HP	mm	inch	Part-No.	
			clear passivated	raw
8	40.6	1.59	66-145-40	
18	91.4	3.59	66-145-41	
28	142.2	5.60	66-145-42	
42	213.4	8.40	66-145-63	
63	320.0	12.60	66-145-65	
81	411.5	16.20	66-145-22	
84	426.7	16.80	66-145-52	
	1350.0	53.14		66-145-19

### 2.6.5.2 Edge Connector Extrusion 66-147

- Supplementary edge connector extrusion for IEC 60603-2
- Matches 66-112, 66-192 and 66-193
- **Scope of delivery:**
  - 1 supplementary edge connector extrusion without assembly material

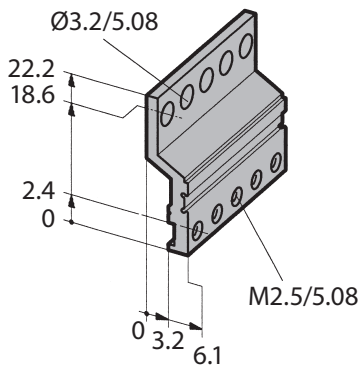
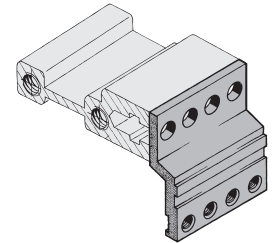

### 2.6.5.2 Edge Connector Extrusion 66-147

Length for HP	mm	inch	Part-No.	
			clear passivated	raw
8	40.6	1.59	66-147-40	
18	91.4	3.59	66-147-41	
28	142.2	5.60	66-147-42	
42	213.4	8.40	66-147-63	
63	320.0	12.60	66-147-65	
81	411.5	16.20	66-147-22	
84	426.7	16.80	66-147-52	
	1350.0	53.14		66-147-19