

## 2: Telescopic Rails



### 2.1 Telescopic Rails 60 kg

Despite their rugged construction, these are among the slimmest telescopic rails available on the market. All types can be locked in the extended position and are fitted with a quick release latch. The load carrying capacity of one pair is 60 kg.

- Extremely slim, overall width only 6 mm
- New type of corrosion-protected surface with high sliding properties
- No additional lubrication necessary
- Little frictional resistance with heavy loads
- Selflocking plug-in function
- Load capacity up to 60 kg/132 lb (US) / pair
- Ease of assembly
- No milling of front vertical extrusion necessary

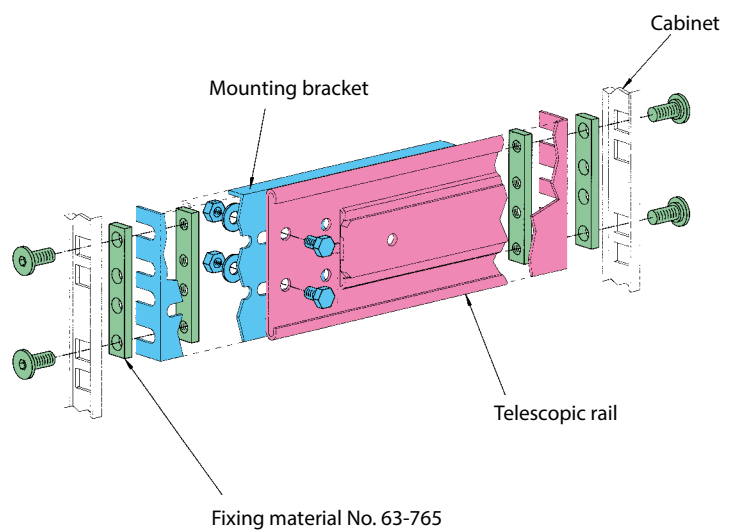

#### 2.1.1 Telescopic Rails 60 kg, Set

- Telescopic rails, suitable for all heights
- **Scope of delivery:**
  - 2 telescopic rails
  - Mounting brackets
  - Assembly material for mounting into cabinet and on module

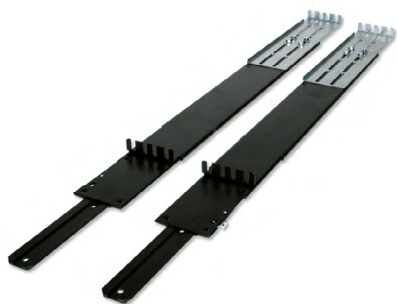

#### 2.1.1 Telescopic Rails, Set (Load Capacity up to 60 kg/Pair)

Max. withdraw	Usable depth		Part-No.
	min.	max.	
511.2 mm	463 mm	681.8 mm	65-051
596.4 mm	564.6 mm	783.4 mm	65-052
719.6 mm	666.2 mm	885.0 mm	65-053

Rugged telescopic rail 90 kg available on request.

# 2: Telescopic Rails

## 2.2 Cable Carrier

- The cable carrier can be easily installed and detached by removing the hinge bolt
- The cable carrier is mounted on the rear vertical section
- **Scope of delivery:**
  - 1 cable carrier



## 3.3 Cable Carrier

Description	Part-No.
Cable carrier	65-028-00

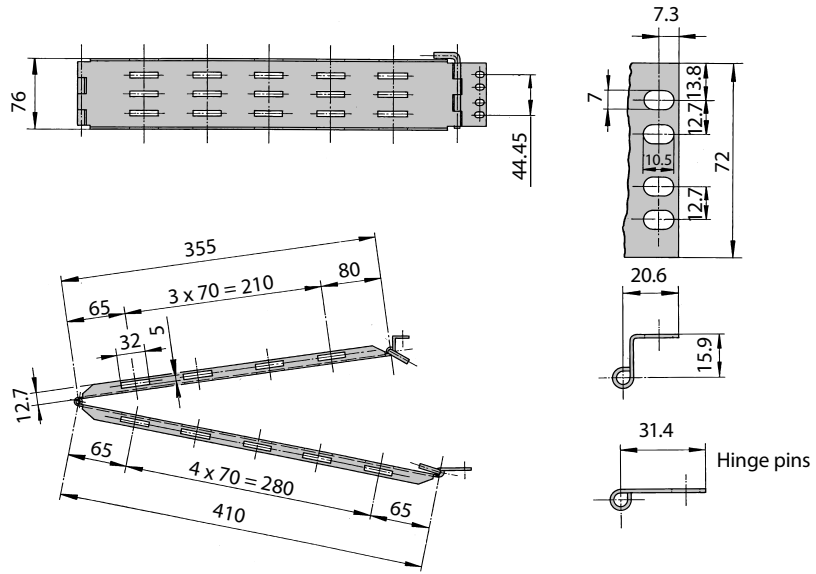

D

# 2: Telescopic Rails

## 2.3 Line Drawings

- Showing a 60 kg rail

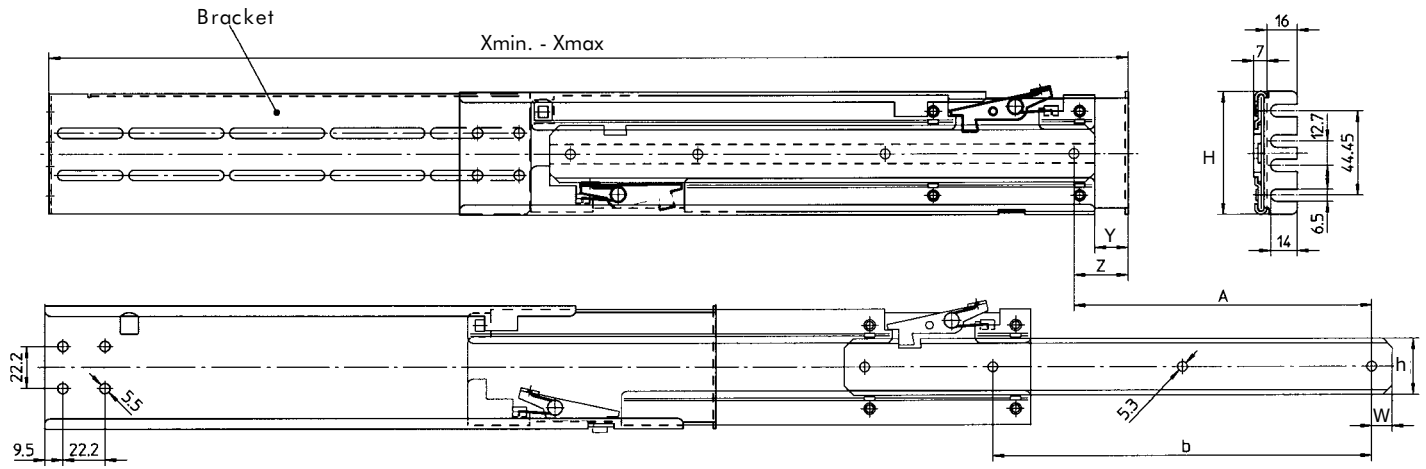

### Dimensions

Size	Type	b	h	H	A	Z	Y	W	X min.	X max.
Size 3	65-051	3 x 100	30	65	511.2	32.2	17.5	11	463	681.8
Size 5	65-052	4 x 100	30	65	596.4	31.8	17.5	11	564.6	783.4
Size 7	65-053	5 x 100	30	65	719.6	28.4	11	11	666.2	885

