

MATERIAL : BODY-BRASS
 CONTACT PIN-BRASS
 SLEEVE-BRASS
 NUT-BRASS
 WASHER-BRASS
 RUBBER-SILICONE
 GASKET-RUBBER
 SHELL-BRASS
 C WASHER-BRASS
 INSULATOR-TEFLON

FINISH : BODY-NICKEL PLATING
 SLEEVE-NICKEL PLATING
 NUT-NICKEL PLATING
 WASHER-NICKEL PLATING
 SHELL-NICKEL PLATING
 C WASHER-NICKEL PLATING
 CONTACT PIN-GOLD PLATING OVER NICKEL

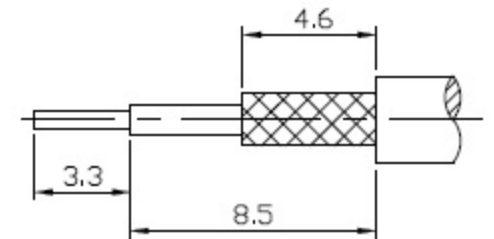

DIMENSIONS ARE IN MILLIMETERS				SCHMID-M		
· ×	±0.5	ANGLE ±3°	SCALE	4:1	TITLE	TNC STRAIGHT PLUG CLAMP FOR RG58u, RG58A/u, RG141A/u
· × ×	±0.1		REV	A-0		DRAWING NO
· × × ×	±0.05		DRAWN	DATE	94.08.01	
APPROVAL		DATE				